

PRODUCT NUMBER

71600-YXXXLF

- LEAD FREE, SEE NOTE 6
- COLOR OPTION, SEE NOTE 1
- TOTAL NB OF POSITION 04 TO 64 SEE SHEET 2
- OPTIONAL STRAIN RELIEF SEE SHEET 2

TRIANGLE INDICATES POSITION 1
NOTE 5

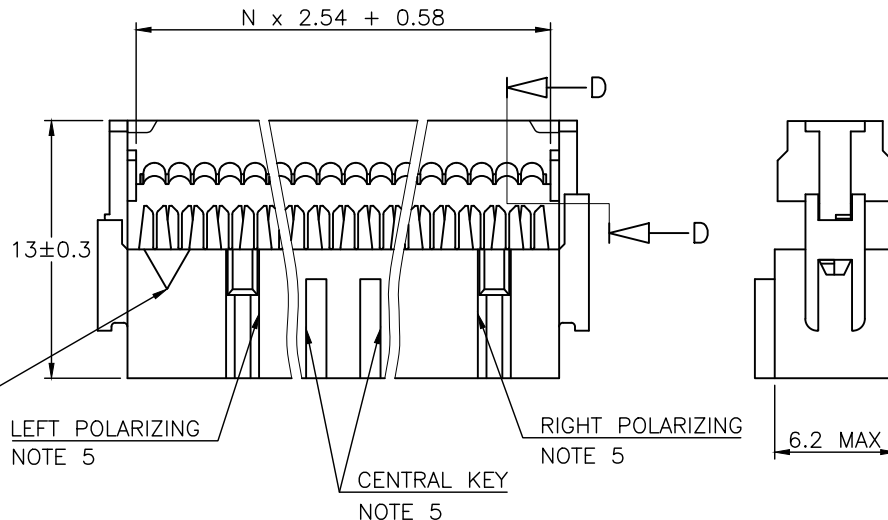

NOTES:

- 1 - HOUSING MATERIAL : GLASS FILLED THERMOPLASTIC. UL94V-0 COLOR: GREY
 = STANDARD COLOR GREY
 B = OPTION COLOR BLACK
- 2 - PIN MATERIAL : PHOSPHOR BRONZE
- 3 - PRODUCT PACKAGED IN TUBES.
- 4 - TO DETERMINE DIMENSIONS :
 N = NUMBER OF POSITIONS PER ROW
 EXAMPLE : 8 POS $N \times 2.54 = 20.32\text{mm}$
- 5 - 2x5, 2x6, 2x7 HAVE NO LEFT POLARIZING SLOT.
 - 2x2, 2x3 WITH CENTRAL KEY HAVE NO TRIANGLE, NO LEFT AND RIGHT POLARIZING SLOT.
 - 2x2 WITHOUT CENTRAL KEY HAS NO LEFT AND RIGHT POLARIZING SLOT.
 - 2x3, 2x4 WITHOUT CENTRAL KEY HAVE NO LEFT POLARIZING SLOT
 - 2x4 WITH CENTRAL KEY HAVE NO LEFT AND RIGHT POLARIZING SLOT
- 6 - THIS PRODUCT MEETS EUROPEAN UNION DIRECTIVES AND OTHER COUNTRY REGULATIONS AS PER GS-22-008. PACKAGING SPECIFICATION AS PER GS-14-920.

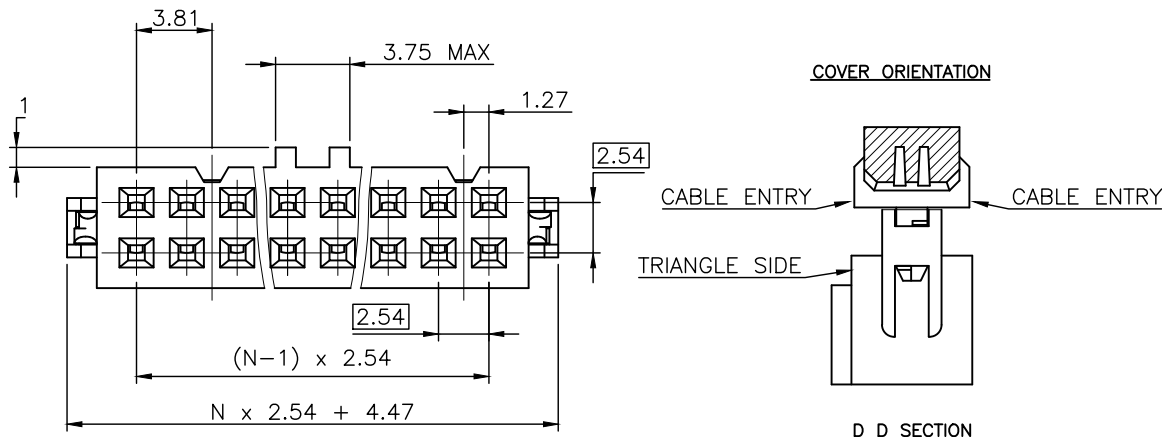

| | | | | | | | | | |
|--------------------------|--|---------------------------------------|--|-------------------------------|--|------------------|--|---------------------------------------|--|
| mat'l. code SEE NOTES | | surface ISO 1302 ✓ | | tolerance ISO 406 ISO 1101 | | projection mm | | product family 2.54MM IDC | |
| lfr ecn no dr date | | tolerances unless otherwise specified | | X.X ±0.3 | | mm | | title QUICKIE III FEM 0.76µm Au | |
| AP F12-0046 LMU 12.04.25 | | angles | | X.XX ±0.13 | | scale 5:1 | | dwg no 71600 | |
| AR B-17851 LMU 14.06.05 | | linear | | X.XXX ±0.05 | | FCJ | | sheet 1 of 2 size A3 | |
| AS F-26816 LMU 17.06.06 | | dr | | D.LE 01.01.24 | | | | type CUSTOMER Drawing | |
| AL F06-0270 LMU 06.09.12 | | engr | | P.NZ 01.01.24 | | | | | |
| AM F06-0274 LMU 06.09.25 | | chr | | JF.N 01.01.24 | | | | | |
| AN F09-0233 LMU 09.12.15 | | appd | | P.NZ 01.01.24 | | | | | |
| sheet revision AS AG | | index sheet 1 2 | | | | | | | |

| STRAIN RELIEF OPTION AVAILABILITY | Nbr OF POSITIONS |
|-----------------------------------|------------------|
| 1/6 | 04 |
| 0/1/2/3/6 | 06 |
| 0/1/2/3/6 | 08 |
| 0/1/2/3/6 | 10 |
| 0/1/2/3/6 | 14 |
| 0/1/2/3/6 | 16 |
| 0/1/2/3/6 | 18 |
| 0/1/2/3/6 | 20 |
| 0/1/3 | 24 |
| 0/1/2/3/6 | 26 |
| 0/1/2/3/6 | 30 |
| 0/1/2/3/6 | 34 |
| 0/1/2/3/6 | 40 |
| 0/1/2/3/6 | 50 |
| 0/1/2/3/6 | 60 |
| 0/1/2/3/6 | 64 |

| |
|-----------|
| 624 |
| 304 |
| 204 / 224 |
| 004 |

DASHES NOT AVAILABLE

PLATING
 0.76µm GOLD ON CONTACT AREA
 1.27 µm Ni REMAINDER OF PRODUCT

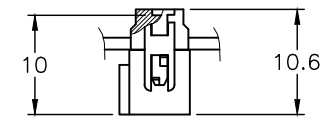

WITHOUT STRAIN RELIEF

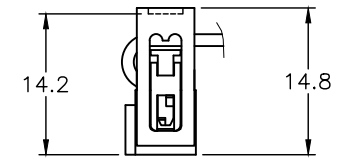

WITH LOW PROFILE STRAIN RELIEF

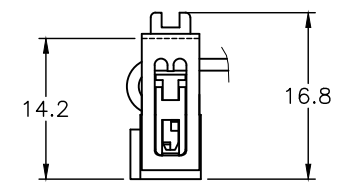

WITH STANDARD STRAIN RELIEF

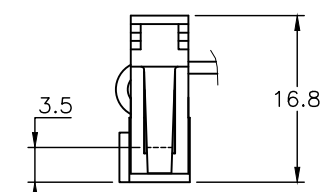

WITH LATCHING STRAIN RELIEF

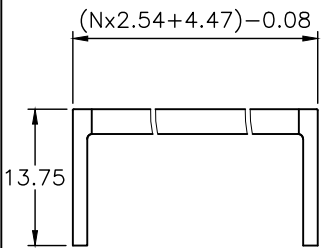

LOW PROFILE STRAIN RELIEF

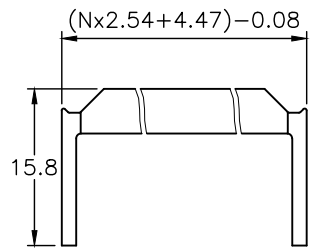

STANDARD STRAIN RELIEF

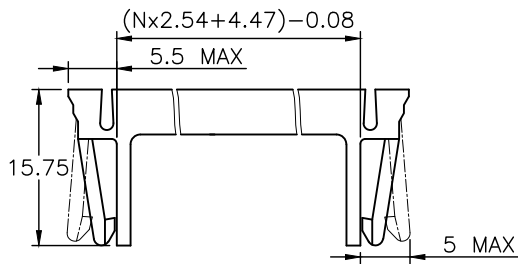

LATCHING STRAIN RELIEF FOR SLIM HEADER

| PRODUCT NUMBER | WITH CENTRAL KEY | | STRAIN RELIEF | | | |
|----------------|------------------|---------|---------------|---------|-------------|----------|
| | WITH | WITHOUT | STANDARD | WITHOUT | LOW PROFILE | LATCHING |
| 71600-6YY(B)LF | ● | | | | | ● |
| 71600-3YY(B)LF | | ● | ● | | | |
| 71600-2YY(B)LF | ● | | | ● | | |
| 71600-1YY(B)LF | ● | | | | ● | |
| 71600-0YY(B)LF | ● | | ● | | | |

| | | | | | | | | | |
|--------------------------|--|---------------------------------------|--|------------------|--|------------|--|-----------------------|--|
| mat'l. code | | surface | | tolerance | | projection | | product family | |
| | | ISO 1302 | | ISO 406 ISO 1101 | | mm | | QUICKIE | |
| ltr ecn no dr date | | tolerances unless otherwise specified | | angles linear | | scale N/A | | title | |
| AF B-17851 LMU 14.06.05 | | | | | | | | IDC RECEPT DR | |
| AG F-26816 LMU 17.06.06 | | | | | | | | sheet 2 of - size | |
| AB F03019 DLE 03.01.23 | | dr | | D.LE | | 01.01.24 | | 71600 A3 | |
| AC F05-0180 LMU 05.04.22 | | enrg | | P.NZ | | 01.01.24 | | type CUSTOMER Drawing | |
| AD F06-0270 LMU 06.09.12 | | chr | | JF.N | | 01.01.24 | | | |
| AE F06-0274 LMU 06.09.25 | | appd | | P.NZ | | 01.01.24 | | | |
| sheet index | | revision sheet | | | | | | | |



Copyright FCI

X-ON Electronics

Largest Supplier of Electrical and Electronic Components

Click to view similar products for [Headers & Wire Housings](#) category:

Click to view products by [Amphenol](#) manufacturer:

Other Similar products are found below :

[892-18-020-10-001101](#) [58102-G61-06LF](#) [582553-1](#) [0009485154](#) [009176003701906](#) [0050291907](#) [LY20-4P-DT1-P1E-BR](#) [02.125.8002.8](#)
[609-3404](#) [61062-3](#) [622-0430](#) [622-3653LF](#) [63453-116](#) [636-1030](#) [636-1427](#) [636-3427](#) [636-4007](#) [641938-9](#) [641991-4](#) [644827-2](#) [65817-010LF](#)
[65817-015LF](#) [65863-015LF](#) [66207-023LF](#) [67095-007LF](#) [67601157](#) [68648-049](#) [70.362.1628.0](#) [70-4210](#) [70-4226B](#) [70-4853B](#) [707-5020](#) [707-](#)
[5028](#) [71.350.2428.0](#) [71918-208LF](#) [71961-016LF](#) [733-134](#) [733-162](#) [754199-000](#) [760-3052](#) [787-8014-00](#) [79531-3000](#) [FCN-360C032-B](#) [FCN-](#)
[367T-T012/H](#) [FCN-723D010/2](#) [80.063.4001.1](#) [800-90-001-10-001000](#) [800-90-010-10-002000](#) [801-43-002-10-013000](#) [801-43-006-10-002000](#)