

PRODUCT NUMBER
73326-XXXXF

PLATING OPTION	1 = GXT 0.76 μ m
	3 = GOLD 0.76 μ m
	5 = GOLD 1.27 μ m
PACKAGE OPTION	1 = TAPE ON REEL
	2 = TUBE
	3 = TAPE ON REEL
	IN PLASTIC BAG

TERMINAL LOADING	1 = FULLY LOADED
	2 = POS 2,3,4,5
	3 = POS 1,2,5,6

WHEN NEEDED, SUFFIX LETTER "F" INDICATES THE PRODUCT IS ROHS COMPLIABLE, SEE NOTE 4.

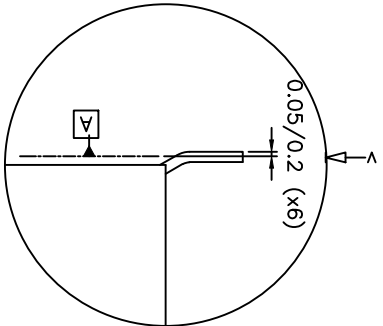
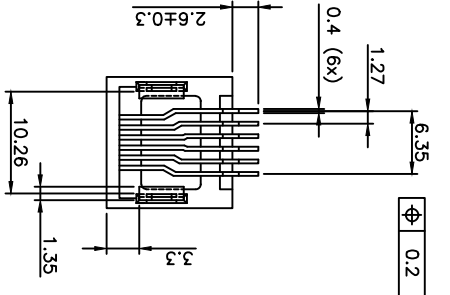
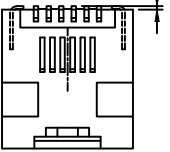
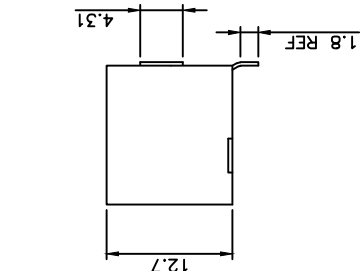
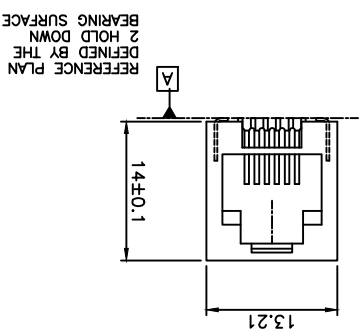

NOTES:
1 - MATERIAL: HOUSING: HIGH TEMP. PCT, COLOUR BLACK.
TERMINAL: PHOSPHOR BRONZE.
2 - PLATING: CONTACT AREA: SEE TABLE.
SOLDER TAIL : 90/10 SnPb 2 μ m MIN.
WHEN SUFFIX "LF" IS REQUIRED, 2 μ m MIN MATTE TIN OVER 1.27 MIN NI IS SUPPLIED INSTEAD OF SnPb. NO RAW EDGES EXEPT SOLDER TAIL TIPS
3 - SOLDER TAILS COPLANARITY : 0.1 mm
4 - ROHS COMPLIABLE PRODUCT SPECIFICATIONS

d - PLATING:
"LF" MEANS THE PRODUCT IS LEAD-FREE, 2 μ m MINIMUM MATTE TIN OVER 1.27 μ m MINIMUM NICKEL UNDERPLATE.
b - MANUFACTURING PROCESS COMPATIBILITY
- THE HOUSING WILL WITHSTAND EXPOSURE TO 245°C PEAK TEMPERATURE FOR 30 SECONDS MAX IN A CONVECTION, INFRA-RED OR VAPOR PHASE OR REFLOW OVEN.
c - LABELING:
- MEETS PACKAGING SPECS AS PER GS-14-920
d - LEGAL STATEMENT: SEE GS-47-0004
5 - PACKAGING FOR OPTION 3: EACH REEL IS WRAPPED INTO A PLASTIC BAG TO PROTECT FROM MOISTURE DURING STACKING TIME.

mat'l. code		ISO 1302	surface tolerance	ISO 406 ISO 1101	projection	product family	MOD JACK
ltr	ecn no	dr	date	tolerances unless otherwise specified	mm	title	SMT RA JACK
H	F06-0240	DLE	06.07.18	±0.13	mm	scale 2:1	6 POS INSIDE
J	F09-0070	LSA	09.07.23	angles	linear		
K	B-15798	JFA	13.09.09	±2°			
L	F-21888	AMA	15.09.09	dr	D LEGRAND	04.10.18	
F	F04-0363	DLE	04.10.18	chnr	D LEGRAND	04.10.18	
G	F05-0247	DLE	05.09.12	appd	P NZ	04.10.18	
sheet index		revision		type		CUSTOMER Drawing	
1	2	3	4	5	6		

CUSTOMER COPY FOR REFERENCE ONLY

mat'l. code		ISO 1302	ISO 406 ISO 1101	projection	product family	MOD JACK
ltf ecn no	dr	date	tolerances unless otherwise specified	±0.13	mm	title
A	F04-0363	DLE	04.10.18	linear	angles	SMT RA JACK
B	F06-0240	DLE	06.07.18	±Z	scale	6 POS INSIDE
Sheet	revision	appd	P NZ	04.10.18	type	CUSTOMER Drawing
index	sheet	chr	D LEGRAND	04.10.18	dwg no	73326
		engr	P NIZZI	04.10.18	sheet 3 of -	A4
		dr	D LEGRAND	04.10.18	size	

CUSTOMER COPY FOR REFERENCE ONLY

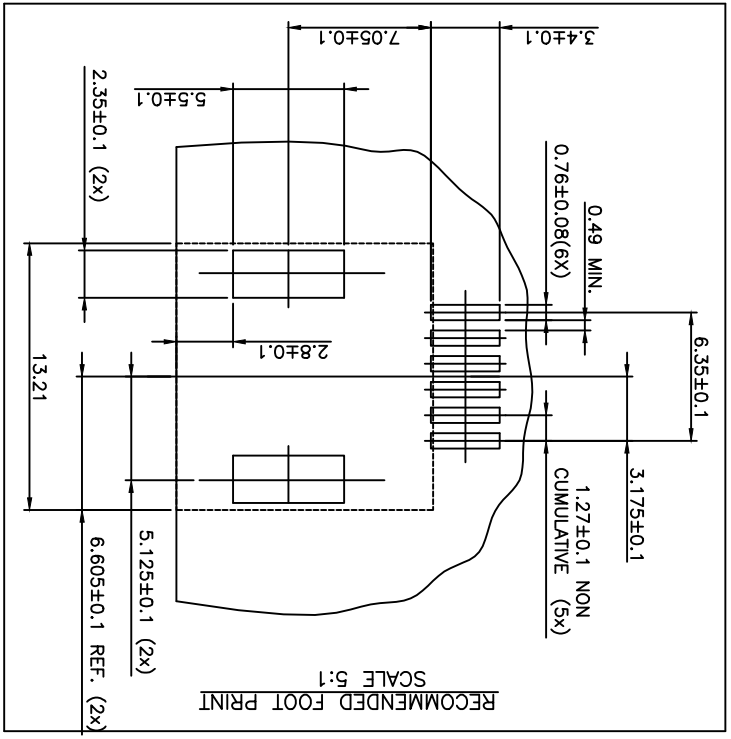

X-ON Electronics

Largest Supplier of Electrical and Electronic Components

Click to view similar products for [Modular Connectors](#) / [Ethernet Connectors](#) category:

Click to view products by [Amphenol](#) manufacturer:

Other Similar products are found below :

[RJE231881317T](#) [MP1010RX-1000](#) [MP44RX-1000](#) [GAX-3-66](#) [GAX-8-62](#) [93606-0253](#) [GD-A-44](#) [GDCX-PA-66-50](#) [GDCX-PN-64](#) [GDCX-PN-66](#) [GDCX-PN-66-50](#) [GDLX-A-66](#) [GDLX-A-88](#) [GDLX-N-66](#) [GDLX-S-88K](#) [GDTX-S-88-50](#) [GDX-PA-1010](#) [GLX-N-1010M-BLK](#) [GLX-N-44M](#) [GLX-S-88M-BLK](#) [GMX-N-1010](#) [GMX-S-1010](#) [GMX-S-66](#) [GMX-SMT2-N-1010](#) [GMX-SMT2-N-64-50](#) [GMX-SMT2-S6-88](#) [GMX-SMT4-N-88](#) [GPX-2-64](#) [GRT1-BT1-5](#) [GSGX-N-2-88](#) [GSX-NS2-88-3.05](#) [GSX-NS2-88-3.05-50](#) [GSX-NS-88-3.05-30](#) [GSX-NS-88-3.05-50](#) [GSX-NS-88-3.68](#) [1-1775629-2](#) [GWLX-S-88-GR](#) [GWLX-S9-88-YG](#) [1300500326](#) [1300500227](#) [1300530003](#) [1300570002](#) [1324640-4](#) [RJ11FTVC2G](#) [RJ11FTVC2N](#) [RJFTVX2SA1G](#) [132764-001](#) [1400000](#) [1413176](#) [1413235](#)