

PRODUCT NUMBER
SEE SHT. 2

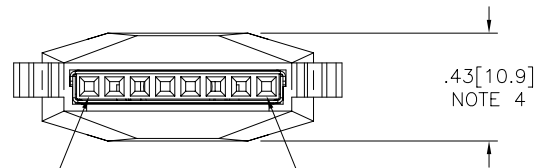
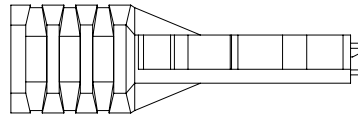
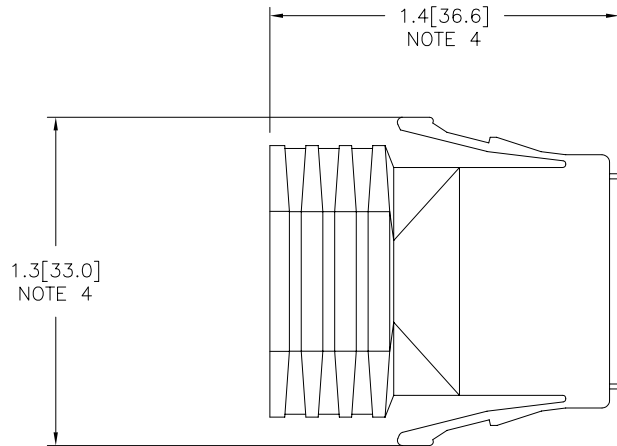

POSITION #1

POSITION #8

FCI
FCIconnect.com

Copyright FCI

mat'l. code				surface ISO 1302 ✓		tolerance ISO 406 ISO 1101		projection ASME Y14.5		product family LATCH-N-LOK			
D V91916 TGD 10/7/99				tolerances unless otherwise specified		.XX±.01/.3		INCH/MM		title 1X8 LATCH-N-LOK 360° SHIELDED PLUG CONN. KIT W/O PV'S			
E V92065 RGD 10/29/99				angles		linear .xxx±.005/.13		scale 1:1		dwg no 74903			
F V01017 TFG 5/15/00				0°±2'		.xxxx±.0020/.051				sheet 1 of 3 size A3			
G V01050 TFG 6/5/00				dr		M. HERNANDEZ 12/03/04		FCI		type Product Customer Drawing			
H V01093 TFG 7/6/00				engr		M. BARRIOS 12/03/04							
J M04-0229 MHT 12/03/04				chr		M. BARRIOS 12/03/04							
K M06-0365 AGS 9/20/06				appd		M. BARRIOS 12/03/04							
sheet		revision		K		K		K					
index		sheet		1		2		3					

74903-TUVLF

U	COLOR	
01	LT-GRAY	OBS
02	OFF WHITE	
03	DK- GRAY	OBS
04	BLACK	
05	SLATE-GRAY	OBS
07	SILVER GRAY	
08	PEARL- WHITE	OBS
09	PEBBLE GRAY	

T	HOLE DIA.
7	.265/6.73
9	.312/7.92

EXAMPLE

74903-707LF: IS A 1x8 REAR EXIT PLUG
 IN SILVER GRAY WITH A CABLE EXIT
 HOLE SIZE OF .265 [6.73] CABLE RANGE ,



Copyright FCI

mat'l. code		surface ISO 1302 <input checked="" type="checkbox"/>		tolerance ISO 406 ISO 1101		projection 		product family LATCH-N-LOK	
ltr	ecn no	dr	date	tolerances unless otherwise specified				title	
K				angles	linear	INCH/MM		1X8 LATCH-N-LOK 360° SHIELDED PLUG CONN. KIT W/O PV'S	
				0°±2'	.XX±.01/.3 .xxx±.005/.13 .xxxx±.0020/.051	scale 1:1		dwg no	
		dr	M. HERNANDEZ	12/03/04			sheet 2 of 3 size		
		enr	M. BARRIOS	12/03/04			74903 A3		
		chr	M. BARRIOS	12/03/04			type Product Customer Drawing		
		app	M. BARRIOS	12/03/04					
sheet index	revision sheet								

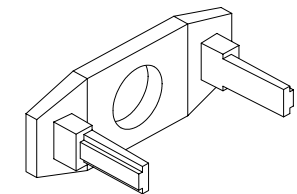

REAR CAP

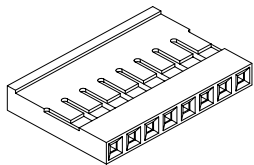

MINI LATCH HOUSING

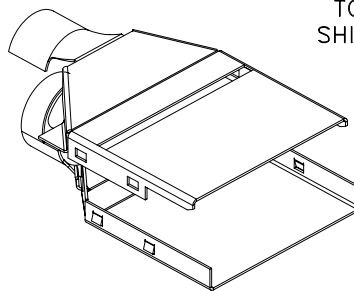

TOP SHIELD

BOTTOM SHIELD

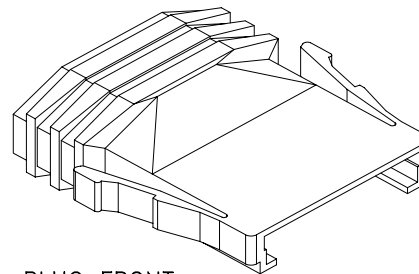

PLUG FRONT

NOTES:

- ① EACH KIT CONTAINS ONE EACH OF THE FOLLOWING COMPONENTS
LATCH-N-LOK PLUG
LATCH-N-LOK END CAP
MINI LATCH HOUSING
360° SHIELD CANS.
- 2. COMPONENTS ARE BULK PACKAGED WITH 100 pcs. OF A COMPONENT PER BAG. PVC'S MUST BE ORDERED SEPARATELY.
- 3. MATERIALS USED: PLUGS AND CAPS ARE MOLDED IN POLYCARBONATE. THE MINI LATCH HOUSING ARE MOLDED IN NYLON. COLOR IS BLACK. THE SHIELD CAN IS 3/4 HARD BRASS PLATED WITH 2.5um MIN. BRIGHT TIN. 1.0um MIN. NICKEL UNDERPLATE.
- ④ DIMENSIONS ARE APPROXIMATE AND REFLECT PLUG IN UNLATCHED STATE.
- 5. PART NUMBERS WITH LF IN THE END ARE LEAD FREE.
- 6. THIS PRODUCT MEETS EUROPEAN UNION DIRECTIVES AND OTHER COUNTRY REGULATION AS DESCRIBED IN GS-22-008.



FCIconnect.com

Copyright FCI

mat'l. code		surface ISO 1302 ✓		tolerance ISO 406 ISO 1101		projection ⊕		product family LATCH-N-LOK	
ltr	ecn	no	dr	date	tolerances unless otherwise specified		INCH/MM	title	
K					angles	.XX±.01/.3		1X8 LATCH-N-LOK 360° SHIELDED PLUG CONN. KIT W/O PV'S	
					0'±2'	linear .xxx±.005/.13	scale 1:1	dwg no	
						.xxx±.0020/.051		sheet 3 of 3 size	
				dr	M. HERNANDEZ	12/03/04		74903	
				enfr	M. BARRIOS	12/03/04		A3	
				chr	M. BARRIOS	12/03/04		type Product Customer Drawing	
				appd	M. BARRIOS	12/03/04			
sheet index	revision sheet								

X-ON Electronics

Largest Supplier of Electrical and Electronic Components

Click to view similar products for [I/O Connectors](#) category:

Click to view products by [Amphenol](#) manufacturer:

Other Similar products are found below :

[571763P](#) [58098-0628](#) [72.250.1628.2](#) [72.250.2428.2](#) [74720-0505](#) [76.350.0729.0](#) [76871-1403](#) [FCN-244F080-G/1](#) [FCN-260A9920](#) [PCR-E36PM](#) [PCS-XE26MA+](#) [G38A71314B](#) [1571250010](#) [157-22500-3](#) [MS3471L14-19P L/C](#) [192991-0703](#) [172501-4002](#) [172501-6002](#) [FCN-260C008-A/L0](#) [FCN-260C024-AL0](#) [FCN-261Z008](#) [2000314-1](#) [200331-1](#) [PCR-E36FC+](#) [PCS-E28FS+](#) [PCS-XE26SLFD+](#) [PCS-XE26SLFDT+](#) [G730VID08BDC24](#) [HDR-E14MSG1+](#) [U90B2054081210](#) [UE86K842720321](#) [38113800006](#) [DP3AR020WQ1R200](#) [Z4.102.0680.0](#) [500-1040](#) [500-1052](#) [500-1054](#) [ZP-4008-66L](#) [0709821002](#) [DX40-20P\(55\)](#) [5554841-1](#) [MS3474W18-8P-LC*](#) [SM3106F14S-7S-LC](#) [U90B3054061110](#) [U65-E04-4020](#) [ZPF000000000097891](#) [557-262M2-06C](#) [747360449](#) [10099439-003C-TRLF](#) [10137239-0021LF](#)