

PRODUCT NUMBER

77314-YXXXLF

WHEN REQUIRED, ADD SUFFIX LETTER "LF" INDICATES THE PRODUCT IS RoHS COMPATIBLE, SEE NOTE 8

OPTION LETTER SEE NOTE 7 & SHEET 9

PIN STYLE SEE SHEET 2 TO 8

PLATING SEE SHEET 2

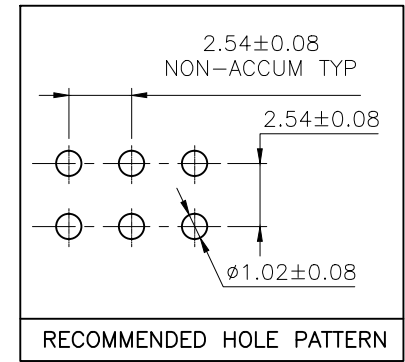
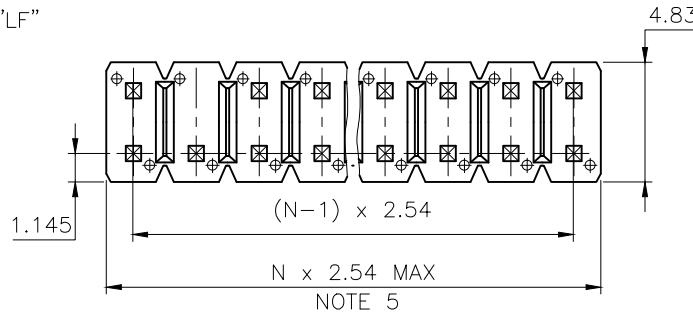

NOTES:

1. HOUSING MAT'L : HIGH TEMPERATURE THERMOPLASTIC. UL94V-0 COLOR: BLACK
2. PIN MATERIAL : PHOSPHOR BRONZE
3. PRODUCT PACKAGED IN POLY BAGS.
4. 9N MIN RETENTION IN EITHER DIRECTION
5. TO DETERMINE DIMENSIONS :  
N = NUMBER OF POSITIONS PER ROW  
EXAMPLE : 8 POS N x 2.54 = 20.32mm
6. UNDERPLATING : 1.27µm Ni MIN
7. RETENTION OPTION "R", OMIT FROM PRODUCT NUMBER IF FEATURE IS NOT APPLICABLE
8. RoHS COMPATIBLE PRODUCT SPECIFICATIONS

a - PLATING:

- "LF" MEANS THE PRODUCT IS LEAD-FREE, 2µm MINIMUM MATTE TIN OVER 1.27µm MINIMUM NICKEL UNDERPLATE.

b - MANUFACTURING PROCESS COMPATIBILITY

- THE HOUSING WILL WITHSTAND EXPOSURE TO 260°C ±5°C SOLDER BATH TEMPERATURE FOR 5 SECONDS IN A WAVE SOLDER APPLICATION WITH A 1.6mm MIN THICK CIRCUIT BOARD.

c - LABELING:

- MEETS PACKAGING SPECS AS PER GS-14-920

d - LEGAL STATEMENT: SEE GS-47-0004

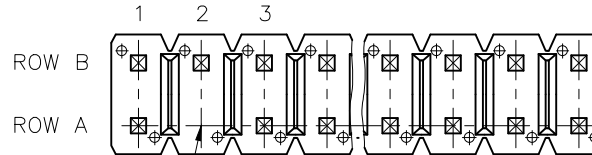
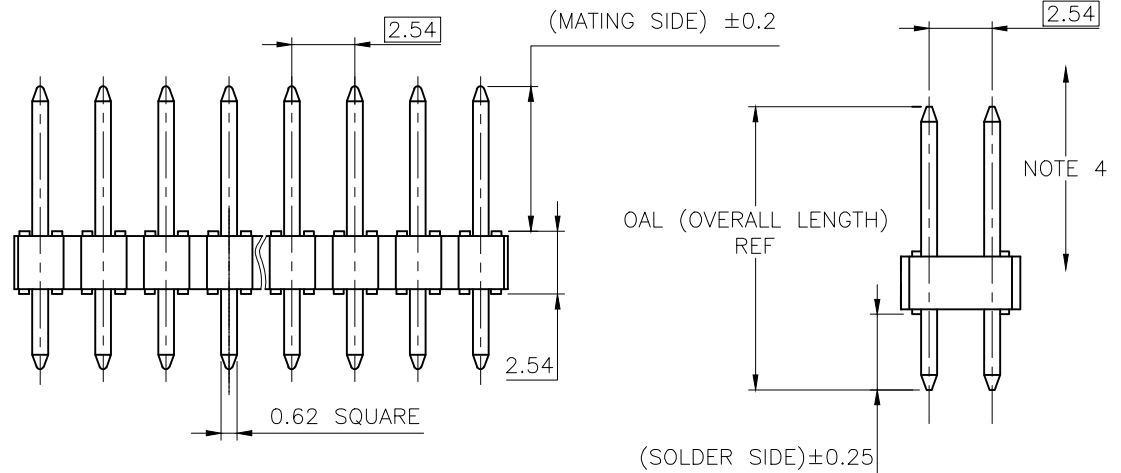

BOTTOM VIEW

mat'l. code SEE P/N		surface ISO 1302 ✓		tolerance ISO 406 ISO 1001		projection mm		product family BSTIK											
ltr ecn no dr date		tolerances unless otherwise specified		.x ±0.3		mm		title											
BR F11-0050LMU 11.05.11		angles		.xx ±0.15		scale 5:1		HEADER STR,DR											
BS F12-0010APA 12.02.01		linear		.xxx ±0.05		sheet 1 of 10		POL DUPLEX 2.54mm.											
BT B-16702 JCO 14.01.08		dr G LEOTY		91.11.13		FCI		77314 A3											
BM F09-0218LMU 09.11.16		enfr J COMPAGNON		95.12.05		type CUSTOMER		Drawing											
BN F10-0042LMU 10.09.08		chr J COMPAGNON																	
BP F10-0252JCO 10.11.30		appd JMC		95.12.05															
sheet index	revision	BT	AJ	AF	AF	AF	AH	AJ	W	J	A								
	sheet	1	2	3	4	5	6	7	8	9	10								

PIN STYLE	PRODUCT DEFINITION			
	POS	MATING SIDE ±0.2	SOLDER SIDE ±0.25	("OAL") REF
01	2X08	5.72	2.54	10.8
02	2X10	5.84	3.05	11.5
04	2X05	5.72	3.05	11.3
05	2X08	5.84	3.42	11.8
06	2X30	5.72	2.54	10.8
07	2X16	5.72	2.54	10.8
08	2X12	5.72	2.54	10.8
09	2X18	5.72	2.54	10.8
10	2X09	5.72	2.54	10.8
11	2X04	5.72	2.54	10.8

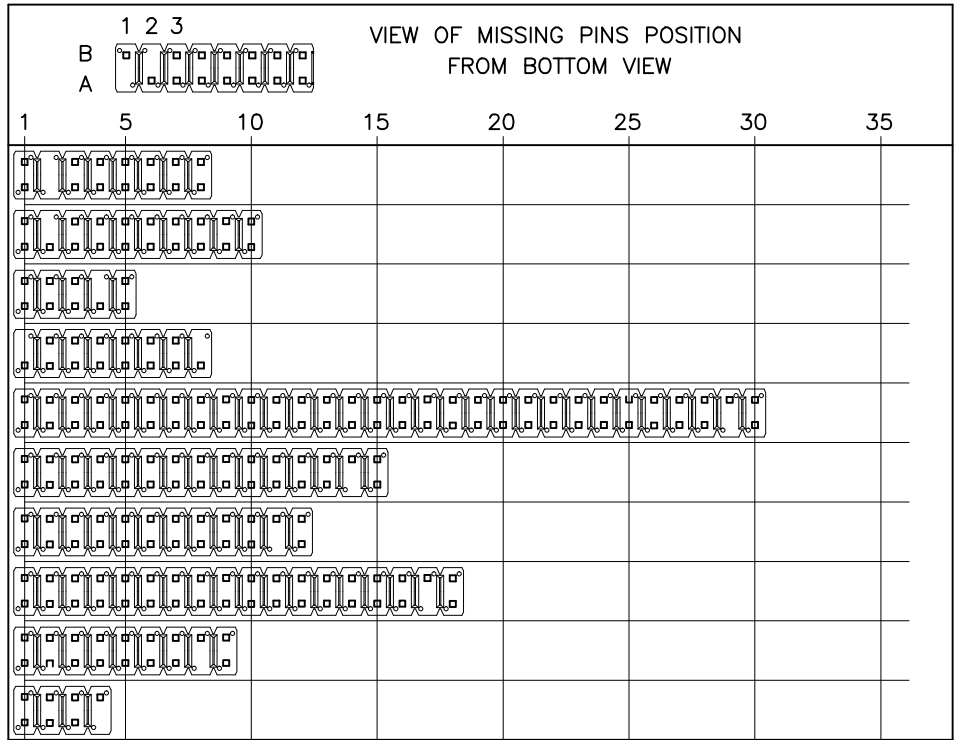

77314-8XXLF	0.38µm Au/GXT	2.0-7.5 Sn MATTE
77314-4XXLF	2.0-7.5 Sn MATTE	
77314-2XXLF	1.27µm Au	2.0-7.5 Sn MATTE
77314-1XXLF	0.76µm Au/GXT	2.0-7.5 Sn MATTE
77314-1XXSLF	0.76µm Au/GXT	GOLD FLASH

77314-8XX	0.38µm Au/GXT	4µm SnPb
77314-4XX	4µm SnPb FULL PLATED	
77314-2XX	1.27µm Au	4µm SnPb
77314-1XX	0.76µm Au/GXT	4µm SnPb
77314-1XXS	0.76µm Au/GXT	GOLD FLASH
PLATING CODE	CONTACT AREA	REMAINDER
	PLATING THICKNESS OVER 1.27µm Ni	

mat'l. code	surface	tolerance	projection	product family		
	ISO 1302	ISO 406 ISO 1101		BSTIK		
ltr	ecr no	dr	date	title		
AH	F06-0196	LMU	06.06.20	HEADER,STR,DR POL DUPLEX 2.54mm		
AJ	F08-0148	RTR	08.03.31			
	angles	linear	mm	scale 1:1		
AE	F10707	LMU	01.12.03	dr	G LEOTY	91.11.13
AF	F20197	LMU	02.04.16	enfr	PHAMVAN JM	95.02.27
AG	F04-0362	JCO	04.12.10	chr	COMPAGNON J	95.02.27
				appd	JMP	95.02.27
sheet index	revision sheet					



Copyright FCI

PIN STYLE	PRODUCT DEFINITION			
	POS	MATING SIDE ±0.2	SOLDER SIDE ±0.25	("OAL") REF
13				
14				
15				
16				
17	2X17	5.72	3.42	10.8
18	2X10	5.72	2.54	10.8
19	2X17	5.72	2.54	10.8
20				
21	2X36	5.72	2.54	10.8
22	2X08	5.72	2.54	10.8
23	2X05	5.72	2.54	10.8
24	2X03	5.72	2.54	10.8
25	2X03	5.72	2.54	10.8
26	2X03	5.72	2.54	10.8

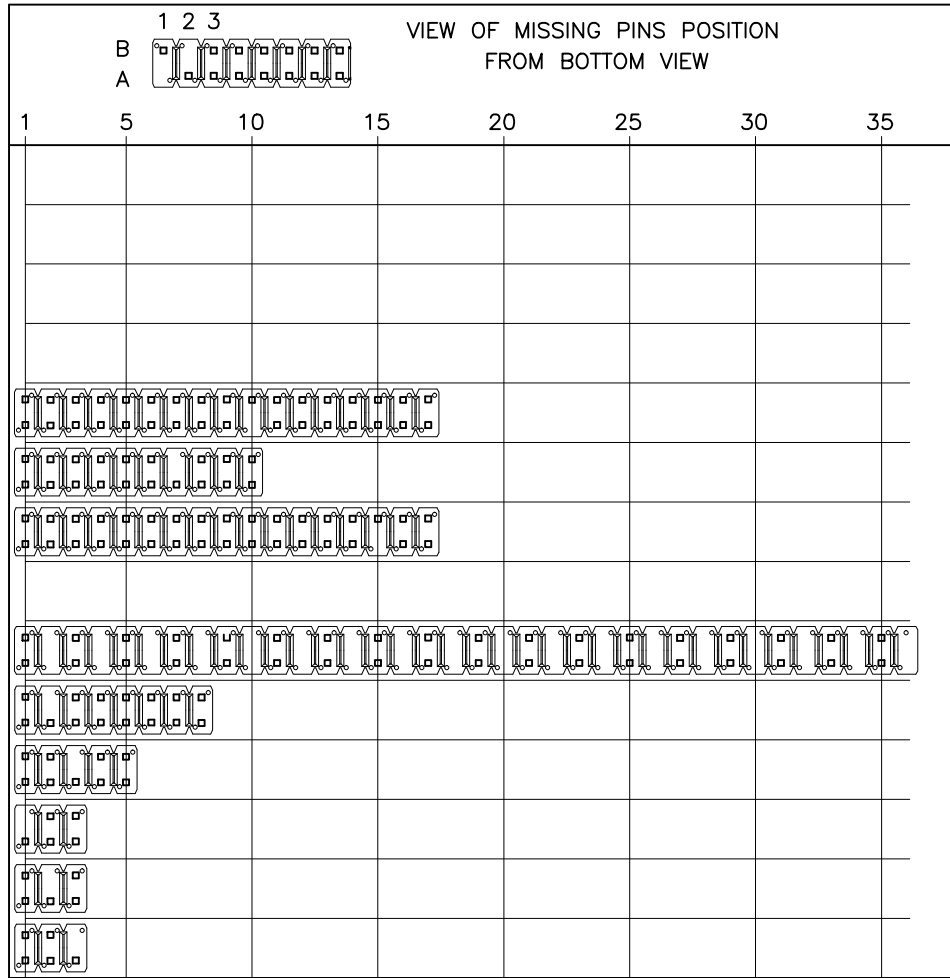

Copyright FCI

mat'l. code		surface		tolerance		projection		product family	
		ISO 1302		ISO 406 ISO 1101				BERGSTIK	
ltr ecn no dr date		tolerances unless otherwise specified		angles		mm		title	
AB F40235 JMC 94.02.25				linear				HEADER,STR,DR	
AC F30323 JMC 95.02.27						scale 1:1		POL DUPLEX 2.54mm	
AD F10707 LMU 01.12.03								dwg no sheet 3 of - size	
AE F20197 LMU 02.04.16		dr G LEOTY 91.11.13		engr PHAMVAN JM 95.02.27		77314		A3	
AF F06-0196 LMU 06.06.20		chr COMPAGNON 95.02.27		appd JMP 95.02.27		type CUSTOMER Drawing			
sheet index		revision sheet							

PIN STYLE	PRODUCT DEFINITION			
	POS	MATING SIDE ±0.2	SOLDER SIDE ±0.25	("OAL") REF
27	2X05	5.72	2.54	10.8
28	2X05	5.72	2.54	10.8
29	2X04	12.7	5.72	20.96
30	2X18	12.7	5.72	20.96
31	2X12	12.7	5.72	20.96
32	2X08	12.7	5.72	20.96
33	2X10	12.7	5.72	20.96
34	2X24	12.7	5.72	20.96
35	2X14	12.7	5.72	20.96
36	2X14	12.7	5.72	20.96
37	2X36	12.7	5.72	20.96
38	2X16	12.7	5.72	20.96
39	2X36	12.7	5.72	20.96
40	2X06	12.7	5.72	20.96

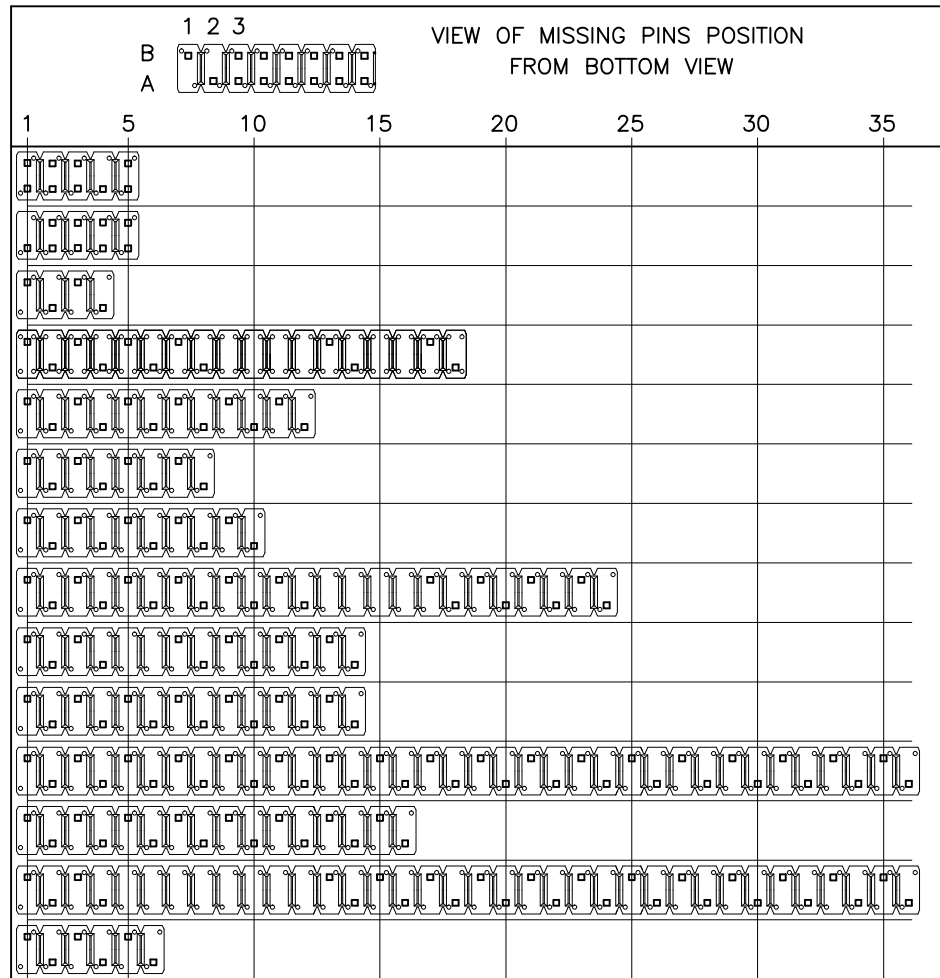

FCIconnect.com

Copyright FCI

mat'l. code		surface		tolerance		projection		product family	
		ISO 1302		ISO 406 ISO 1101				BSTIK	
ltr ecn no dr date		tolerances unless otherwise specified		angles		mm		title	
AB F40235 JMC 94.02.25				linear				HEADER,STR,DR	
AC F30323 JMC 95.02.27						scale 1:1		POL DUPLEX 2.54mm	
AD F10707 LMU 01.12.03								dwg no sheet 4 of - size	
AE F20197 LMU 02.04.16		dr G LEOTY 91.11.13		enfr PHAMVAN JM 95.02.27		77314		A3	
AF F06-0196 LMU 06.06.20		chr COMPAGNON J 95.02.27		appd JMP 95.02.27		type CUSTOMER		Drawing	
sheet index		revision sheet							

PIN STYLE	PRODUCT DEFINITION			
	POS	MATING SIDE ±0.2	SOLDER SIDE ±0.25	("OAL") REF
41	2X20	12.7	5.72	20.96
42	2X36	12.7	5.72	20.96
43	2X36	12.7	5.72	20.96
44	2X18	12.7	5.72	20.96
45	2X22	12.7	5.72	20.96
46	2X20	12.7	5.72	20.96
47	2X36	12.7	5.72	20.96
48	2X16	12.7	5.72	20.96
49	2X28	12.7	5.72	20.96
50	2X05	5.72	2.54	10.8
51	2X29	5.84	3.42	11.8
52	2X25	5.72	2.54	10.8
53	2X25	12.83	3.03	18.4
54	2X03	5.84	3.42	11.8

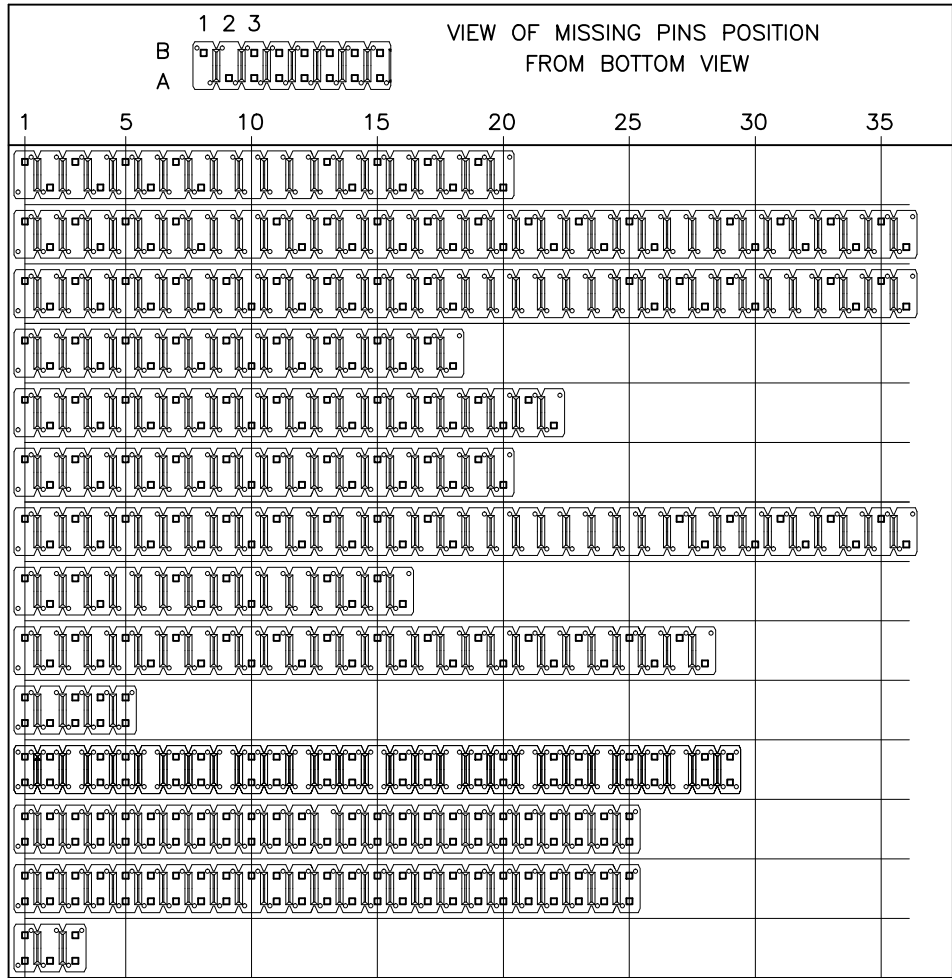

FCIconnect.com

Copyright FCI

mat'l. code		surface		tolerance		projection		product family	
		ISO 1302		ISO 406 ISO 1101				BSTIK	
ltr ecn no dr date		tolerances unless otherwise specified		angles		mm		title	
AB F40235 JMC 94.02.25				linear				HEADER,STR,DR	
AC F30323 JMC 95.02.27						scale 1:1		POL DUPLEX 2.54mm	
AD F10707 LMU 01.12.03								dwg no sheet 5 of - size	
AE F20197 LMU 02.04.16		dr G LEOTY 91.11.13		enr PHAMVAN JM 95.02.27				77314 A3	
AF F06-0196 LMU 06.06.20		chr COMPAGNON J 95.02.27		appd JMP 95.02.27				type CUSTOMER Drawing	
sheet index		revision sheet							

PIN STYLE	PRODUCT DEFINITION			
	POS	MATING SIDE ±0.2	SOLDER SIDE ±0.25	("OAL") REF
55	2X05	5.84	3.42	11.8
56	2X06	5.84	3.42	11.8
57	2X08	5.84	3.42	11.8
58	2X09	5.84	3.42	11.8
59	2X13	5.84	3.42	11.8
60	2X05	5.84	3.42	11.8
61	2X04	5.72	2.54	10.8
62	2X20	5.72	2.54	10.8
63	2X06	5.72	2.54	10.8
64	2X04	5.84	3.42	11.8
65	2X06	5.72	2.72	10.8
66	2X13	5.84	3.12	11.5
67	2X05	5.72	2.54	10.8
68	2X13	5.84	3.42	11.8

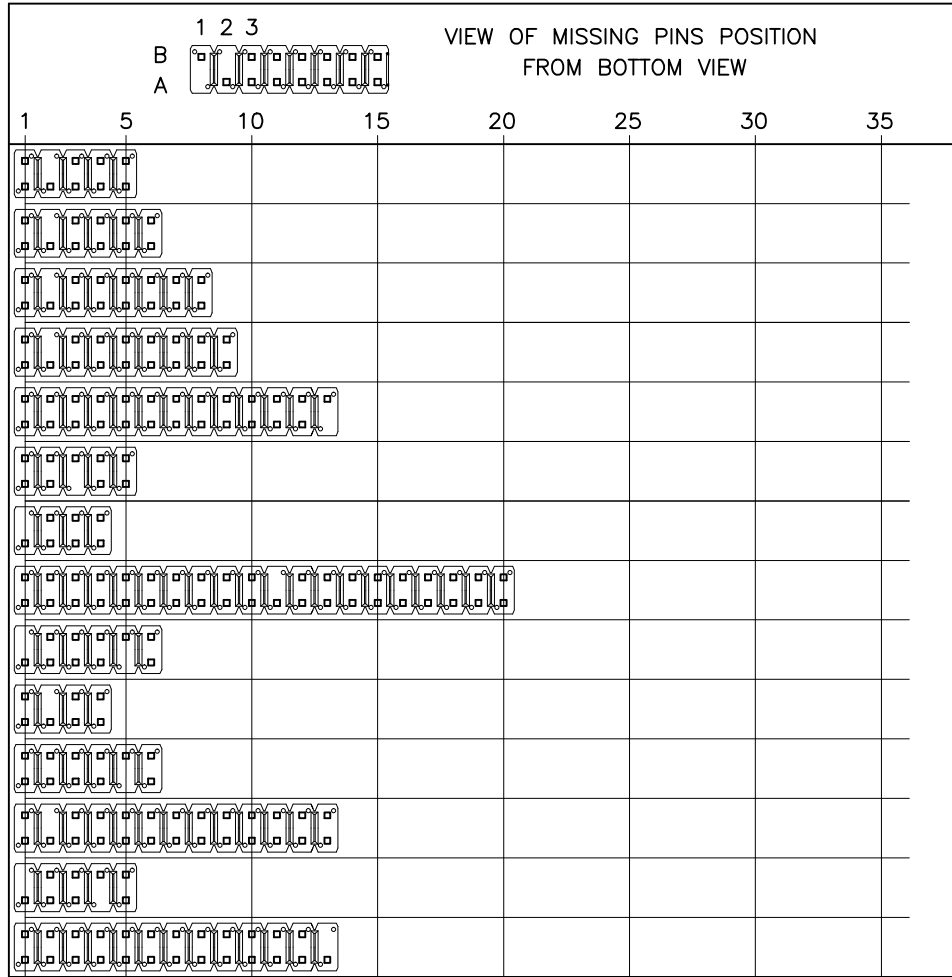

Copyright FCI

mat'l. code		surface		tolerance		projection		product family	
		ISO 1302		ISO 406 ISO 1101				BSTIK	
ltr		ecn no		dr		date		title	
AB		F40235		JMC		94.02.25		HEADER,STR,DR	
AC		F30323		JMC		95.02.27		POL DUPLEX 2.54mm	
AD		F70430		JMC		97.06.02		scale 1:1	
AE		F00100		LMU		00.01.11		dwg no	
AF		F10707		LMU		01.12.03		sheet 6 of - size	
AG		F20197		LMU		02.04.16		77314 A3	
AH		F06-0196		LMU		06.06.20		type CUSTOMER Drawing	
sheet		revision							
index		sheet							

PIN STYLE	PRODUCT DEFINITION			
	POS	MATING SIDE ±0.2	SOLDER SIDE ±0.25	("OAL") REF
69	2X04	5.72	2.54	10.8
70	2X05	5.72	2.54	10.8
71	2X20	5.72	3.05	11.3
72	2X17	5.72	3.05	11.3
73	2X10	5.72	3.05	11.3
74	2X13	5.72	3.05	11.3
75	2X20	5.72	3.05	11.3
76	2X20	5.72	3.05	11.3
77	2X17	5.72	3.05	11.3
78	2X15	5.84	3.42	11.8
79				
80				
81				
82				
83				
84	2X05	5.72	3.05	11.3

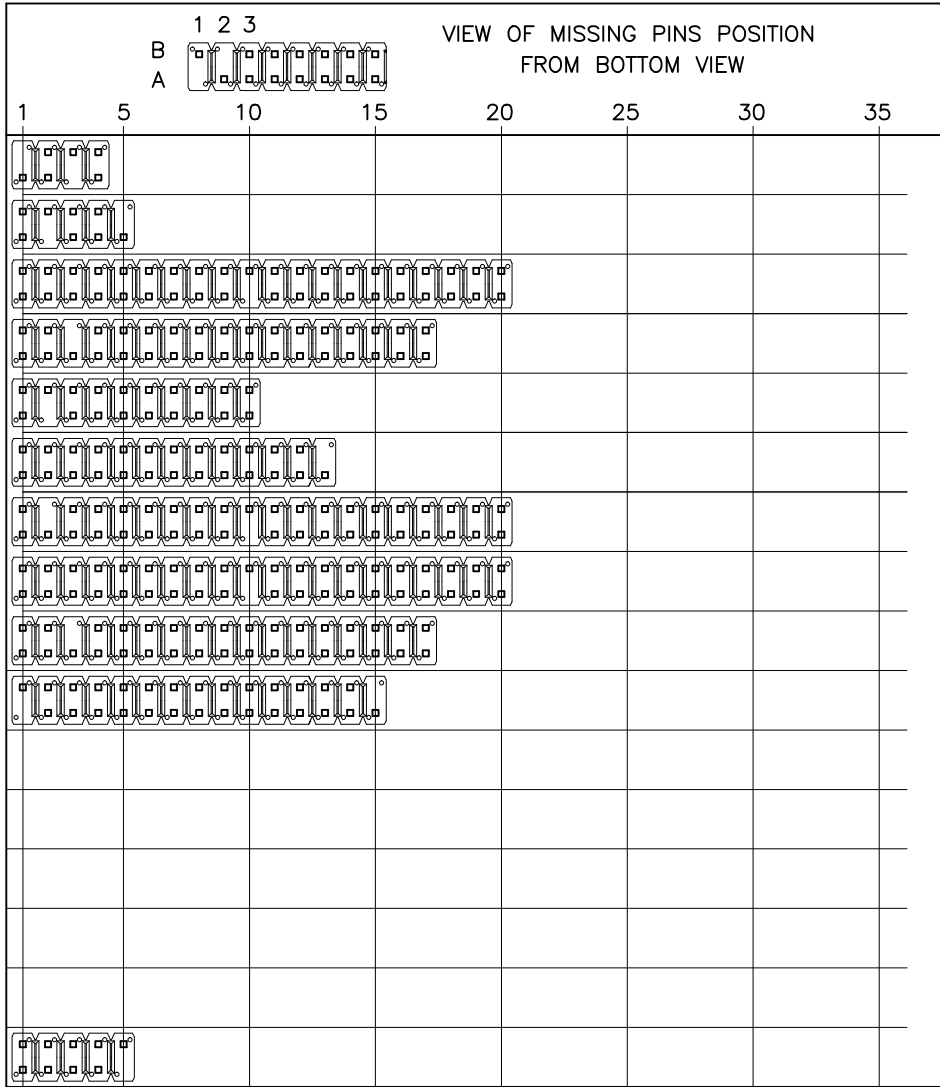

Copyright FCI

mat'l. code	surface	tolerance	projection	product family
	ISO 1302	ISO 406 ISO 1101		BSTIK
ltr ecn no dr date	tolerances unless otherwise specified		mm	title
AJ F06-0196 LMU 06.06.20	angles	linear	scale 1:1	HEADER,STR,DR POL DUPLEX 2.54mm
AD F50246 JMC 95.04.03	AE F50625 JMC 95.08.26	dr G LEOTY 91.11.13		dwg no
AF F50916 JMC 95.12.05	engr COMPAGNON J 95.12.05	chr		sheet 7 of - size
AG F10707 LMU 01.12.03	chr	appd JMC 95.12.05		77314 A3
AH F20197 LMU 02.04.16	appd JMC			type CUSTOMER Drawing
sheet index	revision sheet			

PIN STYLE	PRODUCT DEFINITION			
	POS	MATING SIDE ±0.2	SOLDER SIDE ±0.25	("OAL") REF
85	2X20	5.72	2.54	10.8
86	2X11	5.72	2.54	10.8
87	2X18	5.72	3.05	11.3
88	2X07	5.72	3.05	11.3
89	2X08	5.72	3.05	11.3
90	2X17	6.6	2.66	11.82
91	2X20	6.75	2.90	12.2
92	2X08	5.72	3.05	11.3
93	2X10	5.72	2.54	10.8
94	2X08	5.84	3.05	11.5
95	2X06	5.70	2.93	11.17
96	2X08	8.06	3.00	13.60
97	2X09	5.84	3.05	11.50
98	2X09	5.84	3.05	11.50
99	2X05	15.36	3.05	20.95
AA	2X05	5.90	2.36	10.80
AB	2X03	9.20	3.05	14.80
AC	2X03	9.20	3.05	14.80

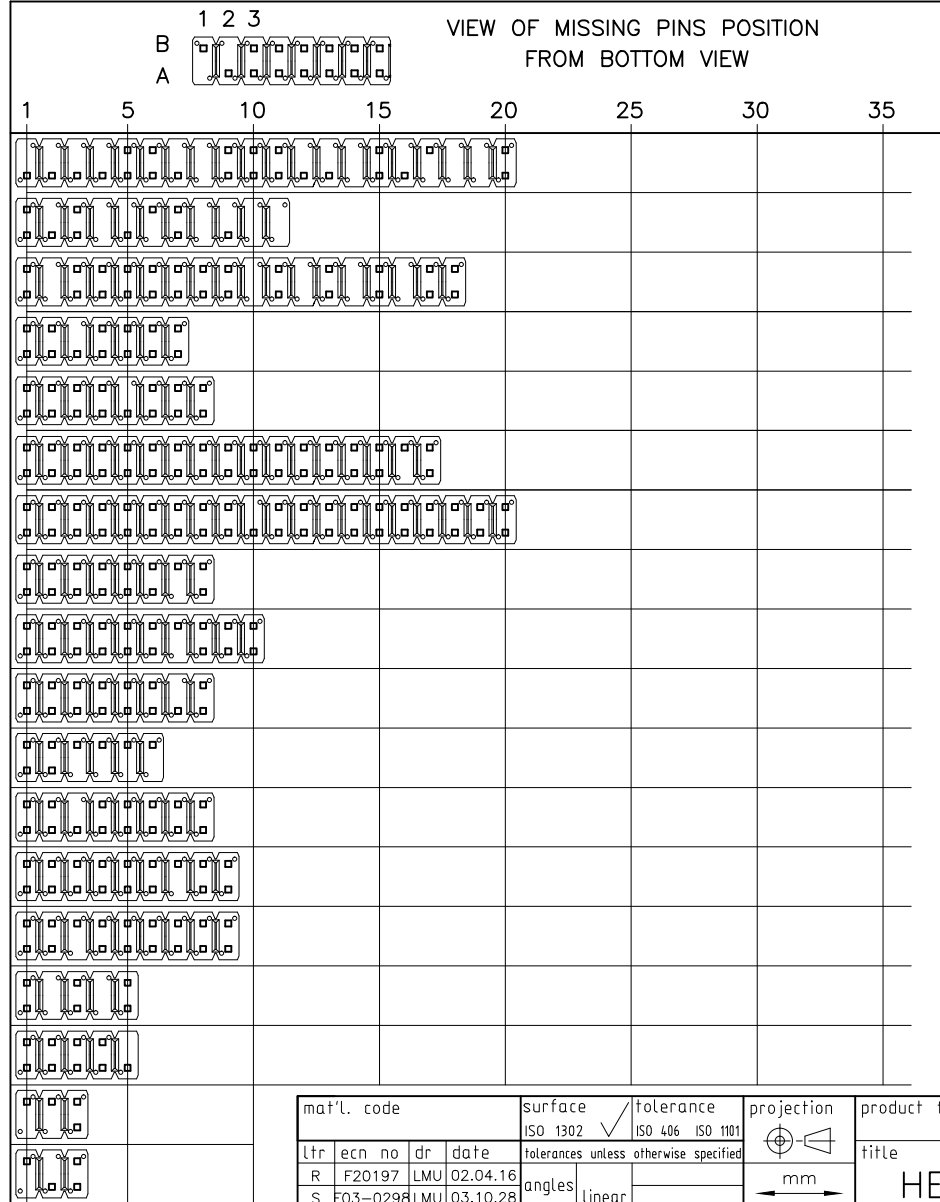

mat'l. code		surface ISO 1302 ✓	tolerance ISO 406 ISO 1101	projection 	product family BSTIK
ltr	ecn no	dr	date	tolerances unless otherwise specified	
R	F20197	LMU	02.04.16	mm	
S	F03-0298	LMU	03.10.28	linear	
T	F04-0137	LMU	04.02.12	scale N/A	
U	F06-0117	LMU	06.01.30	dr	O. MATHEVON 96.08.28
V	F06-0196	LMU	06.06.20	enfr	J COMPAGNON 96.08.28
W	F09-0218	LMU	09.11.16	chr	J COMPAGNON 96.08.28
				appd	JMC 96.08.28
sheet index	revision sheet				



title  
**HEADER,STR,DR**  
POL DUPLEX 2.54mm

dwg no  
**77314**

sheet 8 of  
size  
**A3**

type  
CUSTOMER Drawing



Copyright FCI



AH	2X06	6.75	2.90	12.20
AJ	2X08	5.84	3.42	11.80



Copyright FCI

mat'l. code				surface ISO 1302 ✓	
ltr	ecn no	dr	date	tolerances unless	
H	F12-0010	APA	12.02.01	angles	linear
J	B-16702	JCO	14.01.08		
D	F10-707	LMU	06.06.20	dr	J COMPAC
E	F10-042	LMU	10.09.08	engr	JMC
F	F10-0252	JCO	10.11.30	chr	
G	F11-0050	LMU	11.05.11	appd	JMC
sheet	revision				
index	sheet				

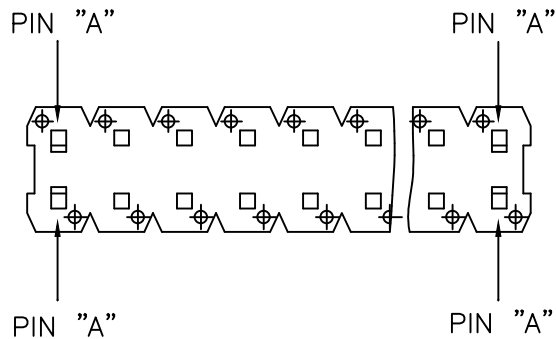
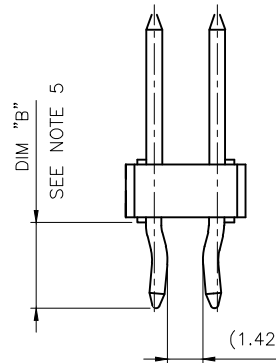
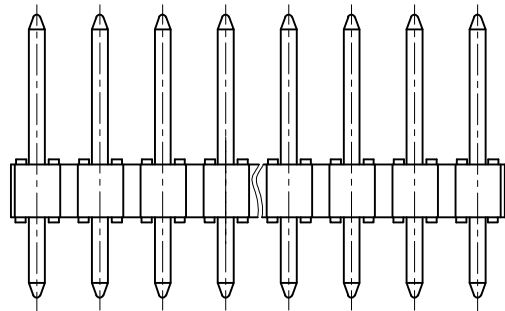

NOTES:

- 1 - PART NUMBER 77314-YXX
- 2 - PINS "A" AND "B" USED FOR RETENTION.
- 3 - DIRECTION OF RETENTION SHOWN BY ARROWS.
- 4 - KINKED LEGS LOCATION CAN BE MOVED IF A PIN IS MISSING.
- 5 - RETENTION VERSION ONLY AVAILABLE WHEN DIM "B" IS BETWEEN 3 AND 3.5mm.
- 6 - 2 AND 3 POSN KINKED HEADER ARE NOT AVAILABLE.

"R" INDICATES A RETENTION HEADER.  
 "T" INDICATES HEADERS PACKED IN TUBES

mat'l. code		surface		tolerance		projection		product family		
		ISO 1302		ISO 406 ISO 1101		mm		BSTIK		
ltr		ecn no		dr		date		title		
A		F10-0042		LMU		10.09.08		HEADER,STR,DR POL DUPLEX 2.54mm		
				angles		linear		scale N/A		
		dr		L.MULIN		10.04.30		dwg no		
		enr		JMC		10.04.30		sheet 10 of		
		chr						77314		
		appd		JMC		10.04.30		size		
								A3		
sheet index		revision sheet						type		
								CUSTOMER Drawing		



Copyright FCI

## X-ON Electronics

Largest Supplier of Electrical and Electronic Components

*Click to view similar products for [Headers & Wire Housings](#) category:*

*Click to view products by [Amphenol](#) manufacturer:*

Other Similar products are found below :

[892-18-020-10-001101](#) [58102-G61-06LF](#) [582553-1](#) [0009485154](#) [009176003701906](#) [0050291907](#) [LY20-4P-DT1-P1E-BR](#) [02.125.8002.8](#)  
[609-3404](#) [61062-3](#) [622-0430](#) [622-3653LF](#) [63453-116](#) [636-1030](#) [636-1427](#) [636-3427](#) [636-4007](#) [641938-9](#) [641991-4](#) [644827-2](#) [65817-010LF](#)  
[65817-015LF](#) [65863-015LF](#) [66207-023LF](#) [67095-007LF](#) [67601157](#) [68648-049](#) [70.362.1628.0](#) [70-4210](#) [70-4226B](#) [70-4853B](#) [707-5020](#) [707-5028](#) [71.350.2428.0](#) [71918-208LF](#) [71961-016LF](#) [733-134](#) [733-162](#) [754199-000](#) [760-3052](#) [787-8014-00](#) [79531-3000](#) [FCN-360C032-B](#) [FCN-367T-T012/H](#) [FCN-723D010/2](#) [80.063.4001.1](#) [800-90-001-10-001000](#) [800-90-010-10-002000](#) [801-43-002-10-013000](#) [801-43-006-10-002000](#)