

PRODUCT NUMBER

XXXXX-YYYHTLF

- LEAD FREE OPTION
SEE NOTE 1,11
- TUBE PACKAGING OPTION
SEE NOTE 1
- HIGH TEMPERATURE PLASTIC
SEE NOTE 1
- NO. OF POSITIONS
SEE NOTE 1
- PIN PLATING
SEE SHEET 2
- BASE PART NO.

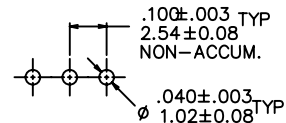
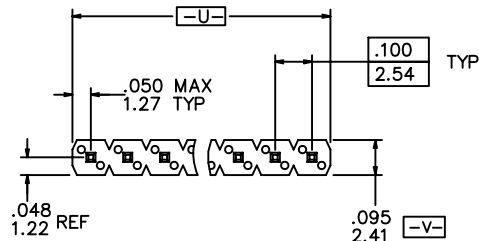

RECOMMENDED HOLE PATTERN

PRODUCT NUMBER

69190-XXXXXHALF

- LEAD FREE OPTION
SEE NOTE 1,11
- PACKAGING OPTION
SEE NOTE 1
- HIGH TEMPERATURE PLASTIC
SEE NOTE 1
- INDICATE DIFFERENT MATING LENGTH
AND TAIL LENGTH
- NO. OF POSITIONS
SEE NOTE 1
- PIN PLATING
SEE SHEET 2
- BASE PART NO.

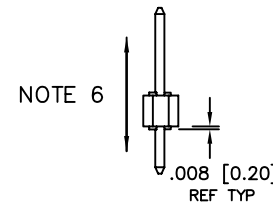
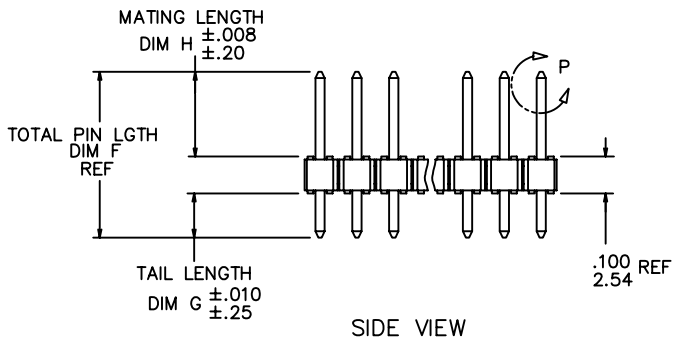

NOTE 6

⊕ ∅ .020/.51 (M) U (M) V (S)

NOTE 4

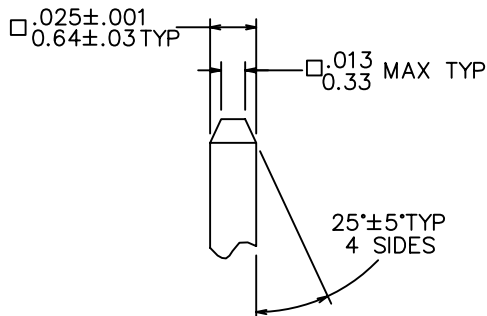

DETAIL P
TYP BOTH ENDS

| | | | | | | | | | |
|-------------|-------------|------------|------------|---------------------------------------|--------------|------------|--|-------------------------------|--|
| mat'l. code | | surface | | tolerance | | projection | | product family | |
| NOTES 2 & 3 | | ISO 1302 ✓ | | ISO 406 ISO 1101 | | INCH/MM | | BERGSTIK | |
| ltr | ecn | nldr | date | tolerances unless otherwise specified | | scale 1:1 | | title | |
| AM | ELX-N-13674 | DCS | 2012-12-12 | angles | linear | | | BERGSTIK® II HEADER | |
| AN | ELX-N-16105 | ZK | 2013-10-22 | | | | | .100/2.54 SR SELF-RET | |
| AP | ELX-N-19414 | HJ | 2014-11-13 | 0°±2' | | | | dwg no | |
| | | | | dr | D. WHITING | 4/19/93 | | sheet 1 of 4 | |
| AJ | M06-0346 | MHT | 9/04/06 | engr | T.HANNA | 4/19/93 | | 69190 | |
| AK | M08-0291 | MHT | 10/06/08 | chr | T. BREWBAKER | 4/19/93 | | A3 | |
| AL | N11-0118 | J.Z | 2011-04-11 | appd | T.HANNA | 4/19/93 | | type Product Customer Drawing | |
| sheet | revision | AP | | | | | | | |
| index | sheet | 1-4 | | | | | | | |



FCIconnect.com

Copyright FCI

PIN PLATING CODES:

| | |
|-------------|---|
| XXXX-1YY | 30u"/0.76u MIN (SEE NOTE 12) OVER 50u"/1.27u MIN Ni |
| XXXX-2YY | 15u"/0.38u MIN (SEE NOTE 12) OVER 50u"/1.27u MIN Ni |
| XXXX-3YY | 50u"/1.27u MIN (SEE NOTE 12) OVER 50u"/1.27u MIN Ni |
| XXXX-4YY | 100u"/2.54u MIN Sn OVER 50u"/1.27u MIN Ni (SEE NOTE 13) |
| XXXX-4YYHLF | |
| XXXX-5YY | 15u"/0.38u MIN (SEE NOTE 12) OVER 50u"/1.27u MIN Ni |
| XXXX-6YY | 30u"/0.76u MIN (SEE NOTE 12) OVER 50u"/1.27u MIN Ni |
| XXXX-7YY | 30u"/0.76u MIN (SEE NOTE 12) OVER 50u"/1.27u MIN Ni |
| XXXX-8YY | 15u"/0.38u MIN (SEE NOTE 12) OVER 50u"/1.27u MIN Ni |
| XXXX-9YY | 15u"/0.38u MIN (SEE NOTE 12) OVER 50u"/1.27u MIN Ni |
| XXXX-0YY | 30u"/0.76u MIN (SEE NOTE 12) OVER 50u"/1.27u MIN Ni |

NOTES

1. PART NUMBER OPTIONS:

PIN PLATING CODES (SEE ABOVE)

HIGH TEMP. MATERIAL:

FOR HIGH-TEMPERATURE APPLICATIONS, SPECIFY AN "H" AT THE END OF THE PART NUMBER, AND PCT WILL BE SUPPLIED.

NUMBER OF POSITION:

ANY NUMBER OF POSITIONS FROM 2 THRU 36.

PACKAGING:

PACKAGED IN POLY BAGS.

EIGHT DIGIT PART NUMBERS FOLLOWED BY A "T" ARE PACKAGED IN TUBES. SEE SPECIFIC PART NUMBERS FOR AVAILABILITY.

EIGHT DIGIT PART NUMBERS FOLLOWED BY A "A" ARE PACKAGED IN TAPE AND REEL WITH PICKUP CAPS.

LEAD FREE:

ADD "HLF" SUFFIX AT THE END OF PART NUMBER FOR LEAD FREE OPTION, NOT AVAILABLE FOR -5YY,-5YYH,-6YY & -6YYH.

2. BODY MATERIAL:

MANUFACTURER'S OPTION OF NYLON OR PCT, GLASS FIBER REINFORCED, FLAME RETARDENT PER UL-94V-0.

COLOR: BLACK. OR MINERAL FILLED LCP, COLOR BLACK FLAME RETARDENT PER UL-94V-0.

PART NUMBERS WITH "H" SUFFIX WILL WITHSTAND EXPOSURE TO 260° PEAK TEMPERATURE FOR 20 SECONDS IN WAVE SOLDER, INFRA-RED OR VAPOR PHASE SOLDER PROCESS.

PART NUMBERS WITHOUT "H" SUFFIX WILL WITHSTAND EXPOSURE TO 260° PEAK TEMPERATURE FOR WAVE SOLDER PROCESS.

3. PIN MATERIAL: PHOS-BRONZE.

4. MEASURED WITH PART IN RESTRAINED CONDITION.

5. TWO SIDES OF PIN TIPS NOT PLATED. TYPICAL BOTH ENDS.

6. 2LBS/0.9KG MIN PIN RETENTION IN EITHER DIRECTION.

7. ±.010/0.25 TOL APPLIES TO ALL 'G' TAILS EXCEPT INDICATED PARTS ON TABLE WHERE +.010/0.25 -.000/0.00 APPLIES.

8. DETAIL N DIMENSIONS APPLY TO 2 POSITION PARTS ONLY

9. SECTION R-R DIMENSIONS ONLY APPLY TO RETENTION. PIN POSITIONS FOR 3 POSITION PARTS AND LARGER. RETENTION PIN POSITIONS LOCATED AT MANUFACTURER'S OPTION.

10. 5LB/2.3KG MAX INSERTION FORCE AND .25LB/.1KG MIN RETENTION FORCE PER RETENTIVE PIN USING .062/1.57 THICK CIRCUIT BOARDS AND RECOMMENDED HOLE PATTERN.

11. THESE PRODUCTS MEETS EUROPEAN UNION DIRECTIVES AND OTHER COUNTRY REGULATION AS DESCRIBED IN GS-22-008.

12. PLATING OPTIONS:
PERFORMANCE PLATING WILL BE EITHER GOLD OR GXT ON POST OR TAIL, OPTIONALLY (78~295u"/2~7.5u) TIN ON TAIL.

13."THIS PRODUCT HAS 100% TIN PLATING IN THE INTERFACE AND HAS NOT BEEN TESTED FOR WHISKER GROWTH IN ALL INTERCONNECT ENVIRONMENTS."

| | | | | | | | | | |
|-------------|----------|--|----|--|--------|----------------|-----------|----------------------------|---|
| mat'l. code | | surface ISO 1302 ✓ ISO 406 ISO 1101 | | tolerance tolerances unless otherwise specified | | projection | | product family BERGSTIK | |
| ltr | ecn | no | dr | date | angles | linear | INCH/MM | | title |
| AP | | | | | 0±2° | | scale 1:1 | | BERGSTIK II HEADER .100/2.54 SR SELF-RET |
| | | | | | dr | D. WHITING | 4/19/93 | | dwg no |
| | | | | | enr | T.HANNA | 4/19/93 | | sheet 2 of 4 |
| | | | | | chr | T. BREWBAKER | 4/19/93 | | 69190 |
| | | | | | app | T.HANNA | 4/19/93 | | A3 |
| sheet | revision | | | | | | | | type |
| index | sheet | | | | | | | | Product Customer Drawing |

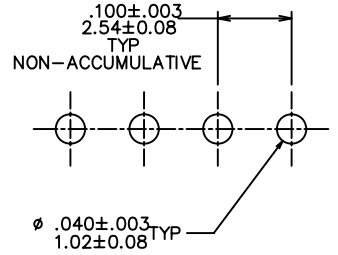

RECOMMENDED HOLE PATTERN

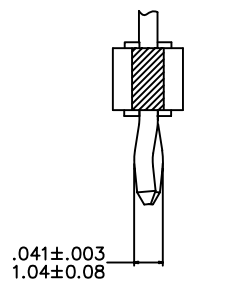

SECTION R-R
NOTE 9

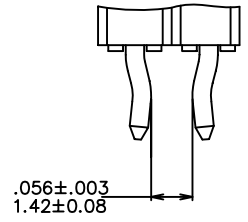
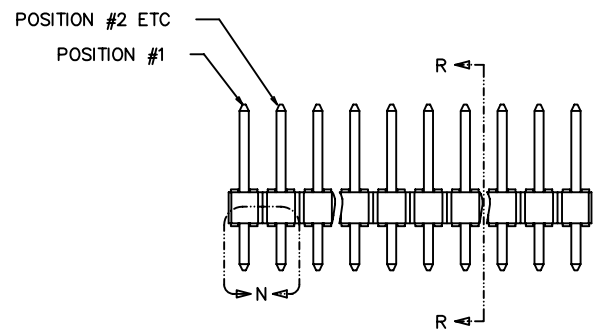

TWO POSITION
DETAIL N
NOTE 8



FCIconnect.com

Copyright FCI

| | | | | | | | | | |
|-------------|----------|-----------------------|----|----------------------------------|--|---------------------------------------|--------------|---|--|
| mat'l. code | | surface ISO 1302 ✓ | | tolerance ISO 406 ISO 1101 | | projection INCH/MM | | product family BERGSTIK | |
| ltr | ecn | no | dr | date | | tolerances unless otherwise specified | | title | |
| AP | | | | | | angles | linear | BERGSTIK II HEADER .100/2.54 SR SELF-RET | |
| | | | | | | 0°±2' | | scale 1:1 | |
| | | | | | | dr | D. WHITING | 4/19/93 | |
| | | | | | | enr | T.HANNA | 4/19/93 | |
| | | | | | | chr | T. BREWBAKER | 4/19/93 | |
| | | | | | | app | T.HANNA | 4/19/93 | |
| sheet | revision | | | | | | | FCJ | |
| index | sheet | | | | | | | dwg no sheet 3 of 4 size 69190 A3 | |
| | | | | | | | | type Product Customer Drawing | |

X-ON Electronics

Largest Supplier of Electrical and Electronic Components

Click to view similar products for [Headers & Wire Housings](#) category:

Click to view products by [Amphenol](#) manufacturer:

Other Similar products are found below :

[95000-104TRLF](#) [10135584-644402LF](#) [DF62W-EP2022PCA](#) [95000-106TRLF](#) [DF62W-2022SCA](#) [DF62W-EP2022PC](#) [2203348](#) [DF62W-2022SC](#) [1084018](#) [1029039](#) [1084017](#) [802-10-012-10-002000](#) [1112640](#) [1112639](#) [000-34000](#) [0009482033](#) [0009507031](#) [57102-S06-03LF](#) [57202-S52-04LF](#) [PCN6-15S-2.5E](#) [0039019024](#) [58102-G61-06LF](#) [582553-1](#) [0009508121](#) [0022285053](#) [0050291907](#) [018731A](#) [LY20-4P-DT1-P1E-BR](#) [02.125.8002.8](#) [60101931](#) [60598-1 \(Cut Strip\)](#) [M1625-3R/100](#) [61062-3](#) [61082-181009](#) [636-1427](#) [638009-1](#) [641938-9](#) [641991-4](#) [644168-1](#) [644827-2](#) [647662-1](#) [65039-019ELF](#) [65817-002LF](#) [65817-015LF](#) [65863-015LF](#) [66207-023LF](#) [67016-026LF](#) [67046-001LF](#) [67095-007LF](#) [68002-116](#)