

Copyright FCI. FCI

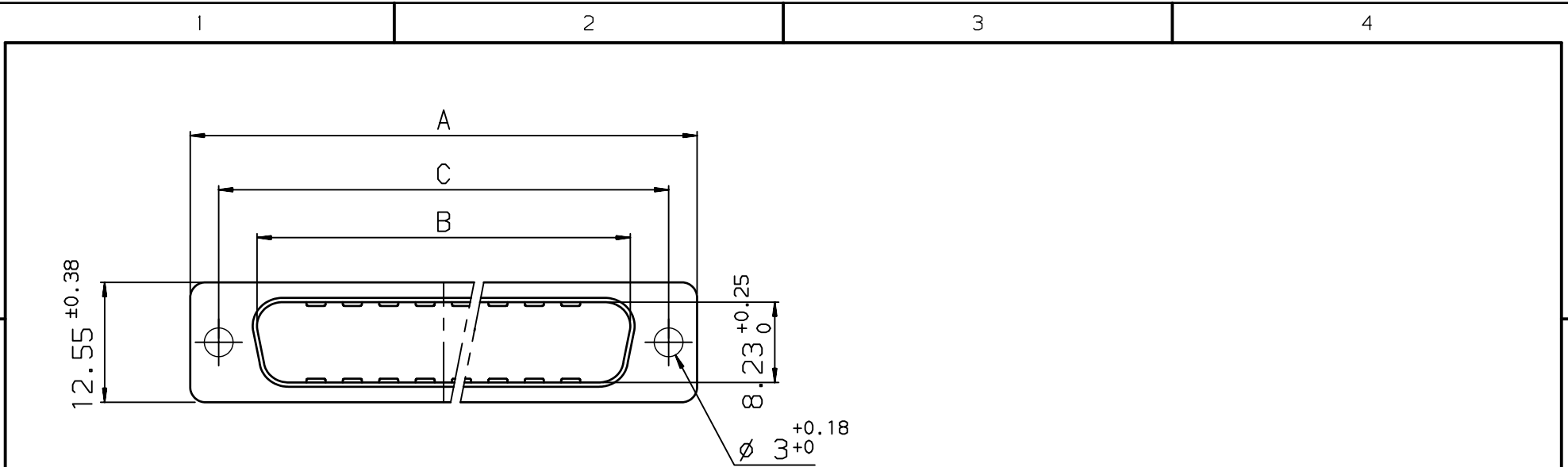

Shell size	Number of contacts	A <sup>+0.76</sup> <sub>0</sub>	B <sup>+0.25</sup> <sub>0</sub>	C ±0.12	F <sup>+0.13</sup> <sub>-0.03</sub>	G	K <sub>maxi</sub>	L <sup>+0.22</sup> <sub>0</sub>	Part number
E	09	30.43	16.79	24.99	4.36	5.90 <sup>+0.15</sup> <sub>0</sub>	1.50	0.80	86553113TLF
A	15	38.76	25.12	33.32	4.36	5.90 <sup>+0.15</sup> <sub>0</sub>	1.50	0.80	86553114TLF
B	25	52.65	38.84	47.04	4.36	5.70 <sup>+0.25</sup> <sub>0</sub>	1.50	0.80	86553115TLF
C	37	68.94	55.30	63.50	4.36	5.70 <sup>+0.25</sup> <sub>0</sub>	1.50	1.00	86553116TLF

**NOTE: RoHS INFORMATIONS**

- The "LF" product meets European union Directives and other country regulations as described in 65-22-008.
- The product is not intended to be exposed to a manufacturing solder process.
- Plating: Sn pure bright over Copper.
- Packaging spec: see 65-14-920.

European Views

www.fciconnect.com		surface ISO 1302 ✓	tolerance std ISO 406 ISO 1101	projection A3	mm
TOLERANCES UNLESS OTHERWISE SPECIFIED					
Dr	GOISNARD	28/06/17	ANGULAR	0.X ±0.1	size A3
Eng	PESSON	2006/01/12	LINEAR	0.XX ±0.1	Scale 3
Chr	LEGARE	2006/01/12	0.XX ±2°	0.XXX ±0.1	ECN LS09-0006
Appr	LEGARE	2006/01/12	Product family	D-SUB	Spec ref -
FCI		title METAL CAPS D SUB ACCESSORIES		dwg no C01-8655-1656	Rev. D
		catalog no	CUSTOMER		sheet 1 of 1

rev	ecn no	dr	date
A	LS05-0123	LGO	2006/01/12
B	LS06-0095	LGO	2006/06/24
C	LS07-0135	MPE	2007/05/11
D	LS09/0006	PCR	2009/01/08
-	-	-	-
-	-	-	-
-	-	-	-

REV F - 2006-04-17

## X-ON Electronics

Largest Supplier of Electrical and Electronic Components

*Click to view similar products for [D-Sub Tools & Hardware](#) category:*

*Click to view products by [Amphenol](#) manufacturer:*

Other Similar products are found below :

[000-01-09-132](#) [000-01-21-132](#) [000-01-31-162](#) [572019-00105-70](#) [000-01-37-162](#) [621-250-113-115](#) [D110550-2](#) [D20418-137](#) [780-518-50SG6-WS](#) [86552009](#) [86553115TLF](#) [86553117TLF](#) [1230032-1](#) [1-5021101-2](#) [15-000050](#) [1589283-4](#) [160-000-005R031](#) [16-000230](#) [160-025-004R031](#) [160-020-209R000](#) [160X10909X](#) [164C03939A](#) [177-505-A-2-2](#) [1-966830-8](#) [21018-6](#) [2-1393560-9](#) [JS-1000](#) [L17D204182M3E](#) [L17D53018](#) [300X10779X](#) [160X10189X](#) [160X10419X](#) [162-000-050R000](#) [21018-5](#) [212561-3](#) [248C21550X](#) [CF15P](#) [D110277](#) [500-008NF1K-01](#) [500-008NF3R3KS-01](#) [500-017M09FN](#) [500-017M15MHN](#) [500-024M1](#) [500-068M3](#) [5-1393561-5](#) [C115373-0001](#) [C115373-0002](#) [3342-4-KIT](#) [K1003](#) [L17D4M68711](#)