

ZONE	REV	SCR NUMBER	DESCRIPTION	BY	DATE	APPROVED
ALL	A	ASSY-7QUL9B.VER01	NEW RELEASE	HCL-GM	04/16/2009	A.ASTBURY
	B	ASSY-868QBB.VER01	ADDED XTALIC PN'S	HCL-GM	06/10/2010	D.SMITH
SHT1 C7 SHT1 D4,B6 SHT1 C4	C	DCOY-9X5MQR.VER01	REMOVED N AND Z LETTER FROM POL GUIDE TABLE. UPDATED PIN STYLE TABLE. ADDED NOTE 11. ADDED 1.5mm SIGNAL WIPE.	HCL-RM	06/10/2015	D.COVEY
	D	DCOY-A84GPZ.VER01	UPDATED PART MARKING REQUIREMENTS IN NOTES	HCL-SD	04/05/2016	D.COVEY

9 5 1 - 4 X 0 C - X X X

XCede BACKPLANE MODULE MALE STANDARD LOAD

4 PAIR

6-POSITION

PLATING	
LETTER	DESCRIPTION
B	Ni SULFAMATE, STANDARD GOLD, LEADE
C	Ni SULFAMATE, HIGH GOLD, LEADED
D	Ni SULFAMATE, STANDARD GOLD, LEAD-FREE
E	Ni SULFAMATE, HIGH GOLD, LEAD-FREE
F	NANO Ni, STANDARD GOLD, LEADED
G	NANO Ni, HIGH GOLD, LEADED
H	NANO Ni, STANDARD GOLD, LEAD-FREE
J	NANO Ni, HIGH GOLD, LEAD-FREE

NUMBER	PIN STYLE, HEIGHT
0	GUIDE PIN MACHINED, 31.6mm / NONE
1	GUIDE PIN MACHINED, 31.6mm
4	GUIDE PIN MACHINED, 25.7mm
5	GUIDE PIN MACHINED, 25.7mm

NUMBER/LETTER	SIGNAL & LG. GROUND WIPE LENGTH, COMPLIANT PIN SIZE
1	2 mm WIPE SIGNAL, 4 mm WIPE LG GND, Ø.0217" DRILL
2	3 mm WIPE SIGNAL, 4 mm WIPE LG GND, Ø.0217" DRILL
3	2 mm WIPE SIGNAL, 4 mm WIPE LG GND, Ø.0177" DRILL
4	3 mm WIPE SIGNAL, 4 mm WIPE LG GND, Ø.0177" DRILL
5	2 mm WIPE SIGNAL, 3 mm WIPE LG GND, Ø.0217" DRILL
6	3 mm WIPE SIGNAL, 3 mm WIPE LG GND, Ø.0217" DRILL
7	2 mm WIPE SIGNAL, 3 mm WIPE LG GND, Ø.0177" DRILL
8	3 mm WIPE SIGNAL, 3 mm WIPE LG GND, Ø.0177" DRILL
C	1.5 mm WIPE SIGNAL, 4 mm WIPE LG GND, Ø.0217" DRILL
D	1.5 mm WIPE SIGNAL, 3 mm WIPE LG GND, Ø.0217" DRILL
E	1.5 mm WIPE SIGNAL, 4 mm WIPE LG GND, Ø.0177" DRILL
F	1.5 mm WIPE SIGNAL, 3 mm WIPE LG GND, Ø.0177" DRILL

	LETTER								
LEFT POLARIZING GUIDANCE (SEE SHEET 3)	J (NO KEY)	A	B	C	D	E	F	G	H
RIGHT POLARIZING GUIDANCE (SEE SHEET 4)	Y (NO KEY)	P	Q	R	S	T	U	V	W
OPEN (SEE SHEET 2)	O (ZERO)								
LEFT WALL (SEE SHEET 5)	L								
RIGHT WALL (SEE SHEET 6)	M								
TWO WALL (SEE SHEET 7)	1								

NOTES:

- REFER TO TB-2150 FOR XCede PRODUCT SPECIFICATIONS.
- NOTCH DESIGNATES "ROW A" SIDE OF SHROUD. NOTCH FEATURE ON OPPOSITE SIDE FROM PART MARKING.
- SEE TB-2325 FOR PART MARKING REQUIREMENTS.
- PLATING THICKNESS OF SIGNAL CONTACT AND GROUND CONTACT IS DETERMINED BY PLATING CODE, SEE PART NUMBER TREE SHEET 1.
- REPAIR PROCEDURE FOR MODULE, SEE TB-2210.
- SEE TB-2149 FOR ROUTING GUIDELINES & PTH REQ'S.
- SEE DOC C190-1001-000 FOR TOOLING KEEPOUT ZONES.
- BACKPLANE DATUM REFERENCE.
- OPTIONAL HOLE/MOUNTING SCREW LOCATION FOR GROUNDED PIN OR ADDITIONAL GUIDE PIN SUPPORT,

REFER TO TB-2211 FOR PROPER GUIDE PIN SELECTION AND DRAWING C-942-4010-000 FOR OPTIONAL HOLE DETAILS.

ONLY APPLIES FOR MACHINED GUIDE PIN APPLICATIONS.

10. DIMENSIONS APPLY FOR BOTH COMPLIANT PIN SIZES.

GUIDE PIN OPTIONS "1" AND "5" ORIGINALLY CALLED FOR ROLLED GUIDE PINS, WHICH HAVE BEEN REPLACED BY MACHINED ONES. ONLY LEGACY 951 SERIES MODULES WILL USE THESE OPTIONS.

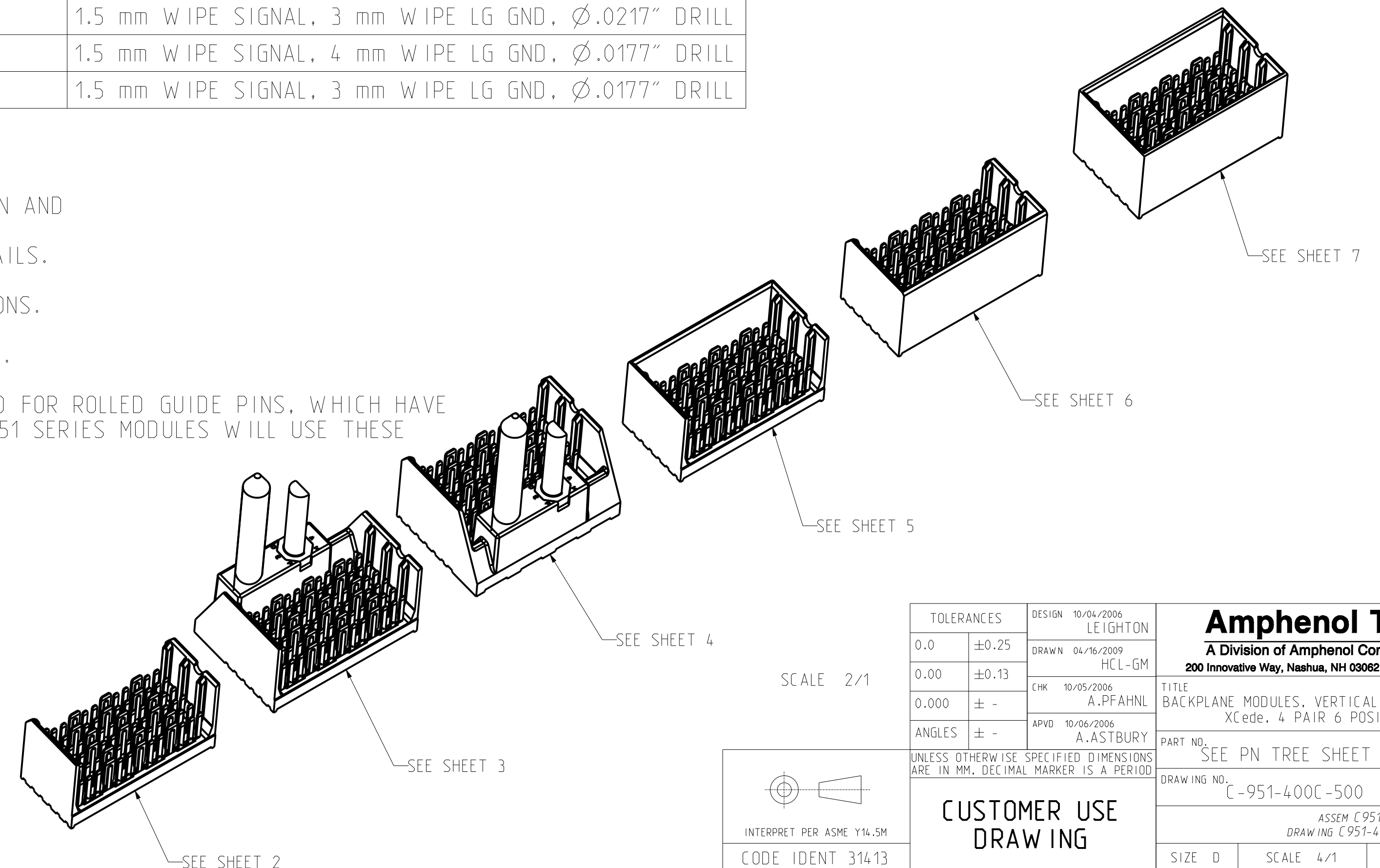

SCALE 2/1

TOLERANCES		DESIGN	10/04/2006	Amphenol TCS	
0.0	±0.25	LEIGHTON		A Division of Amphenol Corporation	
0.00	±0.13	HCL-GM		200 Innovative Way, Nashua, NH 03082 803.879.3000	
0.000	± -	A.PFAHNL		TITLE BACKPLANE MODULES, VERTICAL MALE HEADER XCede, 4 PAIR 6 POSITION	
ANGLES	± -	A.ASTBURY		PART NO. SEE PN TREE SHEET 1	
UNLESS OTHERWISE SPECIFIED DIMENSIONS ARE IN MM. DECIMAL MARKER IS A PERIOD		DRAWING NO.		REV	
INTERPRET PER ASME Y14.5M		C-951-400C-500		D	
CODE IDENT 31413		CUSTOMER USE DRAWING		ASSEM C951-4-BP4 14.7 DRAWING C951-400C-500 C.5	
SIZE	D	SCALE	4/1	SHEET 1 OF 8	

C-951-400C-500

SH 1 REV D

ZONE	REV	SCR NUMBER	DESCRIPTION	BY	DATE	APPROVED
			SEE SHEET 1			

DATUMS X\_BP AND Y\_BP INTERSECT THE SIGNAL A1 VIA ON BACKPLANE

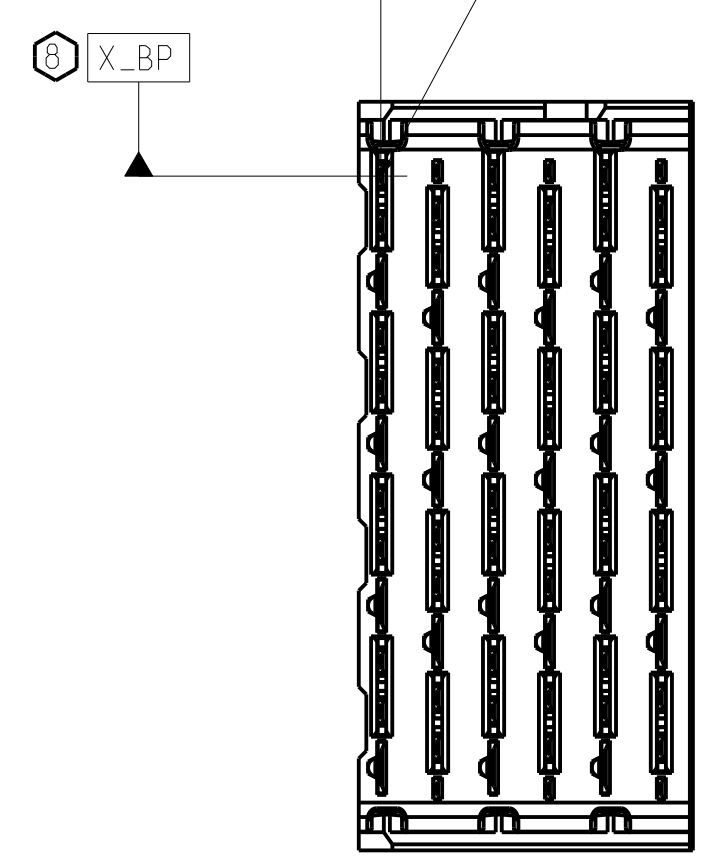

**OPEN BACKPLANE MODULE DIMENSION**

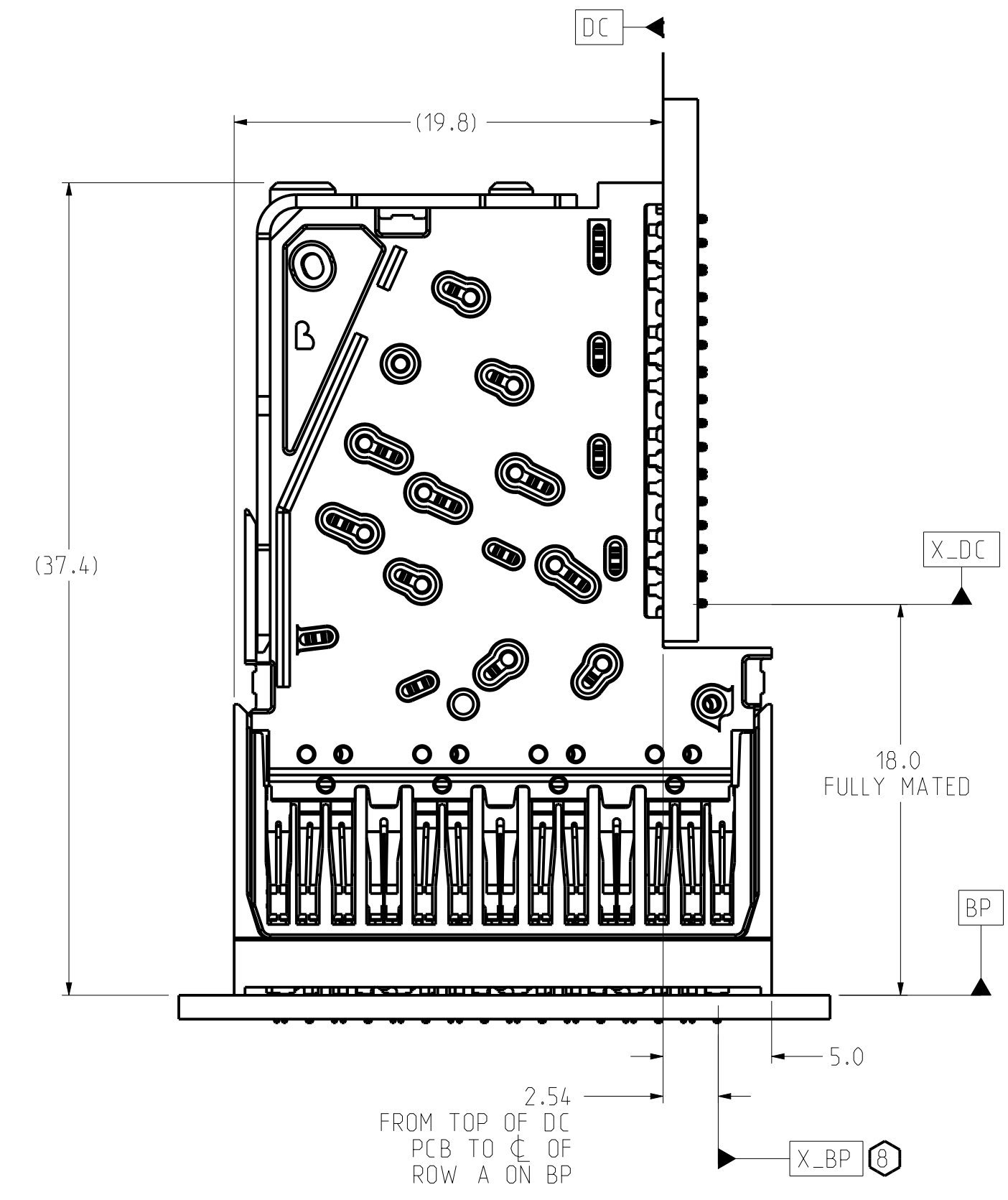

CONNECTOR REFERENCE SCALE 4/1

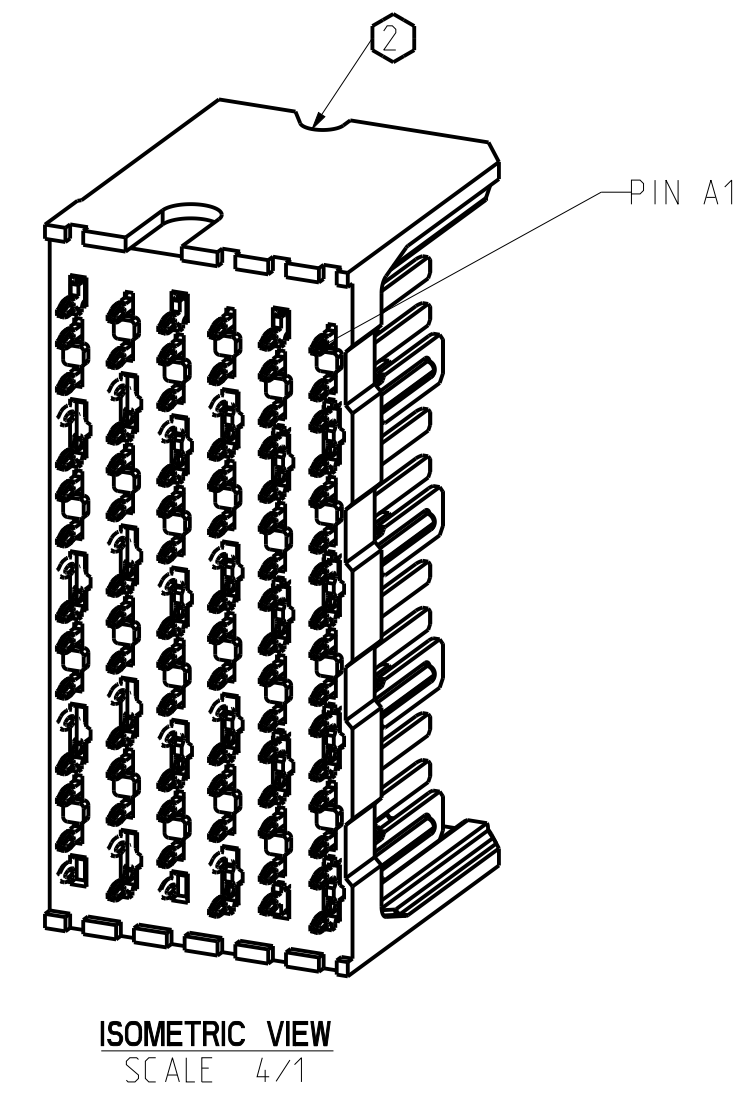
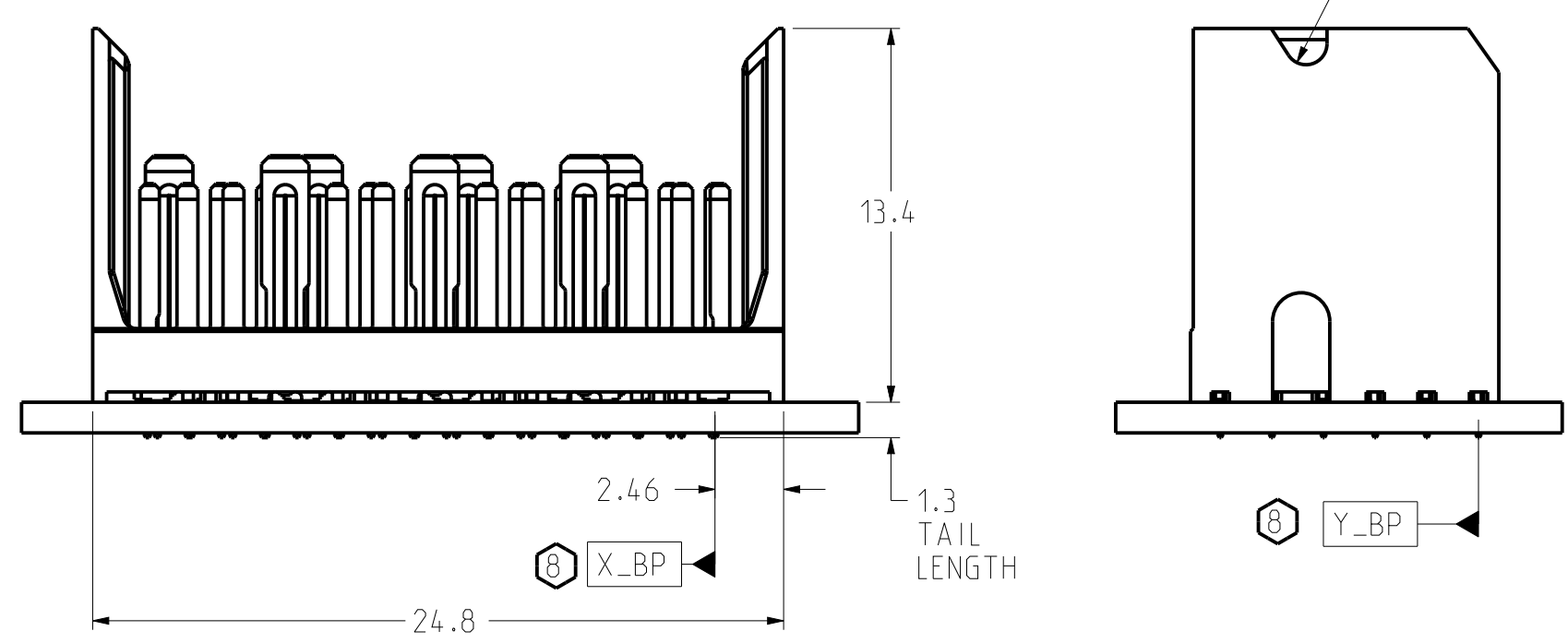
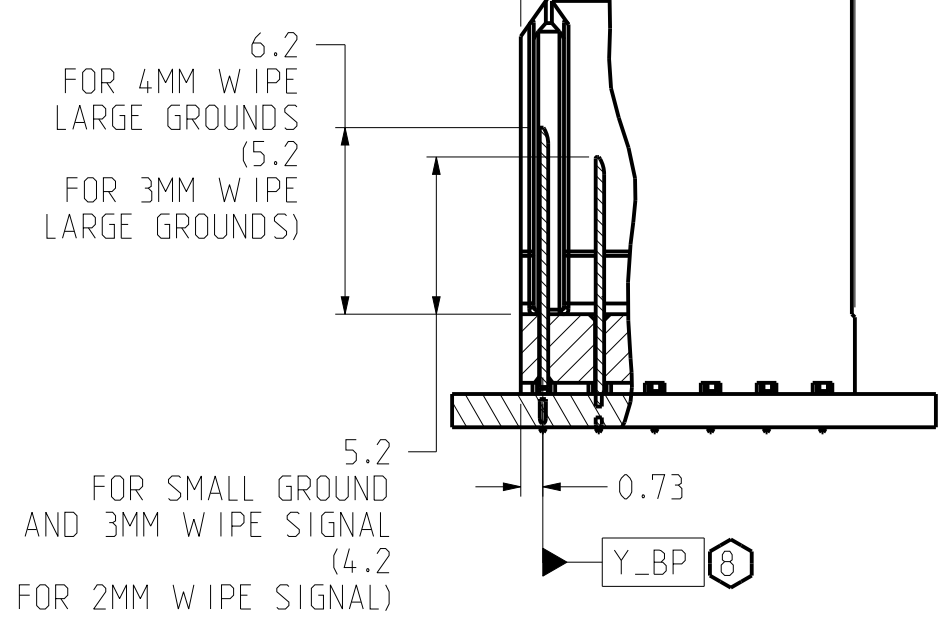

ISOMETRIC VIEW SCALE 4/1

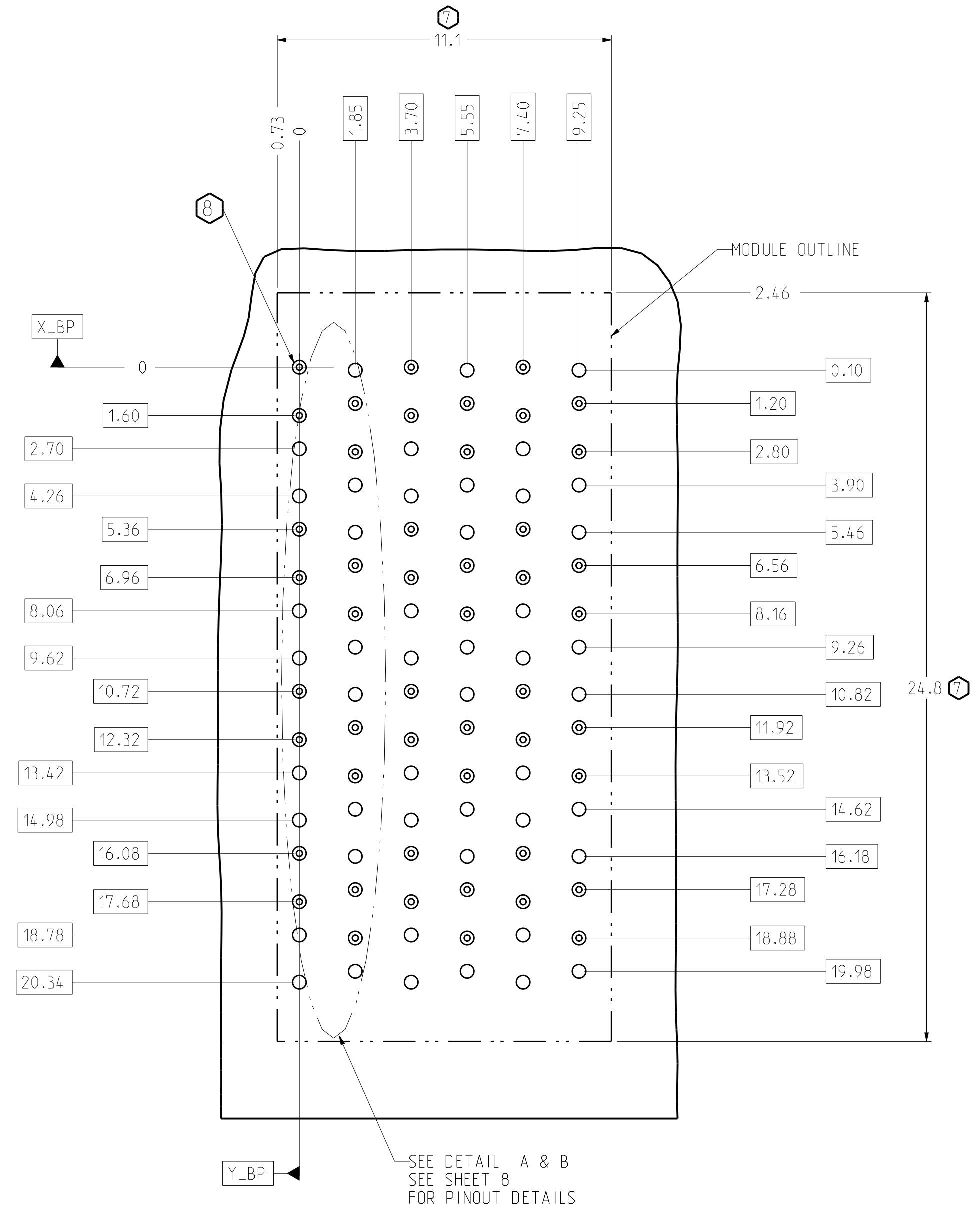

BP HOLE PATTERN COMPONENT SIDE SCALE 8/1

**OPEN BACKPLANE FOOTPRINT**

TOLERANCES	DESIGN	DATE
0.0 ±0.25	10/04/2006	LEIGHTON
0.00 ±0.13	04/16/2009	HCL-GM
0.000 ± -	10/05/2006	A.PFAHNL
ANGLES ± 3°	10/06/2006	A.ASTBURY

**Amphenol TCS**  
A Division of Amphenol Corporation  
200 Innovative Way, Nashua, NH 03082 603.879.3000

TITLE: BACKPLANE MODULES, VERTICAL MALE HEADER  
XCede, 4 PAIR 6 POSITION

PART NO. SEE PN TREE SHEET 1  
REV N/A

DRAWING NO. C-951-400C-500  
REV D

ASSEM C951-4-BP4 14.7  
DRAWING C951-400C-500 C.5

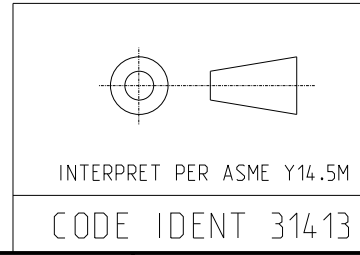

CUSTOMER USE DRAWING

SIZE D SCALE 4/1 SHEET 2 OF 8

DRW NO. C-951-400C-500

SH 2 REV D

ZONE	REV	SCR NUMBER	DESCRIPTION	BY	DATE	APPROVED
			SEE SHEET 1			

DATUMS X\_BP AND Y\_BP INTERSECT THE SIGNAL A1 VIA ON BACKPLANE

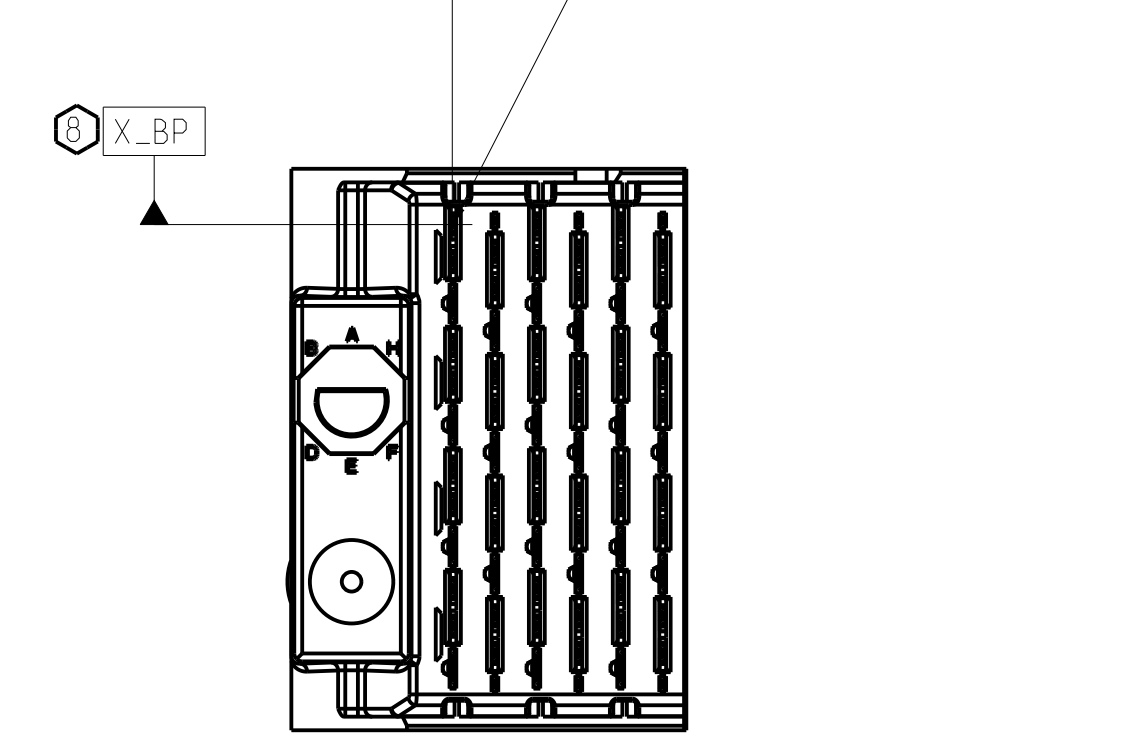

**LEFT POLARIZING/GUIDE BACKPLANE MODULE DIMENSION**

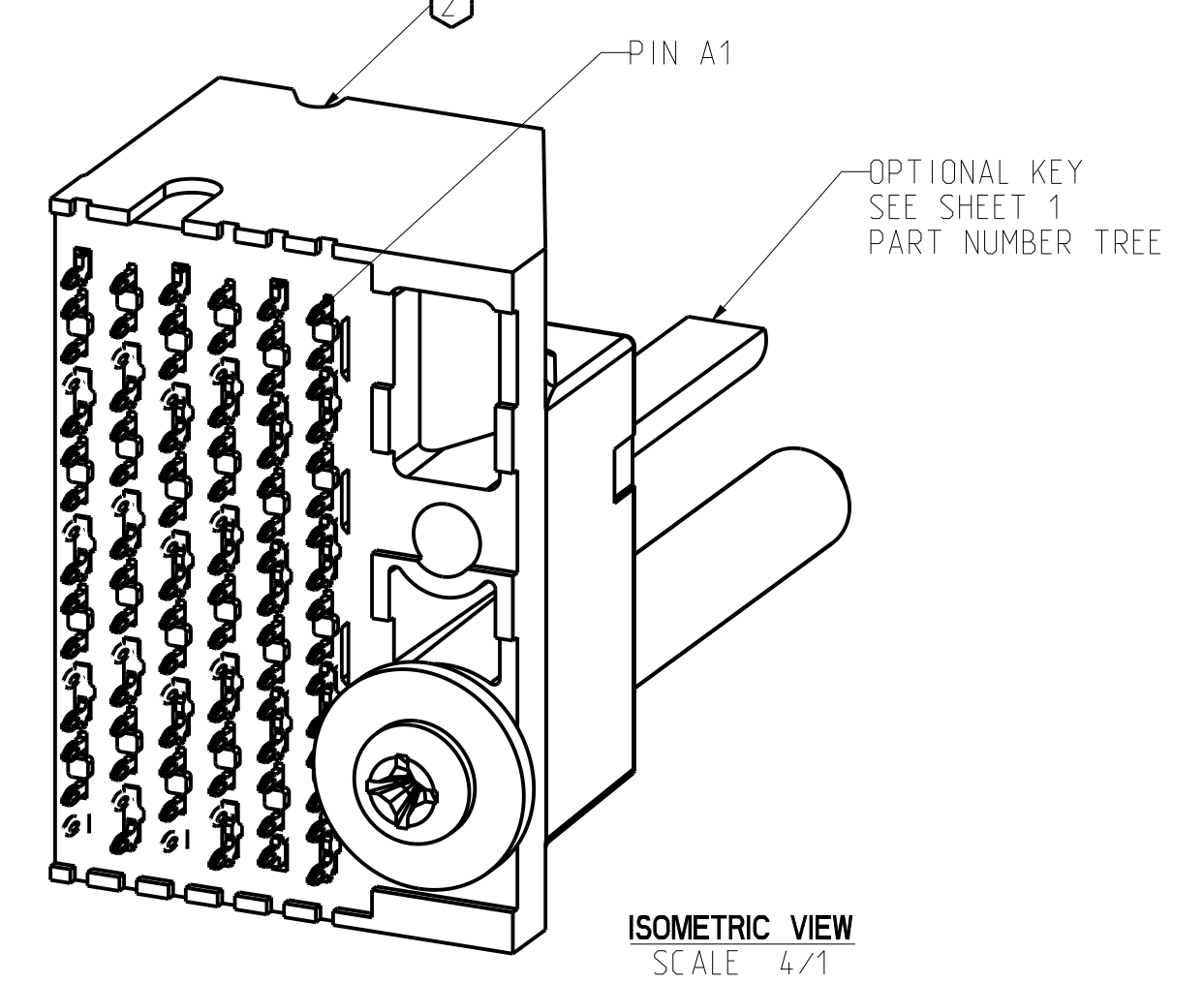
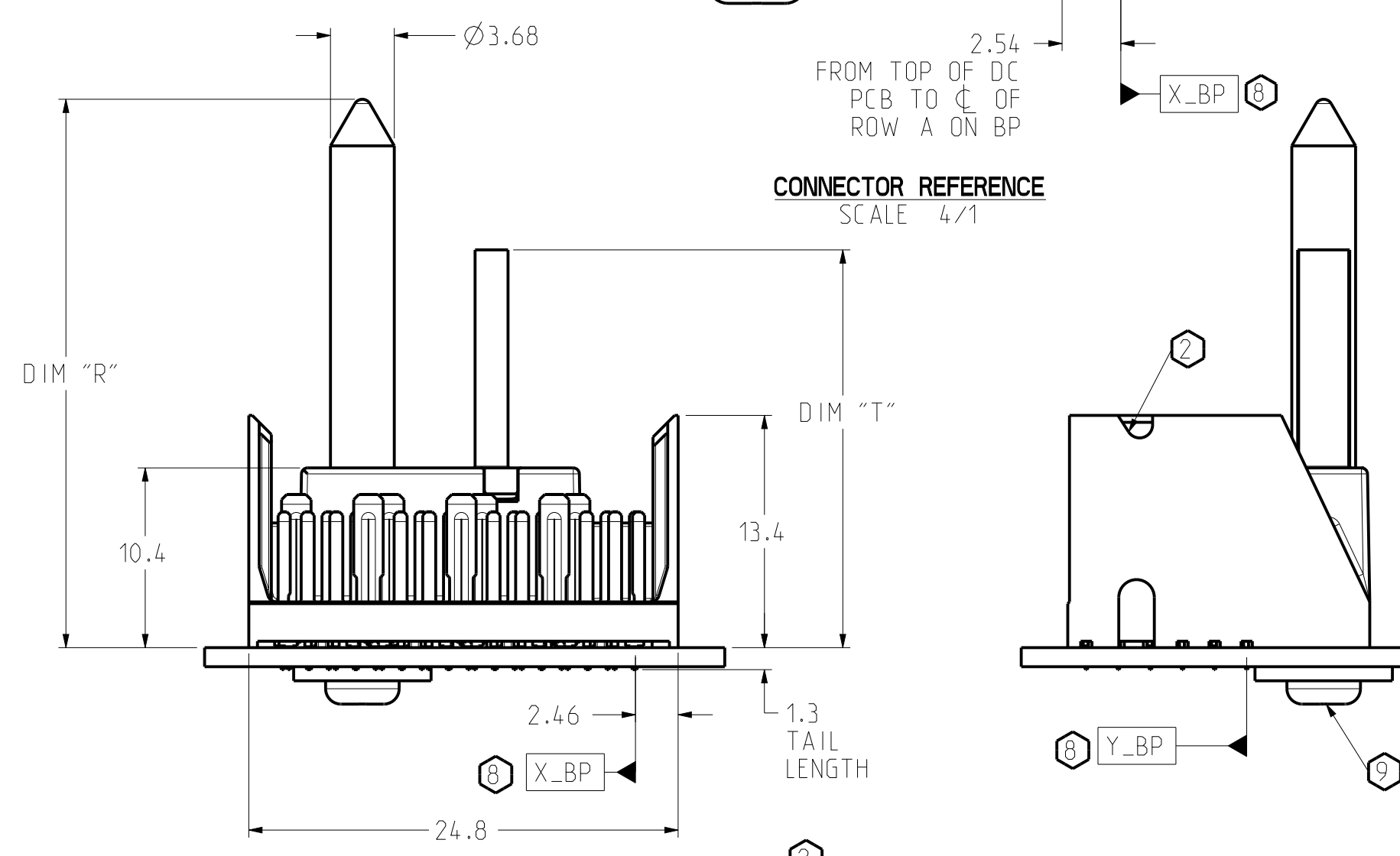
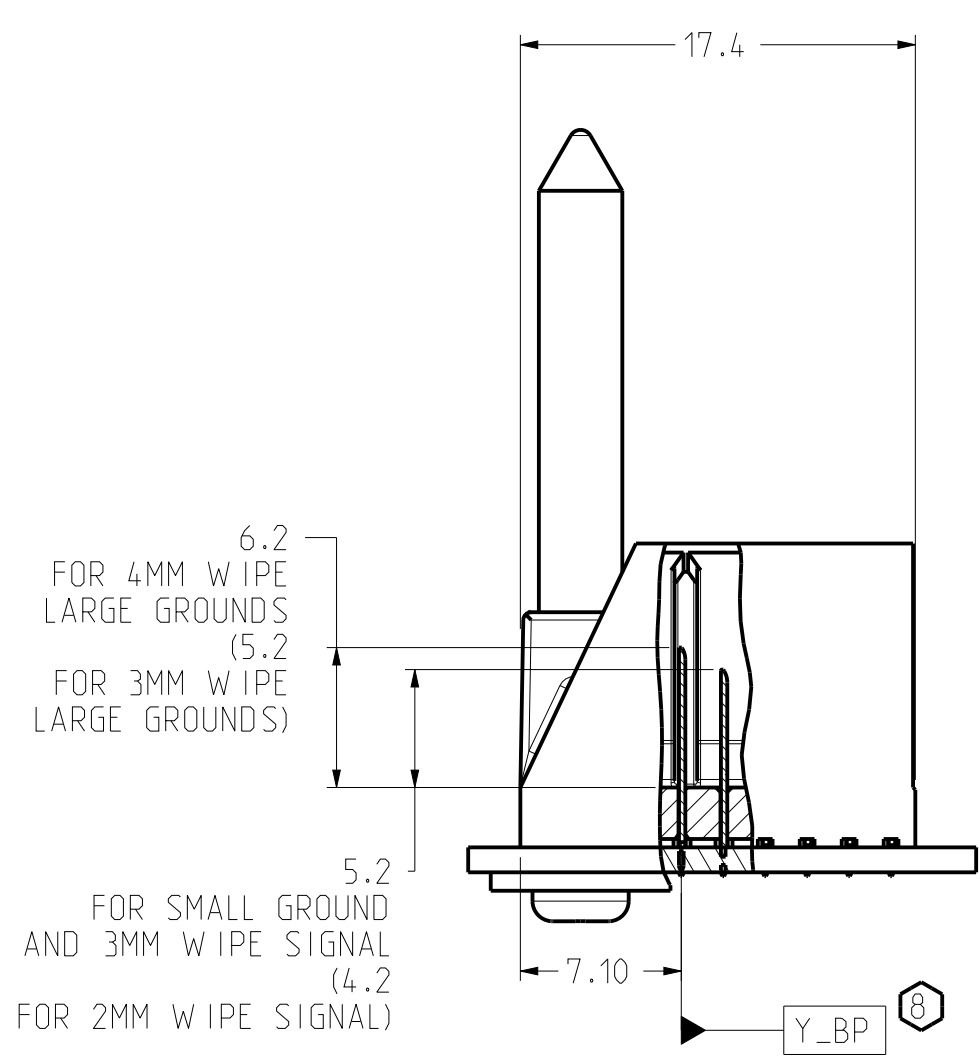
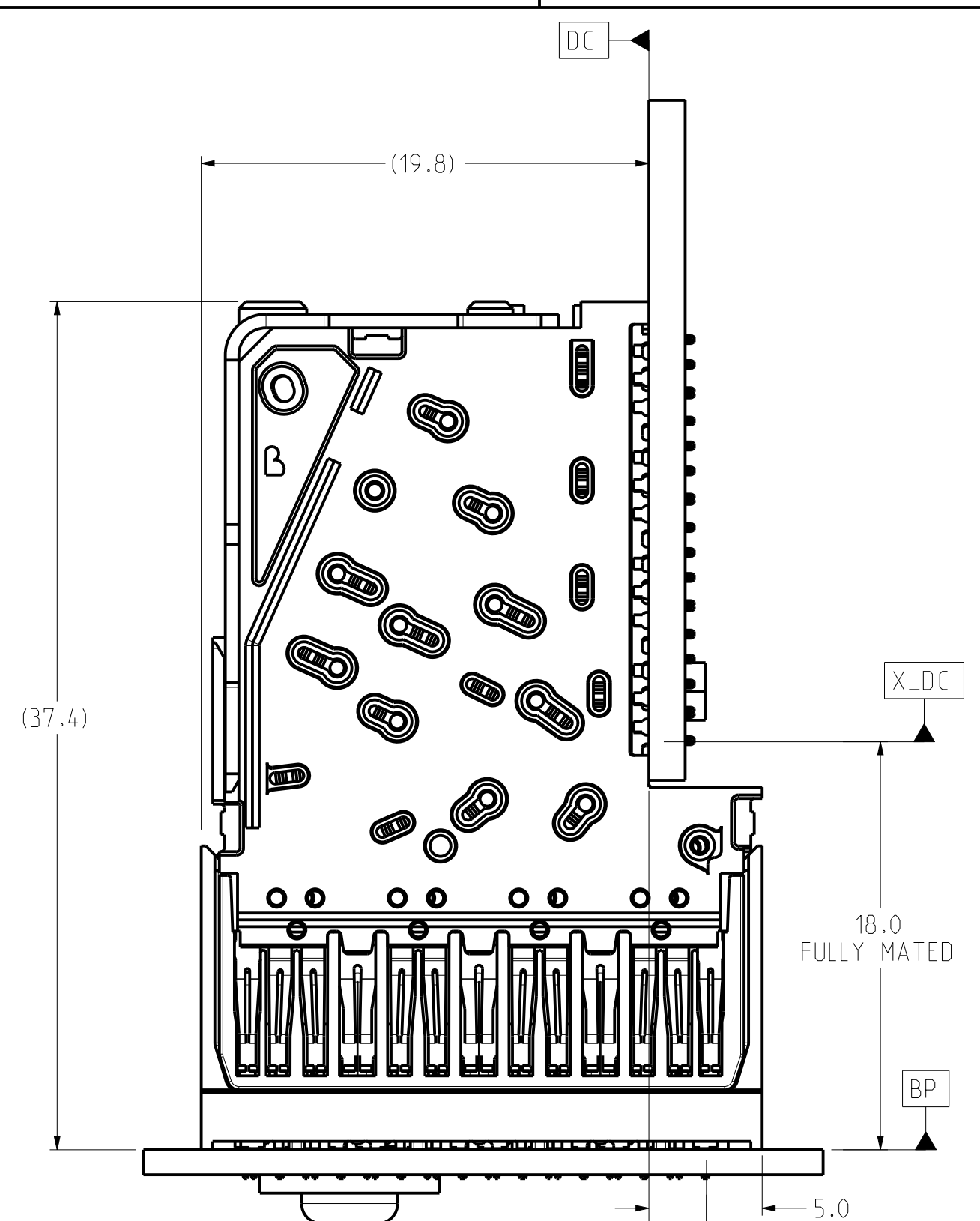

PART NUMBER	DIM "R"	DIM "T"
951-4X0C-X 0 X 951-4X0C-X 1 X	31.6	23.0
951-4X0C-X 4 X 951-4X0C-X 5 X	25.7	20.2

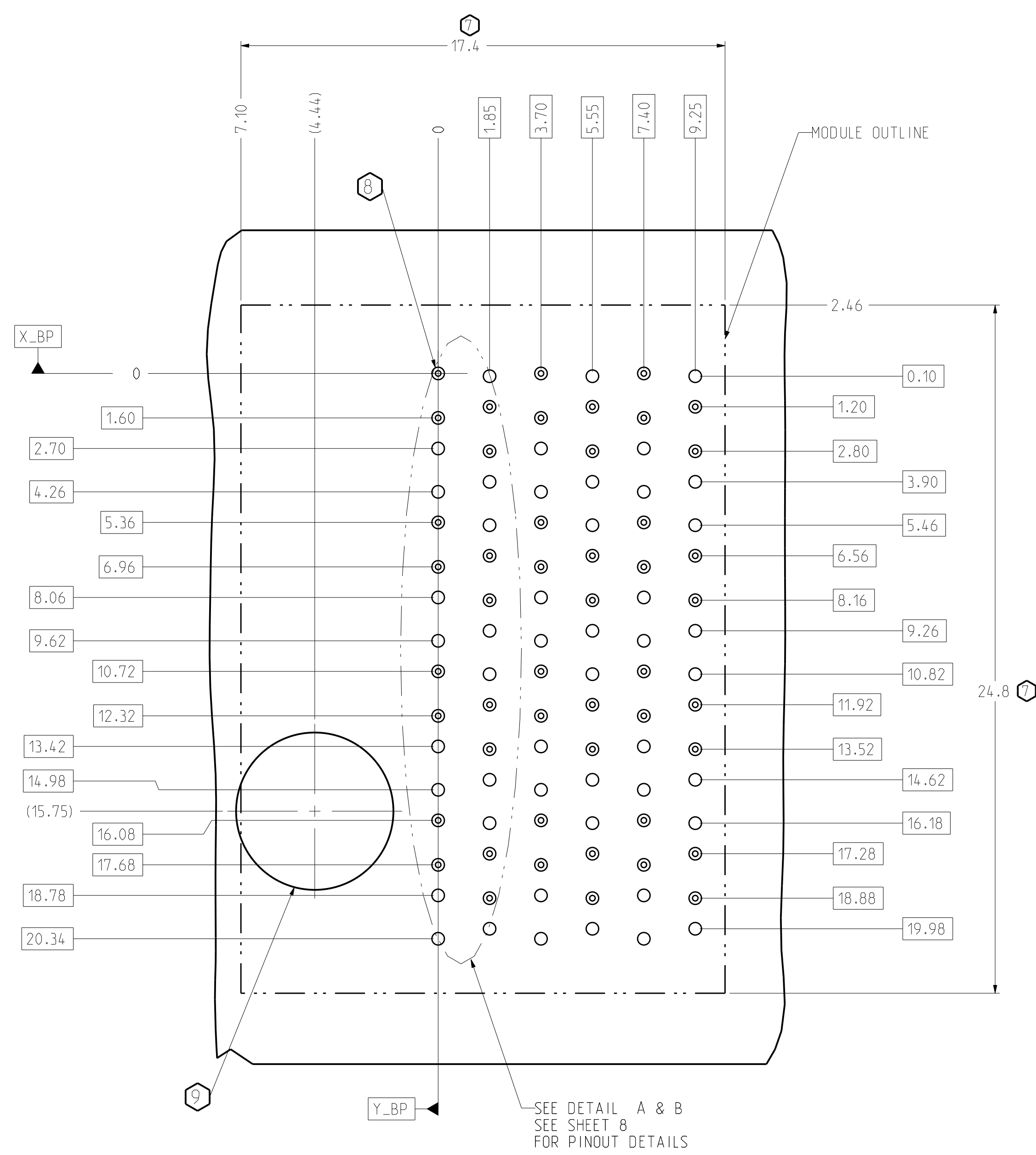

**LEFT POLARIZING/GUIDE BACKPLANE FOOTPRINT**

BP HOLE PATTERN COMPONENT SIDE SCALE 8/1

TOLERANCES	DESIGN	DATE
0.0 ±0.25	10/04/2006	LEIGHTON
0.00 ±0.13	04/16/2009	HCL-GM
0.000 ± -	10/05/2006	A.PFAHNL
ANGLES ± 3°	10/06/2006	A.ASTBURY

**Amphenol TCS**  
A Division of Amphenol Corporation  
200 Innovative Way, Nashua, NH 03082 603.879.3000

TITLE: BACKPLANE MODULES, VERTICAL MALE HEADER  
XCede, 4 PAIR 6 POSITION

PART NO. SEE PN TREE SHEET 1  
DRAWING NO. C-951-400C-500

INTERPRET PER ASME Y14.5M  
CODE IDENT 31413

CUSTOMER USE DRAWING

ASSEM C951-4-BP4 14.7  
DRAWING C951-400C-500 C.5

SIZE D SCALE 4/1 SHEET 3 OF 8

C-951-400C-500

SH 3 REV D

ZONE	REV	SCR NUMBER	DESCRIPTION	BY	DATE	APPROVED
			SEE SHEET 1			

DATUMS X\_BP AND Y\_BP INTERSECT THE SIGNAL A1 VIA ON BACKPLANE

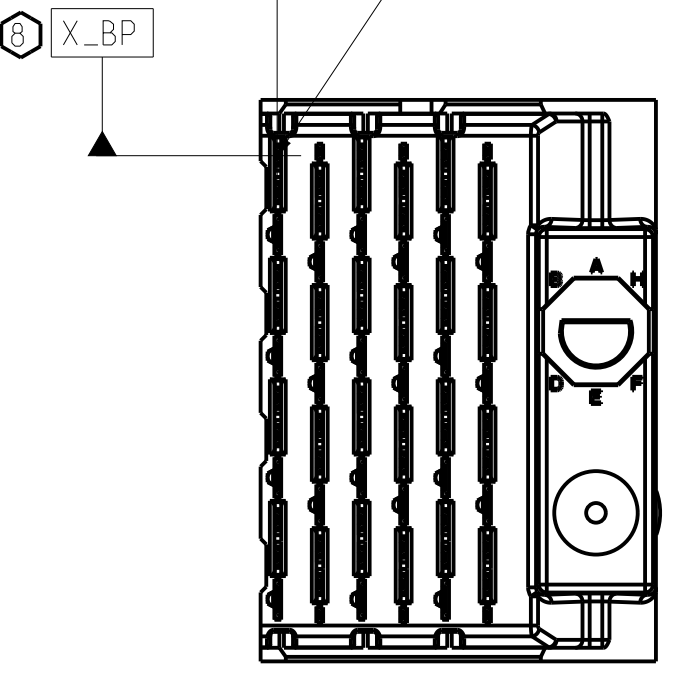

**RIGHT POLARIZING/GUIDE BACKPLANE MODULE DIMENSION**

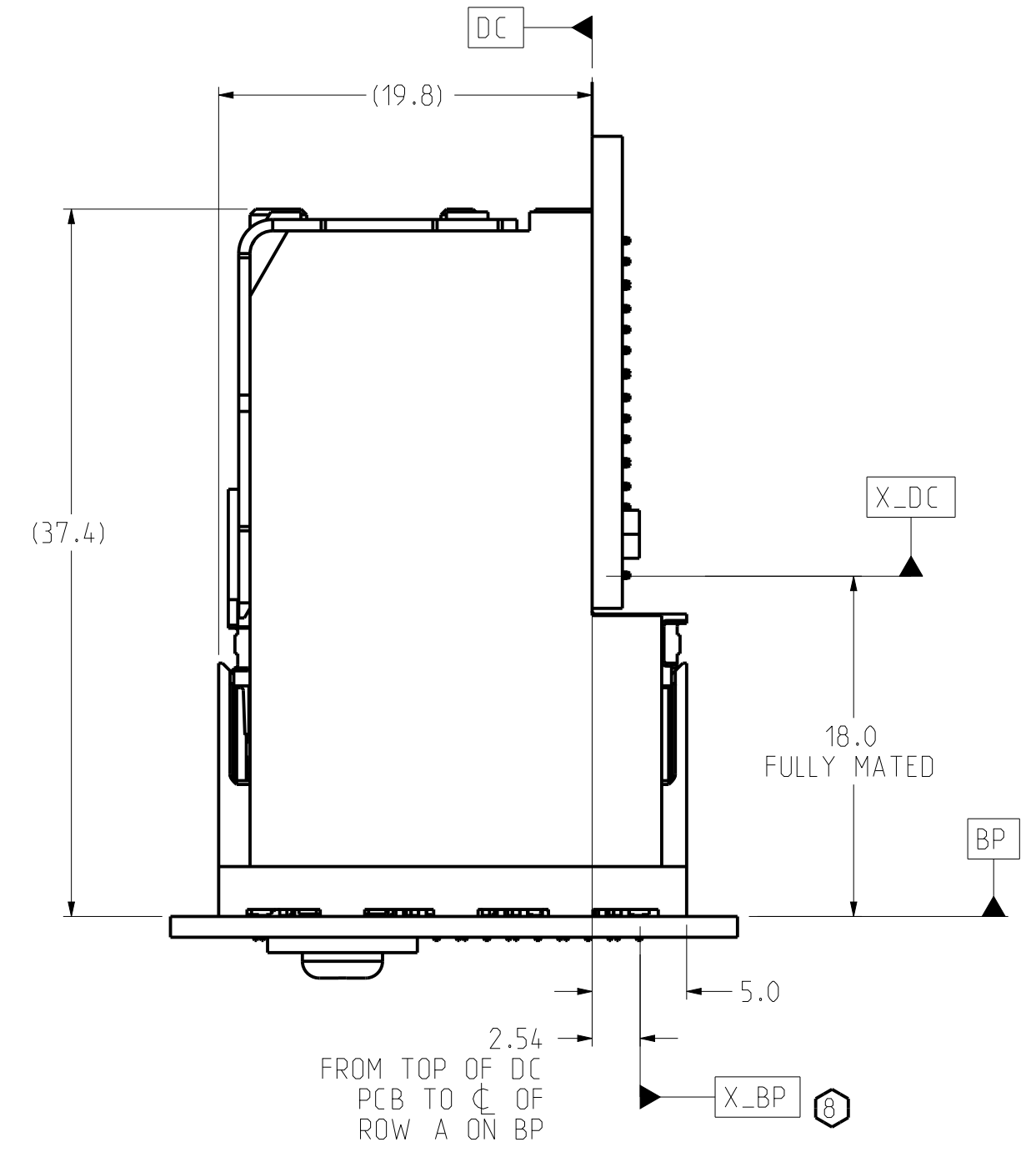

CONNECTOR REFERENCE SCALE 3/1

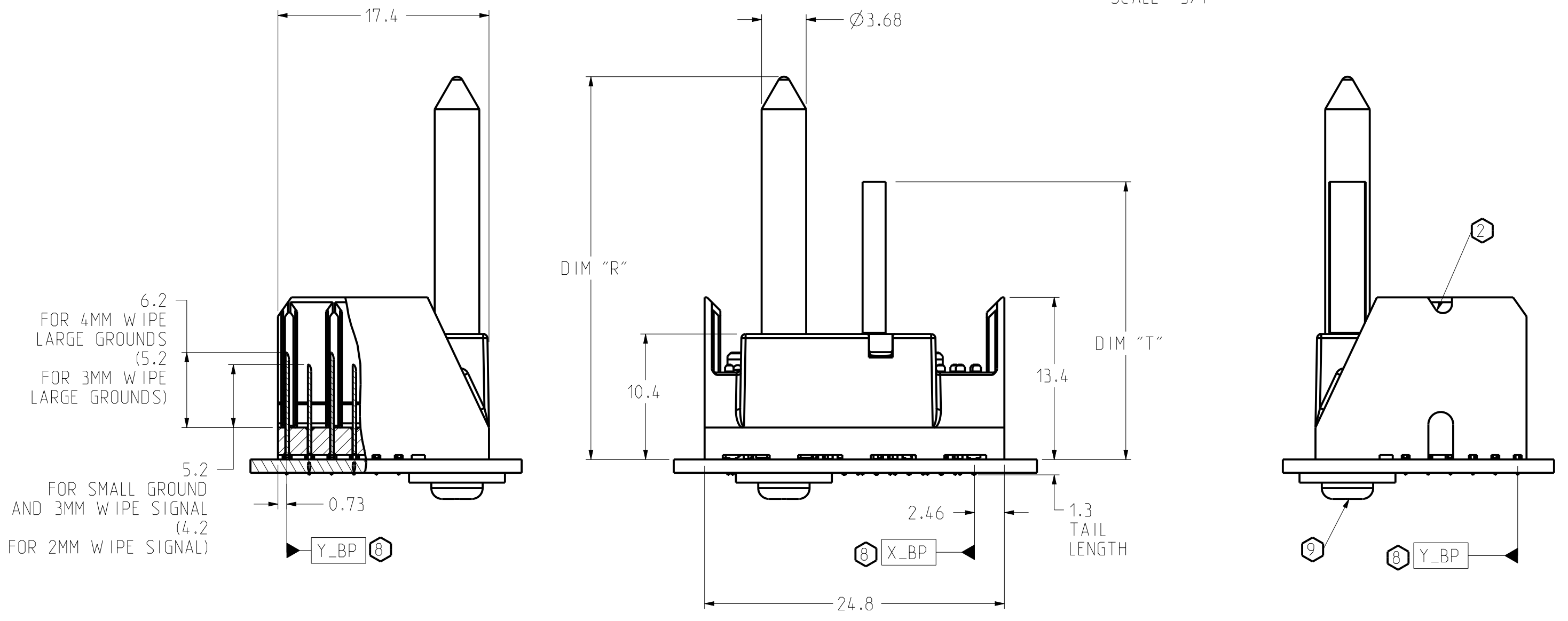

PART NUMBER	DIM "R"	DIM "T"
951-4X0C-X 0 X 951-4X0C-X 1 X	31.6	23.0
951-4X0C-X 4 X 951-4X0C-X 5 X	25.7	20.2

OPTIONAL KEY - SEE SHEET 1 PART NUMBER TREE

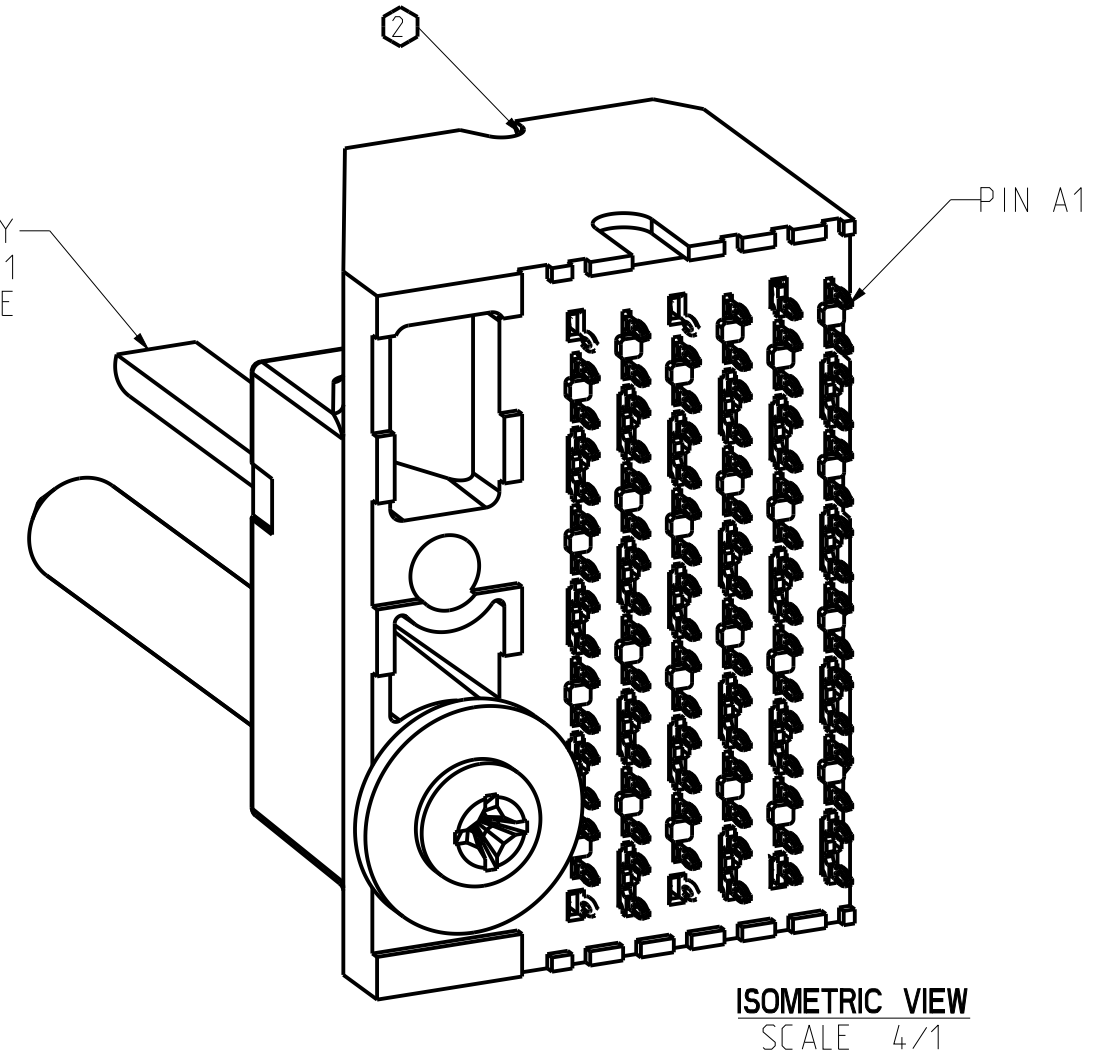

ISOMETRIC VIEW SCALE 4/1

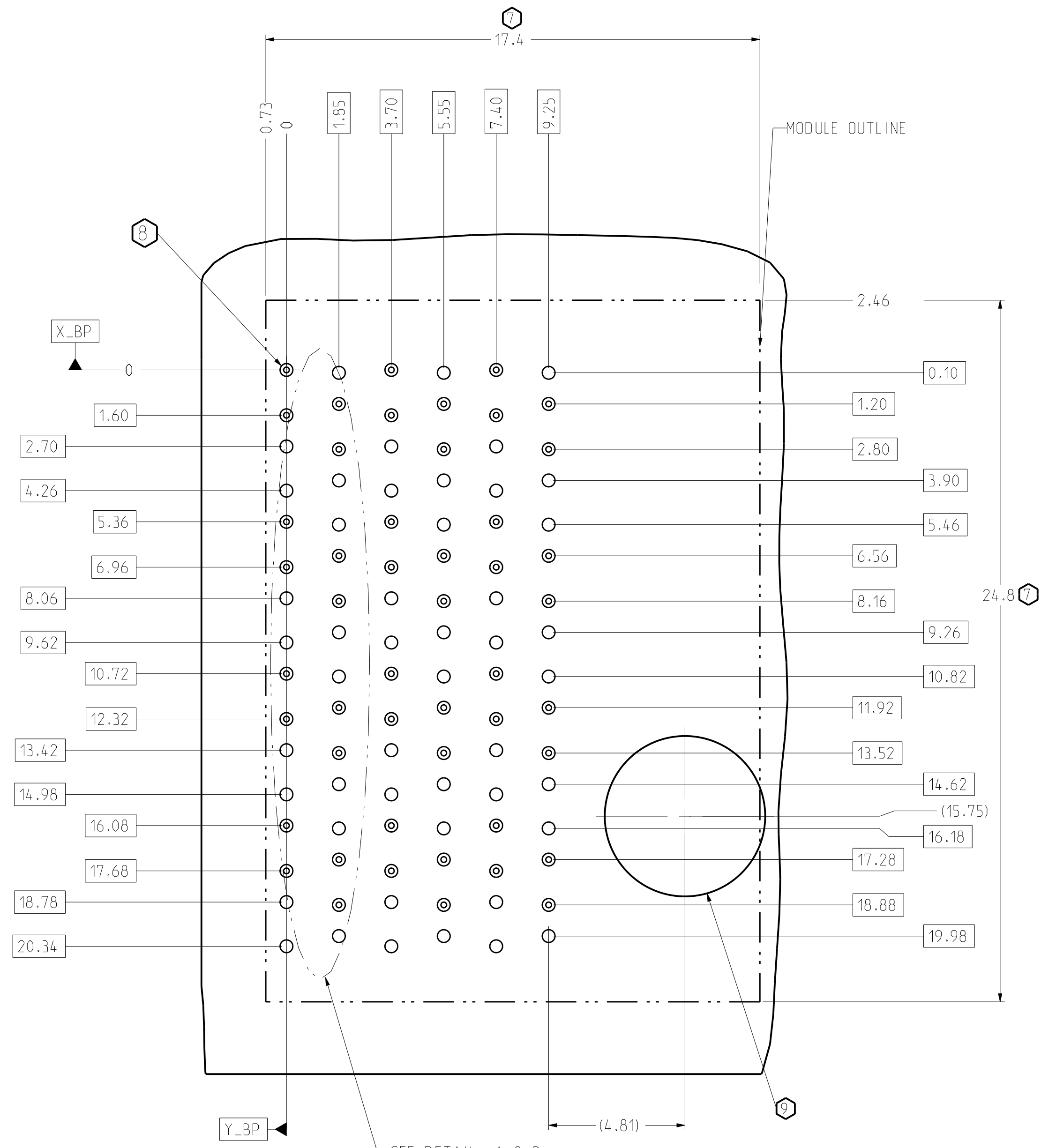

SEE DETAIL A & B SEE SHEET 8 FOR PINOUT DETAILS

BP HOLE PATTERN COMPONENT SIDE SCALE 8/1

**RIGHT POLARIZING/GUIDE BACKPLANE FOOTPRINT**

INTERPRET PER ASME Y14.5M  
CODE IDENT 31413

TOLERANCES	DESIGN 10/04/2006 LEIGHTON	<p><b>Amphenol TCS</b> A Division of Amphenol Corporation 200 Innovative Way, Nashua, NH 03082 603.879.3000</p> <p>TITLE BACKPLANE MODULES, VERTICAL MALE HEADER XCede, 4 PAIR 6 POSITION</p> <p>PART NO. SEE PN TREE SHEET 1 REV N/A</p> <p>DRAWING NO. C-951-400C-500 REV D</p> <p>ASSEM C951-4-BP4 14.7 DRAWING C951-400C-500 C.5</p>
0.0 ±0.25	DRAWN 04/16/2009 HCL-GM	
0.00 ±0.13	CHK 10/05/2006 A.PFAHNL	
0.000 ± -	APVD 10/06/2006 A.ASTBURY	
ANGLES ± 3°		
UNLESS OTHERWISE SPECIFIED DIMENSIONS ARE IN MM. DECIMAL MARKER IS PERIOD		<p>SIZE D SCALE 3/1 SHEET 4 OF 8</p>

CUSTOMER USE DRAWING

C-951-400C-500

REV D

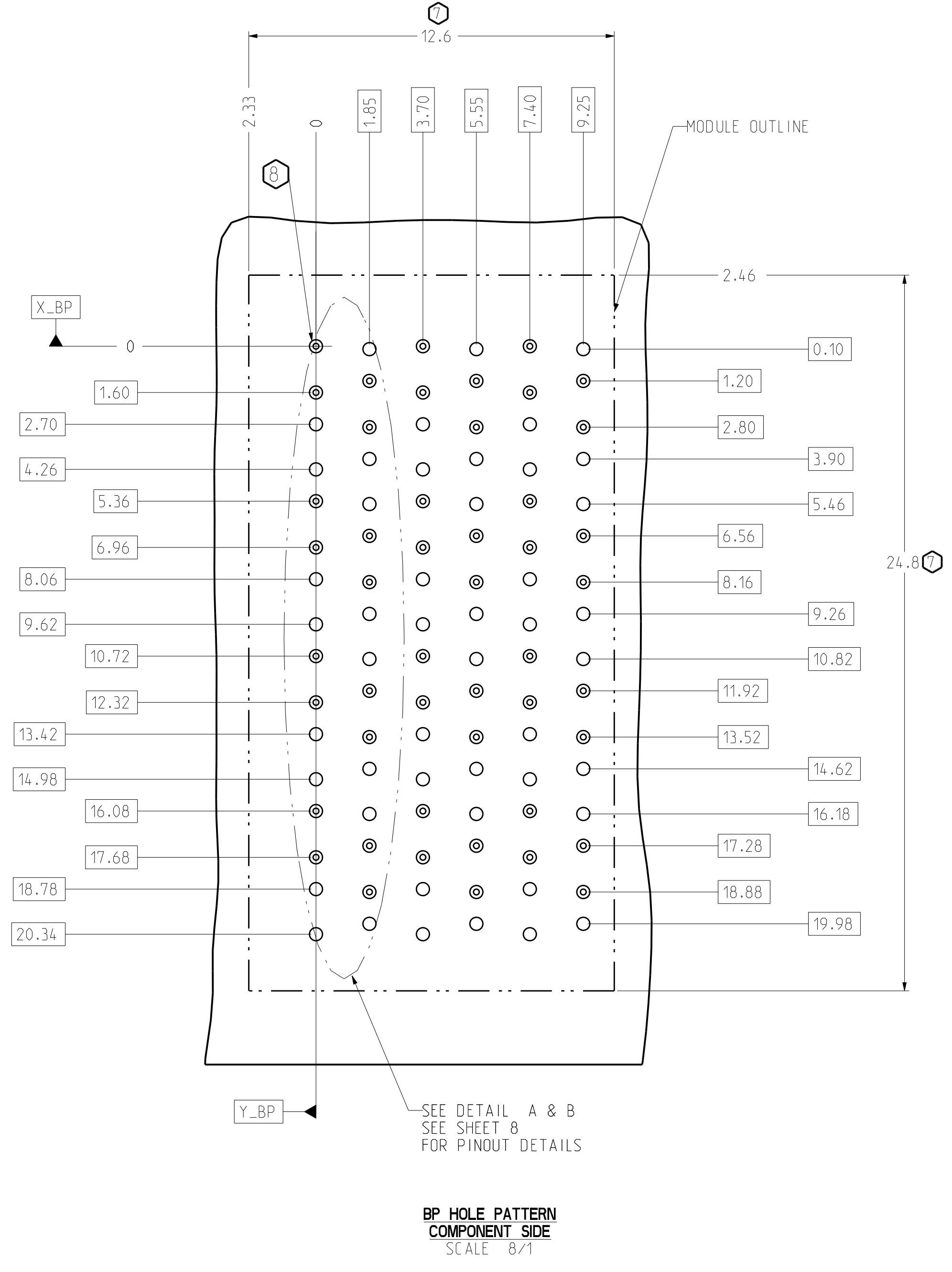
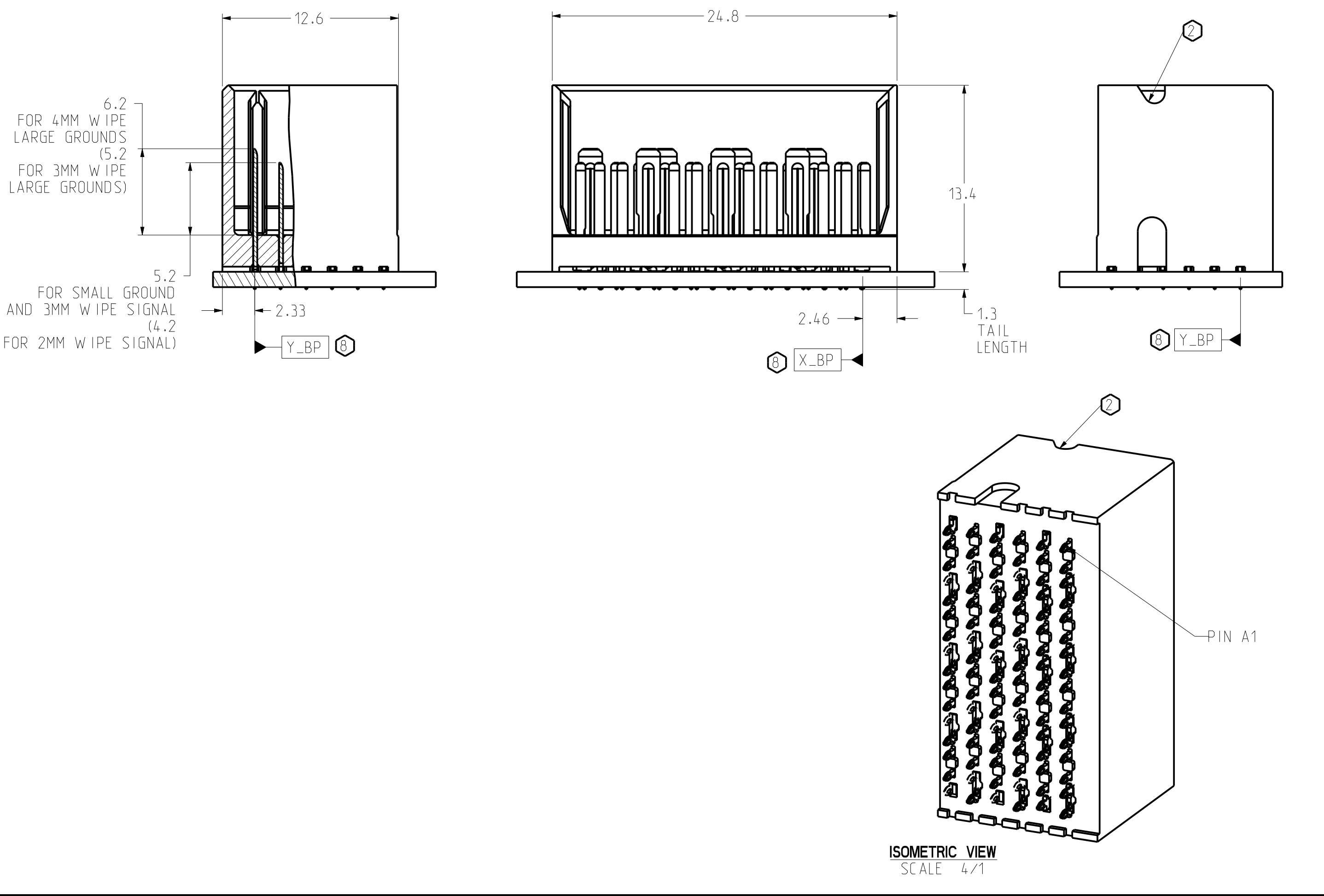
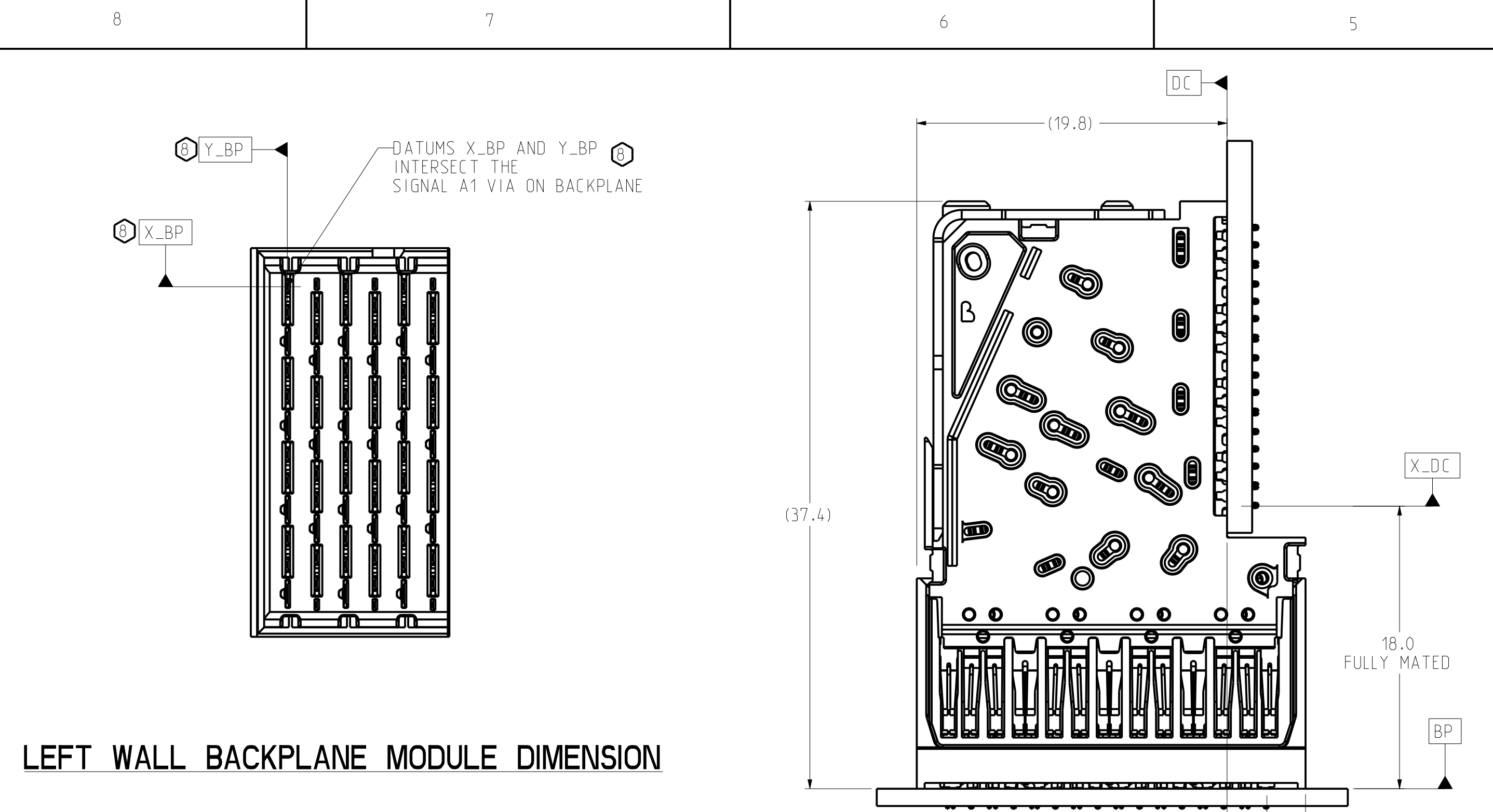

TOLERANCES		DESIGN 10/04/2006 LEIGHTON	<b>Amphenol TCS</b> A Division of Amphenol Corporation 200 Innovative Way, Nashua, NH 03062 603.879.3000 TITLE BACKPLANE MODULES, VERTICAL MALE HEADER XCode, 4 PAIR 6 POSITION
0.0	±0.25	DRAWN 04/16/2009 HCL-GM	
0.00	±0.13	CHK 10/05/2006 A.PFAHNL	
0.000	± -	APVD 10/06/2006 A.ASTBURY	
ANGLES ± 3°		PART NO. SEE PN TREE SHEET 1 REV N/A	
UNLESS OTHERWISE SPECIFIED DIMENSIONS ARE IN MM. DECIMAL MARKER IS PERIOD			DRAWING NO. C-951-400C-500 REV D
INTERPRET PER ASME Y14.5M CODE IDENT 31413			<b>CUSTOMER USE DRAWING</b> ASSEM C951-4-BP4 14.7 DRAWING C951-400C-500 C.5
SIZE D	SCALE 4/1	SHEET 5 OF 8	

C-951-400C-500

SH 5 REV D

ZONE	REV	SCR NUMBER	DESCRIPTION	BY	DATE	APPROVED
			SEE SHEET 1			

DATUMS X\_BP AND Y\_BP INTERSECT THE SIGNAL A1 VIA ON BACKPLANE

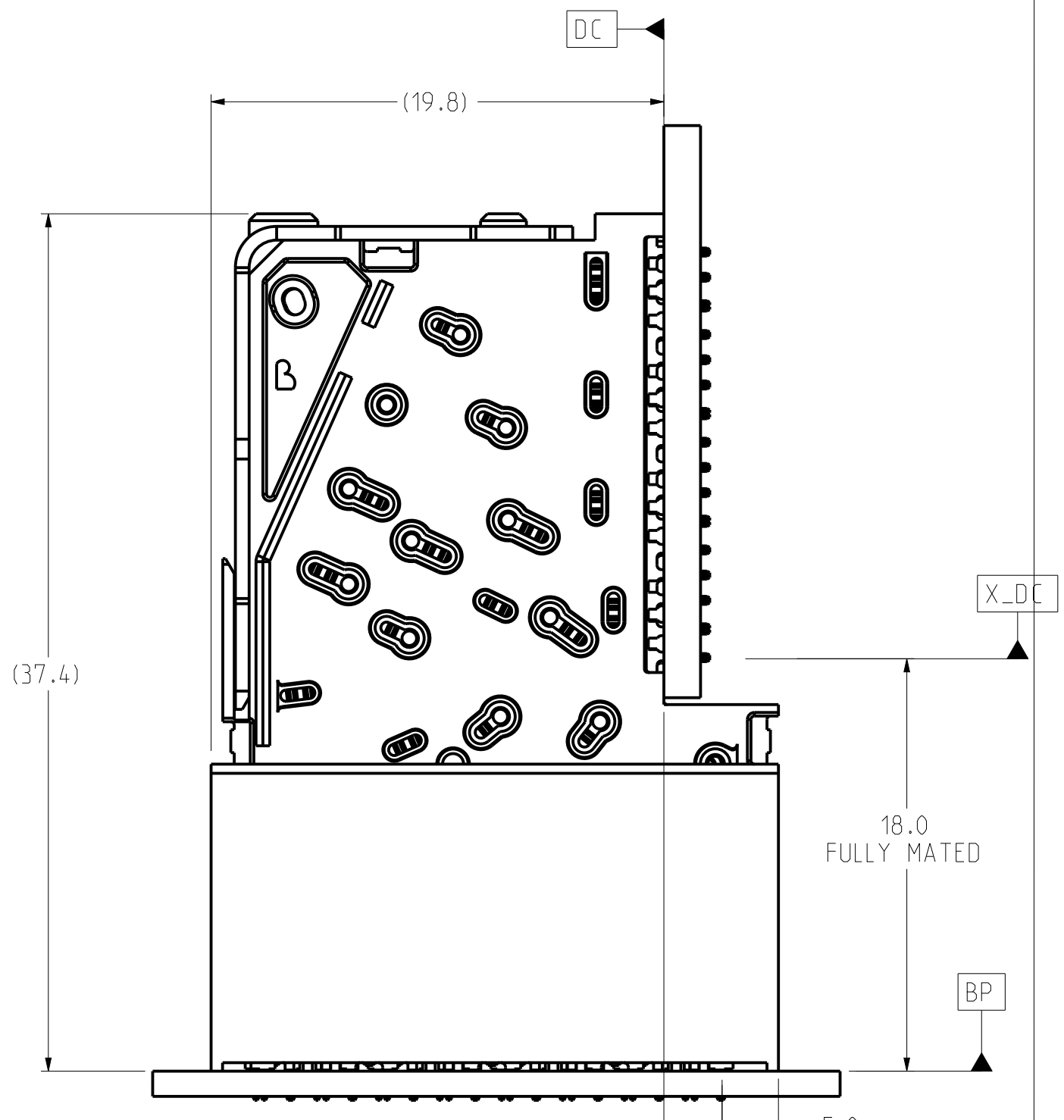
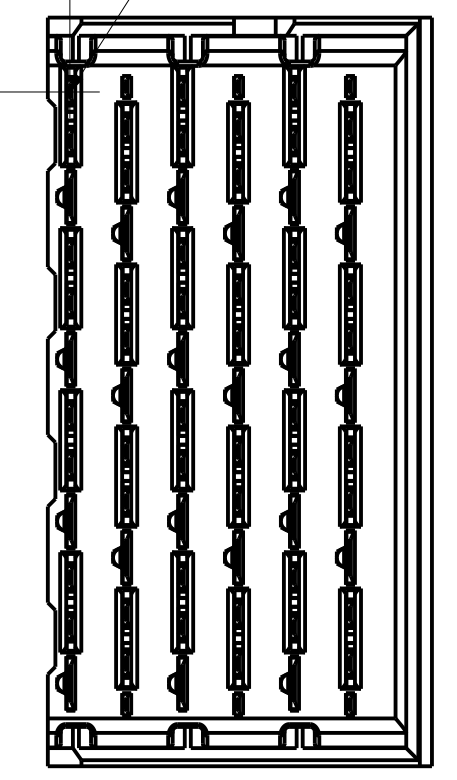

RIGHT WALL BACKPLANE MODULE DIMENSION

2.54 FROM TOP OF DC PCB TO C OF ROW A ON BP

CONNECTOR REFERENCE SCALE 4/1

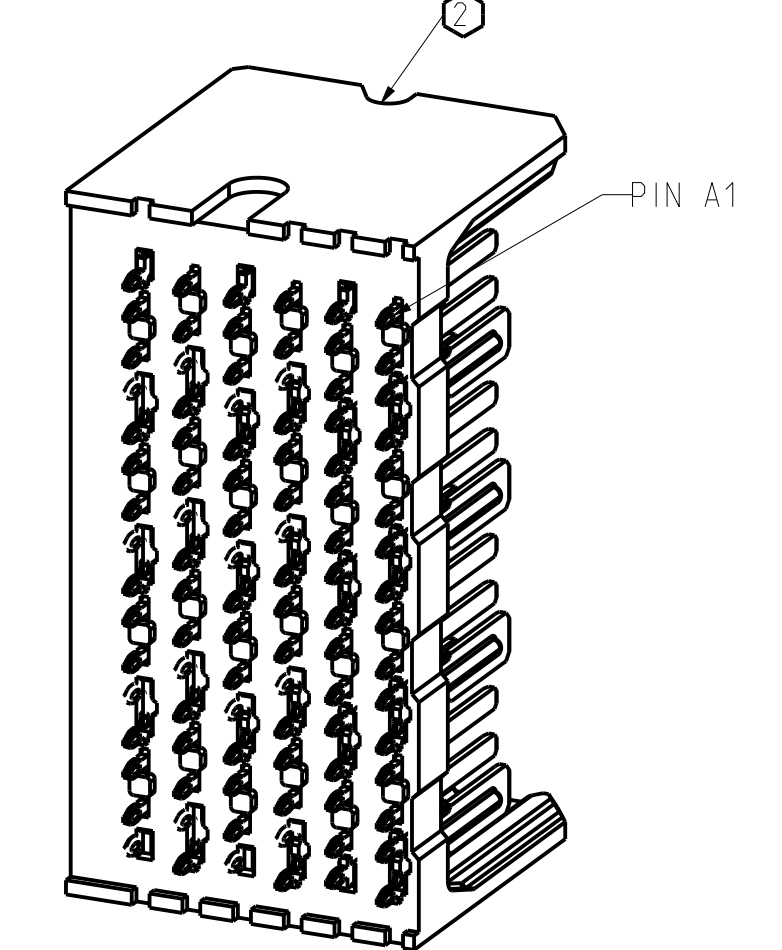
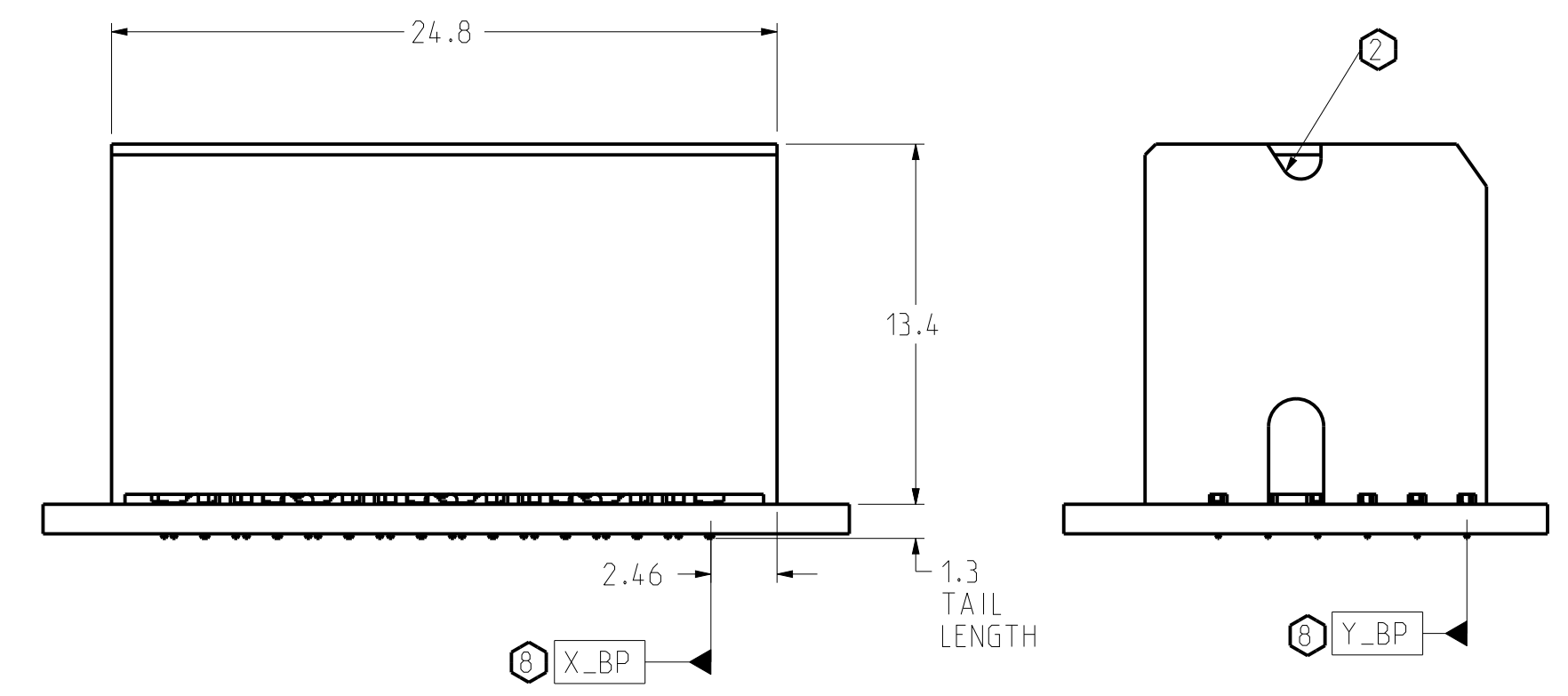
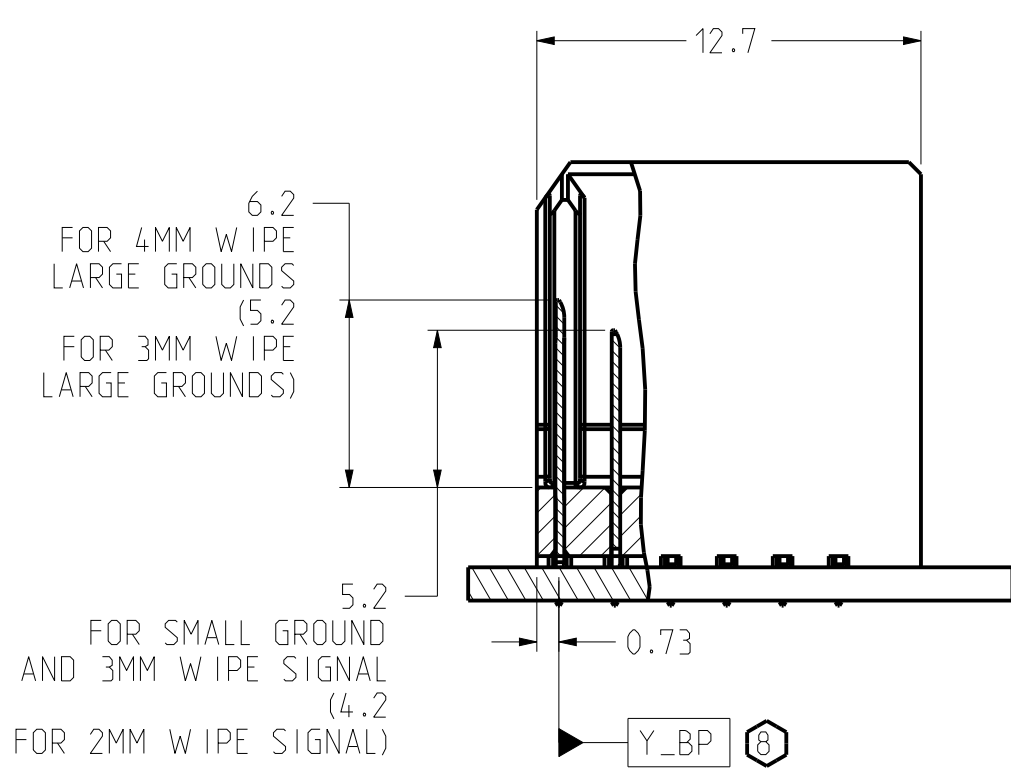

ISOMETRIC VIEW SCALE 4/1

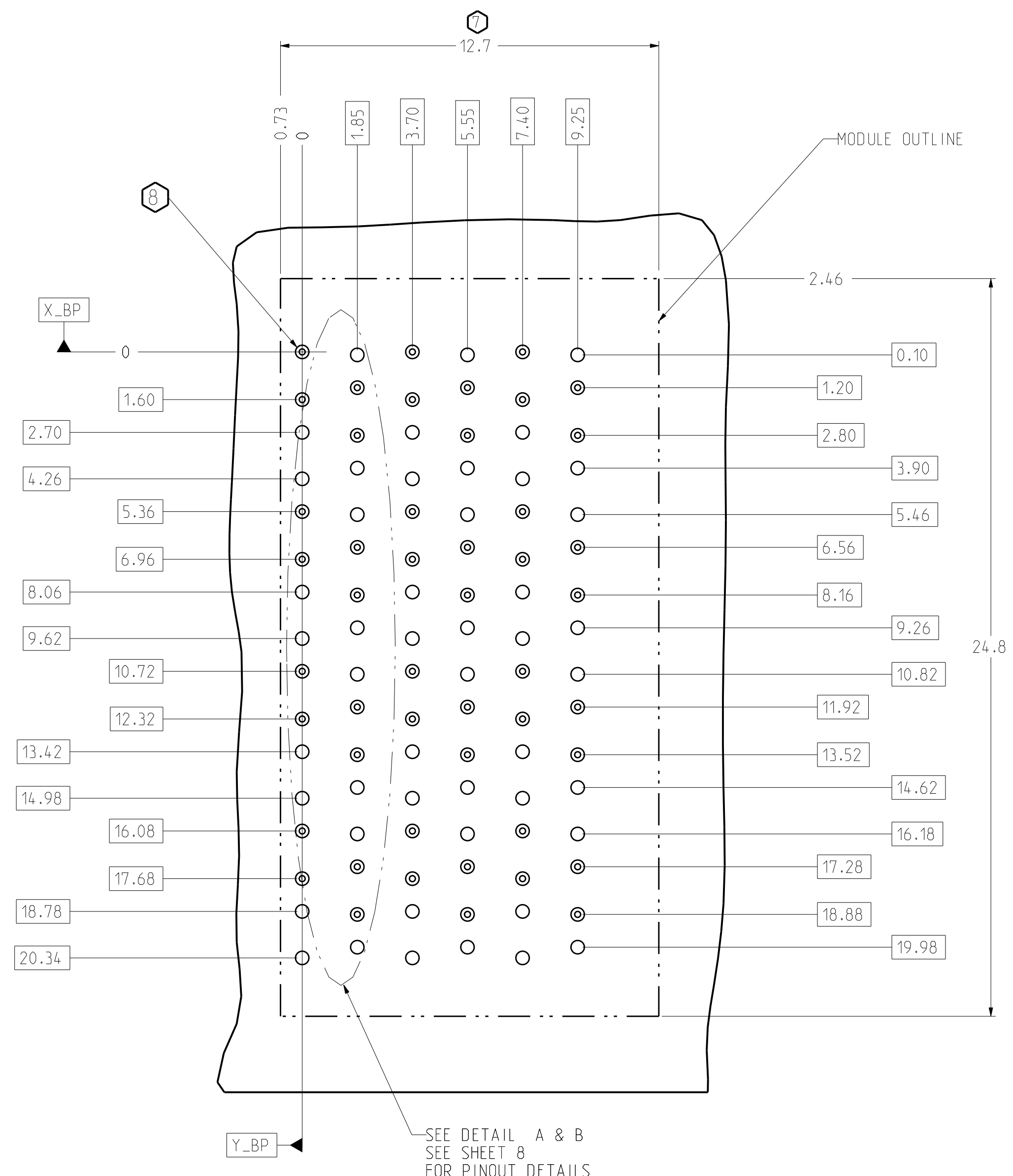

SEE DETAIL A & B SEE SHEET 8 FOR PINOUT DETAILS

BP HOLE PATTERN COMPONENT SIDE SCALE 8/1

RIGHT WALL BACKPLANE FOOTPRINT

TOLERANCES	DESIGN	DATE
0.0 ±0.25	LEIGHTON	10/04/2006
0.00 ±0.13	HCL-GM	04/16/2009
0.000 ± -	A.PFAHNL	10/05/2006
ANGLES ± 3°	A.ASTBURY	10/06/2006

**Amphenol TCS**  
A Division of Amphenol Corporation  
200 Innovative Way, Nashua, NH 03082 603.879.3000

TITLE: BACKPLANE MODULES, VERTICAL MALE HEADER  
XCede, 4 PAIR 6 POSITION

PART NO. SEE PN TREE SHEET 1  
REV N/A

DRAWING NO. C-951-400C-500  
REV D

ASSEM C951-4-BP4 14.7  
DRAWING C951-400C-500 C.5

UNLESS OTHERWISE SPECIFIED DIMENSIONS ARE IN MM. DECIMAL MARKER IS PERIOD

INTERPRET PER ASME Y14.5M  
CODE IDENT 31413

CUSTOMER USE DRAWING

SIZE D SCALE 4/1 SHEET 6 OF 8

C-951-400C-500

SH 6 REV D

ZONE	REV	SCR NUMBER	DESCRIPTION	BY	DATE	APPROVED
			SEE SHEET 1			

DATUMS X\_BP AND Y\_BP INTERSECT THE SIGNAL A1 VIA ON BACKPLANE

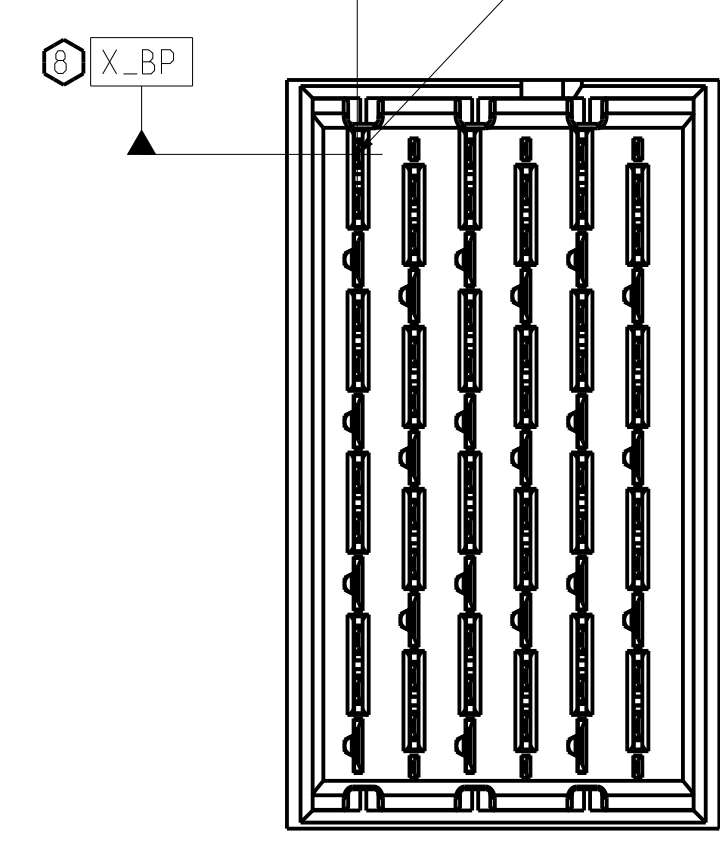

**TWO WALL BACKPLANE MODULE DIMENSION**

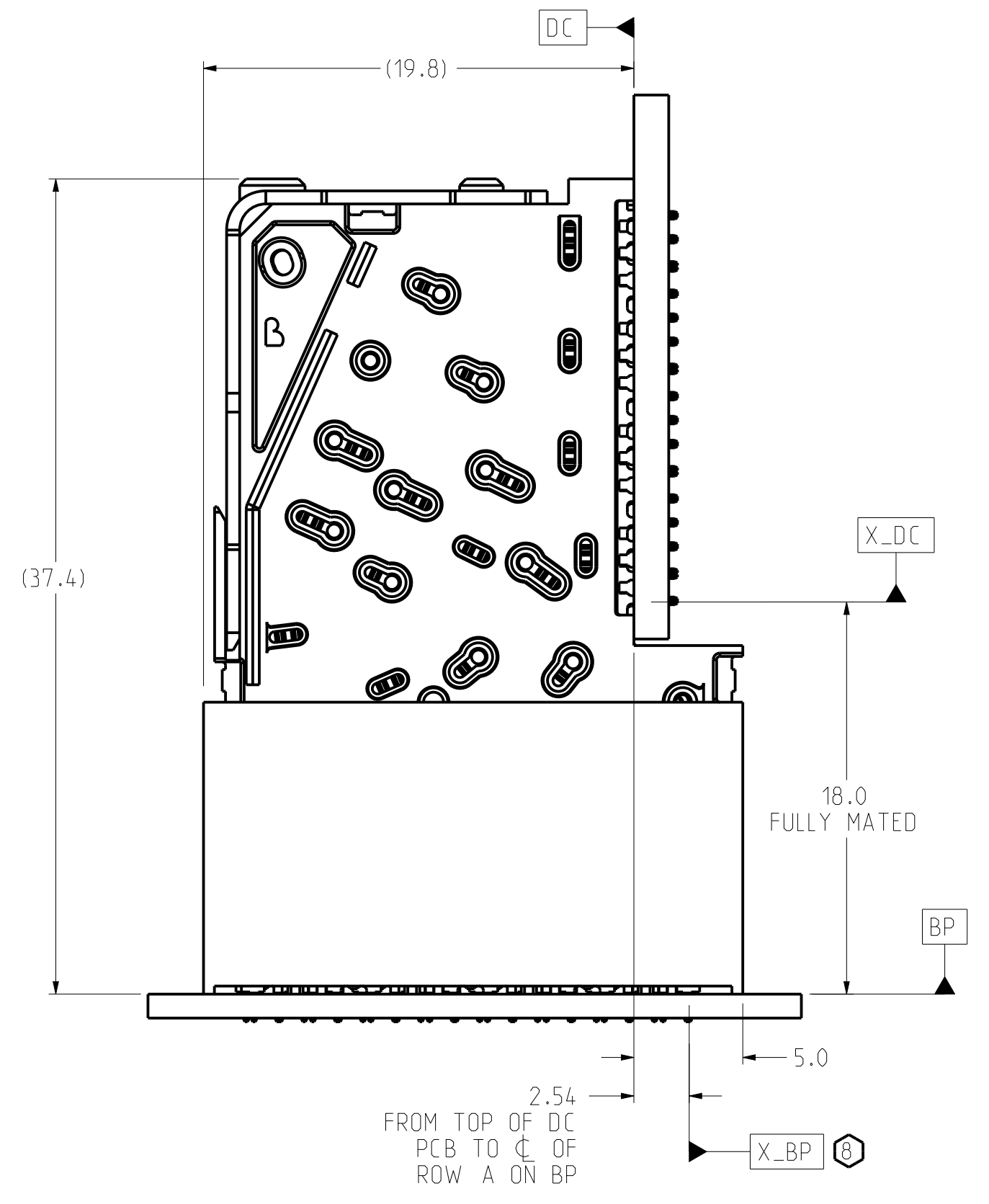

CONNECTOR REFERENCE  
SCALE 4/1

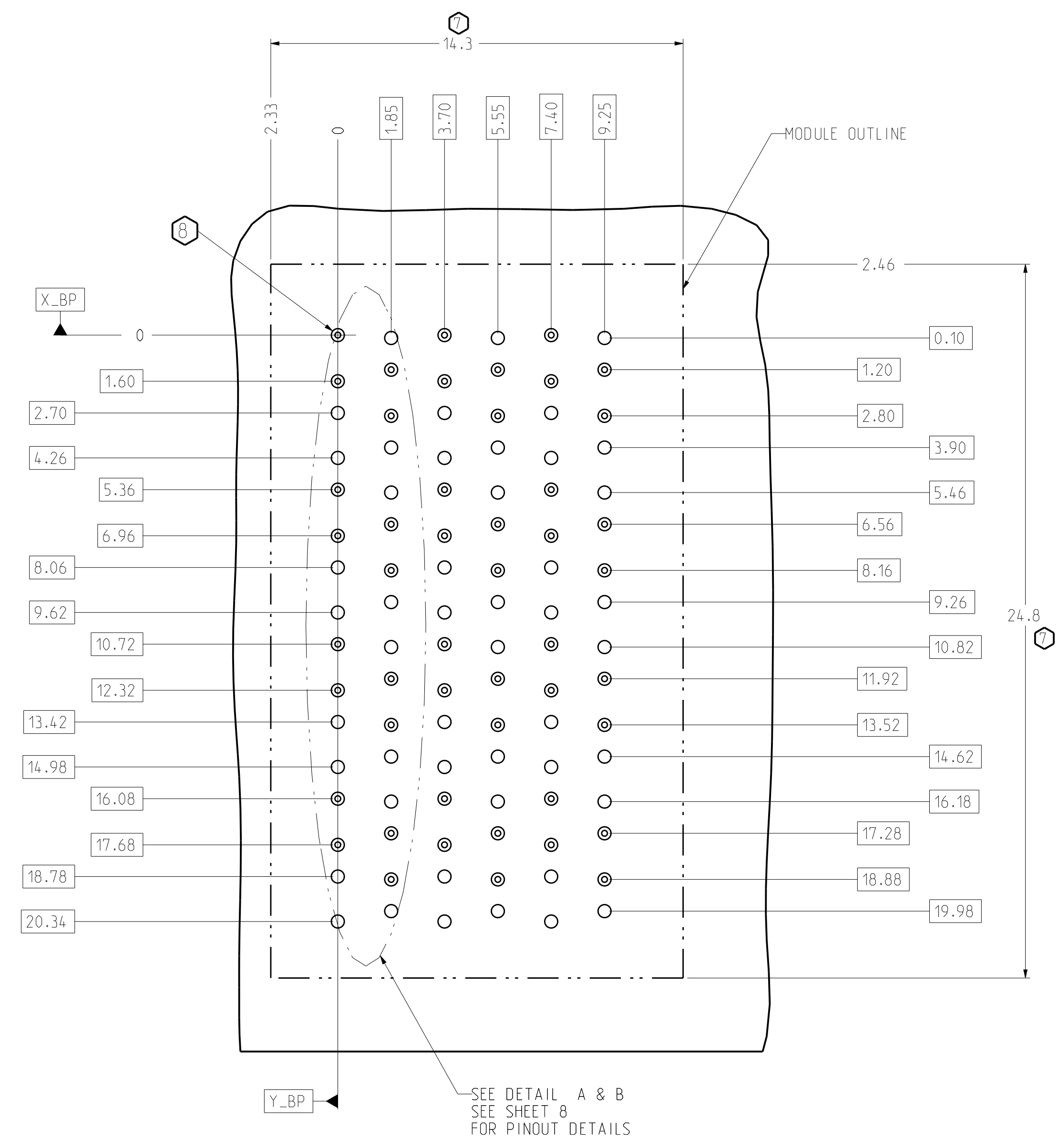
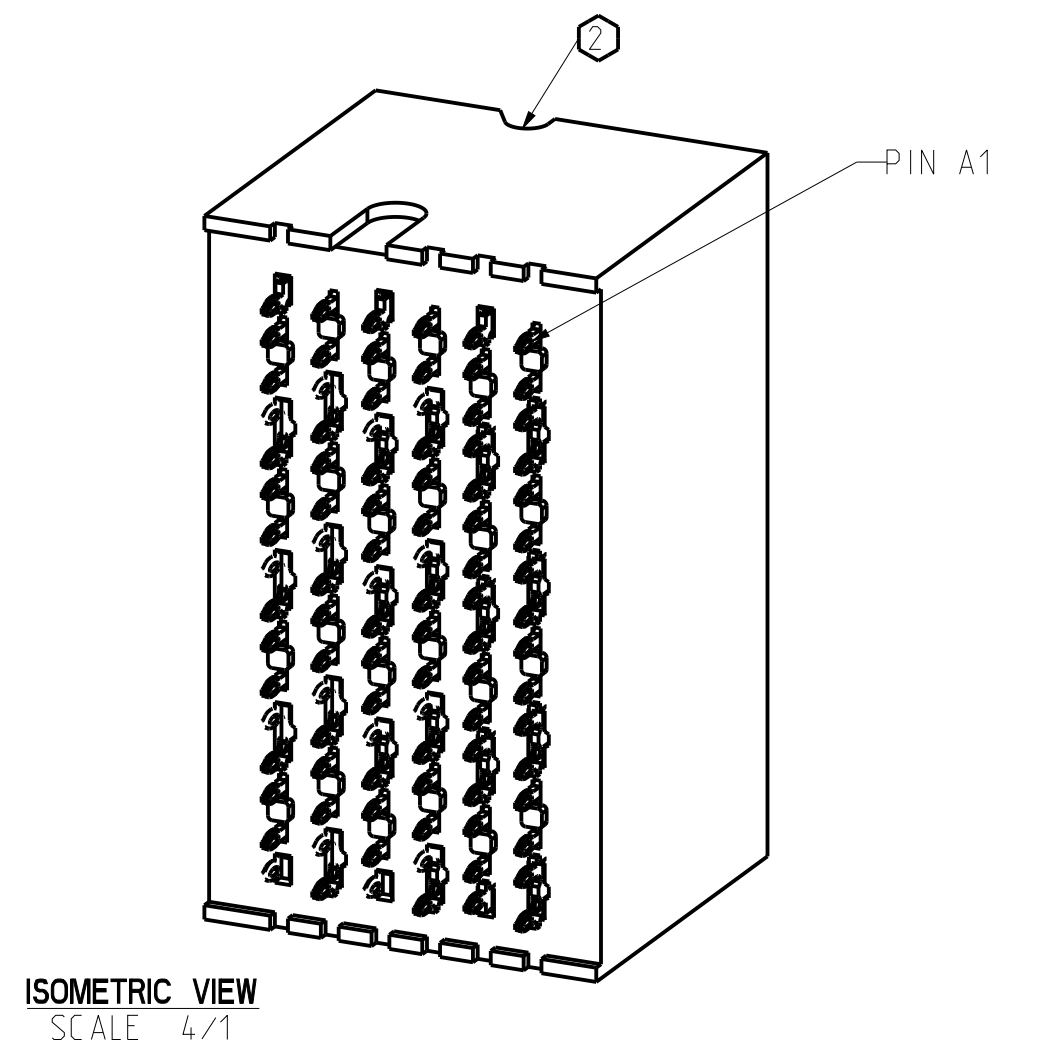
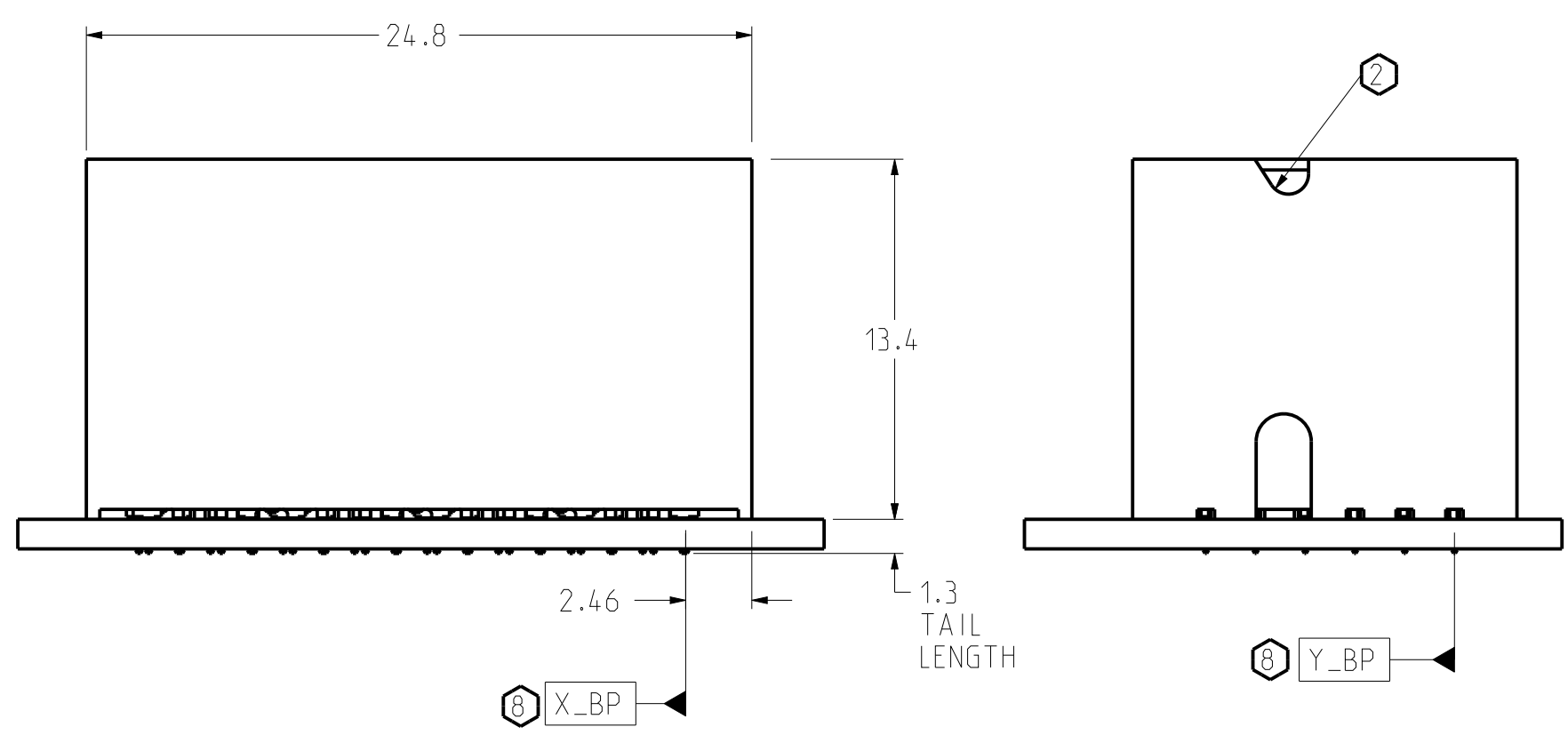
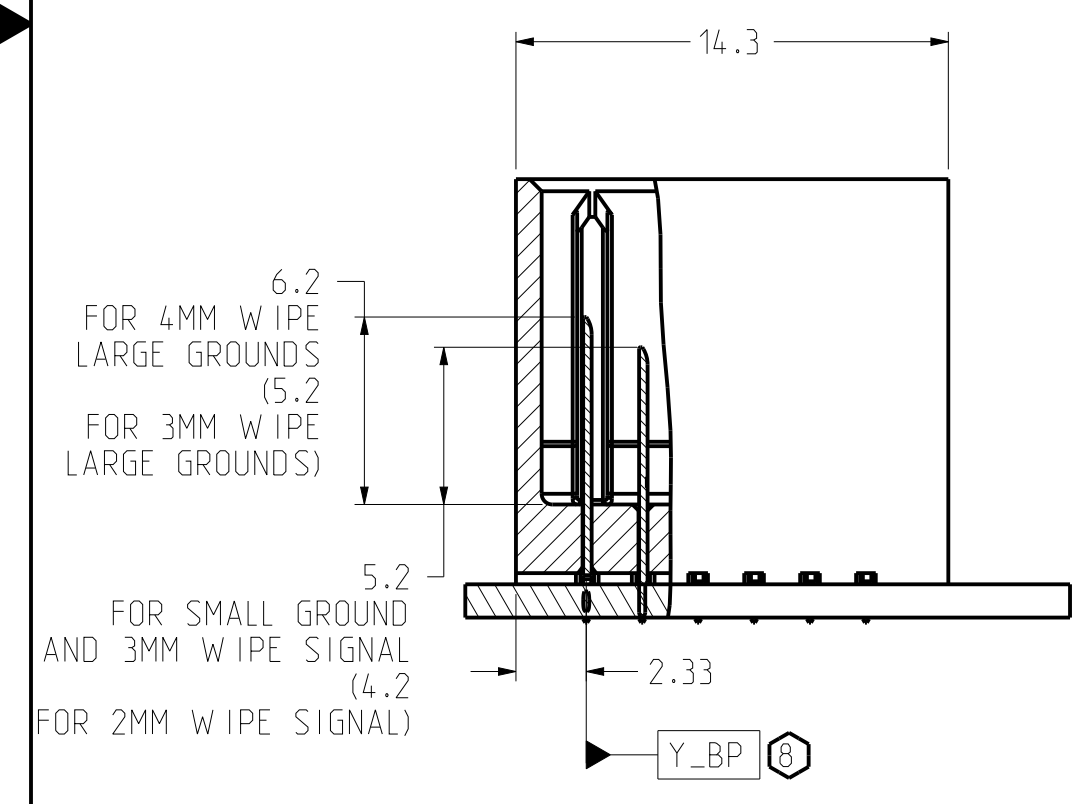

SEE DETAIL A & B  
SEE SHEET 8  
FOR PINOUT DETAILS

BP HOLE PATTERN  
COMPONENT SIDE  
SCALE 8/1

**TWO WALL BACKPLANE FOOTPRINT**

TOLERANCES		DESIGN	10/04/2006	Amphenol TCS	
0.0	±0.25	LEIGHTON		A Division of Amphenol Corporation	
0.00	±0.13	DRAWN	04/16/2009	200 Innovative Way, Nashua, NH 03062 803.879.3000	
0.000	± -	CHK	10/05/2006	TITLE	
ANGLES	± 3°	APVD	10/06/2006	BACKPLANE MODULES, VERTICAL MALE HEADER	
UNLESS OTHERWISE SPECIFIED DIMENSIONS ARE IN MM. DECIMAL MARKER IS PERIOD				XCede, 4 PAIR 6 POSITION	
INTERPRET PER ASME Y14.5M				PART NO.	SEE PN TREE SHEET 1
CODE IDENT 31413				DRAWING NO.	C-951-400C-500
CUSTOMER USE DRAWING				REV	N/A
				ASSEM	C951-4-BP4 14.7
				DRAWING	C951-400C-500 C.5
SIZE	D	SCALE	4/1	SHEET 7 OF 8	

DRW NO. C-951-400C-500

SH 7 REV D

ZONE	REV	SCR NUMBER	DESCRIPTION	BY	DATE	APPROVED
			SEE SHEET 1			

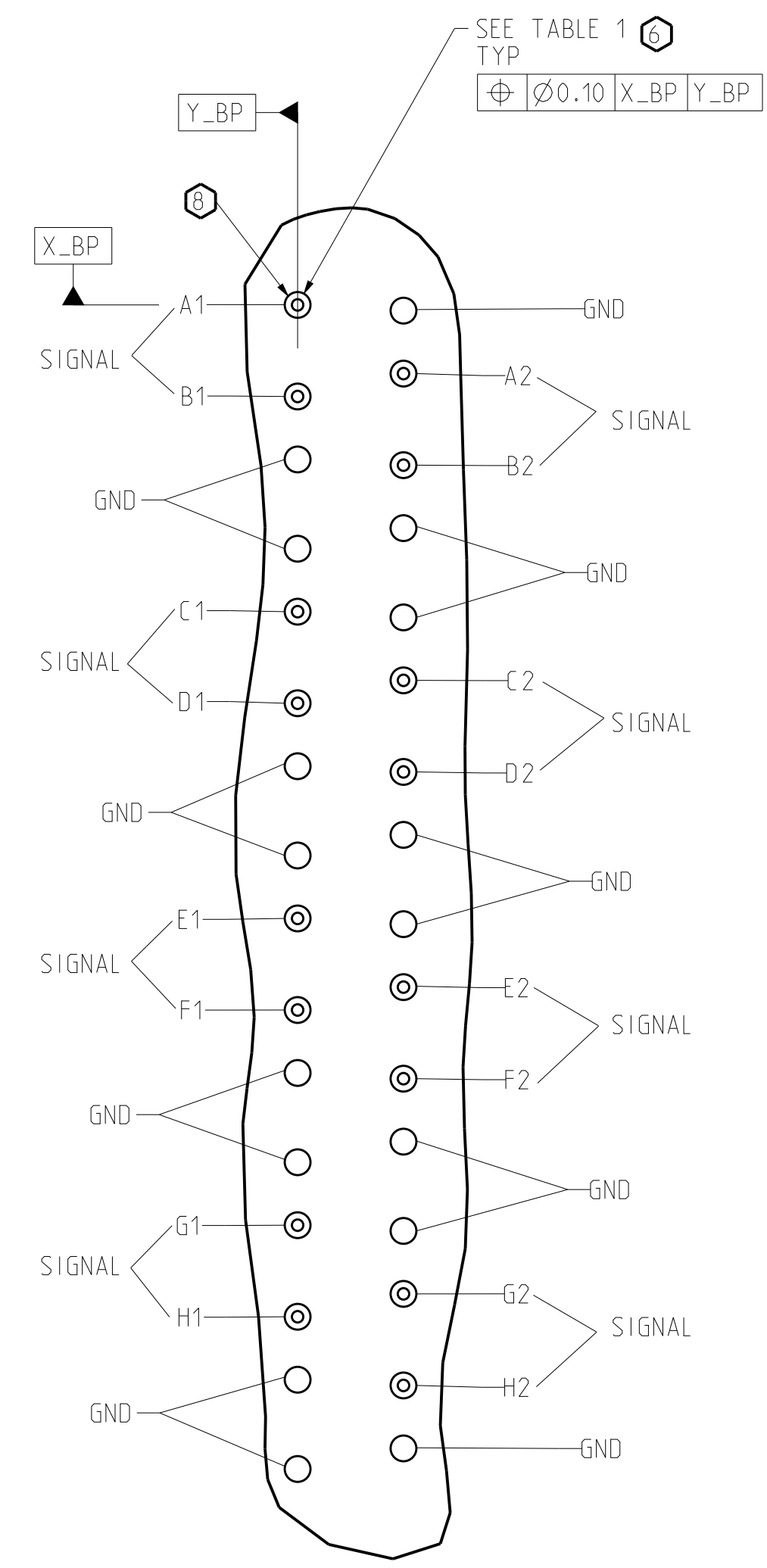

**DETAIL A**  
HSD PINOUTS  
SCALE 10/1

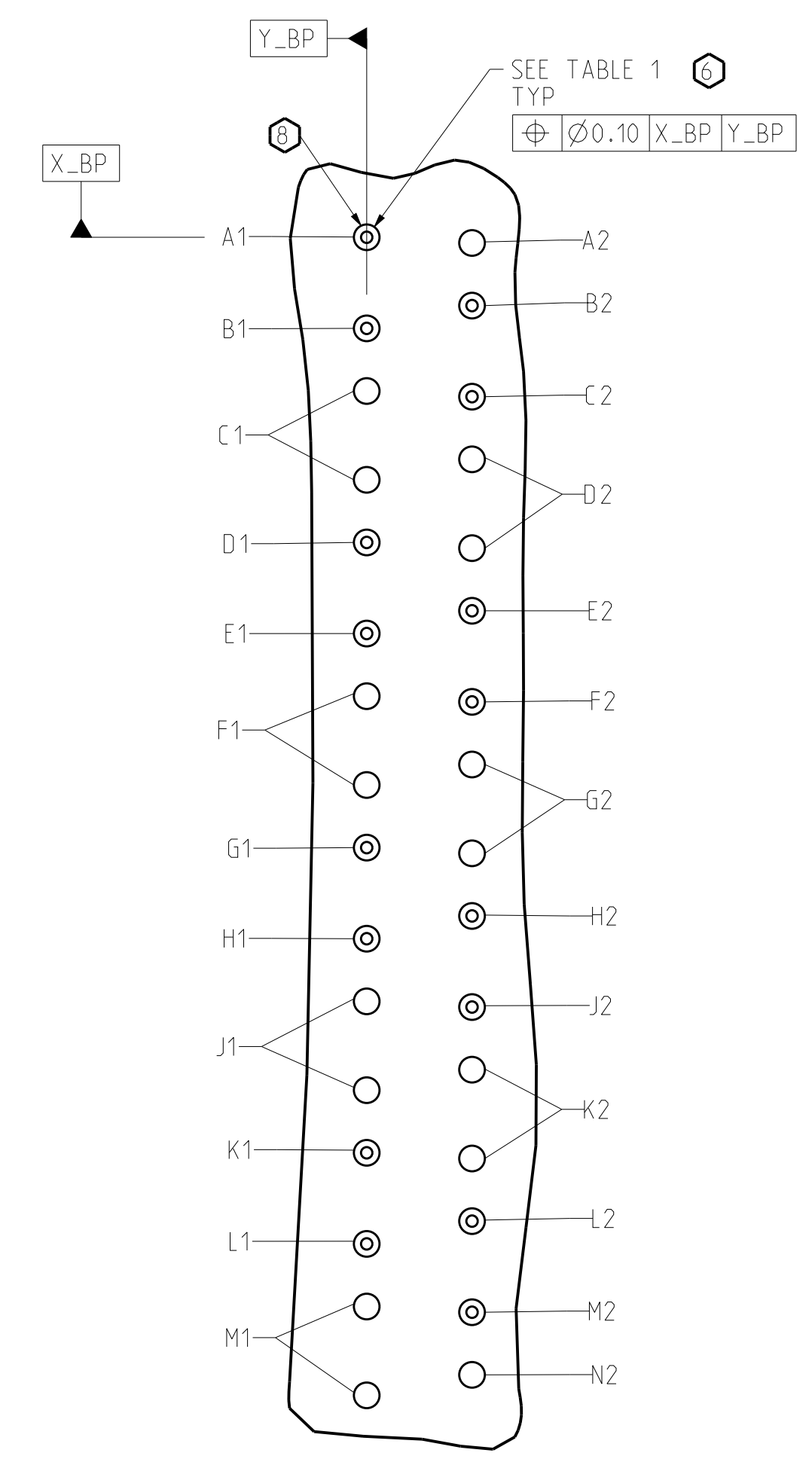

**DETAIL B**  
LC PINOUTS  
SCALE 10/1

	COMPLIANT PIN DRILL $\varnothing$ .0217"	COMPLIANT PIN DRILL $\varnothing$ .0177"
PTH	$\varnothing$ 0.45 $\pm$ 0.05	$\varnothing$ 0.36 $\pm$ 0.05
DRILL	$\varnothing$ 0.55 [1.0217"]	$\varnothing$ 0.45 [1.0177"]
PAD	$\varnothing$ 0.85	$\varnothing$ 0.75

TOLERANCES		DESIGN 10/04/2006 LEIGHTON	<b>Amphenol TCS</b> A Division of Amphenol Corporation 200 Innovative Way, Nashua, NH 03082 603.879.3000	TITLE	BACKPLANE MODULES, VERTICAL MALE HEADER XCede, 4 PAIR 6 POSITION	
0.0	$\pm$ 0.25	DRAWN 04/16/2009 HCL-GM		PART NO.	SEE PN TREE SHEET 1	REV N/A
0.00	$\pm$ 0.13	CHK 10/05/2006 A.PFAHNL		DRAWING NO.	C-951-400C-500	REV D
0.000	$\pm$ -	APVD 10/06/2006 A.ASTBURY		UNLESS OTHERWISE SPECIFIED DIMENSIONS ARE IN MM. DECIMAL MARKER IS PERIOD	ASSEM C951-4-BP4 DRAWING C951-400C-500	14.7 C.5
ANGLES	$\pm$ 3°		CODE IDENT 31413	CUSTOMER USE DRAWING	SIZE D SCALE 4/1 SHEET 8 OF 8	

C-951-400C-500

SH 8 REV D



## X-ON Electronics

Largest Supplier of Electrical and Electronic Components

*Click to view similar products for [High Speed/Modular Connectors](#) category:*

*Click to view products by [Amphenol](#) manufacturer:*

Other Similar products are found below :

[650827-1](#) [74040-1346](#) [1410191-1](#) [1410337-1](#) [1410368-3](#) [1410964-2](#) [1410326-3](#) [1410367-3](#) [1410971-4](#) [1467833-1](#) [2000877-1](#) [2000878-1](#)  
[2041314-1](#) [2065387-1](#) [2187307-1](#) [163P](#) [1934290-1](#) [2000875-1](#) [2065917-1](#) [2102736-2](#) [FSR-40](#) [2169868-2](#) [22354-8](#) [437-5040-000](#) [5-](#)  
[1393565-0](#) [039-0246-000](#) [0740618502](#) [0761601016](#) [0784461022](#) [10123159-12ELF](#) [030-2415-003/100 PK](#) [030-7380-004](#) [030-2494-001](#)  
[532939-1](#) [5532901-3](#) [3-1469268-7](#) [74748-102LF](#) [73670-0247](#) [10041743-101LF](#) [10066670-100002LF](#) [1-533915-1](#) [249-4515-000](#) [7-1469373-](#)  
[3](#) [DL2-2J/S](#) [2000713-8](#) [2000713-7](#) [3011-21](#) [757105208](#) [EBTF-4-10-2.0-S-RA-1](#) [430305-001](#)