

THIS DOCUMENT IS SUBJECT TO CHANGE WITHOUT NOTICE. IT IS CONFIDENTIAL AND A PROPERTY OF AMPHENOL LTW. DISCLOSURE TO THIRD PARTY HAS TO BE AUTHORIZED BY AMPHENOL LTW.

REV.	ECN NO.	DATE	SIGN	DESCRIPTION

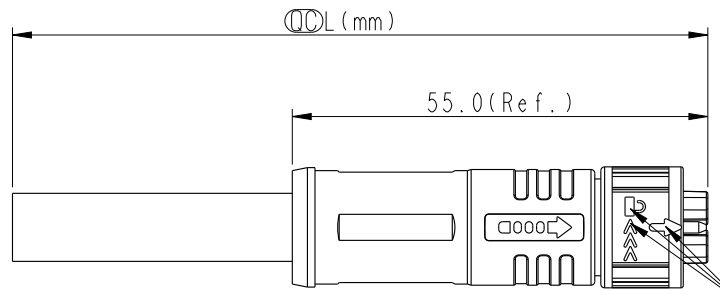

White Printing \varnothing

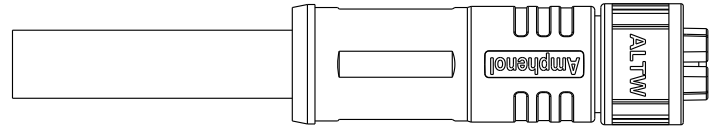
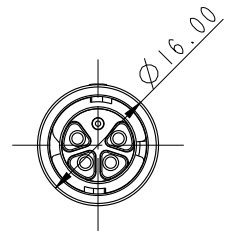
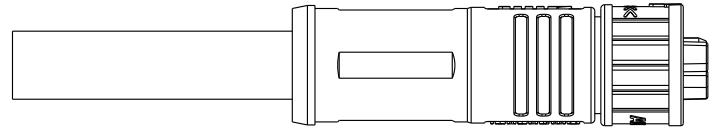

- Note:
- * \varnothing Important Dimension To Check.
 - * Waterproof Rate: IP68, 1m/24H (Mated)
 - * Flame Class: UL94V-0 (UV Resistance)
 - * Housing: Thermoplastic, Black.
 - * Female Pin: Copper Alloy, Gold Plated.
 - * O-Ring: Rubber, Gray
 - * Rated Current: 3~5Pin 16A(630V)
 - * Cable Length Tolerance:
 - 01M: +50/-0mm
 - 02M~03M: +100/-0mm
 - 04M~05M: +150/-0mm
 - 06M~10M: ± 100 mm
 - 11M~20M: ± 200 mm
 - 21M~30M: ± 300 mm
 - 31M~99M: ± 500 mm

UNIT: mm			TITLE X-Lok A-Size Power Connector		
TOLERANCE ± 0.5 mm			SCALE 1:1	SIZE A4	SHEET 1 OF 2
REV. A	WC-REV. .0	\varnothing : Inspection item			

Amphenol LTW
安費諾亮泰企業股份有限公司

ITEM NO.	DRAWN BY Ouyang	DATE 2021-01-23
DWG NO. AG-XXBFGM-QL8GXX	CHECKED BY Jerry	DATE 2021-01-23
CUSTOMER ALTW	APPROVED BY Fred	DATE 2021-01-23

1 2 3 4 5 6 7 8

F

E

D

C

B

A

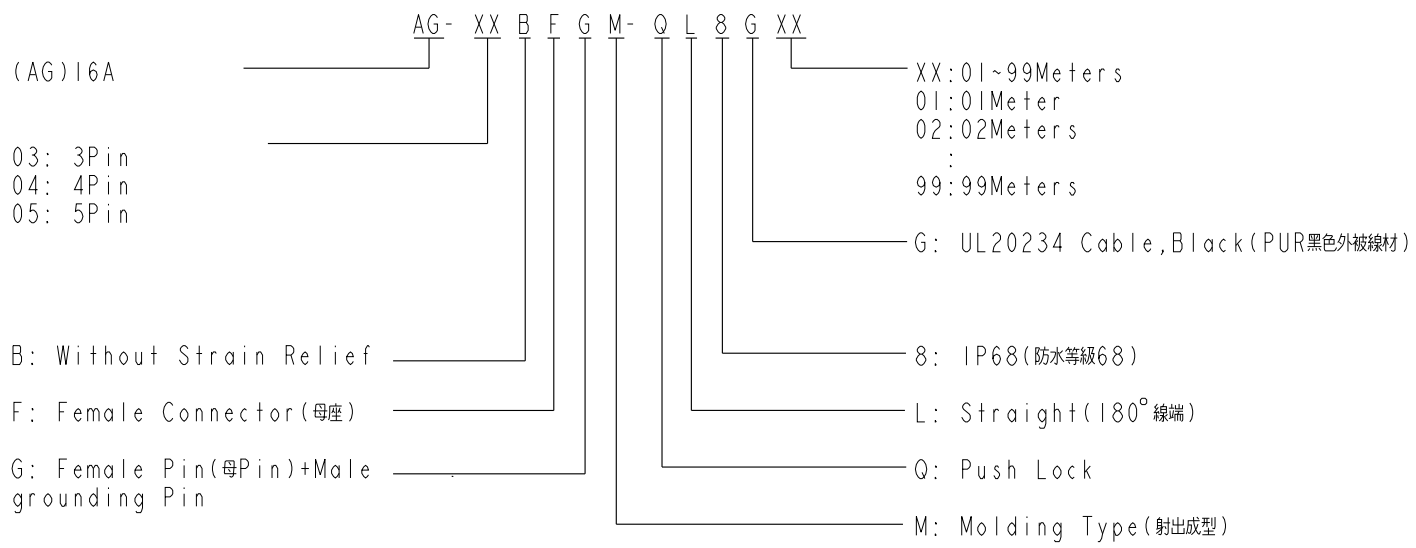

3pin	4pin	5pin
4 3 2 1 PE	4 3 2 1 PE	4 3 2 1 PE
- Red 紅 Brown 棕 - Yellow 黃	- Red 紅 Brown 棕 Black 黑 Yellow 黃	Orange 橘 Red 紅 Brown 棕 Black 黑 Yellow 黃
Pin # Wire	Pin # Wire	Pin # Wire

UNIT:mm		TITLE
TOLERANCE	$\pm 0.5mm$	X-Lok A-Size Power Connector
SCALE	1:1	SIZE A4
REV.	A	SHEET 2 OF 2
WC-REV.	.0	QC: Inspection item

Amphenol LTW
安費諾亮泰企業股份有限公司

ITEM NO	DRAWN BY	DATE
DWG NO	CHECKED BY	DATE
CUSTOMER	APPROVED BY	DATE
AG-XXBFGM-QL8GXX	Ouyang	2021-01-23
ALTW	Jerry	2021-01-23
	Fred	2021-01-23

1 2 3 4 5 6 7 8 W10814-03-001A2

X-ON Electronics

Largest Supplier of Electrical and Electronic Components

Click to view similar products for [Specialised Cables](#) category:

Click to view products by [Amphenol](#) manufacturer:

Other Similar products are found below :

[603PT6](#) [603SS6L](#) [604PT6](#) [604SS6](#) [706000D02F200](#) [910640](#) [1200740077](#) [1200740114](#) [AC172](#) [ACL-SSI-4](#) [R88ACAKA0015SRE](#)
[R88ACAWL005SDE](#) [R88ACRGD0R3C](#) [1300150047](#) [1300660036](#) [1302262116](#) [1300150149](#) [1300220020](#) [1300220104](#) [1300220119](#)
[1301240492](#) [1301810221](#) [1365323-1](#) [176P12](#) [1971465-2](#) [20240400003](#) [20240400013](#) [2085828-1](#) [20886510030](#) [2-22733-8](#) [22733-8](#) [CB-](#)
[5PSBC-RS](#) [CB-704EC-RS](#) [CB-BATACC-RS](#) [CB-JST3PSW-RS](#) [CB-M12COM-R10](#) [25AC84](#) [25AK84X](#) [25AU25](#) [25FN82](#) [AC118](#) [ACL-](#)
[HHS-1M\(CAT5E\)](#) [SSL009PC2DC012N](#) [FC2A-KC6C](#) [2085828-2](#) [20886510150](#) [CCS-FCB-5](#) [CCSF2CBF2](#) [R88A-CRWB020N](#) [416216000-3](#)