

| REVISIONS |     |                            |         |       |      |
|-----------|-----|----------------------------|---------|-------|------|
| REV       | ECO | DESCRIPTION                | DATE    | BY    | APPR |
| A3        | -   | RELEASE NEW DRAWING FORMAT | 02JAN14 | JARRY | -    |

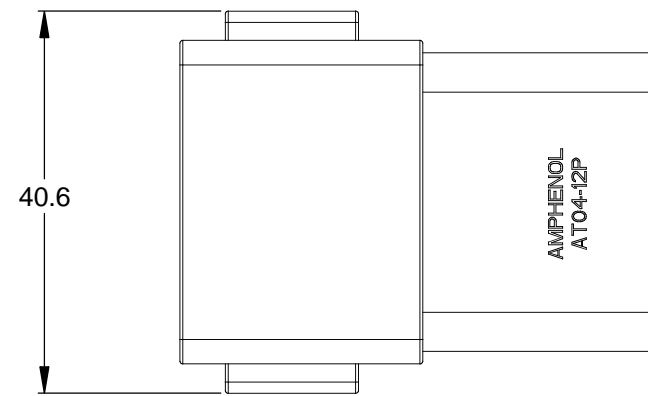

REQUIRES CONTACT  
RETENTION WEDGE AW12P

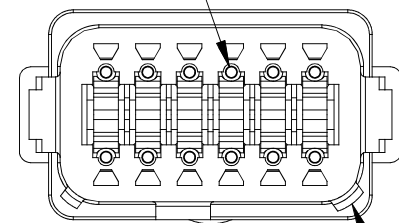

1 KEYWAY (3) PLACES

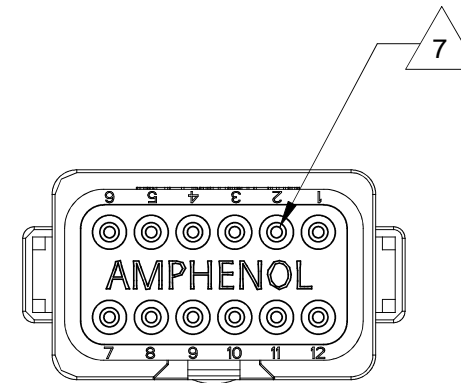
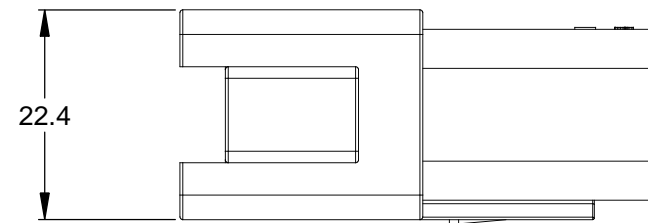

1 REFER TO SHEET 2 FOR  
AVAILABLE CONNECTOR COLORS

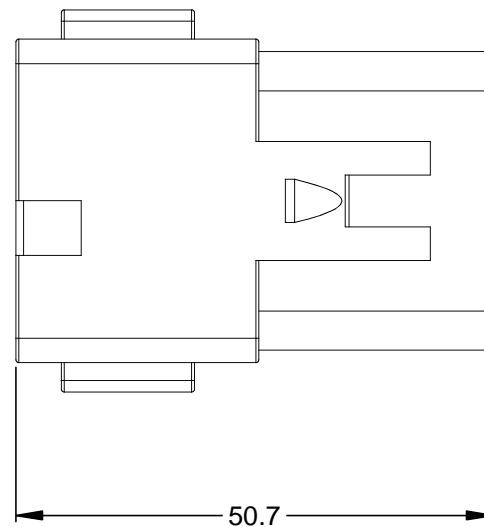
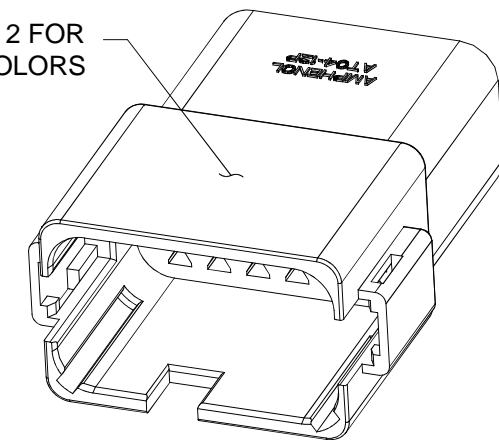

NOTES: UNLESS OTHERWISE SPECIFIED

1 SEE SHEET 2 FOR KEY ARRANGEMENTS AND COLORS.

2. MATERIAL:  
HOUSING: THERMOPLASTIC  
SEAL: SILICONE RUBBER

3. MODIFICATIONS: N/A

4. SPECIFICATIONS:  
4.1 CURRENT RATING: 13 AMPS  
4.2 OPERATING TEMPERATURE: -55°C TO +125°C  
4.3 DIELECTRIC WITHSTANDING VOLTAGE: LESS THAN 2 MILLIAMPS CURRENT LEAKAGE @ 1500 VOLTS AC.  
4.4 INSULATION RESISTANCE: 1000 MEGOHMS MIN @ 25°C.  
4.5 MOISTURE RESISTANCE: IP67 ( MATED CONDITION )  
4.6 MATING CYCLE DURABILITY: 100 CYCLES  
4.7 RoHS COMPLIANT

5. MATING PART: AT06-12SX\* PLUG  
( X = A,B,C,D KEYS; \* = MODIFICATIONS AND COLORS )

6. ALL DIMENSIONS ARE FOR REFERENCE USE ONLY.

7 CONTACT SIZE AND REAR SEAL WIRE RANGE:

| CONTACT SIZE | MIN. INSUL O.D.   | MAX. INSUL O.D.   | TYPICAL WIRE RANGE |
|--------------|-------------------|-------------------|--------------------|
| 16           | 2.24 mm (.088 in) | 3.68 mm (.145 in) | 14 - 20 AWG        |

TITLE: RECEPTACLE, 12 PIN, AT SERIES, KEYED  
DWG NO.: AT04-12PX-XXX  
REV: A3  
SH: 1  
OF: 2

| QUANTITY  | SEE SHEET 2<br>PART NUMBER   | DESCRIPTION   | ITEM                  |
|---|--|---|-----------------------|
| <b>MATERIALS LIST</b>   |  |   |                       |
| UNLESS OTHERWISE SPECIFIED<br>1) All dimensions are in metric(mm).<br>2) Tolerances are as follows:<br>1 PL DEC ±0.30<br>2 PL DEC ±0.15<br>3 PL DEC ±0.08<br>Fractions ±1/64<br>Angles ±1°<br>3) Note reference = X |  | SIGNATURES<br>DRAWN: JARRY<br>CHECKED:<br>ENGINEER:<br>APPROVAL:  | DATE<br>02JAN14       |
| MATERIAL SPECIFICATIONS:  |  | <b>Amphenol</b><br>Sine Systems - www.amphenol-sine.com<br>44724 Morley Drive<br>Clinton Township, MI 48036 |                       |
| PROCESS SPECIFICATIONS:   |  | RECEPTACLE, 12 PIN, AT SERIES,<br>KEYED   |                       |
| NEXT ASSY:  | THIS DRAWING IS SUPPLIED FOR INFORMATION ONLY. DESIGN FEATURES, SPECIFICATIONS AND PERFORMANCE DATA SHOWN HEREON ARE THE PROPERTY OF THE AMPHENOL CORPORATION. NO RIGHTS OF REPRODUCTION ARE IMPLIED. ALL DIMENSIONS ARE SUBJECT TO NORMAL MANUFACTURING VARIATIONS. | SIZE<br><b>B C-</b>   | REVISION<br><b>A3</b> |
|   |  | DWG NO.:<br><b>AT04-12PX-XXX</b>  |                       |
|   |  | SCALE: NONE   | SHEET 1 OF 2          |

| REVISIONS |     |             |      |    |      |
|-----------|-----|-------------|------|----|------|
| REV       | ECO | DESCRIPTION | DATE | BY | APPR |

P/N AT04-12PA  
KEY-A CONFIGURATION  
STANDARD COLOR: GREY

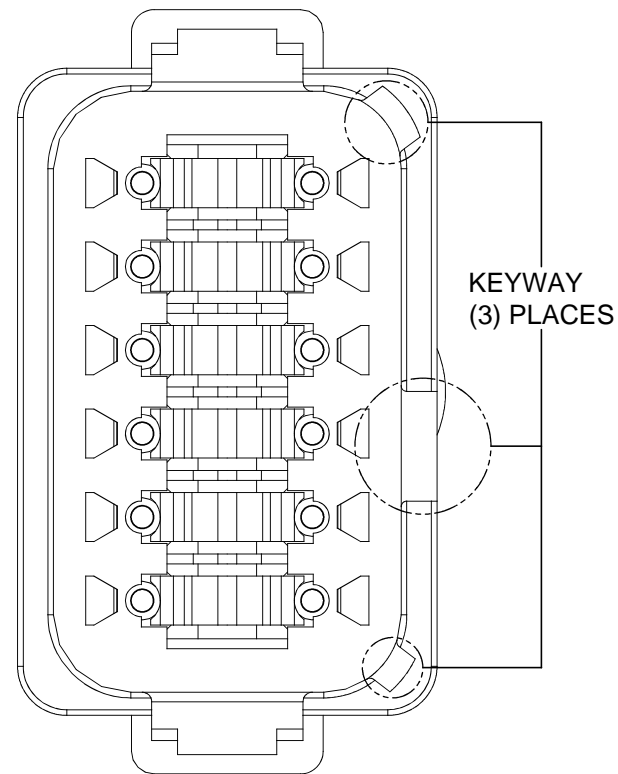

P/N AT04-12PB  
KEY-B CONFIGURATION  
STANDARD COLOR: BLACK

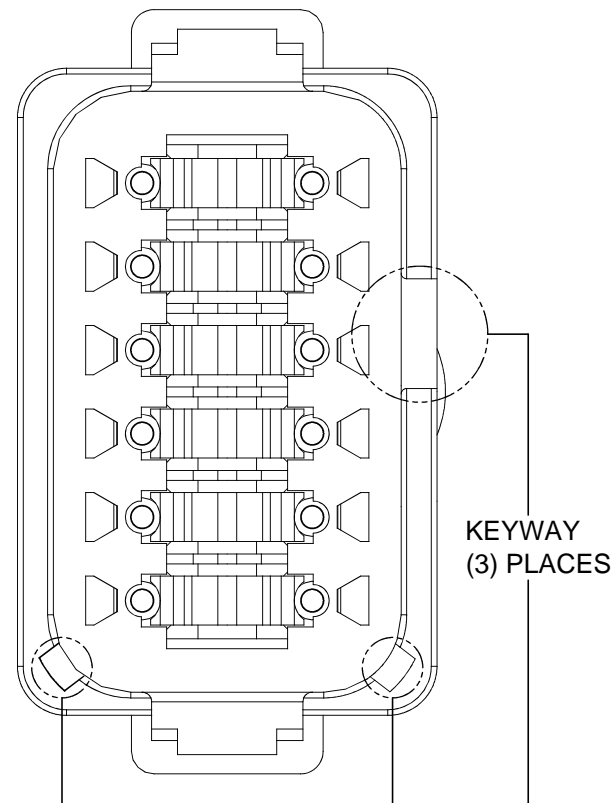

P/N AT04-12PC  
KEY-C CONFIGURATION  
STANDARD COLOR: GREEN

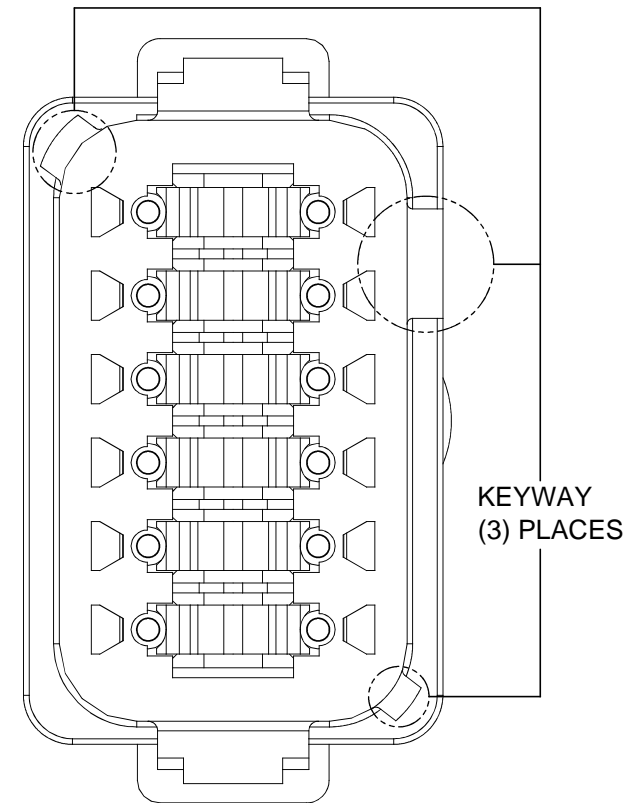

P/N AT04-12PD  
KEY-D CONFIGURATION  
STANDARD COLOR: BROWN

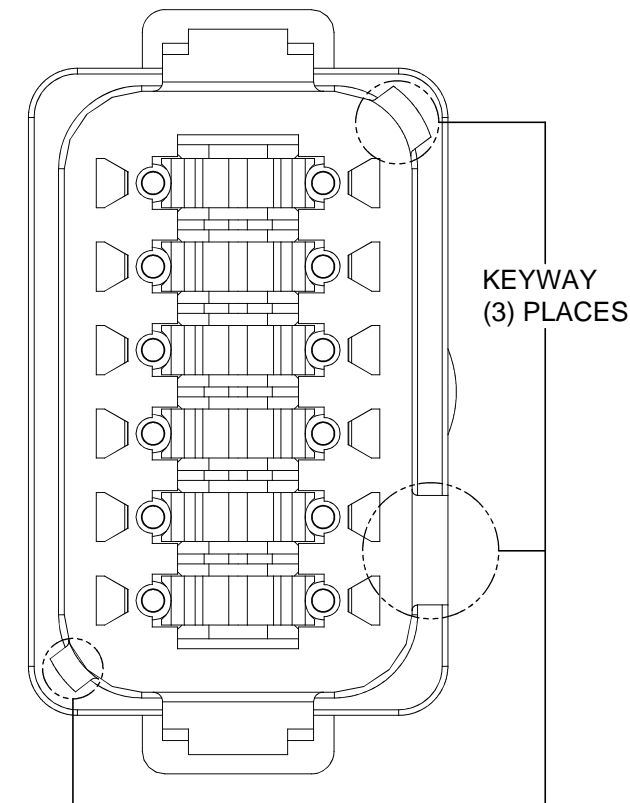

| KEY-A CONFIGURATION |               |
|---------------------|---------------|
| COLOR               | PART NUMBER   |
| * GREY              | AT04-12PA     |
| BLACK               | AT04-12PA-BLK |
| GREEN               | AT04-12PA-GRN |
| BROWN               | AT04-12PA-BRN |

| KEY-B CONFIGURATION |               |
|---------------------|---------------|
| COLOR               | PART NUMBER   |
| GREY                | AT04-12PB-GRY |
| * BLACK             | AT04-12PB     |
| GREEN               | AT04-12PB-GRN |
| BROWN               | AT04-12PB-BRN |

| KEY-C CONFIGURATION |               |
|---------------------|---------------|
| COLOR               | PART NUMBER   |
| GREY                | AT04-12PC-GRY |
| BLACK               | AT04-12PC-BLK |
| * GREEN             | AT04-12PC     |
| BROWN               | AT04-12PC-BRN |

| KEY-D CONFIGURATION |               |
|---------------------|---------------|
| COLOR               | PART NUMBER   |
| GREY                | AT04-12PD-GRY |
| BLACK               | AT04-12PD-BLK |
| GREEN               | AT04-12PD-GRN |
| * BROWN             | AT04-12PD     |

NOTE:

AN ASTERISKS ( \* ) PLACED BEFORE THE COLOR DENOTES THE STANDARD MOLDED COLOR OF THE CONNECTORS SHOWN ABOVE.

OTHER COLORS SHOWN ARE AVAILABLE VIA SPECIAL ORDER.

TITLE: RECEPTACLE, 12 PIN, AT SERIES, KEYED  
DWG NO.: AT04-12PX-XXX  
REV: A3  
SH: 2  
OF: 2

| QUANTITY  | PART NUMBER | DESCRIPTION  | ITEM                       |
|---|-------------|--|----------------------------|
| <b>MATERIALS LIST</b>   |             |  |                            |
| UNLESS OTHERWISE SPECIFIED:<br>1) All dimensions are in metric (mm).<br>2) Tolerances are as follows:<br>1 PL DEC ±0.30<br>2 PL DEC ±0.15<br>3 PL DEC ±0.08<br>Fractions ±1/64<br>Angles ±1°<br>3) Note reference = |             | SIGNATURES DATE<br>DRAWN: JARRY 02JAN14<br>CHECKED:<br>ENGINEER:<br>APPROVAL:  |                            |
| MATERIAL SPECIFICATIONS:  |             | CUSTOMER:  |                            |
| PROCESS SPECIFICATIONS:   |             | THIS DRAWING IS SUPPLIED FOR INFORMATION ONLY. DESIGN FEATURES, SPECIFICATIONS AND PERFORMANCE DATA SHOWN HEREON ARE THE PROPERTY OF THE AMPHENOL CORPORATION. NO RIGHTS OF REPRODUCTION ARE IMPLIED. ALL DIMENSIONS ARE SUBJECT TO NORMAL MANUFACTURING VARIATIONS. |                            |
| NEXT ASSY:  |             | SCALE: NONE  |                            |
|   |             | <br>Sine Systems - www.amphenol-sine.com<br>44724 Morley Drive<br>Clinton Township, MI 48036<br><b>RECEPTACLE, 12 PIN, AT SERIES, KEYED</b>  |                            |
|   |             | SIZE: <b>B C-</b>  | REVISION: <b>A3</b>        |
|   |             | DWG NO.: <b>AT04-12PX-XXX</b>  | SHEET <b>2</b> OF <b>2</b> |

## X-ON Electronics

Largest Supplier of Electrical and Electronic Components

*Click to view similar products for [Automotive Connectors](#) category:*

*Click to view products by [Amphenol](#) manufacturer:*

Other Similar products are found below :

[003-018-000](#) [60403001](#) [60993906-B](#) [M902-2131](#) [M902-2161](#) [72.330.1035.1](#) [73.353.4028.0](#) [F119300-B](#) [F166900](#) [F258300-B](#) [F358300-B](#)  
[F407400](#) [F444110](#) [F487000](#) [F509500B-B](#) [827153-1](#) [8N1515-32-24P](#) [9-1326729-8](#) [925474-1](#) [928905-1](#) [964562-4](#) [968782-1](#) [GT17SA-8DS-](#)  
[HU](#) [98891-1012](#) [98947-1016](#) [12004475-L](#) [12010290](#) [12010309-B](#) [12015454](#) [12020219-B](#) [12020308](#) [12041318-B](#) [12052225-L](#) [12052466](#)  
[12059125](#) [12064869](#) [12004327-B](#) [12010503-B](#) [12015308](#) [12015384](#) [12015909](#) [1-21030-1](#) [12041254](#) [12041318](#) [12047946-B](#) [12047957](#)  
[12047957-L](#) [12059473](#) [12066261](#) [12110546](#)