

P/N	A	B	DEUTSCH CROSS
ATSS-12-00	62.4mm	∅11.3mm	JS-12-00
ATSS-16-00	62.1mm	∅8.8mm	JS-16-00

REVISIONS					
REV	ECD	DESCRIPTION	DATE	BY	APPR
A1	-	RELEASE	12APR19	SULLEN	TOMMY

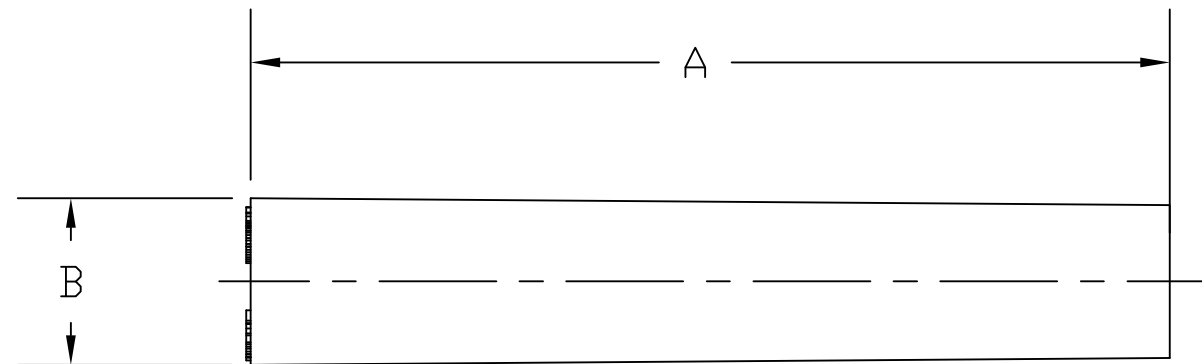
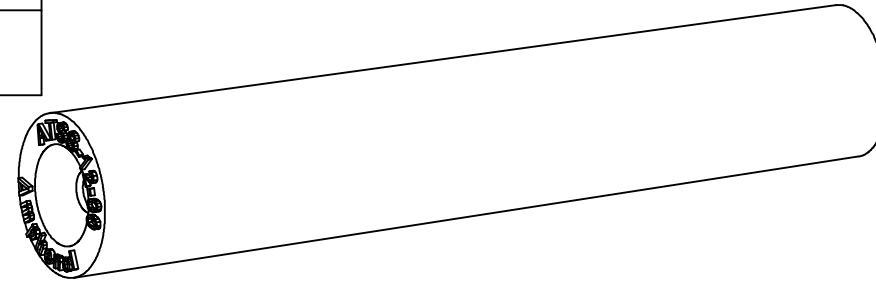

NOTES: UNLESS OTHERWISE SPECIFIED

1. MATERIAL:
SHELL: SILICONE RUBBER, RED
INTEGRATED CONTACT RETENTION SYSTEM

2. SPECIFICATIONS:
2.1 OPERATING TEMPERATURE: -55C TO +125C
2.2 MOISTURE RESISTANCE: IP67
2.3 MATING CYCLE DURABILITY: 100 CYCLES
2.4 RoHS COMPLIANT

3. ALL DIMENSIONS ARE FOR REFERENCE USE ONLY

4. CONTACT SIZE AND WIRE RANGE:

CONTACT SIZE	MIN. INSUL O.D	MAX. INSUL O.D	TYPICAL WIRE RANGE	CURRENT RATING
12	3.40mm (.134 in)	4.32mm (.170 in)	10-14AWG	25 AMPS
16	2.54mm (.100 in)	3.40mm (.134 in)	14-20AWG	13 AMPS

QUANTITY	PART NUMBER	DESCRIPTION	ITEM
MATERIALS LIST			
<small>UNLESS OTHERWISE SPECIFIED</small> <small>1) All dimensions are in metric (mm).</small> <small>2) Tolerances are as follows:</small> 1 PL DEC ±0.30 2 PL DEC ±0.15 3 PL DEC ±0.08 <small>Fractions ±1/64</small> <small>Angles ±1°</small> <small>3) Note reference =</small>		SIGNATURES DRAWN: SULLEN,ZHANG CHECKED: ORION,LI ENGINEER: APPROVAL: TOMMY,XIE CUSTOMER:	DATE 12APR19 12APR19 12APR19
MATERIAL SPECIFICATIONS: PROCESS SPECIFICATIONS:		 Sine Systems - www.amphenol-sine.com 44724 Morley Drive Clinton Township, MI 48036 SPEEDSPlice, SIZE X, ENVIROMENTAL	
NEXT ASS'Y:		THIS DRAWING IS SUPPLIED FOR INFORMATION ONLY. DESIGN FEATURES, SPECIFICATIONS AND PERFORMANCE DATA SHOWN HEREON ARE THE PROPERTY OF THE AMPHENOL CORPORATION. NO RIGHTS OF REPRODUCTION ARE IMPLIED. ALL DIMENSIONS ARE SUBJECT TO NORMAL MANUFACTURING VARIATIONS.	SIZE: B C- SCALE: NONE DWG NO: ATSS-XX-00 REVISION: A1 SHEET 1 OF 1

TITLE: SPEEDSPlice, SIZE 12, ENVIRONMENTAL DWG NO: ATSS-12-00 REV: A1 SH: 1 OF: 1

X-ON Electronics

Largest Supplier of Electrical and Electronic Components

Click to view similar products for [Terminals](#) category:

Click to view products by [Amphenol](#) manufacturer:

Other Similar products are found below :

[00-054007-01074-6](#) [00-054007-70206-1](#) [00-054007-70210-8](#) [00-054007-70217-7](#) [00-054007-70226-9](#) [00-054007-70228-3](#) [00-054007-70248-1](#) [00-054007-70256-6](#) [00-054007-70301-3](#) [00-054007-70316-7](#) [00-054007-49560-4](#) [00-054007-70209-2](#) [00-054007-70225-2](#) [00-054007-70227-6](#) [00-054007-70231-3](#) [00-054007-70241-2](#) [00-054007-70242-9](#) [00-054007-70244-3](#) [00-054007-70246-7](#) [00-054007-70263-4](#) [00-054007-70288-7](#) [00-054007-70290-0](#) [00-054007-70300-6](#) [00-054007-70304-4](#) [01-2065-1-0216](#) [01-2900-1-04412](#) [00581P0075](#) [600TS-10](#) [60205-1](#) [604200-1](#) [605601-1](#) [60598-1-CUT-TAPE](#) [61314-6-C](#) [61810-3](#) [61-S](#) [62149-1](#) [626-0194](#) [62-NBM-A](#) [62-SN](#) [62-SP](#) [640179-1](#) [M55155/059I03](#) [M55155/079C01](#) [M55155/099H02](#) [M55155/109H01](#) [M55155/109H02](#) [M55155/12XH05](#) [M55155/16XH02](#) [M55155/29-5S](#) [M55155/29XJ08](#)