

THIS DOCUMENT IS SUBJECT TO CHANGE WITHOUT NOTICE. IT IS CONFIDENTIAL AND A PROPERTY OF Amphenol LTW. DISCLOSURE TO THIRD PARTY HAS TO BE AUTHORIZED BY Amphenol LTW.

REV.	ECN NO.	DATE	SIGN	DESCRIPTION

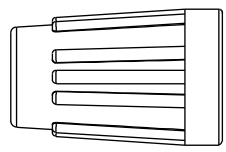

⑦ Sealing Nut

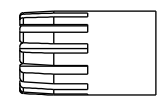

⑥ Clamp Ring

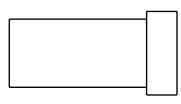

⑤ Seals B2

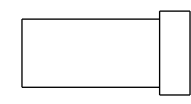

④ Seals B1

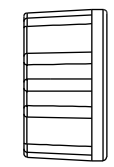

③ Nut

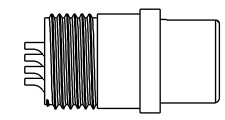

② Connector



① O-Ring

ALTW  
DCC. DEPT.  
CONFIDENTIAL  
2012-04-03  
ISSUED

ALTW  
CONFIDENTIAL  
2012-03-23  
R&D DEPT.

Note:

- \* Seals B1 for Cable OD:  $\varnothing 4.5\text{mm} \sim \varnothing 6.5\text{mm}$   
(防水墊圈B1線徑:  $\varnothing 4.5\text{mm} \sim \varnothing 6.5\text{mm}$ )
- \* Seals B2 for Cable OD:  $\varnothing 3.5\text{mm} \sim \varnothing 5.3\text{mm}$   
(防水墊圈B2線徑:  $\varnothing 3.5\text{mm} \sim \varnothing 5.3\text{mm}$ )
- \* One Set Unassembled in One PE Bag  
(每一組未組裝, 放置於一個PE袋, 並封口)
- \*  $\varnothing$  Important Dimension.
- \* Waterproof Rate : IP66
- \* Ring: Black, EPDM
- \* Housing: Black, Nylon+GF
- \* Pin: Copper Alloy, Gold Plated
- \* Screw Nut: Black, Nylon+GF
- \* Seals: Black, EPDM
- \* Clamping Ring: Black, Nylon
- \* Sealing Nut: Black, Nylon
- \* PE Bag: 90mm\*85mm

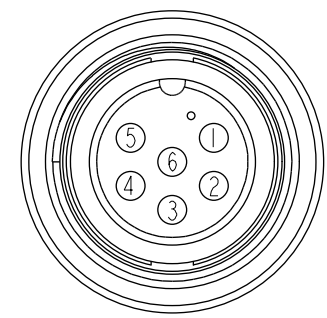
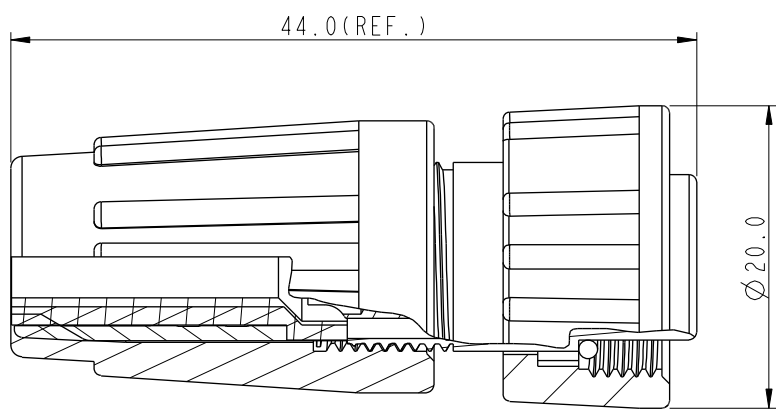

Pin Assignments  
Front View 前視圖

UNIT: mm  TOLERANCE .X ±0.25 .XX ±0.1 .XXX ±0.05 ANGLES ±1°	TITLE Standard, Assy Lock 6Pin F Conn F Pin			ITEM NO. BD-06BFFA-SL6001		DRAWN BY SamChang		DATE 2012-03-23	
	SCALE 1:1    SIZE A4    SHEET 1 OF 1			DWG NO. BD-06BFFA-SL6001		CHECKED BY Jeffrey		DATE 2012-04-03	
	REV. A    WC-REV. A.2 $\varnothing$ Inspection item			CUSTOMER ALTW		APPROVED BY Lion		DATE 2012-04-03	
<b>Amphenol LTW</b> 安費諾亮泰企業股份有限公司				8 FMM10702-01-02A1					

## X-ON Electronics

Largest Supplier of Electrical and Electronic Components

*Click to view similar products for [Standard Circular Connector](#) category:*

*Click to view products by [Amphenol](#) manufacturer:*

Other Similar products are found below :

[5M2530B10P](#) [600259N006](#) [600273N007](#) [6134-336-13149](#) [6134-337-11149](#) [6134-337-2390](#) [6134-341-17149](#) [6280-4SG-516](#) [6280-7SG-3DC](#)  
[6290](#) [6291A](#) [66200A-10](#) [680-SMG](#) [681-PMG](#) [CXS3102A14S2P](#) [CXS3102A181S](#) [7251-6SG-300](#) [7271-6SG-300](#) [7282-3PG-300-CH3](#) [75-](#)  
[474014-05S](#) [75-474618-01S](#) [75-474618-04P](#) [75-474618-04S](#) [799539-000](#) [MI8-SE](#) [805-005-07NF11-19PC](#) [805-005-07NF15-7PA](#) [8280-4PG-](#)  
[516](#) [8280-7PG-519](#) [8282-5PG-519](#) [836783-1](#) [MP-4102-25P-C](#) [862256-1](#) [864019-2](#) [866857-1](#) [867865-1](#) [PT01SP-14-18P](#) [PT08P-14-5S](#)  
[PTSF06SE-14-12S](#) [120-1833-000](#) [QCM019PC2DC012B](#) [1-2069279-1](#) [121583-0217](#) [121667-0020](#) [129591AU](#) [1000B BULK](#) [RD10A16-19-](#)  
[P6CS051/1](#) [RD10A20-31-P8CS051/1](#) [RD16A14-12-S6CS051/2](#) [1301240290](#) [1301240347](#)