

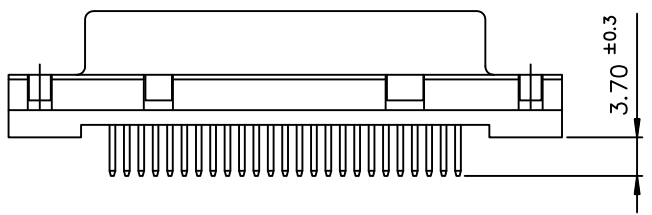

FCIconnect.com

Copyright FCI

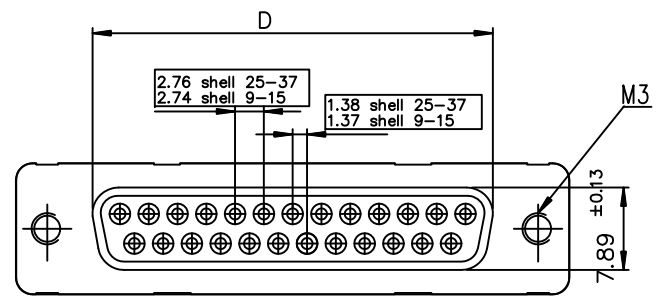
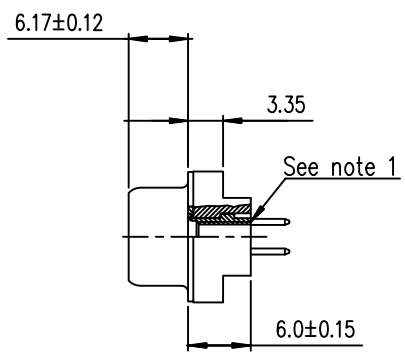
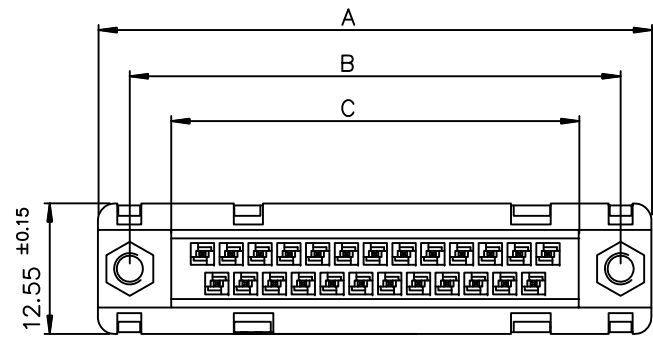

PC card drilling dimensions(after plating)
(thickness 2.40±0.20mm)

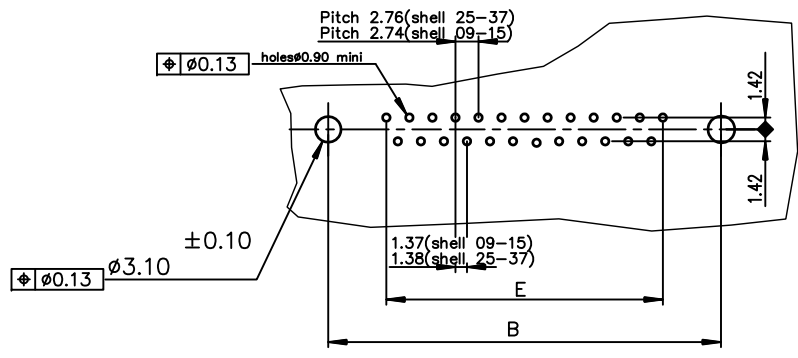

GENERAL CHARACTERISTICS AND ROHS INFORMATIONS:
SEE DRAWING C01-8646-0000

LEAD FREE PART NUMBER

| SHELL | A±0.38 | B±0.12 | C±0.10 | D±0.25 | E±0.07 | PART NUMBER |
|-------|--------|--------|--------|--------|--------|----------------|
| 09 | 30.81 | 24.99 | 16.96 | 16.21 | 10.96 | D09S24B.PL00LF |
| 15 | 39.14 | 33.32 | 25.18 | 24.54 | 19.18 | D15S24B.PL00LF |
| 25 | 53.03 | 47.04 | 39.12 | 38.25 | 33.12 | D25S24B.PL00LF |
| 37 | 69.32 | 63.50 | 55.68 | 54.71 | 49.68 | D37S24B.PL00LF |

Plating: 4 --> flash AU
Plating: 6 --> 0.76µ AU

Notes:

1) The nut can protrude above the surface of insulator but maintaining the footprint dimension 6±0.15 mm.

| | | | | | | | | | |
|-------------|-------------|------------------|------------|---------------------------------------|-------------|------------|--|--------------------------------------|--|
| mat'l. code | | surface ISO 1302 | | tolerance ISO 406 ISO 1101 | | projection | | product family | |
| - | | ✓ | | | | MM | | D-SUB | |
| ltr | ecn no | dr | date | tolerances unless otherwise specified | | MM | | title | |
| E | ELX-I-21256 | AB | 2015/07/14 | | | scale 2:1 | | FEMALE CONNECTOR DELTA-D | |
| | | | | angles | linear | | | STRAIGHT - SOLDER TYPE FOR PCB 2.4mm | |
| | | | | 0°±2' | .0±0.1 | | | dwg no | |
| | | | | | .00±0.1 | | | sheet 1 of 1 | |
| | | | | | .000±0.1 | | | size | |
| | | | | dr | LELEON | 1992/09/16 | | A3 | |
| | | | | engr | ALIAS BABU | 2015/07/14 | | C01-8646-0121 | |
| | | | | chr | MITHUN PAUL | 2015/07/14 | | type | |
| | | | | app | BIJU K PAUL | 2015/07/14 | | Product Customer Drawing | |
| sheet index | revision | E | | | | | | | |
| | sheet | 1 | | | | | | | |

X-ON Electronics

Largest Supplier of Electrical and Electronic Components

Click to view similar products for [D-Sub Standard Connectors](#) category:

Click to view products by [Amphenol](#) manufacturer:

Other Similar products are found below :

[56F706-005-LI](#) [56F711-015](#) [LV242999-142T12](#) [015-0341-000](#) [015-0372-005](#) [015-0372-008](#) [015-8755-001](#) [020419-0104](#) [012-0467-000](#)
[012-9507-034](#) [012-9507-114](#) [020745-0008](#) [609-25P](#) [CT2-18-11PCAU](#) [CT6-10SL-3SC](#) [CT6-10SL-4SC](#) [CT6-14S-2SC](#) [CT6E14SA7SC](#)
[CT6N10SL-4SSA34](#) [M83513/01-FC](#) [M83723/76W24619 L/C](#) [M85049/48-3-2F](#) [6STD09PCM99B70X](#) [6STD09SCM99B30X](#)
[6STD09SCT99S40X](#) [6STD15PCT99S40X](#) [6STD15SCT99S40X](#) [6STF09PCM05B70X](#) [7-135760-9](#) [MC11E-10-6SN](#) [747552-3](#) [MD1-21PS](#)
[MDM-15SCBRM7-F222](#) [MDM96517-699](#) [MDM96521-744](#) [MDVB1-21SL1](#) [MIK0-1-7SH003](#) [MIKQ6-7SH076](#) [MIKQ7-7PH077](#) [MIKQ7-](#)
[7PH11](#) [MIKQ7-7PH32](#) [MJSV-28SL61](#) [MKJ4A1F14-55S](#) [8-135760-3](#) [8STD09PCM99B30X](#) [PG-KV/PV-16-GROM-SEALING](#) [GDA15P](#)
[GDAY15PB](#) [980-0000-170](#) [980-0000-171](#)