

LEAD FREE PART NUMBER

SHELL	A±0.38	B±0.12	C±0.10	D±0.25	E±0.07	Flash Au Plating	0.76µ Au Plating
09	30.81	24.99	16.96	16.21	10.96	D09S33E4G*09LF	D09S33E6G*09LF
15	39.14	33.32	25.18	24.54	19.18	D15S33E4G*09LF	D15S33E6G*09LF
25	53.03	47.04	39.12	38.25	33.12	D25S33E4G*09LF	D25S33E6G*09LF

Part Number & Date Code Printing

L --> ØT=M3
X --> ØT=UNC 4-40

PC card drilling dimensions(after plating)
(thickness 1.60±0.20mm)

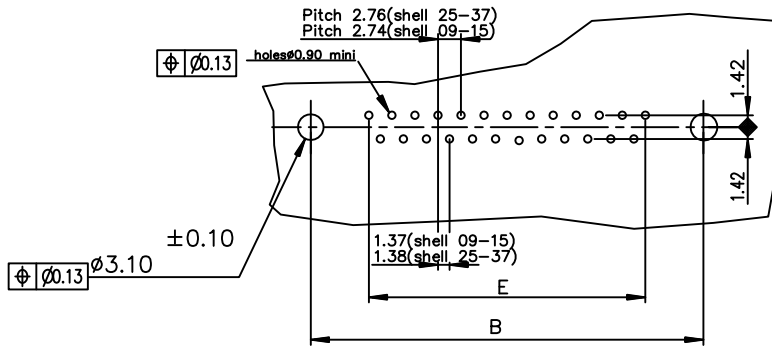

Technical characteristics:

Insulators: self-extinguishing thermoplastic, UL class 94V0, IR or reflow process compatible

Climatic characteristics:

Operating temperature range: -55°C +225°C

FOR ALL OTHER DETAILS REFER DWG.NO: C01-8646-0000

mat'l. code	-	surface	ISO 1302	tolerance	ISO 406	ISO 1101	projection	product family	D-SUB
ltr	ecn no	dr	date	tolerances unless otherwise specified			MM	title	
E	ELX-I-2146	AB	2015-07-22	angles	linear	.0±0.1	MM	DD RA SOCKET CONNECTOR	
				0'±2'		.00±0.1	scale 2:1	HIGH TEMPERATURE INSULATOR	
				dr	JOHN SLEEBA	1996-06-21		dwg no	sheet 1 of 1
				engr	ALIAS BABU	2015-07-22		C01-8646-0449	A3
				chr	MITHUN PAUL	2015-07-22		type Product Customer Drawing	
				appd	BIJU K PAUL	2015-07-22			
sheet index	revision	E							
	sheet	1							

X-ON Electronics

Largest Supplier of Electrical and Electronic Components

Click to view similar products for [D-Sub Standard Connectors](#) category:

Click to view products by [Amphenol](#) manufacturer:

Other Similar products are found below :

[56F706-005-LI](#) [56F711-015](#) [LV242999-142T12](#) [015-0341-000](#) [015-0372-005](#) [015-0372-008](#) [015-8755-001](#) [020419-0104](#) [012-0467-000](#)
[012-9507-034](#) [012-9507-114](#) [020745-0008](#) [609-25P](#) [CT2-18-11PCAU](#) [CT6-10SL-3SC](#) [CT6-10SL-4SC](#) [CT6-14S-2SC](#) [CT6E14SA7SC](#)
[CT6N10SL-4SSA34](#) [M83513/01-FC](#) [M83723/76W24619 L/C](#) [M85049/48-3-2F](#) [6STD09PCM99B70X](#) [6STD09SCM99B30X](#)
[6STD09SCT99S40X](#) [6STD15PCT99S40X](#) [6STD15SCT99S40X](#) [6STF09PCM05B70X](#) [7-135760-9](#) [MC11E-10-6SN](#) [747552-3](#) [MD1-21PS](#)
[MDM-15SCBRM7-F222](#) [MDM96517-699](#) [MDM96521-744](#) [MDVB1-21SL1](#) [MIK0-1-7SH003](#) [MIKQ6-7SH076](#) [MIKQ7-7PH077](#) [MIKQ7-](#)
[7PH11](#) [MIKQ7-7PH32](#) [MJSV-28SL61](#) [MKJ4A1F14-55S](#) [8-135760-3](#) [8STD09PCM99B30X](#) [PG-KV/PV-16-GROM-SEALING](#) [GDA15P](#)
[GDAY15PB](#) [980-0000-170](#) [980-0000-171](#)