

PC board drilling dimensions (after plating)

(thickness ≤ 3.20±0.30mm)

Pitch 2.76(shell 25-37)

pitch 2.74(shell 09-15)

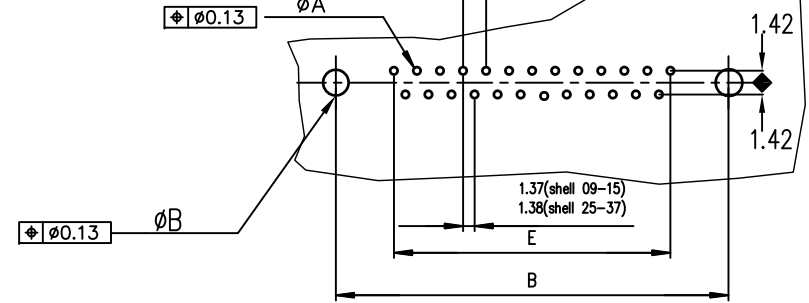

ROHS PART NUMBER

SHELL	A±0.38	B±0.12	C±0.10	D±0.25	E±0.07	PART NUMBER
09	30.81	24.99	16.96	16.21	10.96	D09S91C*GL00LF
15	39.14	33.32	25.18	24.54	19.18	D15S91C*GL00LF
25	53.03	47.04	39.12	38.25	33.12	D25S91C*GL00LF
37	69.32	63.50	55.68	54.71	49.68	D37S91C*GL00LF

Plating: 4 --> 200 mating
 Plating: 6 --> 500 Mating
 Plating: 8 --> 1.25µ Equivalent PdNi/Au

GENERAL CHARACTERISTICS AND ROHS INFORMATIONS:
 SEE DRAWING C01-8646-0001

mat'l. code		surface ISO 1302 ✓		tolerance ISO 406 ISO 1101		projection mm		product family D-SUB	
ltr	ecn no	dr	date	tolerances unless otherwise specified		mm		title	
J	ELX-I-21654	AB	2015-10-26	angles	linear	scale 2:1		FEMALE DELTA-D STRAIGHT PRESS-FIT	
K	ELX-I-24020	AAB	2016-06-06	0°±2'				dwg no sheet 1 of 1 size	
				dr	PESSON	1995-10-03	Amphenol FCi		C01-8646-0303 A3
				engr	MITHUN PAUL	2016-06-06			
				chr	ATHUL A.B	2016-06-06			
				appd	BIJU K PAUL	2016-06-06			
sheet index	revision	K		type Product Customer Drawing					
	sheet	1							

X-ON Electronics

Largest Supplier of Electrical and Electronic Components

Click to view similar products for [D-Sub Standard Connectors](#) category:

Click to view products by [Amphenol](#) manufacturer:

Other Similar products are found below :

[56F706-005-LI](#) [56F711-015](#) [LV242999-142T12](#) [015-0341-000](#) [015-0372-005](#) [015-0372-008](#) [015-8755-001](#) [020419-0104](#) [012-0467-000](#)
[012-9507-034](#) [012-9507-114](#) [020745-0008](#) [609-25P](#) [CT2-18-11PCAU](#) [CT6-10SL-3SC](#) [CT6-10SL-4SC](#) [CT6-14S-2SC](#) [CT6E14SA7SC](#)
[CT6N10SL-4SSA34](#) [M83513/01-FC](#) [M83723/76W24619 L/C](#) [M85049/48-3-2F](#) [6STD09PCM99B70X](#) [6STD09SCM99B30X](#)
[6STD09SCT99S40X](#) [6STD15PCT99S40X](#) [6STD15SCT99S40X](#) [6STF09PCM05B70X](#) [7-135760-9](#) [MC11E-10-6SN](#) [747552-3](#) [MD1-21PS](#)
[MDM-15SCBRM7-F222](#) [MDM96517-699](#) [MDM96521-744](#) [MDVB1-21SL1](#) [MIK0-1-7SH003](#) [MIKQ6-7SH076](#) [MIKQ7-7PH077](#) [MIKQ7-](#)
[7PH11](#) [MIKQ7-7PH32](#) [MJSV-28SL61](#) [MKJ4A1F14-55S](#) [8-135760-3](#) [8STD09PCM99B30X](#) [PG-KV/PV-16-GROM-SEALING](#) [GDA15P](#)
[GDAY15PB](#) [980-0000-170](#) [980-0000-171](#)