

## D-SUBMINIATURE (D-SUB) D/8656/ DP SERIES

Amphenol's D-Subminiature (D-Sub) connectors are part of an industry standard for applications requiring robust and reliable connectors. These proven D-Sub connectors are one of the most popular Input/Output interconnects, addressing a wide variety of applications in telecommunications, data, consumer, industrial, military, instrumentation and medical. Amphenol offers a wide range of D-Sub connectors to meet various design requirements including those in harsh environment.

These high performance connectors are designed for severe environment applications in the field of telecommunications, aerospace, military (125°C) class and for particularly severe applications, especially high temperature (+155°C) class. It features machined contacts and is available in solder bucket, straight spills, angled spills and wire wrap terminations.



### TARGET MARKETS



### FEATURES

- A Basic I/O connector comes with five shell size and housing design
- Has a D-shaped shell design
- Meets DIN 41652 and MIL-C-24308 dimensional standards
- Available in Straight, Angle, Wire Wrap, Solder Bucket, Crimp terminations
- Frugal- D design (2 shells + 2 housings) with stamped & formed contacts
- DP series comes with screw machined contacts
- Various PCB and Panel mounting accessory options available
- Hoods available in plastic, metalized and metallic form with locking screws
- Lead-free and RoHS compliant

### BENEFITS

- Most popular Rugged and sturdy I/O connector
- Supports the need for polarisation
- Interchangeable and intermateable with other makes
- Support both PCB & Cable mounting requirements
- Economical solution
- Can meet 7.A current rating and suitable for high-end applications
- Wide variety of choices for secure connection
- Supports cable connection; Prevents risks of pulling up and accidental un-mating
- Meets environmental, health and safety requirements

## STAMPED AND ROLLED CONTACTS



D series is the standard D-Sub full metal shell version with stamped contacts. This design is basically proposed in solder bucket, straight and angled version without accessories



### PART NUMBER SELECTOR

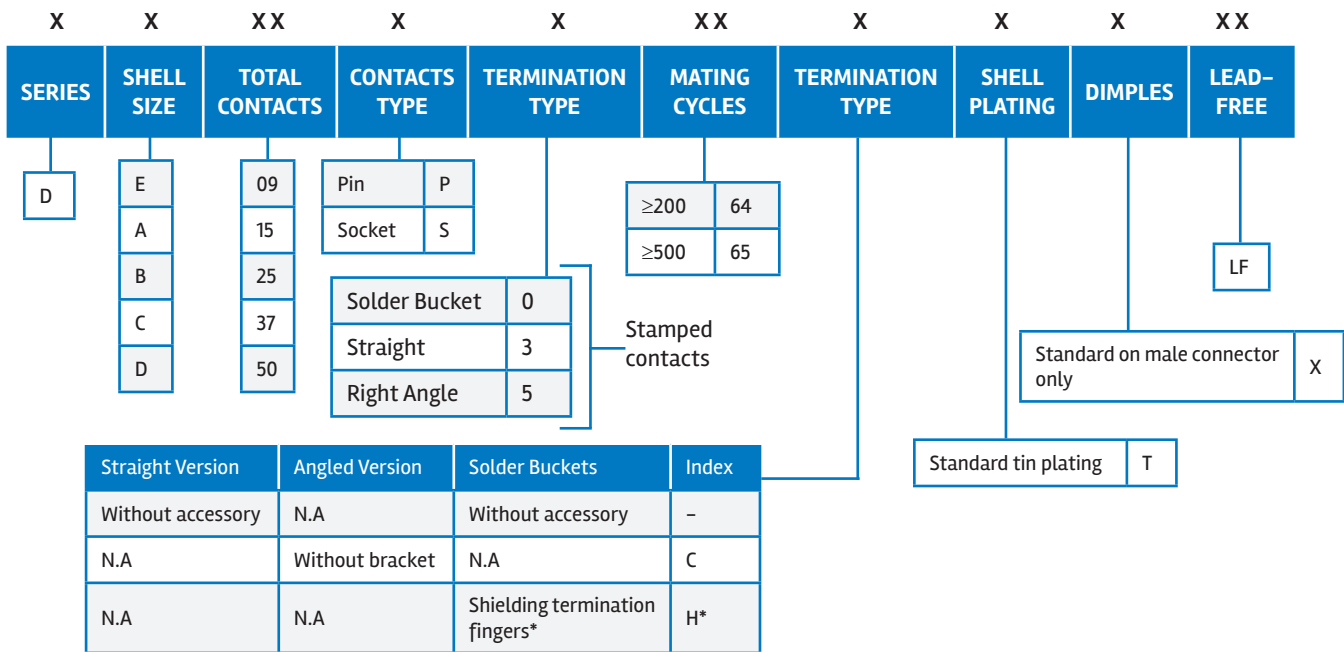

### SPECIFIC DIMENSIONS

Solder Buckets

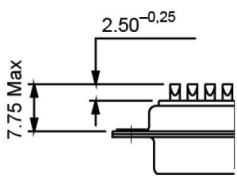

Straight Spills

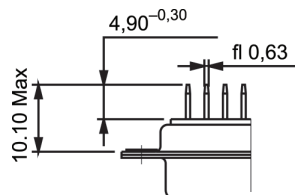

Right Angle Spills

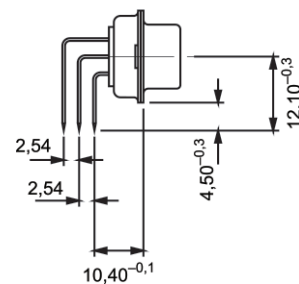
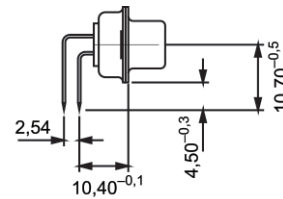

# CRIMP CONTACTS AND CABLE CONNECTORS



- 8656 series is a D connector with removable crimp contacts for AWG 20/24 or 24/28 wires
- It is used for commercial cabling like computer equipment, cash register
- It accepts our standard accessories (hoods, locking devices) and is available with a complete range of crimping tools from hand tools to high volume production equipment



## PART NUMBER SELECTOR

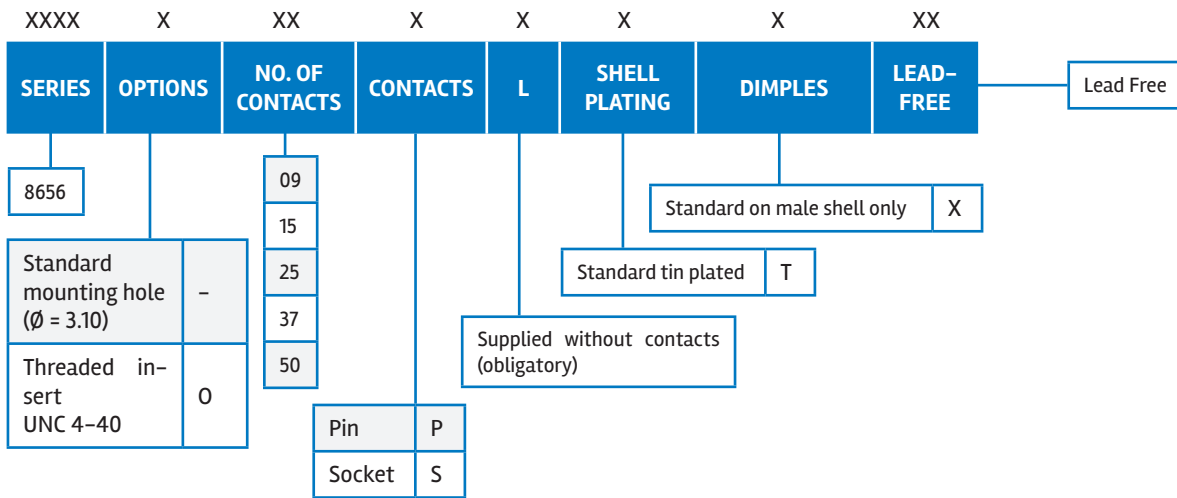

## PART NUMBER

Contact Type	Packaging Type		
	Box of 500 Contacts ✓	Reel of 400 Contacts R	Reel of 5000 Contacts ✓
AWG 24/28 male	865635006 Δ	8656300306 Δ	8656451006 Δ
AWG 24/28 female	865635106 Δ	8656300406 Δ	8656651006 Δ
AWG 20/24 male	865635206 Δ	8656300506 Δ	8656452006 Δ
AWG 20/24 female	865635306 Δ	8656300606 Δ	8656652006 Δ

Δ Contact performance code

4LF: ≥200 mating/unmating, RoHS compatible  
5LF: ≥500 mating/unmating, RoHS compatible

## SPECIFIC DIMENSIONS

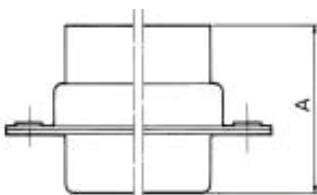

## CABLE PREPARATION

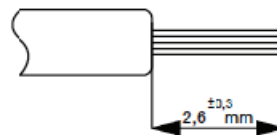

Contacts	09	15	25	37	50
A <sub>Max.</sub> Pin	17.19	17.19	17.35	17.35	17.35
Socket	17.44	17.44	17.44	17.44	17.44

# MACHINED CONTACTS



• DP series is designed for high performance applications, particularly in the field of telecommunications: data transmission, private automatic branch switching, telecom (LNZ listed)

• It features machined contacts and is available with solder bucket, straight spills, angled spills, and wire wrap terminations

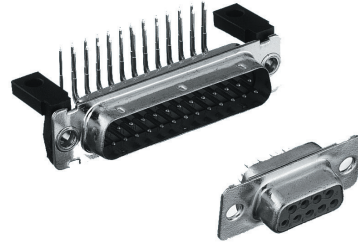

## PART NUMBER SELECTOR

X	X	X	X	XX	X	X	XX	X	X	X	XX
SERIES	SHELL SIZE	P	FRONT ACCESSORIES	NO. OF CONTACTS	CONTACTS	TERMINATION TYPE	MATING CYCLES	C	SHELL PLATING	DIMPLES	LEAD-FREE
D	E A B C D				Pin P Socket S						LF X
	Characterisation of DP series								Standard tin plated T		
			Standard mounting hole (∅ = 3.10)	-	09						
			Threaded insert M3	L	15						
			Female screw locks UNC 4-40	V	25						
			Spacers (straight spills only)	S	37 50						
			Solder buckets (N.A for plating 00)	-							
			Straight spills	3							
			Angled spills- 2.54mm between rows	5							
			Angled spills- 2.84mm between rows	8							
			Wire wrap (3 levels)	4							
			≥200	64							
			≥500; N.A for solder bucket termination	65							

Straight Spills	Angled Spills	Solder Buckets	Wire Wrap	Index
Without accessory	Two plastic brackets*	Without accessory	-	-
-	Without bracket	-	-	C
-	Two metal brackets	-	-	M
Harpoons (Compulsory with option L or V)	Harpoons (9 to 37 ways only)	-	-	G
-	-	Shielding termination fingers	-	H

PCB Accessories

\*Except 50 pos. with monobloc plastic brackets

## ► D-SUBMINIATURE (D-SUB) D/8656/ DP SERIES

### SPECIFIC DIMENSIONS

Solder Buckets

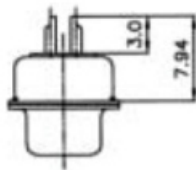

Wire Wrap

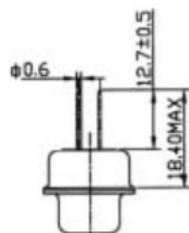

Right Angle Spills

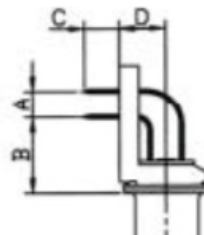

Straight Spills

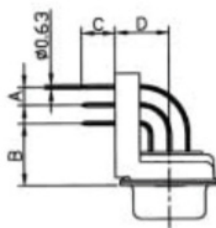
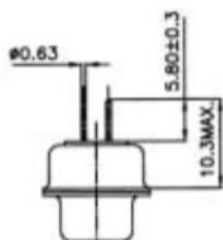

Dimension		Termination Code	
		5	8
A		2.54	2.84
$B^{\pm 0.1}$		10.30	10.30
$C^{\pm 0.5}$		4.00	4.00
$D^{\pm 0.19}$	9 to 37 contacts	7.20	7.20
	50 contacts	8.60	8.60

## TARGET MARKETS/APPLICATIONS

### TARGET MARKETS/APPLICATIONS



Asymmetric Digital Subscriber Line (ADSL)  
Base Station  
Switching  
Transmission



Set-top Box



Desktop and Laptop  
Storage System  
Router and Server



Automotive Diagnostics  
Control Drives  
Energy Meter  
Gaming Machine  
Test Equipment  
Office Automation  
POS & Handheld terminal  
Power Supplies  
Parking Meter  
Printer and Copier  
Renewable Energy  
Robotics  
Surveillance Camera



Medical Instrument



Avionics  
Military Equipment

## X-ON Electronics

Largest Supplier of Electrical and Electronic Components

*Click to view similar products for [D-Sub Standard Connectors](#) category:*

*Click to view products by [Amphenol](#) manufacturer:*

Other Similar products are found below :

[56F706-005-LI](#) [56F711-015](#) [012-9507-004](#) [LV242999-142T12](#) [015-0341-000](#) [015-0372-005](#) [015-0372-008](#) [015-8755-001](#) [020419-0104](#)  
[012-0467-000](#) [012-0515-000](#) [012-9507-034](#) [012-9507-114](#) [020745-0008](#) [609-25P](#) [CT2-14S-2PCA34](#) [CT2-18-11PCAU](#) [CT6-10SL-3SC](#)  
[CT6-10SL-4SC](#) [CT6-14S-2SC](#) [CT6E14SA7SC](#) [CT6N10SL-4SSA34](#) [M83513/01-FC](#) [M83723/76W24619 L/C](#) [M85049/48-3-2F](#)  
[6STD09PCM99B70X](#) [6STD09SCM99B30X](#) [6STD09SCT99S40X](#) [6STD15PCT99S40X](#) [6STD15SCT99S40X](#) [6STF09PCM05B70X](#) [7-](#)  
[135760-9](#) [MC11E-10-6SN](#) [747552-3](#) [MD1-21PS](#) [MDM-15SCBRM7-F222](#) [MDM96517-699](#) [MDM96521-744](#) [MDVB1-21SL1](#) [MIK0-1-](#)  
[7SH003](#) [MIKQ6-7SH076](#) [MIKQ7-7PH077](#) [MIKQ7-7PH11](#) [MIKQ7-7PH32](#) [MJSV-28SL61](#) [MKJ4A1F14-55S](#) [8-135760-3](#)  
[8STD09PCM99B30X](#) [PG-KV/PV-16-GROM-SEALING](#) [GDA15P](#)