

PC card drilling dimensions(after plating)
(thickness 2.40±0.20mm)

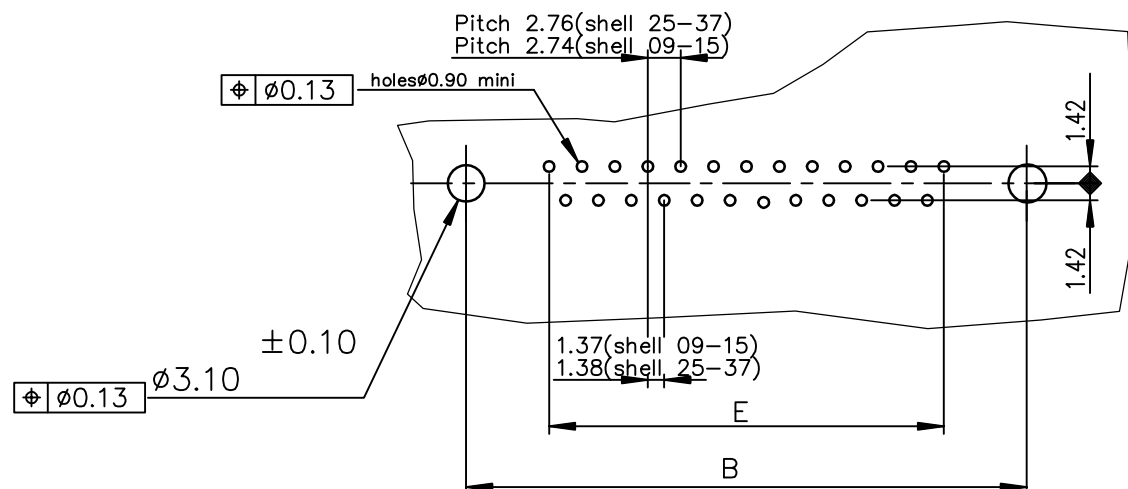

GENERAL CHARACTERISTICS AND ROHS INFORMATIONS:
SEE DRAWING C01-8646-0000

LEAD FREE PART NUMBER

SHELL	A±0.38	B±0.12	C±0.10	D±0.25	E±0.07	PART NUMBER
09	30.81	24.99	16.96	16.21	10.96	D09S24B.PX00LF
15	39.14	33.32	25.18	24.54	19.18	D15S24B.PX00LF
25	53.03	47.04	39.12	38.25	33.12	D25S24B.PX00LF
37	69.32	63.50	55.68	54.71	49.68	D37S24B.PX00LF

Plating: 4 --> flash AU
Plating: 6 --> 0.76µ AU

Notes:

1) The nut can protrude above the surface of insulator but maintaining the footprint dimension 6±0.15 mm.

mat'l. code		surface		tolerance		projection		product family	
-		ISO 1302 ✓		ISO 406 ISO 1101				D-SUB	
ltr		ecn no	dr	date		tolerances unless otherwise specified		title	
E	ELX-I-22878	AB	2015/01/06			.0±0.1 .00±0.1 .000±0.1		FEMALE CONNECTOR DELTA-D STRAIGHT - SOLDER TYPE FOR PCB 2.4mm	
				angles		linear		MM	
				0°±2'				scale 2:1	
		dr		LELEON		1992/09/16		dwg no	
		enr		ALIAS BABU		2015/01/06		sheet 1 of 1	
		chr		MITHUN PAUL		2015/01/06		size	
		app		BIJU K PAUL		2015/01/06		A3	
sheet index		revision sheet		E				type	
		1						Product Customer Drawing	



X-ON Electronics

Largest Supplier of Electrical and Electronic Components

Click to view similar products for [D-Sub Standard Connectors](#) category:

Click to view products by [Amphenol](#) manufacturer:

Other Similar products are found below :

[56F706-005-LI](#) [56F711-015](#) [012-9507-004](#) [LV242999-142T12](#) [015-0341-000](#) [015-0372-005](#) [015-0372-008](#) [015-8755-001](#) [020419-0104](#)
[012-0467-000](#) [012-9507-034](#) [012-9507-114](#) [020745-0008](#) [609-25P](#) [CT2-18-11PCAU](#) [CT6-10SL-3SC](#) [CT6-10SL-4SC](#) [CT6-14S-2SC](#)
[CT6E14SA7SC](#) [CT6N10SL-4SSA34](#) [M83513/01-FC](#) [M83723/76W24619 L/C](#) [M85049/48-3-2F](#) [6STD09PCM99B70X](#) [6STD09SCM99B30X](#)
[6STD09SCT99S40X](#) [6STD15PCT99S40X](#) [6STD15SCT99S40X](#) [6STF09PCM05B70X](#) [7-135760-9](#) [MC11E-10-6SN](#) [747552-3](#) [MD1-21PS](#)
[MDM-15SCBRM7-F222](#) [MDM96517-699](#) [MDM96521-744](#) [MDVB1-21SL1](#) [MIK0-1-7SH003](#) [MIKQ6-7SH076](#) [MIKQ7-7PH077](#) [MIKQ7-](#)
[7PH11](#) [MIKQ7-7PH32](#) [MJSV-28SL61](#) [MKJ4A1F14-55S](#) [8-135760-3](#) [8STD09PCM99B30X](#) [PG-KV/PV-16-GROM-SEALING](#) [GDA15P](#)
[GDAY15PB](#) [980-0000-170](#)