

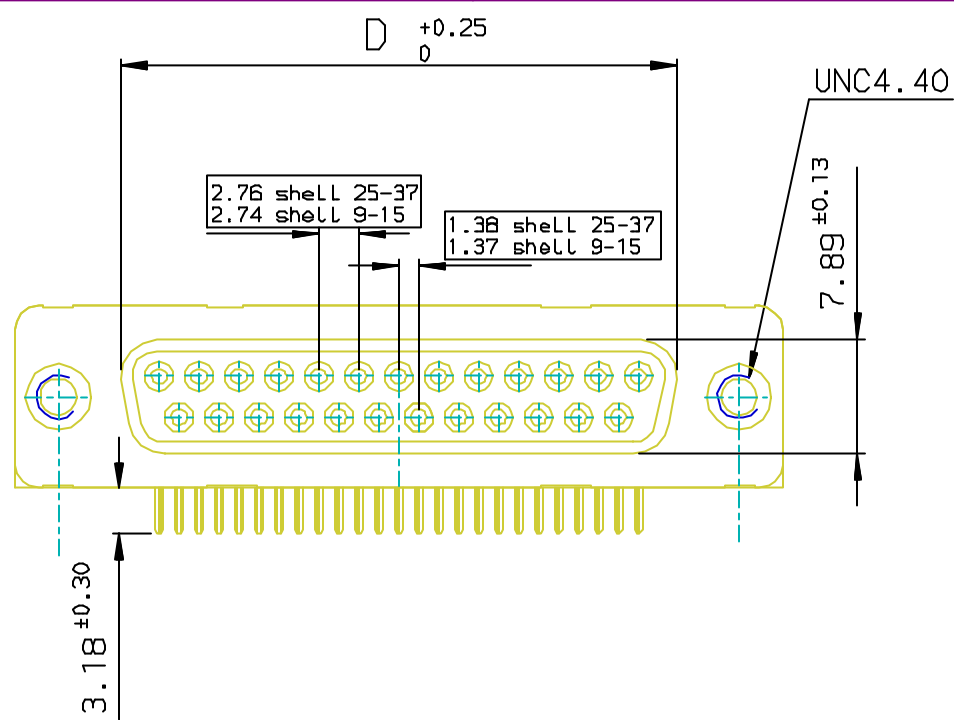

Copyright FCI.

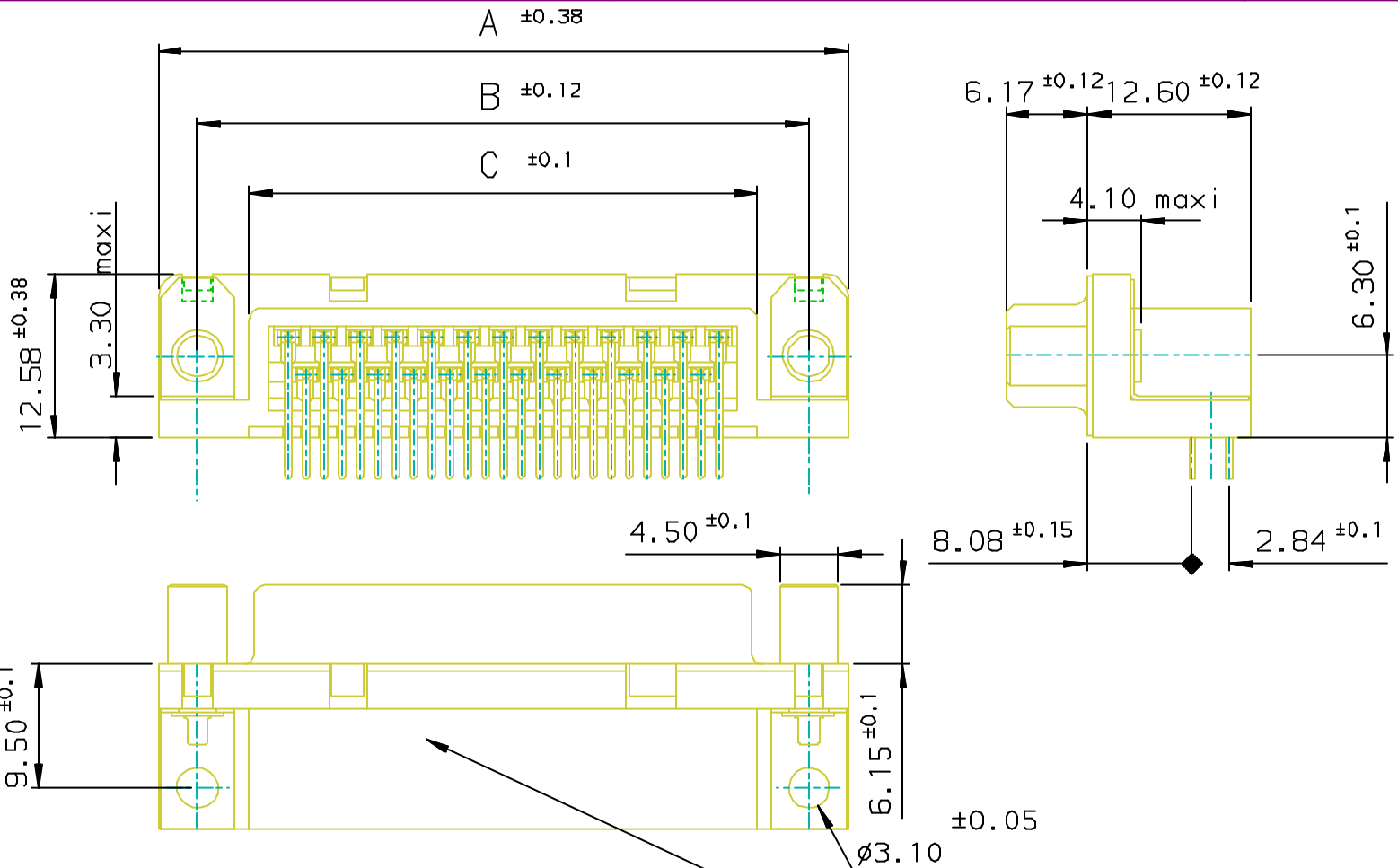

PC card drilling dimensions(after plating)
(thickness 1.60±0.20mm)

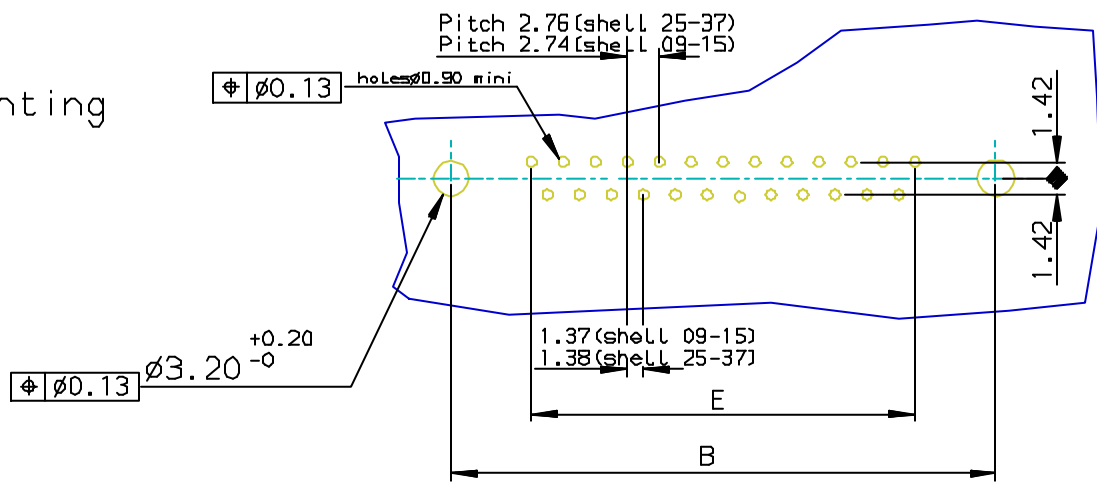

| SHELL | A±0.38 | B±0.12 | C±0.10 | D±0.25 | E±0.07 | PART NUMBER |
|-------|--------|--------|--------|--------|--------|----------------|
| 09 | 30.81 | 24.99 | 16.96 | 16.21 | 10.96 | D09S33E6UV00** |
| 15 | 39.14 | 33.32 | 25.18 | 24.54 | 19.18 | D15S33E6UV00** |
| 25 | 53.03 | 47.04 | 39.12 | 38.25 | 33.12 | D25S33E6UV00** |
| 37 | 69.32 | 63.50 | 55.68 | 54.71 | 49.68 | D37S33E6UV00** |

Part Number & Date Code Printing

LF FOR LEAD FREE

REQUIREMENTS

Technical characteristics:
 Shell: steel tin/Zinc Cr3 plated
 Insulators: self-extinguishing black polyster, ULclass94V0
 Contacts size 20: phosphor bronze, gold 0.76µ on mating end, bright tin on termination end over nickel on entire contact
 Cycles > 500 .

Metal plate for electrical continuity: brass, tin/Zinc Cr3 plated
 Screwlock: brass, tin/Zinc Cr3 plated

Electrical characteristics:
 max. current rating: 5A
 Test voltage: 1000V
 Rated voltage: 300V
 Contact resistance: ≤15ma
 Shell resistance: ≤5ma
 Insulation resistance: ≥5000Ma

Climatic characteristics:
 Operating temperature range: -55°c +125°c

Dimensions:
 in accordance with MIL-C-24308

FOR ROHS DETAILS REFER DWG.NO:C01-8646-0000

European Views

| rev | ecn no | dr | date |
|-----|----------|----|------------|
| B | 105-0124 | JS | 2005/07/27 |
| C | 106-0074 | SK | 2006/06/08 |
| - | - | - | - |
| - | - | - | - |
| - | - | - | - |
| - | - | - | - |

| | | | | |
|---------------------------------------|-------------|--|-----------------------------------|-----------------------|
| www.fciconnect.com | | surface ISO 1302 ✓ | tolerance std ISO 406 ISO 1101 | projection mm |
| TOLERANCES UNLESS OTHERWISE SPECIFIED | | | | |
| Dr | JOHN SLEEBA | 1993/04/07 | ANGULAR | 0.X ±0.1 |
| Eng | GEORGE VJ | 1993/04/07 | LINEAR | 0.XX ±0.1 |
| Chr | GEORGE VJ | 2005/07/27 | 0.XX* ±1* | 0.XXX ±0.1 |
| Appr | KVSD | 2005/07/27 | Product family | D-SUB |
| FCI | | title SOCKET CONNECT.DELTA D right angle screwlock & metal plate | | Rev. C |
| catalog no | | DELTA-D | | dwg no C-8646-0149 |
| | | CUSTOMER | | sheet 1 of 1 |

REV F - 2006-04-17

X-ON Electronics

Largest Supplier of Electrical and Electronic Components

Click to view similar products for [D-Sub Standard Connectors](#) category:

Click to view products by [Amphenol](#) manufacturer:

Other Similar products are found below :

[56F706-005-LI](#) [56F711-015](#) [LV242999-142T12](#) [015-0341-000](#) [015-0372-005](#) [015-0372-008](#) [015-8755-001](#) [020419-0104](#) [012-0467-000](#)
[012-9507-034](#) [012-9507-114](#) [020745-0008](#) [609-25P](#) [CT2-18-11PCAU](#) [CT6-10SL-3SC](#) [CT6-10SL-4SC](#) [CT6-14S-2SC](#) [CT6E14SA7SC](#)
[CT6N10SL-4SSA34](#) [M83513/01-FC](#) [M83723/76W24619 L/C](#) [M85049/48-3-2F](#) [6STD09PCM99B70X](#) [6STD09SCM99B30X](#)
[6STD09SCT99S40X](#) [6STD15PCT99S40X](#) [6STD15SCT99S40X](#) [6STF09PCM05B70X](#) [7-135760-9](#) [MC11E-10-6SN](#) [747552-3](#) [MD1-21PS](#)
[MDM-15SCBRM7-F222](#) [MDM96517-699](#) [MDM96521-744](#) [MDVB1-21SL1](#) [MIK0-1-7SH003](#) [MIKQ6-7SH076](#) [MIKQ7-7PH077](#) [MIKQ7-](#)
[7PH11](#) [MIKQ7-7PH32](#) [MJSV-28SL61](#) [MKJ4A1F14-55S](#) [8-135760-3](#) [8STD09PCM99B30X](#) [PG-KV/PV-16-GROM-SEALING](#) [GDA15P](#)
[GDAY15PB](#) [980-0000-170](#) [980-0000-171](#)