

PC board drilling dimensions(after plating)
(thickness ≤ 3.20±0.30mm)

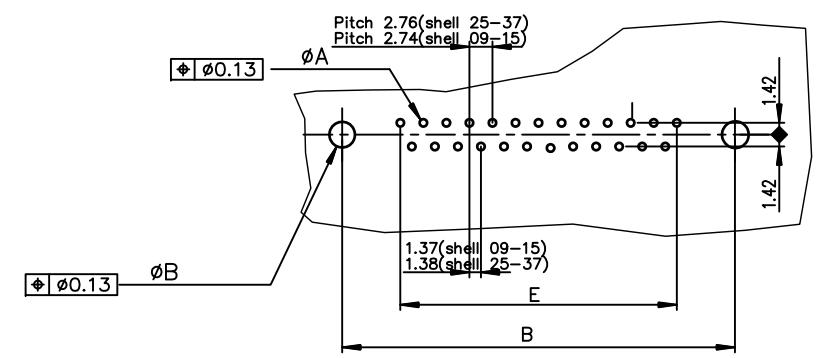
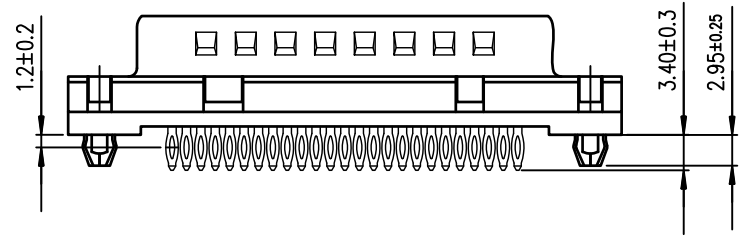

ROHS PART NUMBER

SHELL	A±0.38	B±0.12	C±0.10	D±0.25	E±0.07	Gold Flash	0.76µ Gold	1.25µ Gold
09	30.81	24.99	16.96	16.79	10.96	D09P90C4GL00LF	D09P90C6GL00LF	D09P90C8GL00LF
15	39.14	33.32	25.18	25.12	19.18	D15P90C4GL00LF	D15P90C6GL00LF	D15P90C8GL00LF
25	53.03	47.04	39.12	38.84	33.12	D25P90C4GL00LF	D25P90C6GL00LF	D25P90C8GL00LF
37	69.32	63.50	55.68	55.30	49.68	D37P90C4GL00LF	D37P90C6GL00LF	D37P90C8GL00LF

GENERAL CHARACTERISTICS AND ROHS INFORMATIONS:
SEE DRAWING C01-8646-0001

mat'l. code				surface ISO 1302 ✓		tolerance ISO 406 ISO 1101		projection mm		product family D-SUB	
ltr	ecn no	dr	date	tolerances unless otherwise specified						title	
H	ELX-I-12654	AB	2015-10-26	angles	linear	.0±0.1	mm		MALE DELTA-D LOW PROFILE STRAIGHT PRESS-FIT		
J	ELX-I-24020	AAB	2016-06-06	0±2'		.00±0.1	scale 2:1		dwg no sheet 1 of 1 size		
				dr	PESSON	1995-10-03			Amphenol FCI		
				engr	MITHUN PAUL	2016-06-06			C01-8646-0369 A3		
				chr	ATHUL A.B	2016-06-06			type Product Customer Drawing		
				appd	BIJU K PAUL	2016-06-06					
sheet index	revision	J									
	sheet	1									

X-ON Electronics

Largest Supplier of Electrical and Electronic Components

Click to view similar products for [D-Sub Standard Connectors](#) category:

Click to view products by [Amphenol](#) manufacturer:

Other Similar products are found below :

[56F706-005-LI](#) [56F711-015](#) [LV242999-142T12](#) [015-0341-000](#) [015-0372-005](#) [015-0372-008](#) [015-8755-001](#) [020419-0104](#) [012-0467-000](#)
[012-9507-034](#) [012-9507-114](#) [020745-0008](#) [609-25P](#) [CT2-18-11PCAU](#) [CT6-10SL-3SC](#) [CT6-10SL-4SC](#) [CT6-14S-2SC](#) [CT6E14SA7SC](#)
[CT6N10SL-4SSA34](#) [M83513/01-FC](#) [M83723/76W24619 L/C](#) [M85049/48-3-2F](#) [6STD09PCM99B70X](#) [6STD09SCM99B30X](#)
[6STD09SCT99S40X](#) [6STD15PCT99S40X](#) [6STD15SCT99S40X](#) [6STF09PCM05B70X](#) [7-135760-9](#) [MC11E-10-6SN](#) [747552-3](#) [MD1-21PS](#)
[MDM-15SCBRM7-F222](#) [MDM96517-699](#) [MDM96521-744](#) [MDVB1-21SL1](#) [MIK0-1-7SH003](#) [MIKQ6-7SH076](#) [MIKQ7-7PH077](#) [MIKQ7-](#)
[7PH11](#) [MIKQ7-7PH32](#) [MJSV-28SL61](#) [MKJ4A1F14-55S](#) [8-135760-3](#) [8STD09PCM99B30X](#) [PG-KV/PV-16-GROM-SEALING](#) [GDA15P](#)
[GDAY15PB](#) [980-0000-170](#) [980-0000-171](#)