

LAYOUT OF 50 POS. CONNECTOR

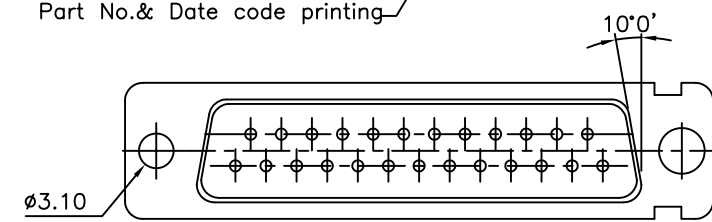

VIEW OF MATING FACE

ORDERING INFORMATION

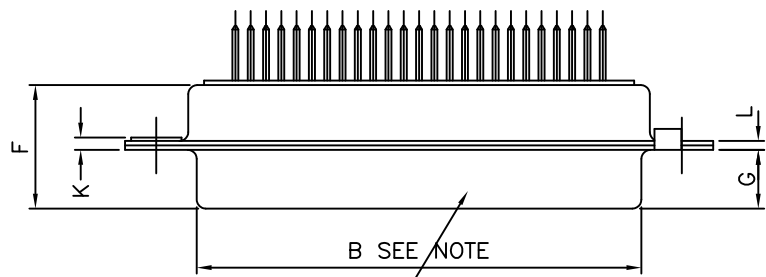
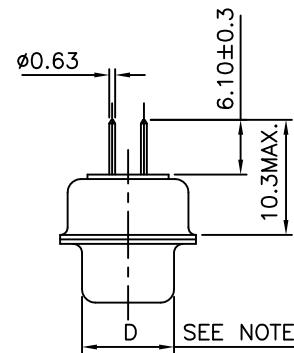
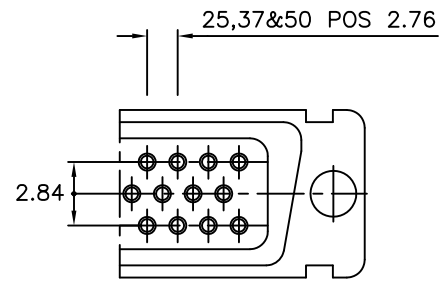
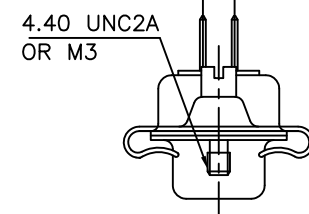
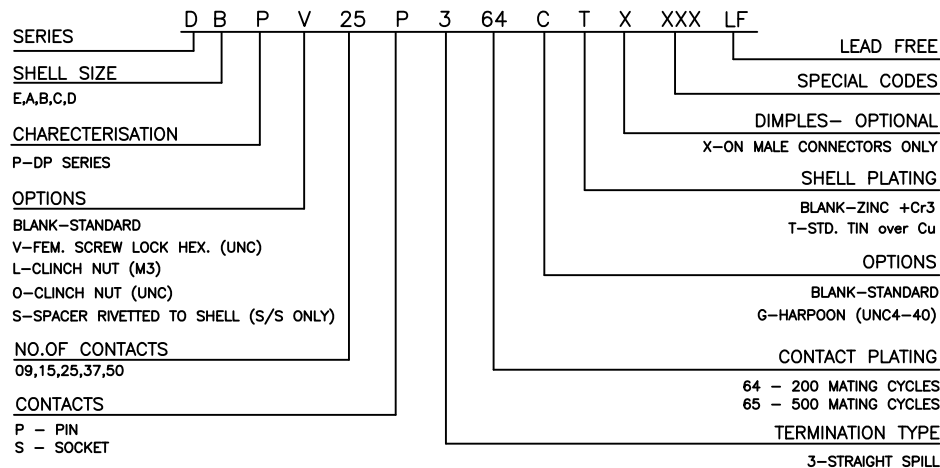

ORD.CODE:--8630-05(E,A,B,C)  
 ORD.CODE:--8630-03 D/SHELL FEMALE.  
 ORD.CODE:--8630-15 D/SHELL MALE.  
 ORD.CODE:--8630-04 E,A,B,C SHELL.  
 WITH METAL HOOD.  
 FOR 4.40UNC THREAD ADD 'N' TO THE CORRESPONDING ORD.CODE.

EXTENDED FEMALE SCREW- LOCK WITH SPACER

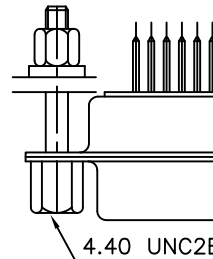

ORD.CODE:--8630-01-062

SPACER RIVETTED TO SHELL

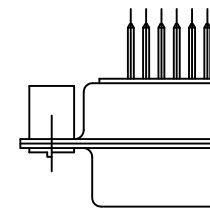

OPTION:--S

FEMALE SCREW RIVETTED TO SHELL

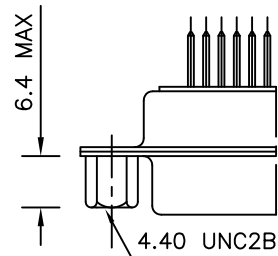

OPTION:--V

HARPOON RIVETTED TO SHELL

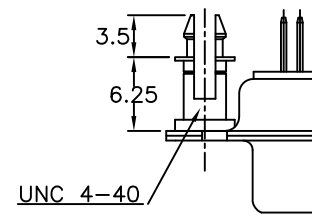

OPTION:--G WITH IN COMBINATION WITH L/O

CLINCH NUT RIVETTED TO SHELL

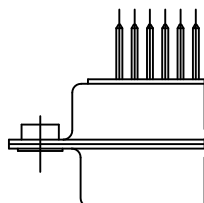

OPTION:--L  
 OPTION:--O

50	P	66.65	52.68	61.11	11.08	14.99	11.09	5.85	55.07	13.31	1.50	1.0										
	S	66.65	52.30	61.11	10.62	14.99	11.21	6.05	55.07	13.31	1.10	0.8										
37	P	68.94	55.30	63.50	8.23	12.17	11.09	5.85	57.45	10.46	1.50	1.0										
	S	68.94	54.71	63.50	7.77	12.17	11.21	6.05	57.45	10.46	1.10	0.8										
25	P	52.65	38.84	47.04	8.23	12.17	11.07	5.85	41.02	10.46	1.10	0.8										
	S	52.65	38.25	47.04	7.77	12.17	11.21	6.05	41.02	10.46	1.10	0.8										
15	P	38.76	25.12	33.32	8.23	12.17	10.99	5.85	27.25	10.46	1.10	0.8										
	S	38.76	24.54	33.32	7.77	12.17	11.21	6.05	27.25	10.46	1.10	0.8										
09	P	30.43	16.79	24.99	8.23	12.17	10.99	5.85	19.02	10.46	1.10	0.8										
	S	30.43	16.21	24.99	7.77	12.17	11.21	6.05	19.02	10.46	1.10	0.8										
SHELL SIZE		A-0	+0.76	B-0	+0.25	C	$\pm 0.12$	D-0	+0.25	E-0	+0.76	F MAX	G-0	+0.15	H-0	+0.51	J-0	+0.51	K	$\pm 0.20$	L-0	+0.22

TECHNICAL SPECIFICATIONS

- SHELLS : TIN/ZINC PLATED STEEL
- INSULATOR MATERIAL : SELF EXTINGUISHING THERMOPLASTIC- TO UL CLASS 94 V0
- THE HOUSING WILL WITHSTAND EXPOSURE TO 260-265°C IF WE USE PROTECTIVE ADHESIVE (type Kapton or Teflon) OR PROTECTIVE METALLIC DEVICE
- CONTACTS DIA ON ACTIVE AREA :  $\phi 1$  MM.
- CONTACTS MATERIAL : COPPER ALLOY
- CONTACT PLATING : GXT / GOLD OVER NICKEL
- OPERATING TEMPERATURE : -55°C +125°C
- OPERATING CURRENT : 7.5 A PER CONTACT
- CONTACT RESISTANCE :  $\leq 7.3$  m $\Omega$
- INSULATION RESISTANCE :  $\geq 5000$  M $\Omega$
- MAXIMUM VOLTAGE : 1000 V.r.m.s
- MECHANICAL ENDURANCE : 500 MATINGS FOR CODE 65
- : 200 MATINGS FOR CODE 64
- DAMP HEAT : 56 DAYS FOR CODE 65
- : 21 DAYS FOR CODE 64

"This LF product meets European Union Directives and other country regulations as described in GS-22-008"

The housing will withstand exposure to 260°C peak temperature for 3.5 seconds in a wave solder application with a 1.6mm minimum thick circuit board.

Pckaging as per GS-14-920

NOTE:--INSIDE DIMENSIONS OF MALE AND OUTSIDE DIMENSIONS OF THE FEMALE CONNECTOR.

mat'l. code		SEE NOTE 4		surface		tolerance		projection		product family	
				ISO 1302		ISO 406 ISO 1101				D-SUB	
				tolerances unless otherwise specified						title	
				angles		linear				D-SUB S/S CONNECTOR (DP SERIES WITH ASSEMBLY OPTIONS)	
								scale		-	
ltr		ecn no		dr		date		dr		Mini K Vandanath	
F		i06-0074		GVJ		2006-06-08		enr		George V Joseph	
G		i08-0047		AMR		2008-03-25		chr		Abhilash M R	
H		i08-0125		AMR		2008-09-25		appd		Sudhir Varma	
J		i08-0139		AMR		2008-10-13				1999-03-20	
K		i09-0075		AMR		2009-05-14				1999-03-20	
L		i11-0003		AMR		2011-01-06				2008-09-25	
M		i11-0079		AMR		2011-05-02				2008-09-25	
sheet index		revision		M							
		sheet		1							
										dwg no	
										sheet 1 of 1	
										size	
										A3	
										type	
										Product Customer Drawing	

## X-ON Electronics

Largest Supplier of Electrical and Electronic Components

*Click to view similar products for [D-Sub Standard Connectors](#) category:*

*Click to view products by [Amphenol](#) manufacturer:*

Other Similar products are found below :

[56F706-005-LI](#) [56F711-015](#) [012-9507-004](#) [LV242999-142T12](#) [015-0341-000](#) [015-0372-005](#) [015-0372-008](#) [015-8755-001](#) [020419-0104](#)  
[012-0467-000](#) [012-9507-034](#) [012-9507-114](#) [020745-0008](#) [609-25P](#) [CT2-18-11PCAU](#) [CT6-10SL-3SC](#) [CT6-10SL-4SC](#) [CT6-14S-2SC](#)  
[CT6E14SA7SC](#) [CT6N10SL-4SSA34](#) [M83513/01-FC](#) [M83723/76W24619 L/C](#) [M85049/48-3-2F](#) [6STD09PCM99B70X](#) [6STD09SCM99B30X](#)  
[6STD09SCT99S40X](#) [6STD15PCT99S40X](#) [6STD15SCT99S40X](#) [6STF09PCM05B70X](#) [7-135760-9](#) [MC11E-10-6SN](#) [747552-3](#) [MD1-21PS](#)  
[MDM-15SCBRM7-F222](#) [MDM96517-699](#) [MDM96521-744](#) [MDVB1-21SL1](#) [MIK0-1-7SH003](#) [MIKQ6-7SH076](#) [MIKQ7-7PH077](#) [MIKQ7-](#)  
[7PH11](#) [MIKQ7-7PH32](#) [MJSV-28SL61](#) [MKJ4A1F14-55S](#) [8-135760-3](#) [8STD09PCM99B30X](#) [PG-KV/PV-16-GROM-SEALING](#) [GDA15P](#)  
[GDAY15PB](#) [980-0000-170](#)