



CATALOGUE

Fiber Optic Connector



Range Overview

∟ Receptacle to Field Installable

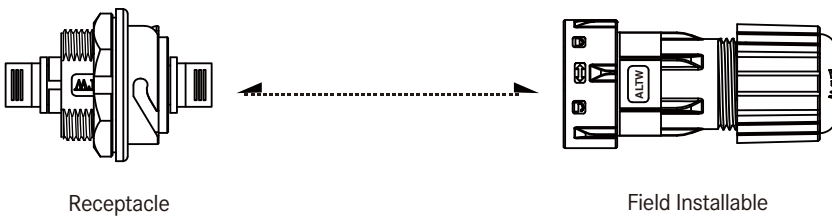

Receptacle

Field Installable

∟ Accessories

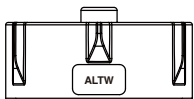

Waterproof Cap
See page 21-18

Specification

Identifications	LC Type SC Type
Description	Receptacle Field Installable
Material	Receptacle: Mousing: PPO Screw Nut: Nylon Field Installable: Clamp Ring: PPO Lock Nut: PPO Sealing Nut: Nylon
Waterproof Rating	IP67
Temperature Range	Receptacle: -40 °C ~ 105 °C Field Installable: -40 °C ~ 105 °C

* Design and specification are subject to change without notice.

Ordering Information

	1	2	3	4	5	6	7	8	9
Specification									
(FB) Fiber Optic									
Mode									
(SM) Single - Mode	(00) None								
Connector Body (Style)									
> For Receptacle	> For Field installable								
(R) Rear Fastened	(B) Without Strain Relief								
Connector (Housing) Gender									
(LM) LC Type / Plug	(SM) SC Type / Plug								
(LF) LC Type / Jack	(SF) SC Type / Jack								
Assemble Style									
> For Receptacle	> For Field Installable								
(J) Put Through	(A) Field Installable								
Mating Style									
(T) 3 Points Lock Bayonet									
Backshell									
> For Receptacle	> For Field Installable								
(C) Circular	(L) Straight								
Waterproof Rating									
(7) IP 67									
More Information									
(001), (002).....									
Without Cable : Different Versions									

Physical Dimension

Receptacle

Panel Cut-Out

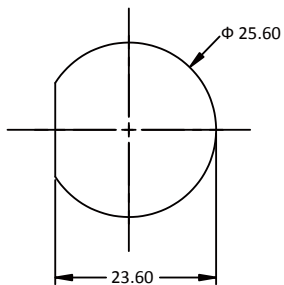

Connector Dimension

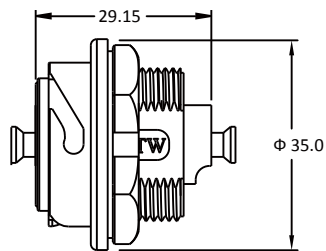
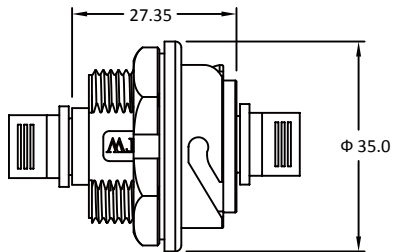

Unit: mm

Field Installable

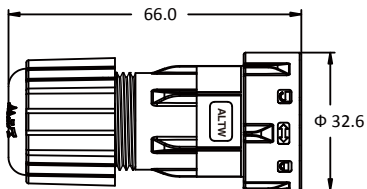

Unit: mm

[Note] Design and specification are subject to change without notice.

Product Features

Receptacle

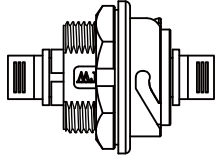

Backshell 7



Circule (C)

Mating Style 6



3 Points Lock Bayonet (T)

Connector Body(Style) 3

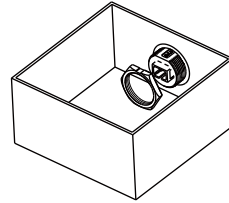

Rear Fastened (R)

Field Installable

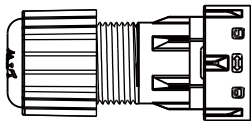

Backshell 7

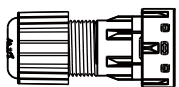

Straight (L)

Mating Style 6



3 Points Lock Bayonet (T)

Connector Body(Style) 3

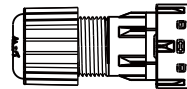

Without Strain Relief (B)

Find Our Standard Products

▾ Receptacle and Mating Pair

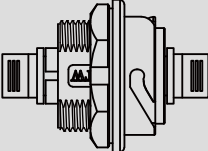
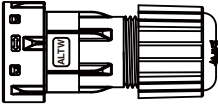
<ul style="list-style-type: none"> • Female Connector (Housing) • 3 Point Lock Bayonet 	<p>Receptacle -----></p> 	<p>Field Installable</p> 
<p>Type</p>	<p>Female Connector (F)</p>	<p>Male Connector (M)</p>
<p>LC Type (L)</p>	<p>FB-00RLFJ-TC7001</p>	<p>FB-00BLMA-TL7001 FB-00BLMA-TL7002</p>
<p>SC Type (S)</p>	<p>FB-SMRSFJ-TC7001</p>	<p>FB-00BSMA-TL7001</p>

FB-00BLMA-TL7001 (Cable OD: 2.5~2.8)
 FB-00BLMA-TL7002 (Cable OD: 4.5~6.8)
 FB-00BSMA-TL7001 (Cable OD: 2.4 max)

[Note] Design and specification are subject to change without notice.

Amphenol LTW Technology Co., Ltd.

5F-3, No.51, Sec.4, Zhongyang Rd., Tucheng Dist., New Taipei City 236, Taiwan
Telephone: +886-2-77416888 Fax: +886-2-77416999
www.amphenolltw.com

Kunshan Factory

No. 62, DaTong Road, Development Zone, Kunshan City, JiangSu Province, 215333 China
Telephone: +86-512-5761-0501
Fax: : +86-512-5761-0515

For further information, please contact :

Sales & Marketing Department | Email : sales@ltw-tech.com

X-ON Electronics

Largest Supplier of Electrical and Electronic Components

Click to view similar products for [Standard Circular Contacts](#) category:

Click to view products by [Amphenol](#) manufacturer:

Other Similar products are found below :

[RC16M23J](#) [133780-1](#) [RM20M13D28](#) [RM24M9D28](#) [MS3474W10-6P L/C](#) [ELVP16100E](#) [164-901-CD](#) [EN3545007SCE](#)
[BV002BSQ20049CZ](#) [BV002SSQ160404CZ](#) [1900ND05S1B00B](#) [192900-0061](#) [192900-0575](#) [192900-0718](#) [166566-1](#) [1900ND04S1X00D](#)
[192900-0058](#) [192900-0309](#) [ST-JL05-16S-C3-100](#) [ST-JL05-20S-C1-100](#) [ST-JL05-20S-C2-100](#) [T01-CRIMP-S03](#) [APK-SA16A07-002](#) [CONT-](#)
[JL05-08S-C2-10](#) [RC16M-23T](#) [RFD26L-1D28](#) [BV002ASJ16049CW](#) [JN1-22-20S-R-PKG100](#) [031-50565](#) [ELFH08251](#) [ELFP0641GE](#)
[SJS861301M](#) [ST-JL05-16S-C1-100](#) [ST-JL05-20P-C1-100](#) [82911466K](#) [ESLM03200](#) [192991-0087](#) [192900-0570](#) [ELFH07251](#) [44-104-10003-](#)
[02](#) [T3P16FC3LZ](#) [ST-JL05-16S-C2-3500](#) [ZP-4016-10NF](#) [CONT-JL05-12P-C1-10](#) [RM20M12G8D28](#) [031-50676](#) [12115010110](#) [RJFTVC2MG](#)
[CAP-DACMDPC2](#) [031-50675-002](#)