

REVISIONS	
REV	ECN, ERN NO.
A	OCT16/12
PRODUCT DRAWING (EAR 14134)	
APPRD.	K.L.

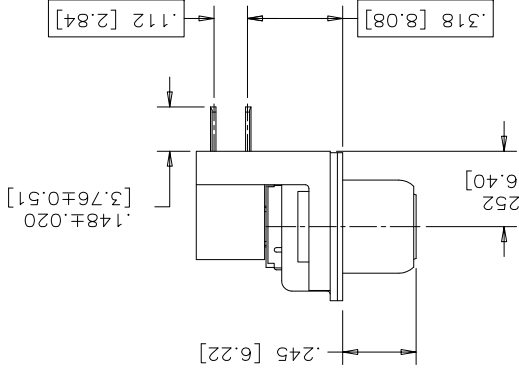
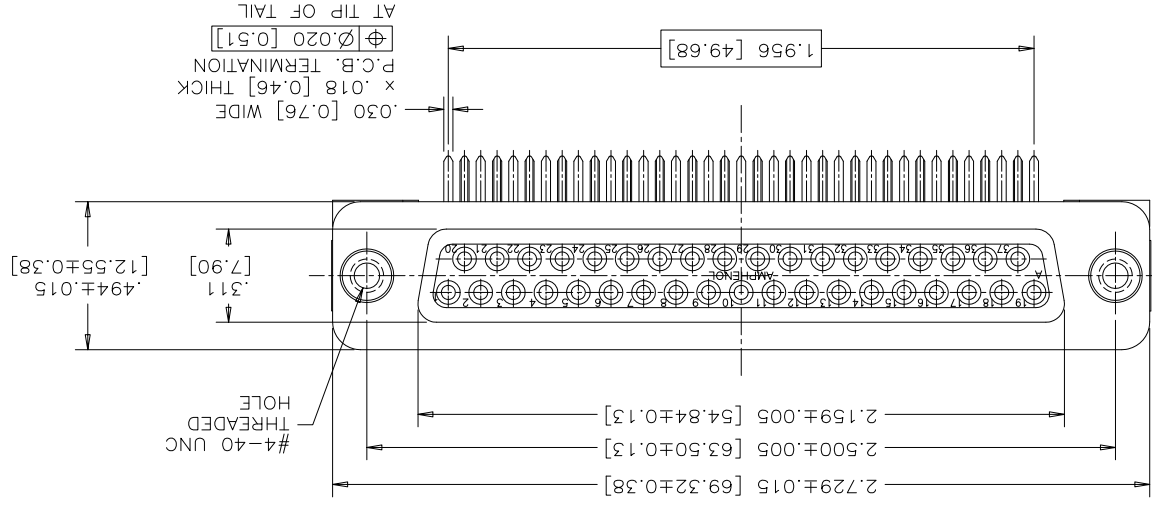
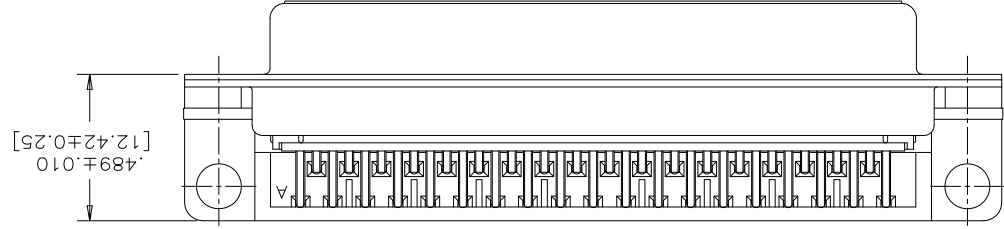

NOTES:

1. MATERIALS: - SHELLS - TIN PLATED STEEL
- CONTACTS - PHOSPHOR BRONZE PLATED WITH 15µ" [0.38µm] GOLD OVER 50µ" [1.27µm] NICKEL ON THE MATING AREA AND TIN-LEAD ON THE TERMINALS
- INSULATOR - ENGINEERING THERMOPLASTIC, FLAMMABILITY RATING UL94V-0, BLACK
2. CONTACT RESISTANCE: 15 MILLIOHMS MAXIMUM
3. INSULATION RESISTANCE: 3000 MEGOHMS MINIMUM
4. DIELECTRIC WITHSTANDING VOLTAGE: 600 VDC
5. CURRENT RATING: 5 AMPS MAXIMUM
6. OPERATING TEMPERATURE: -40°C TO 85°C
7. TOLERANCE, UNLESS INDICATED OTHERWISE, ±.005 [0.13]

THIS DOCUMENT CONTAINS PROPRIETARY INFORMATION AND SUCH INFORMATION MAY NOT BE DISCLOSED TO OTHERS FOR ANY PURPOSE OR USED FOR MANUFACTURING PURPOSES WITHOUT WRITTEN PERMISSION FROM AMPHENOL CANADA CORP.

ORDERING CODE: F C C 1 7 - C 3 7 S A - 3 9 1

SERIES
SIZE/NUMBER OF CONTACTS
C37
CONNECTOR STYLE
S=SOCKET
TERMINATION TYPE
A=.318" [8.08] FOOTPRINT
MOUNTING
3=#4-40 UNC THREAD

PERFORMANCE CHARACTERISTICS
REFER TO AMPHENOL
CATALOGUE FOR FILTER
9=5600 pF ±15%
1=BOARDLOCK OMITTED
FILTER CAPACITANCE

MATERIAL	
DATE	OCT16/12
DRAWN	A.ESP/IE
DESIGNED	
CHECKED	
L. E. APPRD.	
Q. A. APPRD.	
DWG. APPRD.	K.LAMB/IE
ENG. REL. NO.	
REF.	EAR 14134
DIMENSIONS ARE IN	INCHES [mm]
CODE ID. NO.	03554
SCALE	3/1
WT.	
SURF.	
SHEET 1 OF 1	

REV	
DWG	C
DRAWING NO.	P-FCC17-C37SA-391
REV	A

TITLE
FCC17 FILTERED D-SUB, 37 SIZE SOCKET,
.318 F/P BEND, PLASTIC BRACKET,
#4-40 THREAD, BOARDLOCK OMITTED

AMPHENOL Canada Corp.

X-ON Electronics

Largest Supplier of Electrical and Electronic Components

Click to view similar products for [D-Sub Standard Connectors](#) category:

Click to view products by [Amphenol](#) manufacturer:

Other Similar products are found below :

[DCM37S732N](#) [DAM15P500](#) [DEV09S364GTLF](#) [DEM09P032N](#) [DDM50P732N](#) [DAM15S332N](#) [173109-2218](#) [173109-2466](#) [173109-2436](#)
[173109-2435](#) [56F706-005-LI](#) [56F711-015](#) [015-0341-000](#) [015-0372-008](#) [015-8544-011](#) [017041-0005](#) [020419-0104](#) [012-0515-000](#) [012-9507-](#)
[034](#) [012-9507-114](#) [012-9534-001](#) [020745-0008](#) [609-25P](#) [M24308/2-23Z](#) [M243082310F](#) [M243082410F](#) [M243082411F](#) [M24308/4-21](#)
[CT1A18-11PSA206](#) [CT1N36-5SC](#) [CT2-16S-17PS](#) [CT2-20-15PCAU](#) [CT2-24-12PS](#) [CT2-24-28PSF127A206](#) [CT2-32-9PC](#) [CT6F9767-14-4-](#)
[14S-5PC](#) [CT6FA10SL-4PS](#) [CT7-18-10SC](#) [CT7-18-10SCAU](#) [CT7-18-12SCAU](#) [CT7-18-1PC](#) [CT7-18-1PCAU](#) [CT7-18-21SCAU](#) [M83513/01-](#)
[FC](#) [M83723/76W24619 L/C](#) [M85049/48-3-2F](#) [69001-865](#) [6STD09PCM99B70X](#) [6STD09SCM99B30X](#) [6STD09SCT99S40X](#)