

REV	ECN, ERN NO.	DATE	APPRD.
A	PRODUCT DRAWING (EAR 14134)	OCT16/12	K.L.

REVISIONS

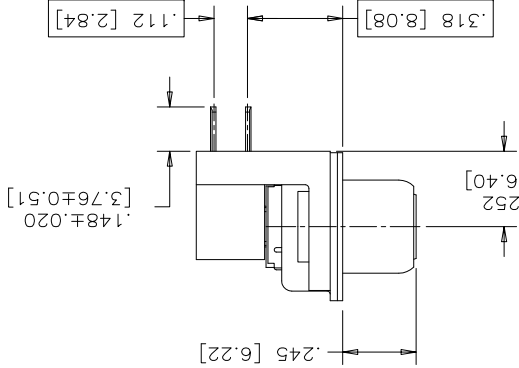
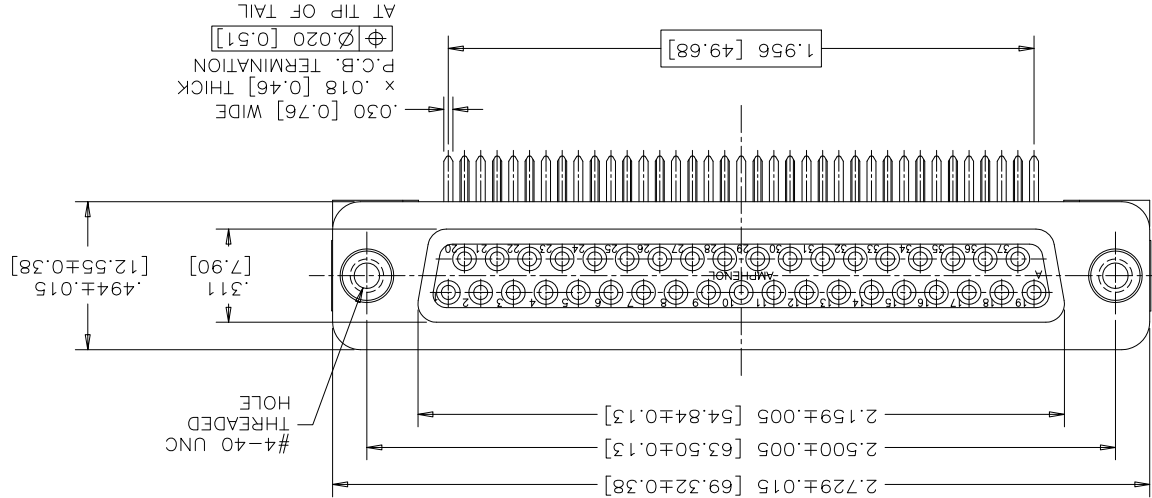
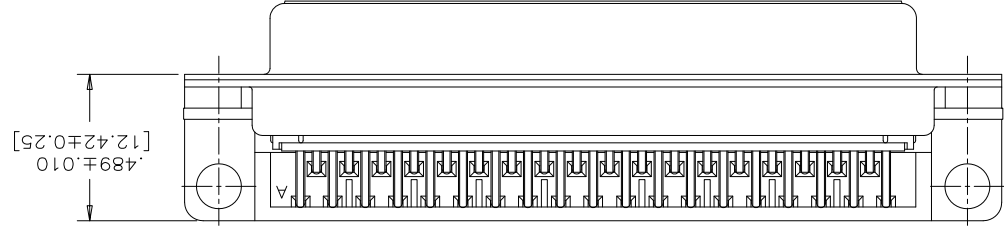

NOTES:

1. MATERIALS: - SHELLS - TIN PLATED STEEL  
- CONTACTS - PHOSPHOR BRONZE PLATED WITH 15µ" GOLD OVER 50µ" [1.27µm]  
- INSULATOR - ENGINEERING THERMOPLASTIC, FLAMMABILITY RATING UL94V-0, BLACK
2. CONTACT RESISTANCE: 15 MILLIOHMS MAXIMUM
3. INSULATION RESISTANCE: 3000 MEGOHMS MINIMUM
4. DIELECTRIC WITHSTANDING VOLTAGE: 600 VDC
5. CURRENT RATING: 5 AMPS MAXIMUM
6. OPERATING TEMPERATURE: -40°C TO 85°C
7. TOLERANCE, UNLESS INDICATED OTHERWISE, ±.005 [0.13]

THIS DOCUMENT CONTAINS PROPRIETARY INFORMATION AND SUCH INFORMATION MAY NOT BE DISCLOSED TO OTHERS FOR ANY PURPOSE OR USED FOR MANUFACTURING PURPOSES WITHOUT WRITTEN PERMISSION FROM AMPHENOL CANADA CORP.

ORDERING CODE: F C C 1 7 - C 3 7 S A - 3 9 1

SERIES: C37  
SIZE/NUMBER OF CONTACTS: 37  
CONNECTOR STYLE: S=SOCKET  
TERMINATION TYPE: A=.318" [8.08] FOOTPRINT  
MOUNTING: 3=#4-40 UNC THREAD

TITLE: FCC17 FILTERED D-SUB, 37 SIZE SOCKET, .318 F/P BEND, PLASTIC BRACKET, #4-40 THREAD, BOARDLOCK OMITTED

DWG. NO. P-FCC17-C37SA-391

MATERIAL	DATE	DESIGNED	CHECKED	L. E. APPRD.	Q. A. APPRD.	DWG. APPRD.	ENG. REL. NO.	REF.	DIMENSIONS ARE IN	CODE ID. NO.	SCALE	WT.	SURF.	SHEET
	OCT16/12	A.ESP/IE				K.LAMB/IE		EAR 14134	INCHES [mm]	03554	3/1			1 OF 1

## X-ON Electronics

Largest Supplier of Electrical and Electronic Components

*Click to view similar products for [D-Sub Adapters & Gender Changers](#) category:*

*Click to view products by [Amphenol](#) manufacturer:*

Other Similar products are found below :

[76000672](#) [243A10110X](#) [243A10120X](#) [243A10140X](#) [243A11070X](#) [243A13240X](#) [243A13290X](#) [243A13460X](#) [300X10729X](#) [300X10759X](#)  
[GCHDLP26F26F](#) [56-715-005-LI](#) [56F715-003](#) [76000673](#) [200.2071](#) [243A11800X](#) [243A10560X](#) [243A11060X](#) [56-745-005](#) [243A10580X](#)  
[56F715-005-LI](#) [SC485](#) [40-9525S](#) [76000670](#) [FCC17-C37AD-291](#) [FCC17-E09AD-250](#) [FCE17-E09AD-250](#) [76000560](#) [GCLP37M37F](#)  
[GCLP37M37M](#) [76000702](#) [GCHDLPF15M15M](#) [GCHDLPF15F15F](#) [301-1001-11](#) [301-1001-31](#) [76000698](#) [76000699](#) [NADB9MF](#) [FCE17-](#)  
[C37AD-290](#) [30-9520](#) [P156-000](#) [P118-000](#) [P152-000](#) [2902318](#) [P150-000](#) [2902317](#) [320X10549X](#) [2902320](#) [230016003](#) [163A50039X](#)