

This document is the property of Amphenol Corporation and is delivered on the express condition that it is not to be disclosed, reproduced or used, in whole or in part, for manufacture or sale by anyone other than Amphenol Corporation without its prior consent, and that no right is granted to disclose or to use any information in this document.

The marking on this product doesn't contain environmental hazardous materials per Material Specification SS-00259 for Sony GP compliant or per directive 2011/65/EU for RoHS compliant.

POS	A	B	C	D
02	6.60	6.00	6.00	4.3
04	9.60	3.00	9.00	7.3
06	12.60	6.00	12.00	10.3
08	15.60	9.00	15.00	13.3
10	18.60	12.00	18.00	16.3
12	21.60	15.00	21.00	19.3
14	24.60	18.00	24.00	22.3
16	27.60	21.00	27.00	25.3
18	30.60	24.00	30.00	28.3
20	33.60	27.00	33.00	31.3
22	36.60	30.00	36.00	34.3
24	39.60	33.00	39.00	37.3

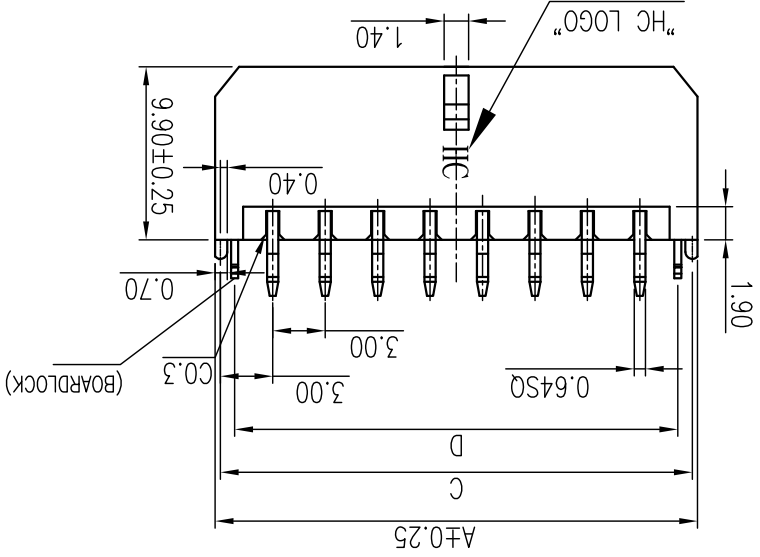
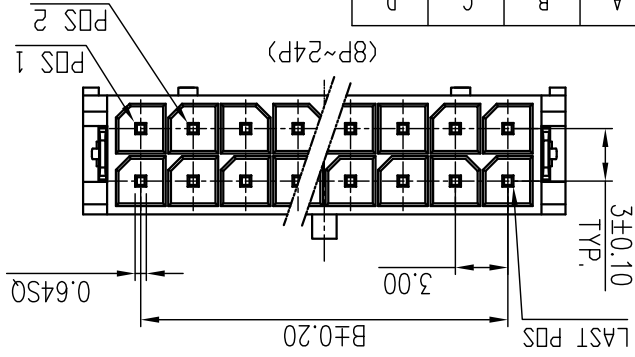

F	E
F	1.75
E	2.10
	2.60
	2.35
	2.95
	3.20
	2.95
	3.85
	4.00
	4.50

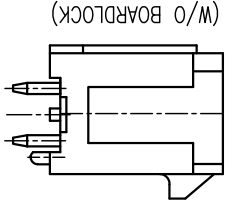
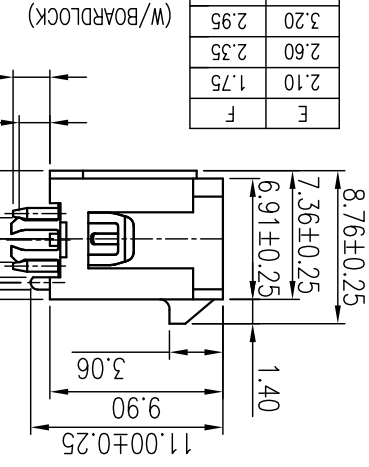

SYMBOL	E.C.N. No.	DESCRIPTION	DATE	APPROVED
A	NE-14086	RELEASE FOR ROHS	06/14/2014	Aron Liu
B	NE-16287	ADD W/O BOARDLOCK OPTION/ADD TAIL 2.60,3.20,4.00,4.50 OPTION	12/14/2016	Roger Tsai
C	NE-17135	ADD BOARDLOCK LENGTH DIM F OPTION	06/19/2017	Roger Tsai
D	NE-18172	UPDATE PACKING PCS/CARTON	08/13/2018	Roger Tsai
EX1	NE-19XXX	UPDATE CONTACT FINISH TO CONTACT / SOLDERING FINISH	05/06/2019	Roger Tsai

NOTE:

- MATERIAL: INSULATOR: HIGH TEMP. THERMOPLASTIC, OPTIONS, UL 94V-0, COLOR OPTIONS CONTACT MATERIAL: HIGH PERFORMANCE COPPER ALLOY.
- FINISH: BOARDLOCK: COPPER ALLOY. CONTACT: SELECTIVE PLATING.; SOLDERING AREA: PLEASE REFER TO PART NO. DEFINITION. UNDER PLATING: NICKEL PLATING 50 μ" THICKNESS MIN. OVERALL. BOARDLOCK: MATTE TIN 100 μ" MIN. PLATING; UNDER PLATING: NICKEL PLATING 50 μ" THICKNESS MIN. OVERALL. THIS PRODUCT DOESN'T ENVIRONMENTAL HAZARDOUS MATERIALS PER DIRECTIVE 2011/65/EU FOR ROHS.
- PACKING MUST BE PER Amphenol PACKING SPECIFICATION
- ENSURE CURRENT RATING CAPABILITY, PLEASE ADOPT TOTAL SOLUTION.
- (G88MPH CABLE HOUSING SERIES WITH G88MPC CABLE TERMINAL SERIES)

PART NO. G88MPXX1X2XXEU
No. OF CIRCUIT
BOARD MOUNT OPTION
C: W/BOARDLOCK
D: W/O BOARDLOCK
INSULATOR, TAIL (DIM E)
BLANK: LCP (BLACK), 2.10MM
1: LCP (NATURAL), 2.10MM
2: LCP (BLACK), 2.60MM
3: LCP (NATURAL), 2.60MM
4: LCP (BLACK), 3.20MM
5: LCP (NATURAL), 3.20MM
6: LCP (BLACK), 4.00MM
7: LCP (NATURAL), 4.00MM
8: LCP (BLACK), 4.50MM
9: LCP (NATURAL), 4.50MM

CONTACT / SOLDERING FINISH
0: MATTE TIN 100 μ" (OVERALL)
1: FLASH GOLD / FLASH GOLD THICKNESS MIN
2: LCP (BLACK), 2.60MM
3: 30 μ" GOLD / MATTE TIN 100 μ"
4: LCP (BLACK), 3.20MM
5: LCP (NATURAL), 3.20MM
6: LCP (BLACK), 4.00MM
7: LCP (NATURAL), 4.00MM
8: LCP (BLACK), 4.50MM
9: LCP (NATURAL), 4.50MM

TOLERANCE		APPROVALS	DATE	TITLE	
X	±0.30	DRAWN	Juda Liu	05/06/2019	G88MP SERIES MICRO POWER
X	±0.20	CHECKED	Deby Hung	05/06/2019	STRAIGHT DIP, W/BLOCK
X	±0.10	APPROVED	Roger Tsai	05/06/2019	
UNLESS OTHERWISE SPECIFIED		DWG TYPE	CUST DWG	PROJECT CODE	PHD

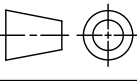

DWG No.	SHEET	UNIT	SCALE
G88MPXX1X2XXEU	1 OF 4	mm	NA

REV	EX1	REV	EX1
G88MPXX1X2XXEU	8	G88MPXX1X2XXEU	8

This document is the property of Amphenol Corporation and is delivered on the express condition that it is not to be disclosed, reproduced or used, in whole or in part, for manufacture or sale by anyone other than Amphenol Corporation without its prior consent, and that no right is granted to disclose or to use any information in this document.

The marking on this product doesn't contain environmental hazardous materials per Material Specification 55-00259 for Sony GP compliant or per directive 2011/65/EU for RoHS compliant.

SYM	ECN No.	DESCRIPTION	DATE	APPROVED
A	NE-14098	RELEASE FOR ROHS	06/14/2014	Aron Liu
B	NE-16287	ADD W/O BOARDLOCK OPTION/ADD TAIL 2.60,3.20,4.00,4.50 OPTION	12/14/2016	Roger Tsoi
C	NE-17135	ADD BOARDLOCK LENGTH DIM F OPTION	06/19/2017	Roger Tsoi
D	NE-18172	UPDATE PACKING PCS/CARTON	08/13/2018	Roger Tsoi
EX1	NE-19XXX	UPDATE CONTACT FINISH TO CONTACT / SOLDERING FINISH	05/06/2019	Roger Tsoi

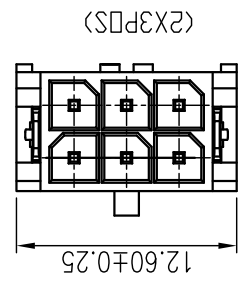
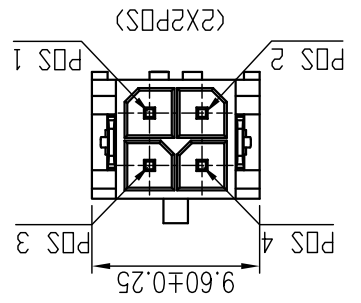
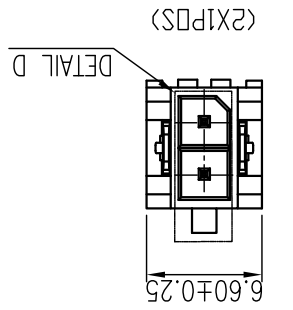
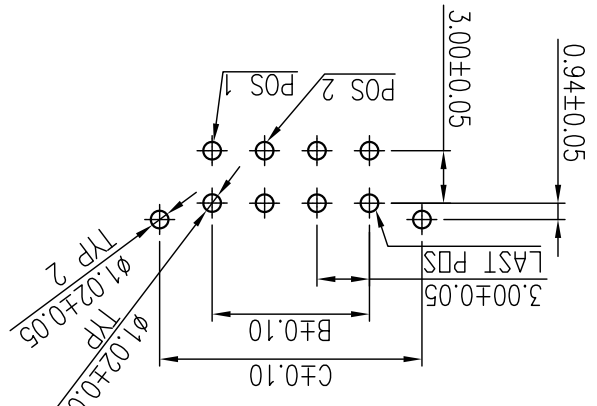
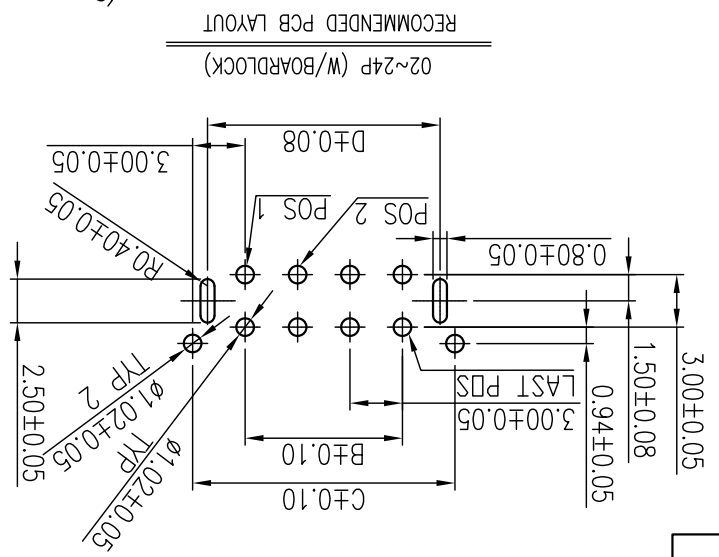
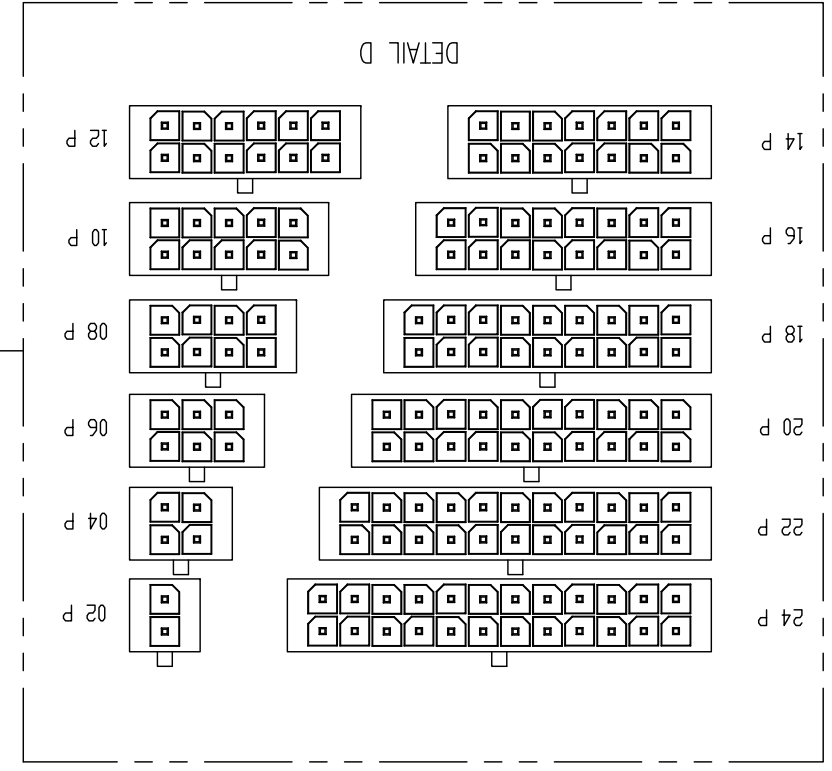

02~24P (W/O BOARDLOCK)
RECOMMENDED PCB LAYOUT

02~24P (W/BOARDLOCK)
RECOMMENDED PCB LAYOUT

TOLERANCE	APPROVALS	DATE	TITLE
X. X.X X.XX X.XXX ±1.	DRAWN Juda Liu	05/06/2019	888MP SERIES MICRO POWER PLUS, WAFER 3.00 MM PITCH STRAIGHT DIP, W/BLOCK
	CHECKED Debby Hung	05/06/2019	Amphenol Corporation Amphenol Taiwan Corporation
	APPROVED Roger Tsoi	05/06/2019	888MPXX1X2XXEU
UNLESS OTHERWISE SPECIFIED	DWG TYPE CUST DWG	PROJECT CODE PHD	SCALE NA

1 2 3 4 5 6 7 8

8 7 6 5 4 3 2 1

This document is the property of Amphenol Corporation and is delivered on the express condition that it is not to be disclosed, reproduced or used, in whole or in part, for manufacture or sale by anyone other than Amphenol Corporation without its prior consent, and that no right is granted to disclose or to use any information in this document.

The marking on this product doesn't contain environmental hazardous materials per Material Specification 55-00259 for Sony GP compliant or per directive 2011/65/EU for RoHS compliant.

SYM	ECN No.	DESCRIPTION	DATE	APPROVED
A	NE-14098	RELEASE FOR ROHS	06/14/2014	Aron Liu
B	NE-16287	ADD W/O BOARDLOCK OPTION/ADD TAIL 2.60,3.20,4.00,4.50 OPTION	12/14/2016	Roger Tsoi
C	NE-17135	ADD BOARDLOCK LENGTH DIM F OPTION	06/19/2017	Roger Tsoi
D	NE-18172	UPDATE PACKING PCS/CARTON	08/13/2018	Roger Tsoi
EX1	NE-19XXX	UPDATE CONTACT FINISH TO CONTACT / SOLDERING FINISH	05/06/2019	Roger Tsoi

POS.	BOARD-MOUNT P/N	CABLE HOUSING P/N	CABLE TERMINAL P/N	AWG NO.	PLATING OPTIONS
02	G88MP021X2XXEU	G88MPH0222CEU	G88MPC0232XCCEU	AWG#16~18	0: TIN 100u" ; 1: FLASH GOLD 2: 15u" GOLD ; 3: 30u" GOLD
04	G88MP041X2XXEU	G88MPH0422CEU	G88MPC0232XCCEU	AWG#16~18	0: TIN 100u" ; 1: FLASH GOLD 2: 15u" GOLD ; 3: 30u" GOLD
06	G88MP061X2XXEU	G88MPH0622CEU	G88MPC0232XCCEU	AWG#16~18	0: TIN 100u" ; 1: FLASH GOLD 2: 15u" GOLD ; 3: 30u" GOLD
08	G88MP081X2XXEU	G88MPH0822CEU	G88MPC0232XCCEU	AWG#16~18	0: TIN 100u" ; 1: FLASH GOLD 2: 15u" GOLD ; 3: 30u" GOLD
10	G88MP101X2XXEU	G88MPH1022CEU	G88MPC0232XCCEU	AWG#16~18	0: TIN 100u" ; 1: FLASH GOLD 2: 15u" GOLD ; 3: 30u" GOLD
12	G88MP121X2XXEU	G88MPH1222CEU	G88MPC0232XCCEU	AWG#16~18	0: TIN 100u" ; 1: FLASH GOLD 2: 15u" GOLD ; 3: 30u" GOLD
14	G88MP141X2XXEU	G88MPH1422CEU	G88MPC0232XCCEU	AWG#16~18	0: TIN 100u" ; 1: FLASH GOLD 2: 15u" GOLD ; 3: 30u" GOLD
16	G88MP161X2XXEU	G88MPH1622CEU	G88MPC0232XCCEU	AWG#16~18	0: TIN 100u" ; 1: FLASH GOLD 2: 15u" GOLD ; 3: 30u" GOLD
18	G88MP181X2XXEU	G88MPH1822CEU	G88MPC0232XCCEU	AWG#16~18	0: TIN 100u" ; 1: FLASH GOLD 2: 15u" GOLD ; 3: 30u" GOLD
20	G88MP201X2XXEU	G88MPH2022CEU	G88MPC0232XCCEU	AWG#16~18	0: TIN 100u" ; 1: FLASH GOLD 2: 15u" GOLD ; 3: 30u" GOLD
22	G88MP221X2XXEU	G88MPH2222CEU	G88MPC0232XCCEU	AWG#16~18	0: TIN 100u" ; 1: FLASH GOLD 2: 15u" GOLD ; 3: 30u" GOLD
24	G88MP241X2XXEU	G88MPH2422CEU	G88MPC0232XCCEU	AWG#16~18	0: TIN 100u" ; 1: FLASH GOLD 2: 15u" GOLD ; 3: 30u" GOLD

AMPHENOL CABLE TERMINAL

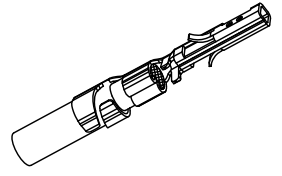

AMPHENOL CABLE HOUSING

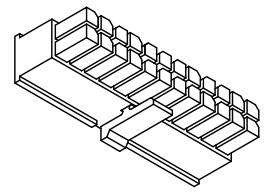

AMPHENOL BOARD-MOUNT

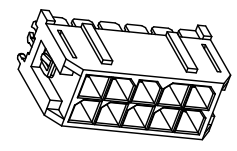

NOTE: TO ENSURE CURRENT RATING CAPABILITY, PLEASE ADOPT TOTAL SOLUTION.
(G88MPH CABLE HOUSING SERIES WITH G88MPC CABLE TERMINAL SERIES)

TITLE	APPROVALS	DATE
G88MP SERIES MICRO POWER PLUS, WAFER 3.00 MM PITCH STRAIGHT DIP, W/BLOCK	DRAWN	Juda Liu 05/06/2019
	CHECKED	Debby Hung 05/06/2019
	APPROVED	Roger Tsoi 05/06/2019
UNLESS OTHERWISE SPECIFIED	TOLERANCE	
ANGULAR ±1	X X.X X.XX X.XXX	
DWG TYPE	CUST DWG	PHD
PROJECT CODE	PROJECT CODE	PROJECT CODE
SCALE	SCALE	SCALE
SHEET	SHEET	SHEET
DWG No.	DWG No.	DWG No.
REV	REV	REV

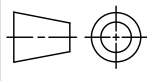

1
2
3
4
5
6
7
8

A
B
C
D
E
F

This document is the property of Amphenol Corporation and is delivered on the express condition that it is not to be disclosed, reproduced or used, in whole or in part, for manufacture or sale by anyone other than Amphenol Corporation without its prior consent, and that no right is granted to disclose or to use any information in this document. The marking on this product doesn't contain environmental hazardous materials per Material Specification 5S-00259 for Sony GP compliant or per directive 2011/65/EU for RoHS compliant.

SYM	ECN No.	DESCRIPTION	DATE	APPROVED
A	NE-14098	RELEASE FOR ROHS	06/14/2014	Aron Liu
B	NE-16287	ADD W/O BOARDLOCK OPTION/ADD TAIL 2.60,3.20,4.00,4.50 OPTION	12/14/2016	Roger Tsoi
C	NE-17135	ADD BOARDLOCK LENGTH DIM F OPTION	06/19/2017	Roger Tsoi
D	NE-18172	UPDATE PACKING PCS/CARTON	08/13/2018	Roger Tsoi
EX1	NE-19XXX	UPDATE CONTACT FINISH TO CONTACT / SOLDERING FINISH	05/06/2019	Roger Tsoi

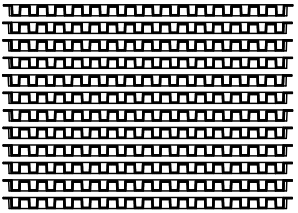
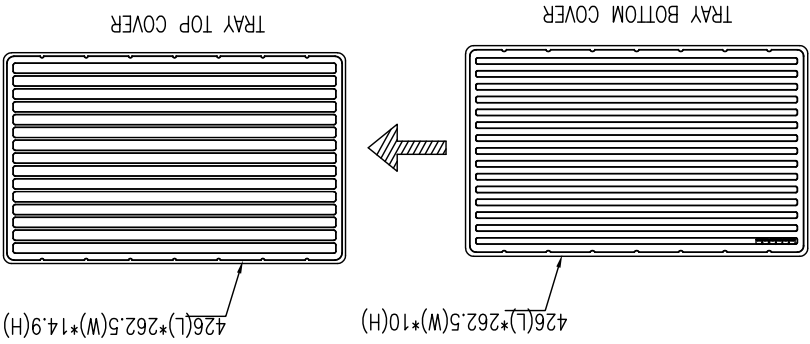

TABLE B: TAIL (DIM E) ≥ 4.00mm

POS	PCS/TRAY	PCS/CARTON
2	840	10080
4	574	6888
6	434	5208
8	350	4200
10	294	3528
12	252	3024
14	224	2688
16	196	2352
18	168	2016
20	154	1848
22	140	1680
24	140	1680

TABLE A: TAIL (DIM E) < 4.00mm

POS	PCS/TRAY	PCS/CARTON
2	900	10800
4	615	7380
6	465	5580
8	375	4500
10	315	3780
12	270	3240
14	240	2880
16	210	2520
18	180	2160
20	165	1980
22	150	1800
24	150	1800

NOTE:
 1. MATERIAL : BLACK CONDUCTIVE POLYSTYRENE ALLOY
 2. ALL DIMENSIONS MEET EIA-481-C REQUIREMENTS.
 3. THICKNESS : 0.80±0.05mm.

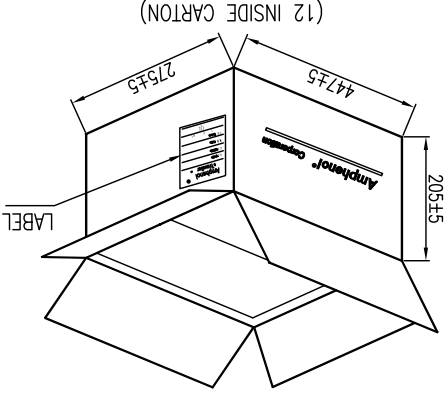

TOLERANCE		APPROVALS		DATE	TITLE
X	±0.30	DRAWN	Juda Liu	05/06/2019	G88MP SERIES MICRO POWER PLUS, WAFER 3.00 MM PITCH STRAIGHT DIP, W/BLOCK
X	±0.20	CHECKED	Debby Hung	05/06/2019	
X	±0.10	APPROVED	Roger Tsoi	05/06/2019	
UNLESS OTHERWISE SPECIFIED		DWG TYPE		CUST DWG	PHD
ANGULAR ±1		PROJECT CODE		PROJECT CODE	PROJECT CODE

REV	EX1	DWG No.	SHEET	4 OF 4	SCALE	UNIT	SIZE	PART No.
		G88MPXX1X2XXEU			NA	mm	A3	G88MPXX1X2XXEU

Amphenol
 Amphenol Corporation
 Amphenol Taiwan Corporation

X-ON Electronics

Largest Supplier of Electrical and Electronic Components

Click to view similar products for [Headers & Wire Housings](#) category:

Click to view products by [Amphenol](#) manufacturer:

Other Similar products are found below :

[95000-104TRLF](#) [10135584-644402LF](#) [DF62W-EP2022PCA](#) [95000-106TRLF](#) [DF62W-2022SCA](#) [DF62W-EP2022PC](#) [2203348](#) [DF62W-2022SC](#) [1084018](#) [1029039](#) [1084017](#) [802-10-012-10-002000](#) [1112640](#) [1112639](#) [891-007-9SS-BST1T](#) [000-34000](#) [0008550134](#) [0009482033](#) [0009507031](#) [57102-F02-18ULF](#) [57102-S06-03LF](#) [57202-S52-04LF](#) [PCN6-15S-2.5E](#) [0039019024](#) [58102-G61-06LF](#) [582553-1](#) [0009485154](#) [0009508121](#) [0022285053](#) [0050291907](#) [018731A](#) [LY20-4P-DT1-P1E-BR](#) [02.125.8002.8](#) [60101931](#) [60598-1 \(Cut Strip\)](#) [M1625-3R/100](#) [61062-3](#) [61082-181009](#) [CSU011177004](#) [636-1427](#) [638009-1](#) [641938-9](#) [641991-4](#) [644168-1](#) [644827-2](#) [647662-1](#) [65039-019ELF](#) [65692-001LF](#) [65781-018](#) [65781-047](#)