

△ N = Number of poles
 Dim L = (N × 5.08) + 2.54
 Dim P = (N - 1) × 5.08

| | Dim L | Dim P |
|--------|-------|-------|
| 1p | ±0.10 | ±0.10 |
| 2-6p | ±0.15 | ±0.10 |
| 7-12p | ±0.20 | ±0.20 |
| 13-18p | ±0.30 | ±0.25 |
| 19-24p | ±0.40 | ±0.30 |

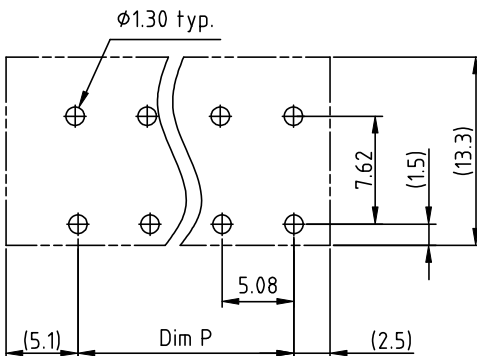

△ P.C.B. LAYOUT
 Bottom view

| SIGN | DATE | DESCRIPTION | APPROVER |
|------|------------|---|----------|
| △ | 01/20/07 | The Soldering temperature from 245° to 250° | Aaron |
| △ | 2010.08.12 | The design is changed | Chen Bo |
| △ | 2012.07.18 | The tolerance are added | Runner |
| △ | 10/29/12 | update the drawing | Da cheng |
| △ | 2015.09.29 | Update the drawing | Airy min |

THIS IS CAD DRAWING, DO NOT REVISE MANUALLY!!!

Material:

- Item ① Lever: Thermoplastic (UL94V-0) Orange RAL2011/P
- Item ② Terminal body: Thermoplastic (UL94V-0)
- Item ③ cover: Thermoplastic (UL94V-0)
- Item ④ Spring clamp: Stainless steel
- △ ● Item ⑤ contact pin: Brass. Bright Tin plated over Nickel plated

Electrical cULus/VDE

- Voltage rating: 300VAC/250VAC
- Current rating: 10A/10A
- Wire range: 0.75-1.5mm²
- Solid wire(AWG): 14-24
- Stranded wire(AWG): 14-24
- Wire strip length: 9-10mm
- Withstanding Voltage: 1.6KV/2KV
- Operating temperature: -40°C to +115°C
- Soldering temperature: 260°C±5°C/5 Sec
- Safety Approval: △
- Critical dimension: △

HA xx 00 x 0 xxxx G

- △ 01 1 Poles
- 02 2 Poles
-
- 24 24 Poles

△ Body color

- 0 Black (RAL9005)
- 2 Red (RAL3001/D)
- 5 Green(RAL6018/T)
- 8 Grey(RAL7004/P)
- 9 White(RAL1102)
- C Multiple colors

RoHS compliant (lead<4%)
 In copper Alloy
 0000: "@ " Logo (Standard)
 000A: "ANYTEK" Mark
 Any special item by customer request. please contact sales department.

| ANYTEK | | | | CUSTOMER COPY | | | |
|---|--|----------------------|------------------------|------------------------|----------|---------|------------|
| ALL RIGHTS RESERVED. REPRODUCTION OR ISSUE TO THIRD PARTIES IN ANY FORM WHATSOEVER IS NOT PERMITTED WITHOUT WRITTEN AUTHORITY FROM THE PROPRIETOR. PROPERTY OF ANYTEK TECHNOLOGY CO., LTD | | | | | | | |
| TITLE | | HA-5.08mm 90° series | | | | | |
| PART NO. | | HAxx00x0xxxxG | | DWG NO. | | 8HA0101 | |
| APPROVED | | CHECKED | DESIGNED | DRAWN | CUST NO. | | Tolerance |
| | | | Airy min 2015.09.29 | Airy min 2015.09.29 | | | X. ±0.50 |
| | | | | | | | X.X ±0.30 |
| | | | | | | | X.XX ±0.10 |
| | | | | | | | X° ±1° |
| | | | | SHEET: 01/01 | | REV.: G | |

X-ON Electronics

Largest Supplier of Electrical and Electronic Components

Click to view similar products for [Pluggable Terminal Blocks](#) category:

Click to view products by [Amphenol](#) manufacturer:

Other Similar products are found below :

[57.510.0053](#) [721-104/026-047](#) [721-204/026-045](#) [MC 1.5/ 6-ST-3.5 GY AU](#) [ET02015000J0G](#) [860505](#) [860516](#) [860810](#) [GBPACX-12](#)
[93.731.4953.0](#) [PV05-5,08-K](#) [PVP03-3,50](#) [PVS02-5,00](#) [1-1986160-3](#) [1377680000](#) [1531000000](#) [1546228-5](#) [ELFP03110](#) [ELFP10210](#)
[ELFT06250](#) [ELFT07250](#) [ELVD12100](#) [ELVF09400](#) [ELXH071G0E](#) [1634640000](#) [1725220000](#) [1760336](#) [1855000000](#) [19346](#) [1946309](#)
[1973592](#) [19892](#) [2-1546857-6](#) [25.320.4053.1](#) [25.320.4553.9](#) [25.320.4753.1](#) [25.320.5453.1](#) [25.340.0353.1](#) [25.340.1053.1](#) [25.345.3553.0M001](#)
[25.640.3553.1](#) [SH02-5,08](#) [SH06-3,81](#) [SH08-5,08](#) [SH08-5,08-K](#) [SH12-5,08](#) [SHS04-5,00](#) [30.303](#) [30.305](#) [30.306](#)