

THIS DRAWING IS SUPPLIED FOR INFORMATION ONLY. DESIGN FEATURES, SPECIFICATIONS AND PERFORMANCE DATA SHOWN HEREON ARE THE PROPERTY OF THE AMPHENOL CORPORATION. NO RIGHTS OF REPRODUCTION ARE IMPLIED. ALL DIMENSIONS ARE SUBJECT TO NORMAL MANUFACTURING VARIATIONS.

Customer Drawing

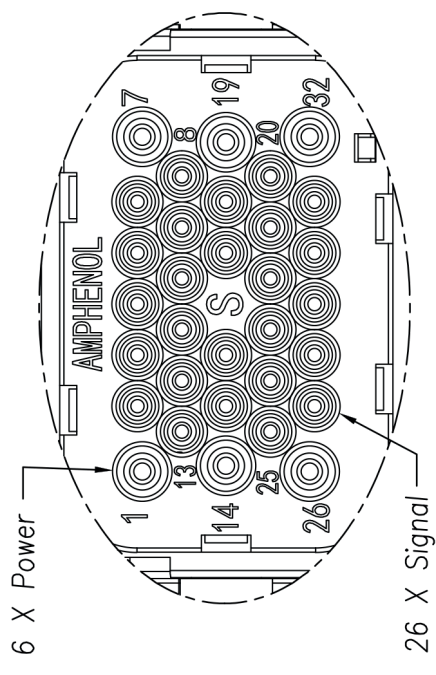
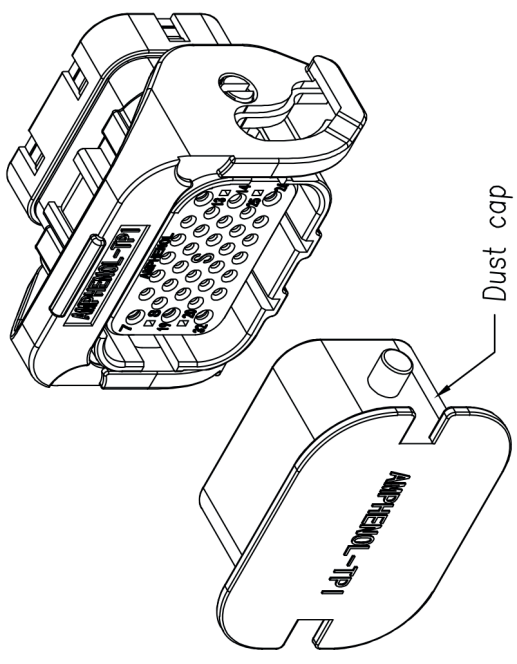
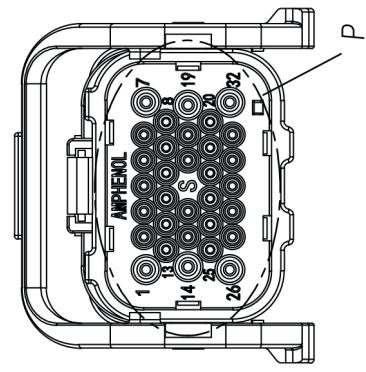
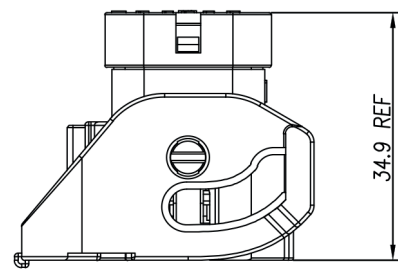
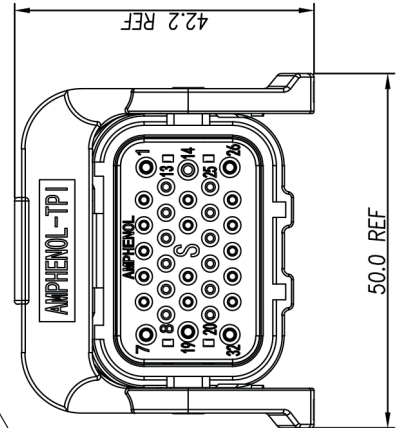

Detail P
Scale 2:1

- 规格参数 (Spec.):
1. 工作温度 Operating Temperature: -40° C--+125° C.
 2. 额定电流 Current Rating: Power: 13 A MAX. Signal: 5 A MAX.
 3. 配对线径 Cable Size:
 - 3.1. Power: 14~18 AWG.
 - 3.2. Signal: 20~22 AWG.
 4. 耐压 Dielectric Withstanding Voltage: 3000 VDC.
 5. 防护等级 Protection Class: IP67.
 6. 机械寿命 Mating Cycle: 100 Min.
 7. 对配插头视图纸 Mating plug see drawing: "HC08B-P32R"

订购信息 Ordering Information

HC18 B - S32

键位 Key
"B"

For Information on Crimp
Contacts please consult factory

AMPHENOL		Amphenol Technical Products International GZ			
第三角投影 THIRD ANGLE PROJECTION	日期 DATE	幅面 SIZE	版次 REL.	比例 SCALE	零件名称 PART NAME:
	05/06/15	A3	A		HC 320XT Plug Straight Code B
签名 SIGNATURE	日期 DATE	UNLESS OTHERWISE SPECIFIED			
制图 DRAWN	05/06/15	1) All dimensions are in metric(mm).			
审核 CHECKED	05/06/15	2) Tolerances are as follows:			
批准 APPROVAL	05/06/15	1 PL DEC ±1.00	Angle ±1°		
		2 PL DEC ±0.20			
			零件号 PART NO:	HC18B-S32	
			客户零件号 CUSTOMER PART #:	N/A	

X-ON Electronics

Largest Supplier of Electrical and Electronic Components

Click to view similar products for [Heavy Duty Power Connectors](#) category:

Click to view products by [Amphenol](#) manufacturer:

Other Similar products are found below :

[6646058-2](#) [6646137-1](#) [6646138-1](#) [6646940-1](#) [6651091-1](#) [6651525-1](#) [6651529-1](#) [696475-1](#) [702-32-01109](#) [73080255059](#) [73080965046](#)
[7310205040001](#) [765-16-0080B](#) [765-18-0080D](#) [MHDM35-15-K](#) [902-77-02113](#) [PS00/A0620/6300](#) [PS25/A0420/63](#) [AN0024023](#) [154-](#)
[42B7WM250](#) [1643543-1](#) [1766966-1](#) [1791340000](#) [NLDFT-3-BL-L-S120-M40A](#) [1926015-1](#) [NPS-3-BL-T6](#) [2-1589900-8](#) [9300480317](#) [294-](#)
[0091-01100](#) [295-0068-01100](#) [296-0040-01100](#) [1-6609148-0](#) [A32595-0049](#) [1766249-1](#) [19000005132](#) [1-966831-8](#) [AN0024202](#) [AN0264023](#)
[279-0841-10100A](#) [281-0334-00100A](#) [RMSB4](#) [419-2083-301](#) [LCDX4/0-14B-X](#) [075-8519-001](#) [078238-1613](#) [07.470.3256.0](#) [09000005288](#)
[09140240311](#) [09300240303](#) [09370009946](#)