

REVISIONS			
REV	DESCRIPTION, ECN, EAR NO.	DATE	APP'D
B	PRODUCT DRAWING (EAR 14655)	OCT26/18	K.L.
C	PRODUCT DRAWING (EAR 14655)	NOV21/18	K.L.

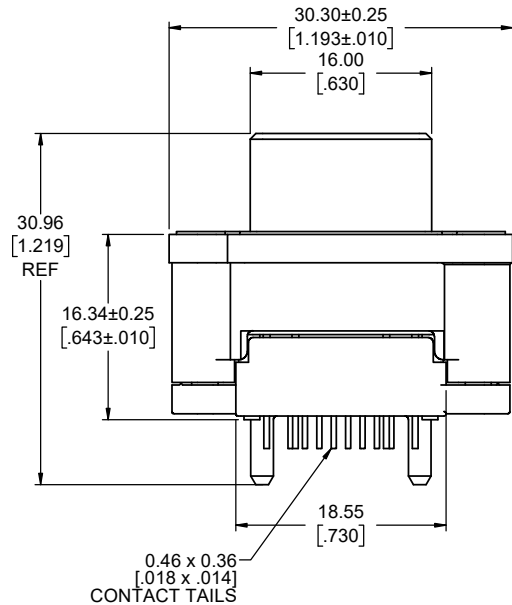
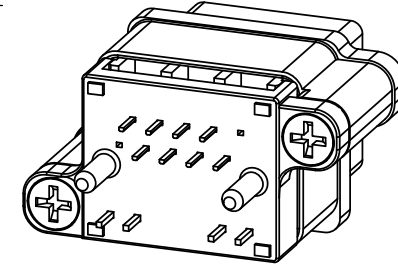
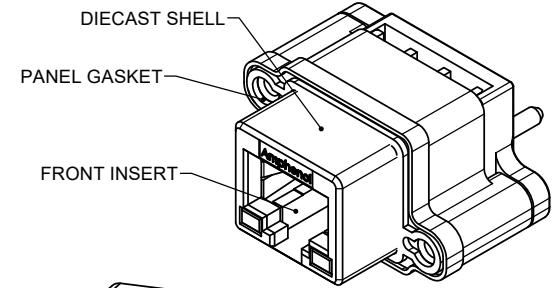

**ORDERING CODE: MRJR-948X-XC**

SERIES, RUGGED RJ  
 CAT6A RJ45 RECEPTACLE, VERTICAL PCB TAIL, 8 CONTACTS  
 LED OPTION:  
 0 = NONE  
 1 = GREEN LEFT, YELLOW RIGHT  
 4 = YELLOW LEFT, GREEN RIGHT  
 5 = GREEN LEFT, GREEN RIGHT  
 7 = RED LEFT, GREEN RIGHT  
 A = BI-COLOUR GREEN/YELLOW LEFT  
 BI-COLOUR GREEN/YELLOW RIGHT  
 D = GREEN LEFT  
 BI-COLOUR GREEN/YELLOW RIGHT  
 E = YELLOW LEFT  
 BI-COLOUR GREEN/YELLOW RIGHT  
 TAIL LENGTH AND MOUNTING HOLE THREAD OPTION:  
 0 = "A" 2.54 [.100], #4-40 UNC  
 B = "A" 3.81 [.150], #4-40 UNC  
 M = "A" 2.54 [.100], M3 X 0.5  
 P = "A" 3.81 [.150], M3 X 0.5  
 SINGLE PORT, EXTRA CLEARANCE NEAR SHELL MOUNTING HOLES

**SPECIAL CONNECTORS**  
 MANY UNIQUE FEATURES ARE READILY AVAILABLE TO SUIT CUSTOMER REQUIREMENTS. CONSULT WITH AMPHENOL CANADA FOR DETAILS.

**NOTES:**

- MATERIALS: ALL MATERIALS ARE RoHS COMPLIANT PER EU DIRECTIVE 2011/65/EU AND AMENDMENTS
  - SHELL - DIECAST ZINC, NICKEL PLATED
  - CONTACTS - PHOSPHOR BRONZE WITH 1.27µm [50 µ"] MIN GOLD OVER 1.27µm [50 µ"] NICKEL ON THE MATING AREA AND MATTE TIN OVER NICKEL ON THE CONTACT TAILS.
  - INSERTS - ENGINEERING THERMOPLASTIC, UL94V-0 FLAMMABILITY RATING, REAR INSERTS: BLACK NYLON, FRONT INSERT: CLEAR POLYCARBONATE
  - GASKET - SILICONE RUBBER, CONDUCTIVE, BLACK
  - LED'S - EPOXY LENS, STEEL TAILS WITH TIN PLATING
  - PCB - FR-4 FIBERGLASS, LEAD FREE, UL94V-0 FLAMMABILITY RATING
- ENVIRONMENTAL PERFORMANCE PER IEC 60529 CODE IP67 FOR SEAL BETWEEN MATING AREA AND PCB SIDE OF CONNECTOR. GASKET PROVIDES SEAL TO INSIDE FACE OF PANEL.
- CURRENT RATING: 1.25 AMPERES
- CONTACT RESISTANCE: 30 MILLIOHMS MAXIMUM
- OPERATING TEMPERATURE: -40C TO +105C
- LED CHARACTERISTICS: FORWARD DC CURRENT 25 mA MAX. FORWARD VOLTAGE 2.5V MAX. @ 2 mA
- RECOMMENDED TORQUE FOR PANEL MOUNT SCREWS: 0.45 TO 0.65 N-m (4.0 TO 5.75 IN-LBS) FOR STEEL SCREWS WITH 3.00 (.118) THREAD ENGAGEMENT.
- CUSTOMER TO VERIFY THAT ALL PROCESS CLEANERS ARE COMPATIBLE WITH POLYCARBONATE MATERIAL.
- AVAILABLE MATING AREA COVERS PROVIDE ADDED PROTECTION. CONSULT WITH AMPHENOL CANADA FOR MORE DETAILS.
- COMPARED TO DRAWING P-MRJR-54XX-XF, PARTS ON THIS DRAWING HAVE EXTRA CLEARANCE NEAR THE SHELL MOUNTING HOLES (2 PLCS).

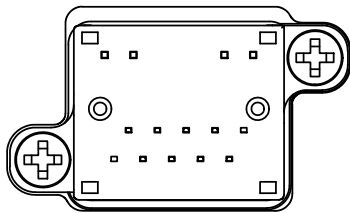

UNLESS SPECIFIED OTHERWISE	DRAWN M. PAHLJE	MAR27/18
PRIMARY UNITS MILLIMETERS	CHECKED K.LAMBIE	APR25/18
SECONDARY INCHES	M.E. APP'D	
REFERENCE IN PARENTHESES	Q.A. APP'D	
GENERAL TOLERANCES	DWG APPR.	
1 DECIMAL PLACE	ENG. REL. NO.	EAR 14655
2 DECIMAL PLACES ±0.15	REF.	
3 DECIMAL PLACES	THIRD ANGLE PROJECTION	
ANGULAR DEGREES	DO NOT SCALE DRAWING	

**Amphenol Canada Corp.**  
 www.amphenolcanada.com

MRJR SERIES RUGGED CAT6A MODULAR JACK, 8 CONTACTS, VERTICAL, LED, THREAD, & TAIL LENGTH OPTIONS, EXTRA SHELL CLEARANCE, RoHS COMPLIANT

DWG. NO. **P-MRJR-948X-XC** REV **C**

CODE ID NO. 03554 DWG SIZE: X SCALE: 3:1 SHEET 1 OF 2

REVISIONS			
REV	DESCRIPTION, ECN, EAR NO.	DATE	APP'D
B	PRODUCT DRAWING (EAR 14655)	OCT26/18	K.L.
C	PRODUCT DRAWING (EAR 14655)	NOV21/18	K.L.

**RECOMMENDED PCB LAYOUT**  
COMPONENT SIDE OF BOARD

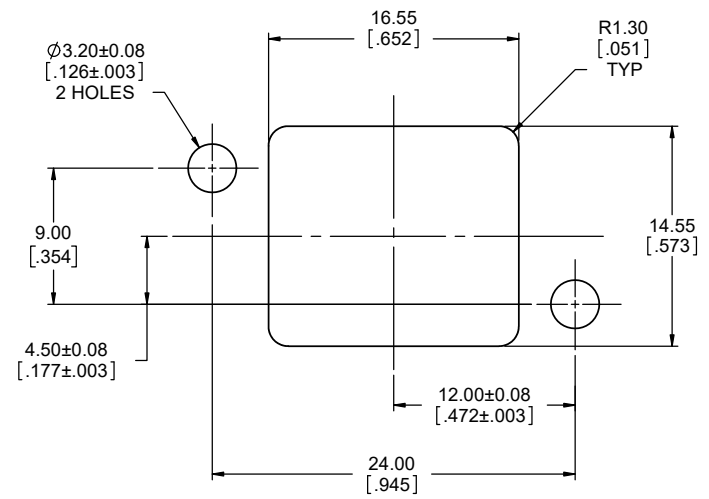
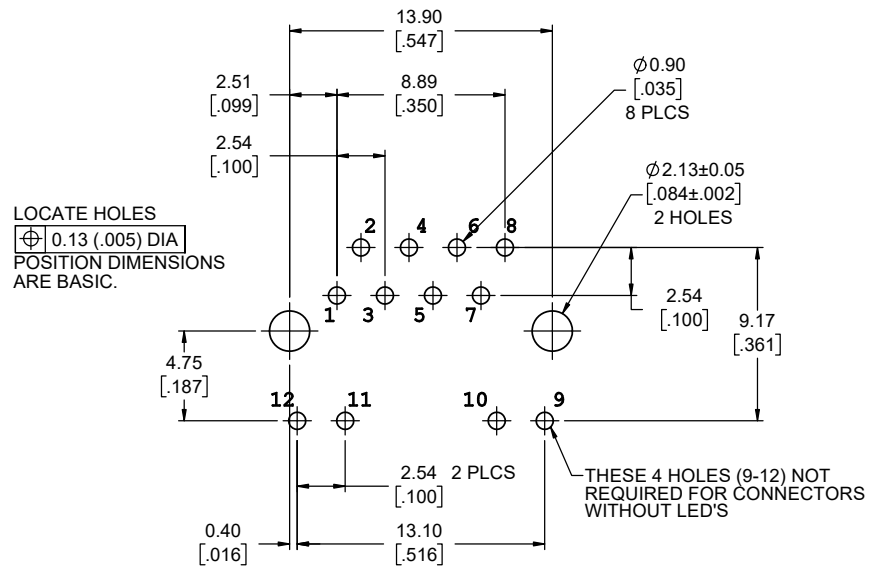

**RECOMMENDED PANEL CUTOUT**  
OUTSIDE PANEL VIEW

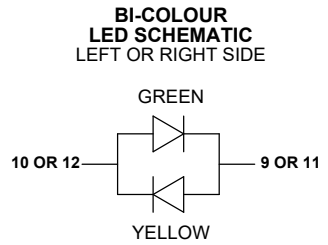
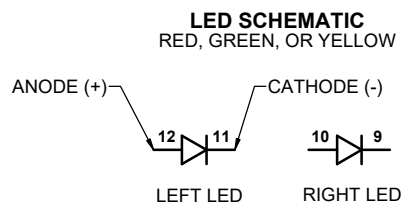

UNLESS SPECIFIED OTHERWISE	DRAWN M. PAHULJE	MAR27/18
PRIMARY UNITS MILLIMETERS	CHECKED K.LAMBIE	APR25/18
SECONDARY INCHES	M.E. APP'D	
REFERENCE IN PARENTHESES	Q.A. APP'D	
GENERAL TOLERANCES	DWG APPR.	
1 DECIMAL PLACE	ENG. REL. NO.	EAR 14655
2 DECIMAL PLACES ±0.15	REF.	
3 DECIMAL PLACES	THIRD ANGLE PROJECTION	
ANGULAR DEGREES	DO NOT SCALE DRAWING	

**Amphenol Canada Corp.**  
[www.amphenolcanada.com](http://www.amphenolcanada.com)

MRJR SERIES RUGGED CAT6A MODULAR JACK,  
 8 CONTACTS, VERTICAL, LED, THREAD, & TAIL  
 LENGTH OPTIONS, EXTRA SHELL CLEARANCE,  
 RoHS COMPLIANT

DWG. NO. **P-MRJR-948X-XC** REV **C**

CODE ID NO. 03554 DWG SIZE: X SCALE: 5:1 SHEET 2 OF 2

THIS DOCUMENT CONTAINS PROPRIETARY INFORMATION AND SUCH INFORMATION MAY NOT BE DISCLOSED TO OTHERS FOR ANY PURPOSE OR USED FOR MANUFACTURING PURPOSES WITHOUT WRITTEN PERMISSION FROM AMPHENOL CANADA CORP.

## X-ON Electronics

Largest Supplier of Electrical and Electronic Components

*Click to view similar products for [Modular Connectors](#) / [Ethernet Connectors](#) category:*

*Click to view products by [Amphenol](#) manufacturer:*

Other Similar products are found below :

[RJE231881317T](#) [MP1010RX-1000](#) [MP44RX-1000](#) [GAX-3-66](#) [GAX-8-62](#) [93606-0253](#) [GD-A-44](#) [GDCX-PA-66-50](#) [GDCX-PN-64](#) [GDCX-PN-66](#) [GDCX-PN-66-50](#) [GDLX-A-66](#) [GDLX-A-88](#) [GDLX-N-66](#) [GDLX-S-88K](#) [GDTX-S-88-50](#) [GDX-PA-1010](#) [GLX-N-1010M-BLK](#) [GLX-N-44M](#) [GLX-S-88M-BLK](#) [GMX-N-1010](#) [GMX-S-1010](#) [GMX-S-66](#) [GMX-SMT2-N-1010](#) [GMX-SMT2-N-64-50](#) [GMX-SMT2-S6-88](#) [GMX-SMT4-N-88](#) [GPX-2-64](#) [GRT1-BT1-5](#) [GSGX-N-2-88](#) [GSX-NS2-88-3.05](#) [GSX-NS2-88-3.05-50](#) [GSX-NS-88-3.05-30](#) [GSX-NS-88-3.05-50](#) [GSX-NS-88-3.68](#) [1-1775629-2](#) [GWLX-S-88-GR](#) [GWLX-S9-88-YG](#) [1300500326](#) [1300500227](#) [1300530003](#) [1300570002](#) [1324640-4](#) [RJ11FTVC2G](#) [RJ11FTVC2N](#) [RJFTVX2SA1G](#) [132764-001](#) [1400000](#) [1413176](#) [1413235](#)