

| | | | | |
|------|---------|------------|-------|-------------|
| REV. | ECN NO. | DATE | SIGN | DESCRIPTION |
| A | | 2018/04/16 | Brady | New Initial |

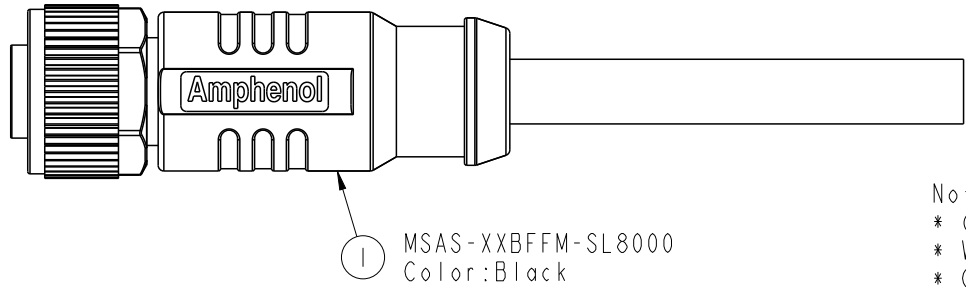
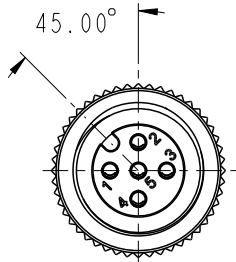
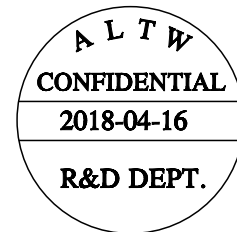
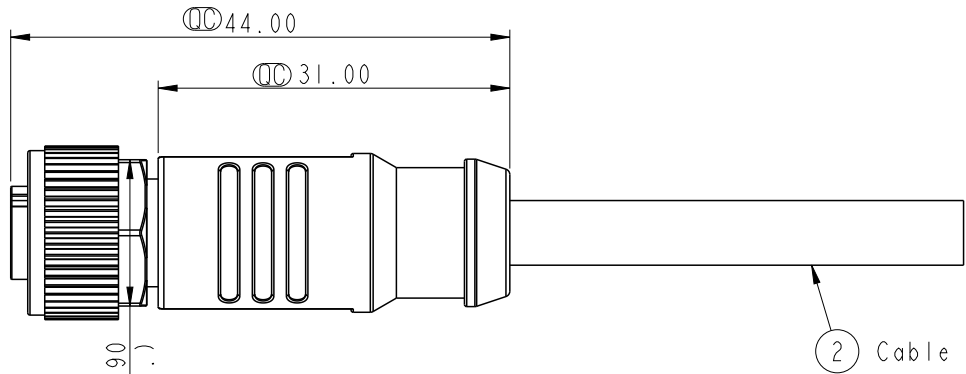

- Notes:
- * ④ Important Dimension.
 - * Waterproof Rate: IP68(Under water 1M for 24Hrs).
 - * Connector: Nylon+GF, Black.
 - * Female Pin: Copper Alloy, Gold Plated.
 - * Screw Nut: Zinc Alloy, Nickel Plated.
 - * Outer Mold: PP, Black.
 - * Cable: UL2517, Shield, PVC Jacket,UV resistant. Black.
UL20549,Shield, PU Jacket, Black.
 - * Rated Voltage: 3 & 4Pin 250V dc. or ac.
5Pin 60V dc. or ac.
6~12Pin 30V dc. or ac.
 - * Rated Current: 3~5Pin 4A
6~8Pin 2A
10~12Pin 1.5A
 - * Operating Temperature: -25~85°C

| | | |
|-----------|--|--|
| UNIT:mm | | |
| TOLERANCE | | |
| ±0.5mm | | |

| | | |
|--|----------------|--------------------|
| TITLE M12 Shielded A Code Cable Female Conn. | | |
| SCALE 3:2 | SIZE A4 | SHEET 1 OF 3 |
| REV. A | WC-REV. A.3 | ④: Inspection item |

Amphenol LTW
安費諾亮泰企業股份有限公司

| | | |
|------------------------------|--------------------|--------------------|
| ITEM NO | DRAWN BY Brady | DATE 2018/04/16 |
| DWG NO MSAS-XXBFFM-SL8XXX | CHECKED BY Neo | DATE 2018/04/16 |
| CUSTOMER ALTW | APPROVED BY Max | DATE 2018/04/16 |

THIS DOCUMENT IS SUBJECT TO CHANGE WITHOUT NOTICE. IT IS CONFIDENTIAL AND A PROPERTY OF Amphenol LTW. DISCLOSURE TO THIRD PARTY HAS TO BE AUTHORIZED BY Amphenol LTW.

THIS DOCUMENT IS SUBJECT TO CHANGE WITHOUT NOTICE. IT IS CONFIDENTIAL AND A PROPERTY OF Amphenol LTW. DISCLOSURE TO THIRD PARTY HAS TO BE AUTHORIZED BY Amphenol LTW.

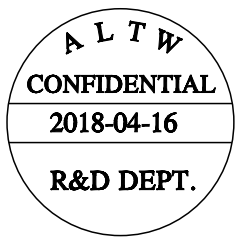

| | | | | |
|----------|--------------|----------|-----|--------------------|
| 12P | PU | 6.4 | 26 | MSAS-12BFFM-SL8EXX |
| 8P | | 5.8 | 24 | MSAS-08BFFM-SL8EXX |
| 5P | | 5.7 | 22 | MSAS-05BFFM-SL8EXX |
| 12P | PVC | 6.4 | 26 | MSAS-12BFFM-SL8DXX |
| 8P | | 5.8 | 24 | MSAS-08BFFM-SL8DXX |
| 5P | | 5.7 | 22 | MSAS-05BFFM-SL8DXX |
| Contacts | Cable Jacket | Cable OD | AWG | Item No. |

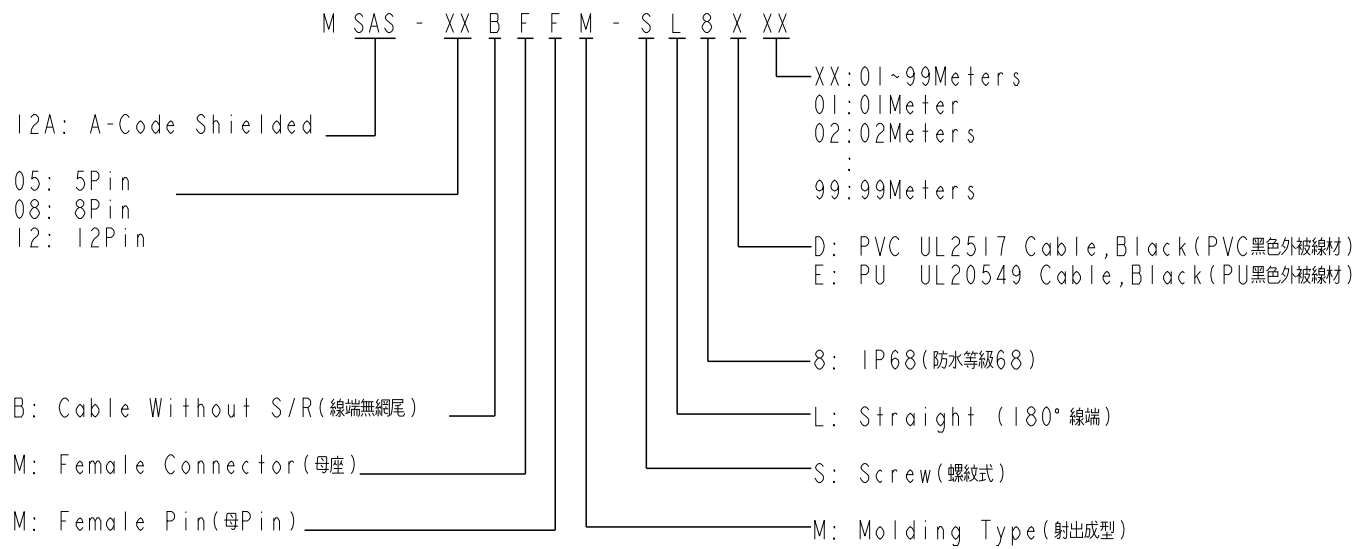

UNIT: mm

TOLERANCE ±0.5mm

| | | | |
|--|----------------|---------------------|--|
| TITLE M12 Shielded A Code Cable Female Conn. | | | |
| SCALE 3:2 | SIZE A4 | SHEET 2 OF 3 | |
| REV. A | WC-REV. A.3 | QC: Inspection item | |

Amphenol LTW
安費諾亮泰企業股份有限公司

| | | |
|------------------------------|--------------------|--------------------|
| ITEM NO | DRAWN BY Brady | DATE 2018/04/16 |
| DWG NO MSAS-XXBFFM-SL8XXX | CHECKED BY Neo | DATE 2018/04/16 |
| CUSTOMER ALTW | APPROVED BY Max | DATE 2018/04/16 |

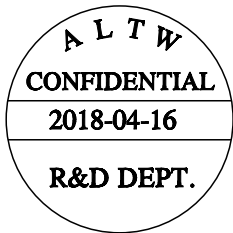

| | | | | | | | | | | | | | | | | | | | | |
|---|-------|---|---|-------|---|---|-------|---|---|--------|---|---|--------|---|----|--------|---|----|-----------|-----|
| 5 | -- | | 5 | -- | | 5 | Gray | 灰 | 8 | -- | | 8 | Red | 紅 | 12 | -- | | 12 | Red/Blue | 紅/藍 |
| 4 | Black | 黑 | 4 | Black | 黑 | 4 | Black | 黑 | 7 | Blue | 藍 | 7 | Blue | 藍 | 11 | -- | | 11 | Gray/Pink | 灰/粉 |
| 3 | Blue | 藍 | 3 | Blue | 藍 | 3 | Blue | 藍 | 6 | Pink | 粉 | 6 | Pink | 粉 | 10 | Violet | 紫 | 10 | Violet | 紫 |
| 2 | -- | | 2 | White | 白 | 2 | White | 白 | 5 | -- | | 5 | Gray | 灰 | 9 | Black | 黑 | 9 | Black | 黑 |
| 1 | Brown | 棕 | 1 | Brown | 棕 | 1 | Brown | 棕 | 4 | Yellow | 黃 | 4 | Yellow | 黃 | 8 | Red | 紅 | 8 | Red | 紅 |
| | | | | | | | | | 3 | Green | 綠 | 3 | Green | 綠 | 7 | Blue | 藍 | 7 | Blue | 藍 |
| | | | | | | | | | 2 | Brown | 棕 | 2 | Brown | 棕 | 6 | Pink | 粉 | 6 | Pink | 粉 |
| | | | | | | | | | 1 | White | 白 | 1 | White | 白 | 5 | Gray | 灰 | 5 | Gray | 灰 |
| | | | | | | | | | | | | | | | 4 | Yellow | 黃 | 4 | Yellow | 黃 |
| | | | | | | | | | | | | | | | 3 | Green | 綠 | 3 | Green | 綠 |
| | | | | | | | | | | | | | | | 2 | Brown | 棕 | 2 | Brown | 棕 |
| | | | | | | | | | | | | | | | 1 | White | 白 | 1 | White | 白 |

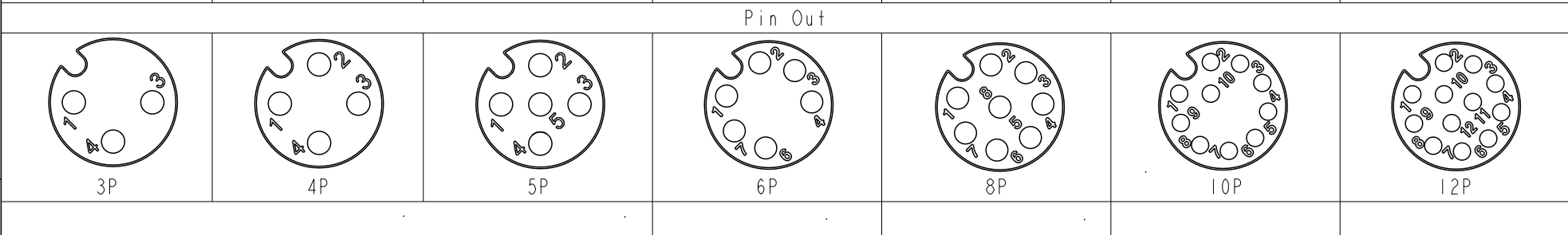

| | | | | | | | |
|--------------------------------|--|----------------|--|--|-------------------------------|--------------------|--------------------|
| UNIT:mm TOLERANCE ±0.5mm | TITLE M12 Shielded A Code Cable Female Conn. | | <h2 style="text-align: center;">Amphenol LTW</h2> <p style="text-align: center;">安費諾亮泰企業股份有限公司</p> | | ITEM NO MSAS-XXBFFM-SL8XXX | DRAWN BY Brady | DATE 2018/04/16 |
| | SCALE 3:2 | SIZE A4 | | | SHEET 3 OF 3 | CHECKED BY Neo | DATE 2018/04/16 |
| | REV. A | WC-REV. A.2 | | | (CC): Inspection item | APPROVED BY Max | DATE 2018/04/16 |

X-ON Electronics

Largest Supplier of Electrical and Electronic Components

Click to view similar products for [Sensor Cables / Actuator Cables](#) category:

Click to view products by [Amphenol](#) manufacturer:

Other Similar products are found below :

[60963](#) [60964](#) [M83513/19-F01CP](#) [703000D02F2002](#) [703001D02F0602](#) [703001D02F300](#) [704000D02F120](#) [773032K02F030](#) [802027107404-1](#)
[802027213811-1](#) [804001A09M150](#) [805001A09M0502](#) [84914-0235](#) [84914-0237](#) [885030A09M020](#) [8R4J30E03C3003](#) [1200651332](#)
[1200651713](#) [1200660844](#) [1200660845](#) [1200661173](#) [1200680071](#) [1200720053](#) [1200720081](#) [1200720099](#) [1200720217](#) [1200800231](#)
[1200860125](#) [1200870123](#) [1200980102](#) [1200650267](#) [1200650298](#) [1200660183](#) [1200660782](#) [1200660849](#) [1200661295](#) [1200661297](#)
[1200661342](#) [1200661343](#) [1200670080](#) [1200670220](#) [1200680331](#) [1200720252](#) [1200730184](#) [1200860344](#) [1200870359](#) [1200870643](#)
[1200980008](#) [1200980031](#) [1210502211](#)