

THIS DOCUMENT IS SUBJECT TO CHANGE WITHOUT NOTICE. IT IS CONFIDENTIAL AND A PROPERTY OF Amphenol LTW. DISCLOSURE TO THIRD PARTY HAS TO BE AUTHORIZED BY Amphenol LTW.

REV.	DESCRIPTION
A	Initial Release

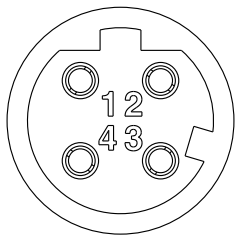

Pin Assignments  
Front View

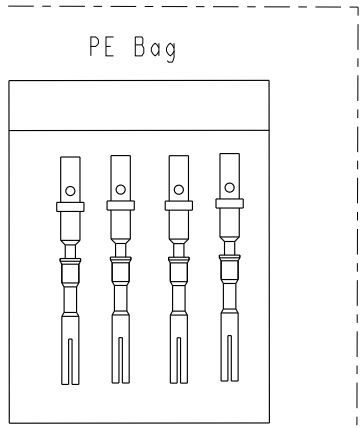
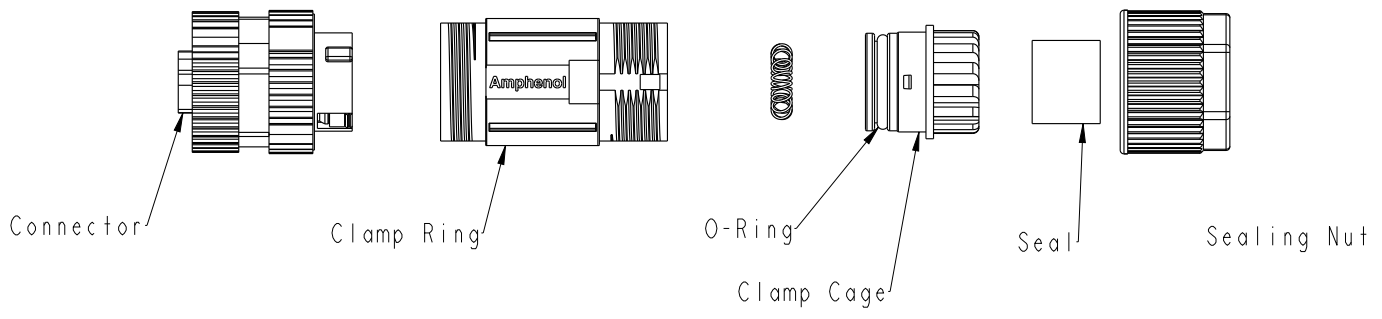
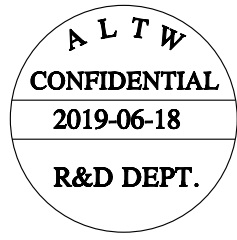
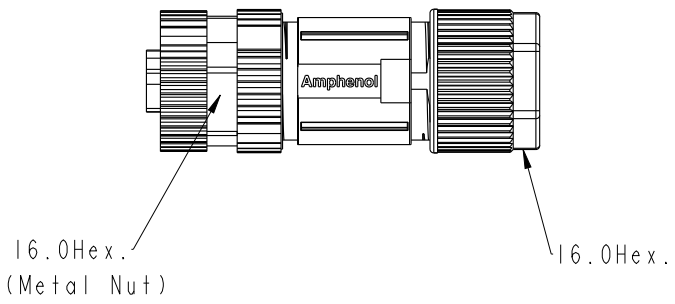

UNIT:mm		
TOLERANCE		
±0.5mm		

TITLE M12 D-Code Shielded Assy 4PIN F Conn. F Pin			
SCALE Free	SIZE A4	SHEET 1 OF 2	
REV. A	WC-REV. .0	QC: Inspection item	

**Amphenol LTW**  
安費諾亮泰企業股份有限公司

ITEM NO MSDS-04BFFC-SL7001	DRAWN BY Xiaofeng	DATE 2019/06/18
DWG NO MSDS-04BFFC-SL7001	CHECKED BY Li-Feng	DATE 2019/06/18
CUSTOMER ALTW	APPROVED BY Jerry	DATE 2019/06/18

THIS DOCUMENT IS SUBJECT TO CHANGE WITHOUT NOTICE. IT IS CONFIDENTIAL AND A PROPERTY OF Amphenol LTW. DISCLOSURE TO THIRD PARTY HAS TO BE AUTHORIZED BY Amphenol LTW.

REV.	DESCRIPTION

M SDS - XX B F F C - S L 7 001

SAS: D-Code Shielded ——— SDS

04: 4Pin ——— XX

B: Without S/R(無網尾) ——— B

F: Female Connector(母座) ——— F

F: Female Pin(母Pin) ——— F

C: Crimp Type(組裝式) ——— C

S: Screw(螺紋式) ——— S

L: Straight(180°) ——— L

7: IP67(防水等級67) ——— 7

001: Without Cable ——— 001

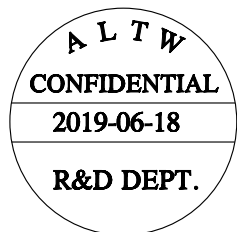

- Note:
- \* IP: IP67.
  - \* Housing: Thermoplastic, Black.
  - \* Female Pin: Metal.
  - \* Nut: Metal.
  - \* O-Ring: Silicone, Grey.
  - \* Clamp Ring: Metal.
  - \* Sealing Nut: Metal..
  - \* Seal: Silicone, Grey.
  - \* Seal For Cable OD:  $\varnothing 4.0\text{mm} \sim \varnothing 8.0\text{mm}$
  - \* Applicable Wire gauge (Stranded wire cross section) 20AWG ~ 24AWG
  - \* Mating Recommended tightening torque: 3~4 kgf.cm / 0.29~0.39 N.m
  - \* Sealing-Nut Recommended tightening torque: 4~6 kgf.cm / 0.39~0.59 N.m
  - \* Detailed applicable wire specifications may vary depending on the actual wire construction.

UNIT:mm

TOLERANCE  $\pm 0.5$

TITLE M12 D-Code Shielded Assy 4PIN F Conn. F Pin			
SCALE 1:1	SIZE A4	SHEET 2 OF 2	
REV. A	WC-REV. .0	QC: Inspection item	

**Amphenol LTW**  
安費諾亮泰企業股份有限公司

ITEM NO MSDS-04BFFC-SL7001	DRAWN BY Xiaofeng	DATE 2019/06/18
DWG NO MSDS-04BFFC-SL7001	CHECKED BY Li-Feng	DATE 2019/06/18
CUSTOMER ALTW	APPROVED BY Jerry	DATE 2019/06/18

## X-ON Electronics

Largest Supplier of Electrical and Electronic Components

*Click to view similar products for [Circular Metric Connectors](#) category:*

*Click to view products by [Amphenol](#) manufacturer:*

Other Similar products are found below :

[600X518037X](#) [6STD15PCR99B70A](#) [8R4000A16M020](#) [8R5000A16M005](#) [1200910002](#) [1203580030](#) [1200910008](#) [1200910011](#) [1300140094](#)  
[130203-0054](#) [1300140026](#) [1300150099](#) [1-3637-600-5205](#) [1612618](#) [21036836414](#) [8R4006A16M010](#) [1R3006A20M005](#) [41-40011](#) [42-00006](#)  
[42-01015](#) [4-22279-4](#) [4-22281-1](#) [4-22284-9](#) [43-00113](#) [43-01203](#) [41-40013](#) [42-00008](#) [43-00343](#) [43-01026](#) [43-01162](#) [43-01173](#) [43-10000](#)  
[XS3P-M421-2](#) [600X518050X](#) [8R5006A16M020](#) [8R5006A16M005](#) [8R4000A16M010](#) [6-22279-3](#) [1605332](#) [N03FA03144](#) [1300140077](#) [43-](#)  
[16213](#) [43-01338](#) [XS2RD4265](#) [XS2R-D426-1](#) [XS8A-0441](#) [859RD04-103R004](#) [860RD04-113R004](#) [860RD04-213R004](#) [1-213245-2](#)