

REV.	ECN NO.	DATE	SIGN	DESCRIPTION
C	LE3-910024	2009/01/06	Vicky	Modify the Wire Harness
D	LEN1350144	2013/05/08	Lu Di	Change Logo
E	LE31730071	2017/03/02	Ruru	Change Outer Mold Design

Conn. 2

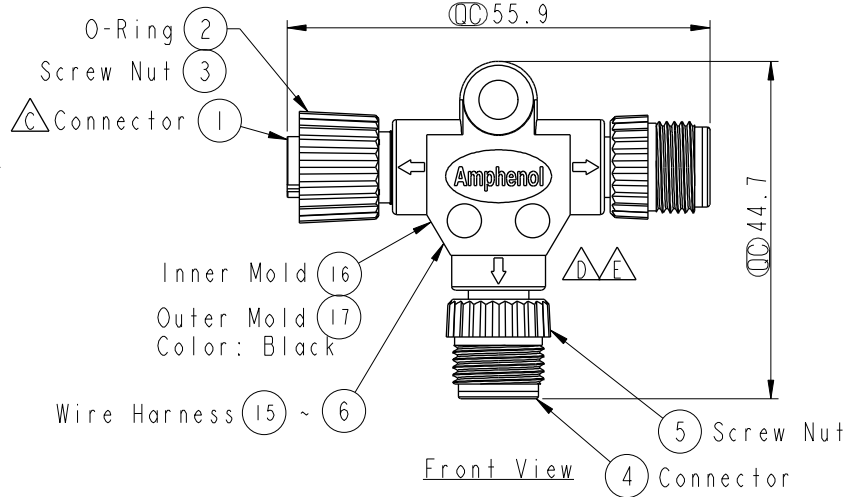

Conn. 3

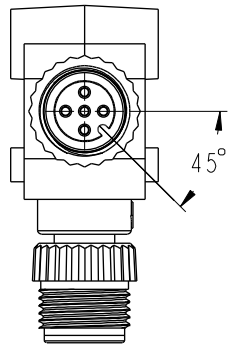
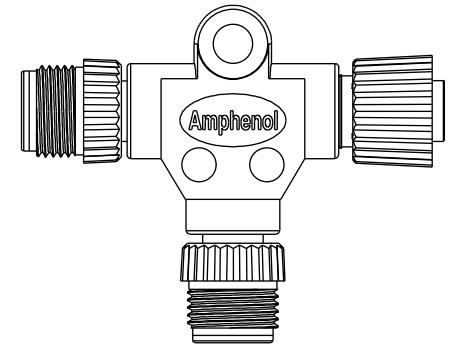
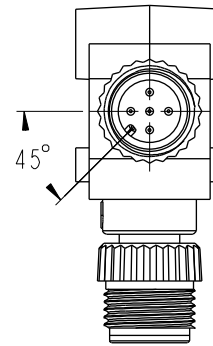

Back View

Front View

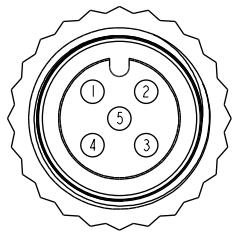

Conn. 2  
Pin Assignments  
Front View

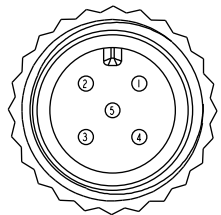

Conn. 1&3  
Pin Assignments  
Front View

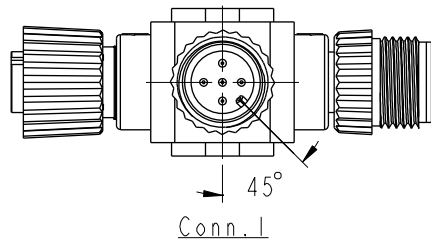

Conn. 1

Blue (24AWG) 藍	5	5	5
White (24AWG) 白	4	4	4
Black (22AWG) 黑	3	3	3
Red (22AWG) 紅	2	2	2
Green (24AWG) 綠	1	1	1
Wire Color	Conn. 1	Conn. 2	Conn. 3

Pin Out

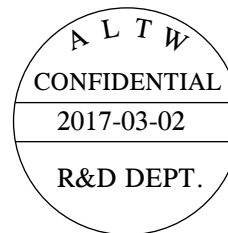

Note:

- \*  $\varnothing$  Important Dimension
- \* Waterproof Rate: IP68  
In 1 meter water within 24 hours
- \* Connector: PU, Black
- \* O- Ring: Viton, Green
- \* Screw Nut: Nylon+GF, Black
- \* Pin: Copper Alloy, Gold Plated
- \* Wire Harness: UL1061 24AWG, Green, White, Blue
- \* Wire Harness: UL1061 22AWG, Red, Black

UNIT:mm

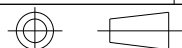

TOLERANCE

$\pm 0.5mm$

TITLE			
M12 Conn T Adaptor MFM Conn MFM Pin, 5Pin			
SCALE	SIZE	SHEET OF	
1:1	A4	1 OF 1	
REV.	WC-REV.	$\varnothing$ : Inspection item	
E	A.1		

**Amphenol LTW**  
安費諾亮泰企業股份有限公司

ITEM NO	DRAWN BY	DATE
PS-050505-MFM-TS001	Ruru	2017-03-02
DWG NO	CHECKED BY	DATE
PS-050505-MFM-TS001	Rita	2017-03-02
CUSTOMER	APPROVED BY	DATE
ALTW	Max	2017-03-02

THIS DOCUMENT IS SUBJECT TO CHANGE WITHOUT NOTICE. IT IS CONFIDENTIAL AND A PROPERTY OF Amphenol LTW. DISCLOSURE TO THIRD PARTY HAS TO BE AUTHORIZED BY Amphenol LTW.

## X-ON Electronics

Largest Supplier of Electrical and Electronic Components

*Click to view similar products for [Circular Metric Connectors](#) category:*

*Click to view products by [Amphenol](#) manufacturer:*

Other Similar products are found below :

[600X518037X](#) [MA1EAF1200](#) [6STD15PCR99B70A](#) [8R4000A16M020](#) [8R4A00A18M020](#) [8R5000A16M005](#) [1200910008](#) [1200910011](#)  
[1300140094](#) [130203-0054](#) [1300150099](#) [RF-12S1N8A90DU](#) [1-3637-600-5205](#) [1612618](#) [8R4006A16M010](#) [8R5006A18A120](#) [1604232](#)  
[1R3006A20M005](#) [RF-12P1N8A80DU](#) [RF-12P1N8A90DU](#) [41-01016](#) [41-40011](#) [41-40017](#) [42-01015](#) [4-22279-4](#) [4-22281-1](#) [4-22284-9](#) [43-](#)  
[00002](#) [43-01166](#) [41-40005](#) [41-40016](#) [43-00161](#) [43-01191](#) [XS3P-M421-2](#) [600X518050X](#) [SACC-DSI-FS-5P-PG9-L180 SC](#) [8R4006A16A120](#)  
[8R4000A16M010](#) [RKC 50/16](#) [1R3004A20A1201](#) [6-22279-3](#) [N03FA03144](#) [1300140077](#) [XS8A-0441](#) [859RD04-103R004](#) [860RD04-113R004](#)  
[860RD04-213R004](#) [860-X08-213R004](#) [1-213245-2](#) [2273142-2](#)