

REVISIONS				
REV	ECO	DESCRIPTION	DATE	BY APPR
A1	-	RELEASED DRAWING	Mar-29-2017	Ben Tommy
A2	-	UPDATE NOTES	Jul-05-2017	Nick Tommy
A3	-	UPDATE DRAWING	Mar-20-2018	White Tommy
A4	-	UPDATE DRAWING	Apr-10-2018	White Tommy
A5	-	MODIFY WIRE RANGE	Mar-1-2019	Flan Tommy

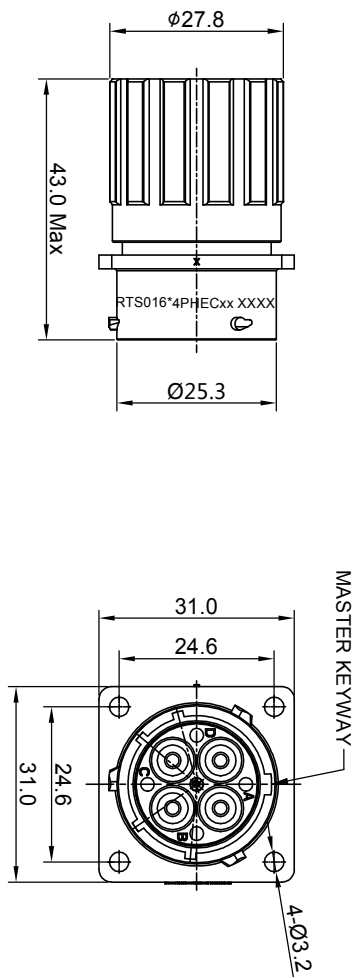

NOTES : (UNLESS OTHERWISE SPECIFIED)

- MATERIAL :
SHELL : THERMOPLASTIC , UL94 V-0.
INSERT : THERMOPLASTIC , UL94 V-0.
O-RING : NBR OR SILICONE RUBBER.
SEAL GASKET : NBR OR SILICONE RUBBER.
END CAP : THERMOPLASTIC , UL94 V-0.
PLASTIC RING:THERMOPLASTIC , UL94 V-0.
WIRE SEAL : SILICONE RUBBER.
- SPECIFICATIONS :
2.1 RATED CURRENT : 45A (MAX).
2.2 RATED VOLTAGE : 600V (AC/DC) .
2.3 OPERATING TEMPERATURE : SEE TABLE.
2.4 DIELECTRIC WITHSTANDING VOLTAGE : LESS THAN 2 MILLIAMPS CURRENT LEAKAGE@2000 VOLTS AC.
2.5 INSULATION RESISTANCE : 5000 MEGOHMS MIN.
2.6 IP-CLASS : IP67 AND IP69K IN THE MATED CONDITION.
WIRE SEALS FULLY POPULATED.
- SUITABLE CONTACTS : #8 CONTACT.
- ALL DIMENSIONS ARE FOR REFERENCE USE ONLY.
- CONTACT SIZE AND REAR SEAL WIRE RANGE :

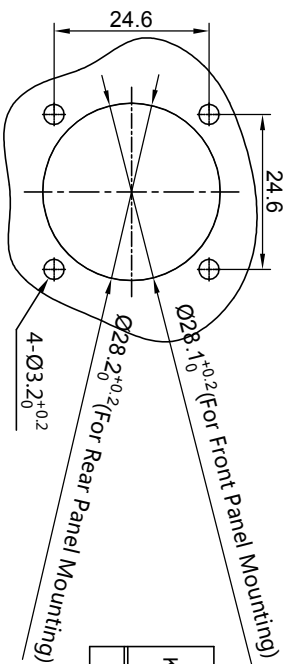

KEY POS	PART NUMBER
-40°C ~ 105°C	RTS016N4PHEC3
-40°C ~ 125°C	RTS016N4PHEC03

CONTACT SIZE	MIN. INSUL. O.D.	MAX. INSUL. O.D.	WIRE RANGE
#8	Ø2.8mm	Ø4.1mm	12 AWG

QUANTITY	PART NUMBER	DESCRIPTION	ITEM									
<table border="1"> <thead> <tr> <th colspan="2">SIGNATURES</th> <th>DATE</th> </tr> </thead> <tbody> <tr> <td>DRAWN: <i>Fln</i></td> <td>CHECKED: <i>Tld</i></td> <td>Mar-1-2019</td> </tr> <tr> <td>DESIGNED: <i>Tld</i></td> <td>APPROVAL: <i>Tommy</i></td> <td>Mar-1-2019</td> </tr> </tbody> </table>				SIGNATURES		DATE	DRAWN: <i>Fln</i>	CHECKED: <i>Tld</i>	Mar-1-2019	DESIGNED: <i>Tld</i>	APPROVAL: <i>Tommy</i>	Mar-1-2019
SIGNATURES		DATE										
DRAWN: <i>Fln</i>	CHECKED: <i>Tld</i>	Mar-1-2019										
DESIGNED: <i>Tld</i>	APPROVAL: <i>Tommy</i>	Mar-1-2019										
<p>MATERIALS LIST</p> <p>ECO-MATE, RECEPTACLE, FLANGE, SIZE 16, 4POS, PIN END CAP.</p> <p>Amphenol</p> <p>Sine Systems - www.amphenol-sine.com 44724 Morley Drive Clinton Township, MI 48036</p>												
<p>UNLESS OTHERWISE SPECIFIED</p> <p>1) All dimensions are in millimeters.</p> <p>2) Tolerances are as follows: 3 PL DEC 20-18 Angles ±1/16 3 PL DEC 20-18 Angles ±1°</p> <p>3) Note reference = Δ</p>		<p>THIS DRAWING IS SUPPLIED FOR INFORMATION ONLY. DESIGN FEATURES, DIMENSIONS AND MATERIALS ARE SHOWN HEREON AND ARE THE PROPERTY OF AMPHENOL CORPORATION. NO RIGHTS OR DIMENSIONS ARE SUBJECT TO NORMAL MANUFACTURING VARIATIONS.</p>										
<p>PROCESS SPECIFICATIONS:</p> <p>NEW ASBY:</p>		<p>SIZE TYPE DWG NO.</p> <p>B C- RTS016*4PHECxx</p> <p>SCALE: NONE</p>										

X-ON Electronics

Largest Supplier of Electrical and Electronic Components

Click to view similar products for [Standard Circular Connector](#) category:

Click to view products by [Amphenol](#) manufacturer:

Other Similar products are found below :

[5M2530B10P](#) [600259N006](#) [600273N007](#) [6134-336-13149](#) [6134-337-11149](#) [6134-337-2390](#) [6134-341-17149](#) [6280-4SG-516](#) [6280-7SG-3DC](#)
[6290](#) [6291A](#) [66200A-10](#) [680-SMG](#) [681-PMG](#) [CXS3102A14S2P](#) [CXS3102A181S](#) [7251-6SG-300](#) [7271-6SG-300](#) [7282-3PG-300-CH3](#) [75-](#)
[474014-05S](#) [75-474618-01S](#) [75-474618-04P](#) [75-474618-04S](#) [799539-000](#) [MI8-SE](#) [805-005-07NF11-19PC](#) [805-005-07NF15-7PA](#) [8280-4PG-](#)
[516](#) [8280-7PG-519](#) [8282-5PG-519](#) [836783-1](#) [MP-4102-25P-C](#) [862256-1](#) [864019-2](#) [866857-1](#) [867865-1](#) [PT01SP-14-18P](#) [PT08P-14-5S](#)
[PTSF06SE-14-12S](#) [120-1833-000](#) [QCM019PC2DC012B](#) [1-2069279-1](#) [121583-0217](#) [121667-0020](#) [129591AU](#) [1000B BULK](#) [RD10A16-19-](#)
[P6CS051/1](#) [RD10A20-31-P8CS051/1](#) [RD16A14-12-S6CS051/2](#) [1301240290](#) [1301240347](#)