

REV. A		SHEET 1 OF 2		RVPX-JE208EXX	
REVISIONS					
LTR	DESCRIPTION			DATE	
A	INITIAL RELEASE			17-DEC-19	

PART MARKING AS FOLLOWS  
AMPHENOL 77820  
'DATE CODE'

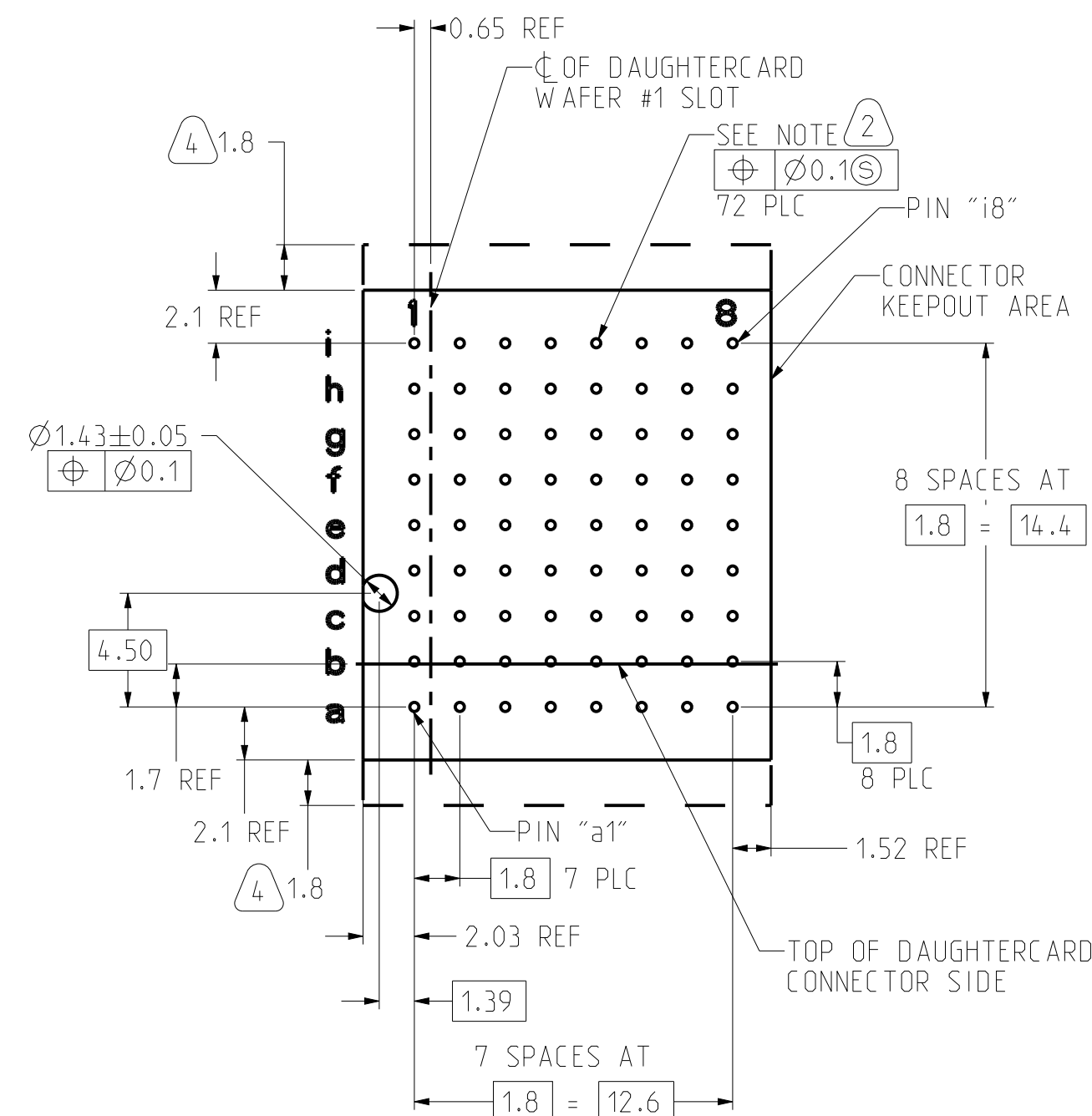
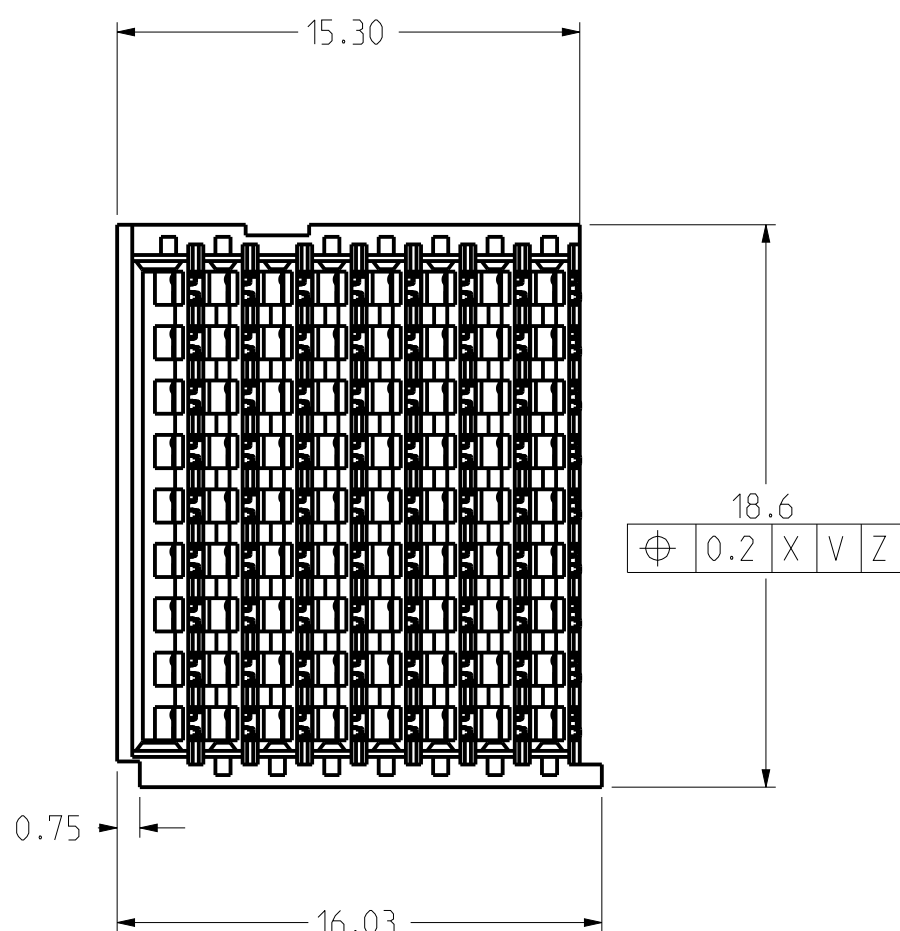
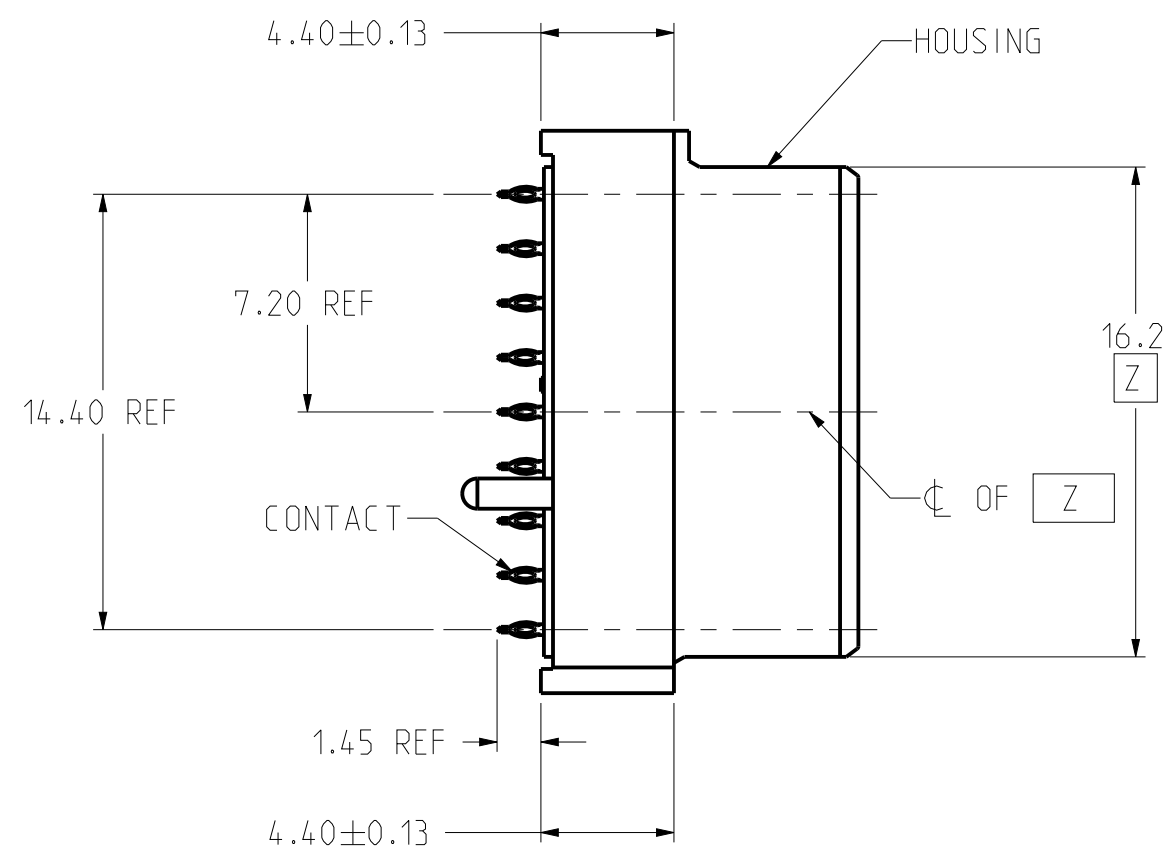
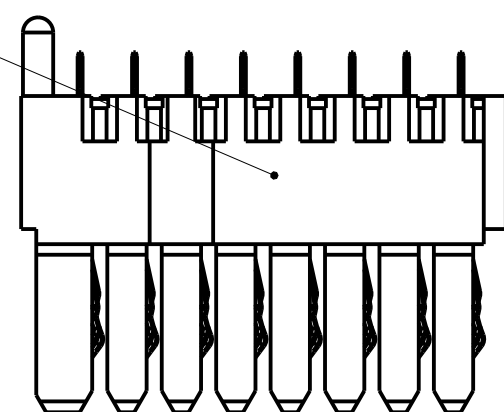

PC BOARD LAYOUT  
(CONNECTOR SIDE)  
SCALE 4/1  
TABLE 1

PLATING THICKNESS AND MATERIAL BY PART NUMBER			
PART NUMBER	GOLD IN CONTACT AREA	COMPLIANT	NICKEL OVERALL
RVPX-JE208EM1	50 μ-INCH MIN	50 μ-INCH MIN TIN	50 μ-INCH MIN
RVPX-JE208EM2	50 μ-INCH MIN	50 μ-INCH MIN TIN-LEAD	50 μ-INCH MIN
RVPX-JE208EC1	30 μ-INCH MIN	50 μ-INCH MIN TIN	50 μ-INCH MIN
RVPX-JE208EC2	30 μ-INCH MIN	50 μ-INCH MIN TIN-LEAD	50 μ-INCH MIN

PART MARKING AS FOLLOWS  
'AAO PART NUMBER' (SEE TABLE 1)  
'WORK ORDER NUMBER AS LOT NUMBER'

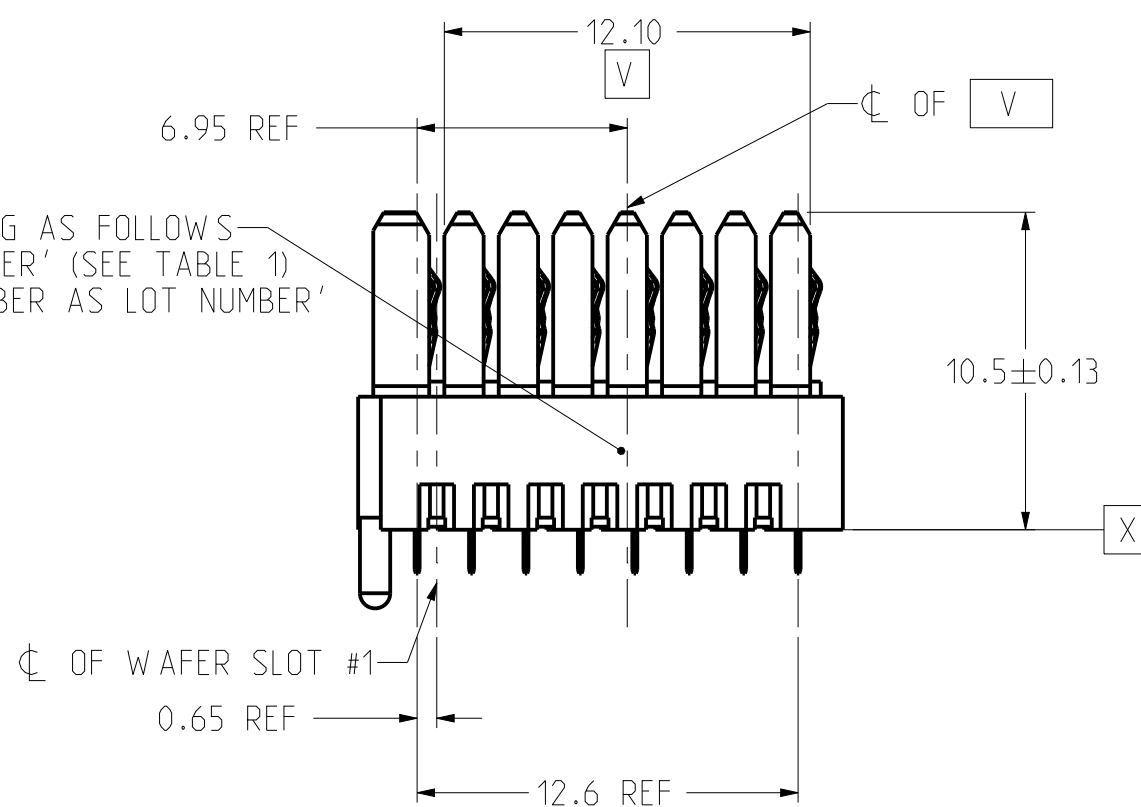

- 4 ADDITIONAL CONNECTOR-SIDE KEEPOUT AREA REQUIRED IF CONNECTOR-SIDE EXTRACTION TOOL IS TO BE USED.
- 3 SEE TABLE 1 FOR PART NUMBER AND FINISHES
- 2 PTH CALLOUT TYPICAL HOLE  
Ø0.43-.47 DRILL  
Ø0.36 ±.05 FINISH HOLE  
Ø0.75 PAD
- 1 HOUSING: GLASS FILLED LCP, UL94 - V0  
CONTACT: CU ALLOY

NOTES:

THE USE OF THIS DOCUMENT IS UNLIMITED. HOWEVER, DOCUMENTS REFERENCED HEREON MAY CONTAIN LIMITED RIGHTS DATA.

PRO/ENGINEER INFORMATION  
Pro/e Model Used:  
RVPX-JE208EXX.ASSEM  
Drawing Name:  
RVPX-JE208EXX

UNLESS OTHERWISE SPECIFIED  
SPECIFICATIONS  
MATERIAL SPEC.  
N/A  
PROCESS SPEC.  
9-3895  
9-3856-5

POS	QTY	PART NUMBER	DESCRIPTION	NOTE
APPROVALS				
PREPARED BY	S.LANGELIER	DATE	17-DEC-19	
ENGINEER IN CHARGE	S.LANGELIER			
DESIGN MANAGER	G.PECK			
DESIGN ACTIVITY GROUP	BOARD LEVEL			
THIRD ANGLE PROJECTION				
PARTS LIST				
AMPHENOL CORPORATION 40-60 DELAWARE AVENUE SIDNEY, N.Y. 13858				
CONNECTOR ASSEMBLY, BACKPLANE VERTICAL RECEPTACLE, 8 POS, END RVPX EVO 2				
SIZE	CAGE CODE	DOCUMENT NO.	REV.	
C	77820	RVPX-JE208EXX	A	
SCALE: 4/1	REF. RVPX-J08EXX	SHEET 1 OF 2		

RVPX-JE208EXX SHEET 1 OF 2 REV. A

RVPX-JE208EXX SHEET 1 OF 2 REV. A

# REAR TRANSITION MODULE APPLICATION

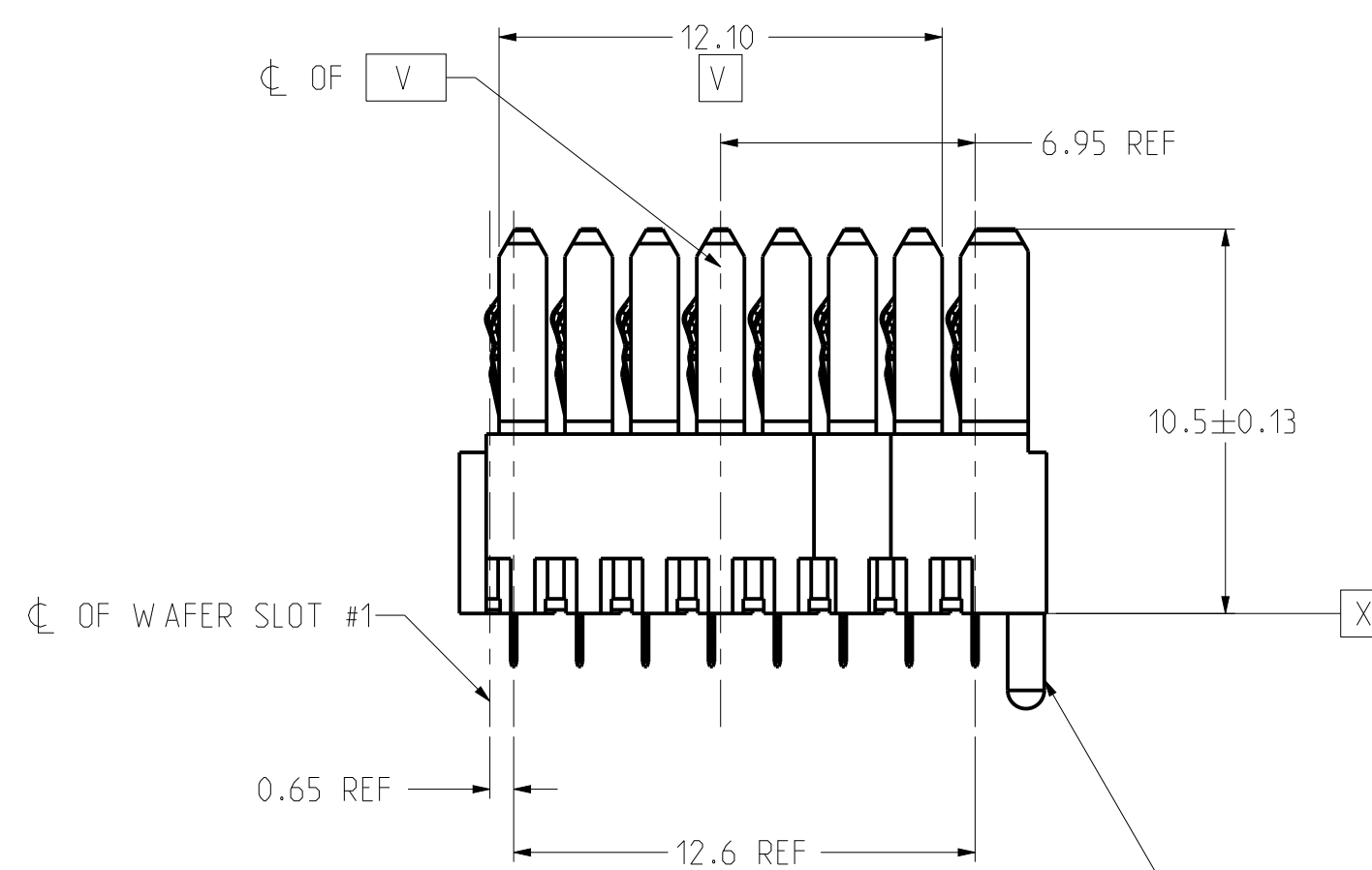
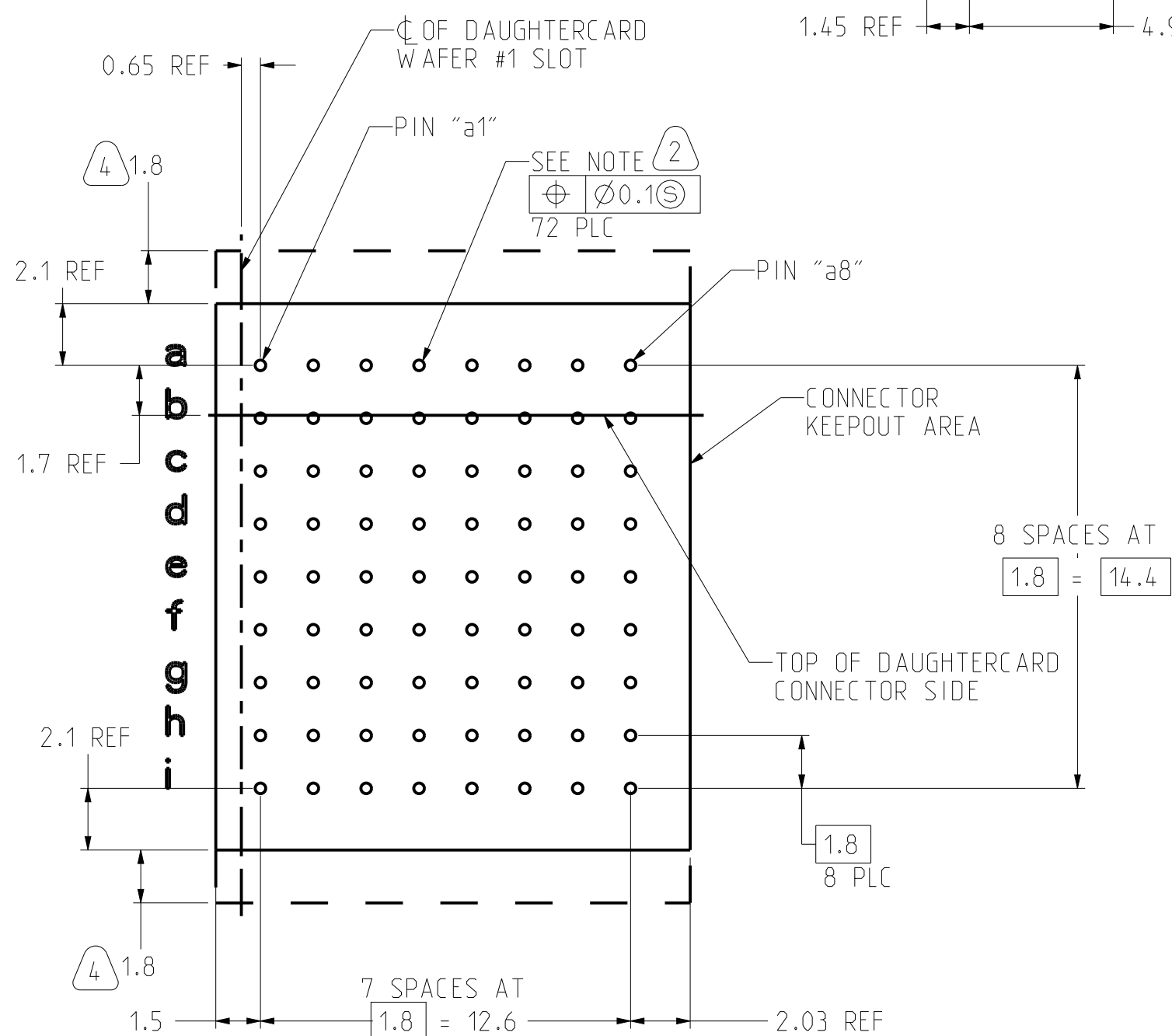
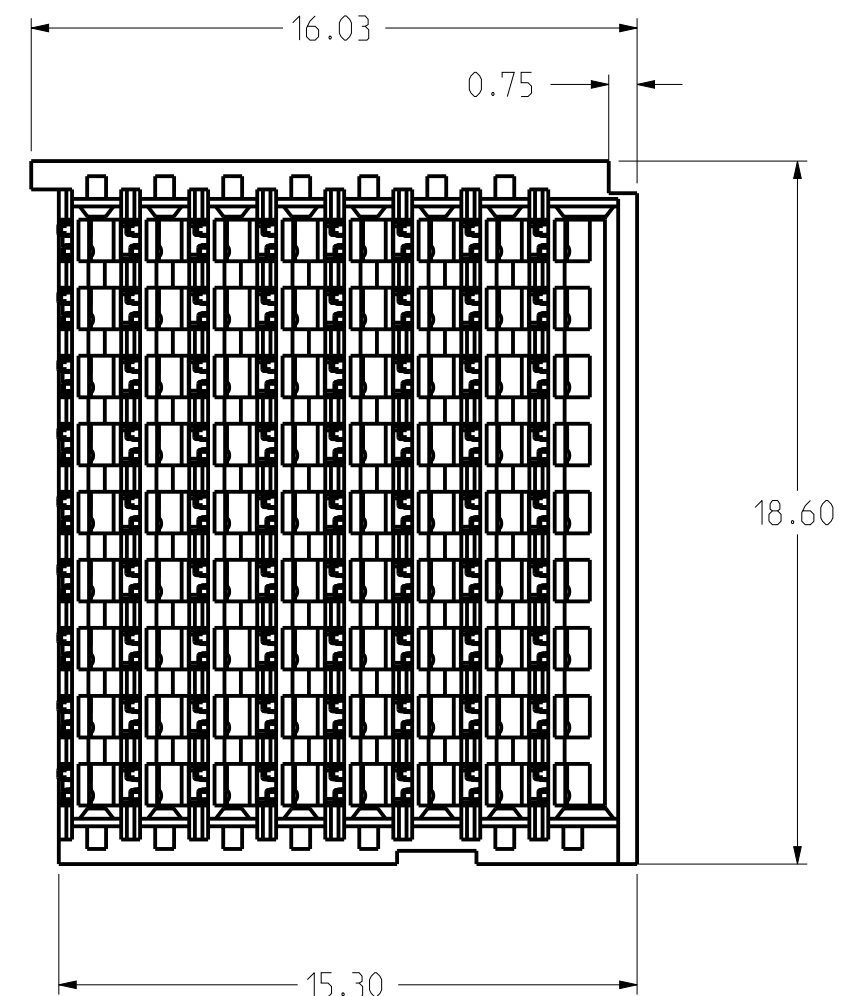
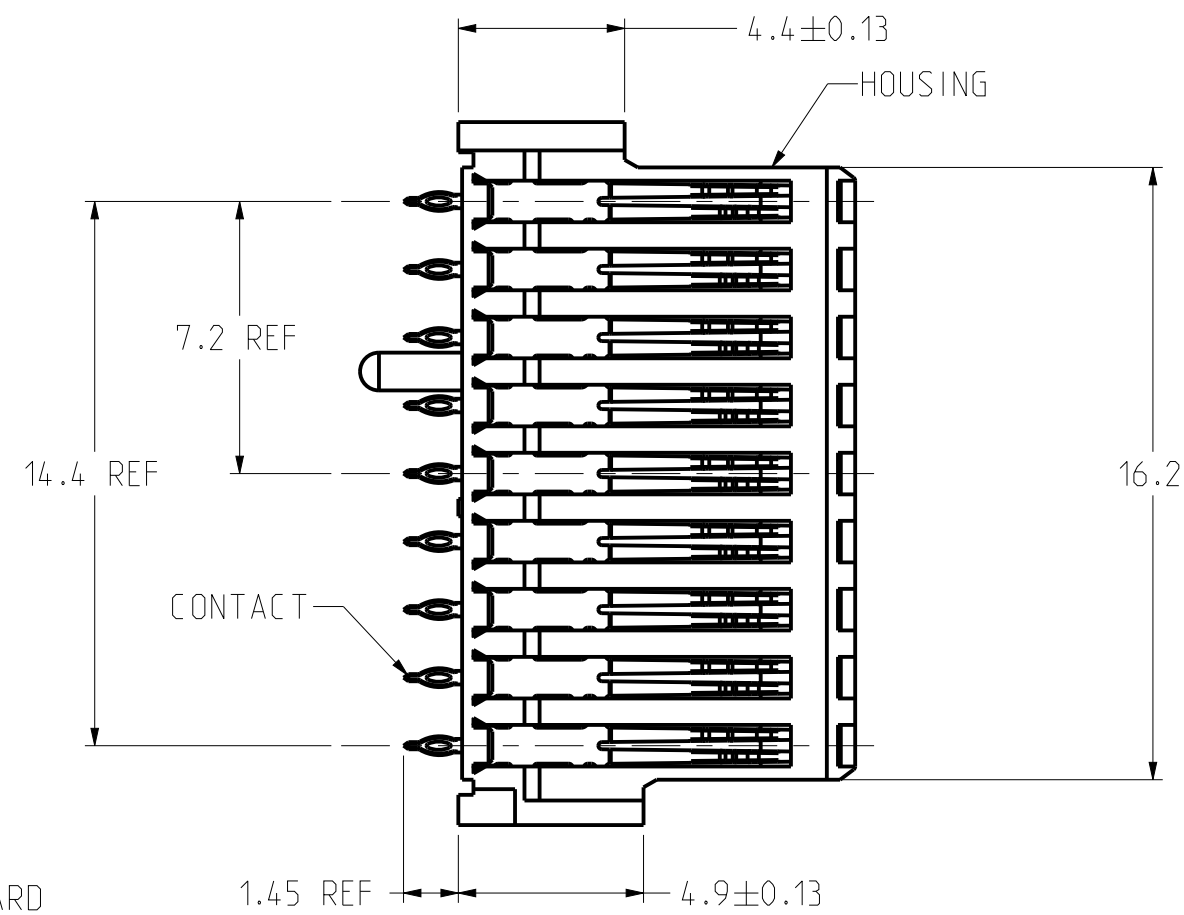

PLASTIC ALIGNMENT PIN MUST BE REMOVED FLUSH TO HOUSING BODY PRIOR TO INSERTION INTO RTM LAYOUT

RVPX-JE208EXX SHEET 2 OF 2 REV. A

**NOTES:**

THE USE OF THIS DOCUMENT IS UNLIMITED. HOWEVER, DOCUMENTS REFERENCED HEREON MAY CONTAIN LIMITED RIGHTS DATA.

RELEASED / Jan. 14 2020, 2:35:52 PM

DOCUMENT NO. RVPX-JE208EXX SHEET 2 OF 2 REV. A

SIZE <b>C</b>	CAGE CODE <b>77820</b>	DOCUMENT NO. <b>RVPX-JE208EXX</b>	REV. <b>A</b>
SCALE: 4/1		REF: RVPX-J08EXX	SHEET 2 OF 2

RVPX-JE208EXX SHEET 2 OF 2 REV. A

## X-ON Electronics

Largest Supplier of Electrical and Electronic Components

*Click to view similar products for [High Speed/Modular Connectors](#) category:*

*Click to view products by [Amphenol](#) manufacturer:*

Other Similar products are found below :

[650827-1](#) [74040-1346](#) [1410191-1](#) [1410337-1](#) [1410368-3](#) [1410367-3](#) [1410971-4](#) [1467833-1](#) [2000877-1](#) [2000878-1](#) [2041314-1](#) [2065387-1](#)  
[2187307-1](#) [163P](#) [1934290-1](#) [2000875-1](#) [2065799-1](#) [2065917-1](#) [2102736-2](#) [FSR-40](#) [2169868-2](#) [22354-8](#) [437-5040-000](#) [039-0246-000](#)  
[0740618502](#) [0761601016](#) [73774-1000](#) [030-2415-003/100 PK](#) [030-7380-004](#) [030-2494-001](#) [532939-1](#) [5532901-3](#) [3-1469268-7](#) [UMK-SE](#)  
[11,25-1](#) [74748-102LF](#) [10041743-101LF](#) [10066670-100002LF](#) [1-533915-1](#) [249-4515-000](#) [7-1469373-3](#) [DL2-2J/S](#) [2000713-8](#) [2000713-7](#)  
[10124313-101LF](#) [1410189-2](#) [3011-21](#) [EBTF-4-10-2.0-S-RA-1](#) [430305-001](#) [4395800100](#) [8140115](#)