

REV. A		SHEET 1 OF 2		DOCUMENT NO. RVPX-P08PXX	
REVISIONS M					
LTR	DESCRIPTION			DATE	
A	INITIAL RELEASE			25-MAY-18	

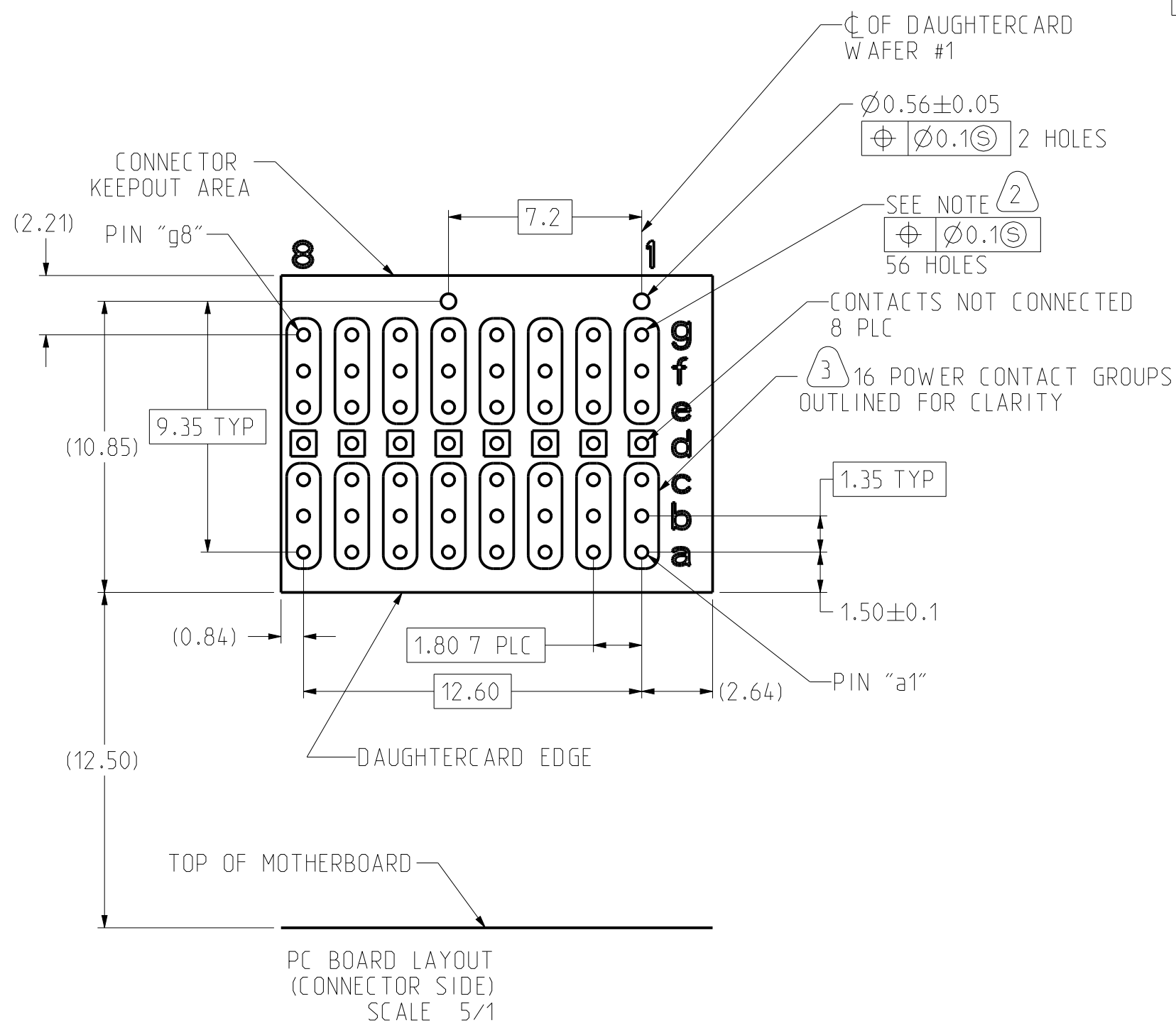
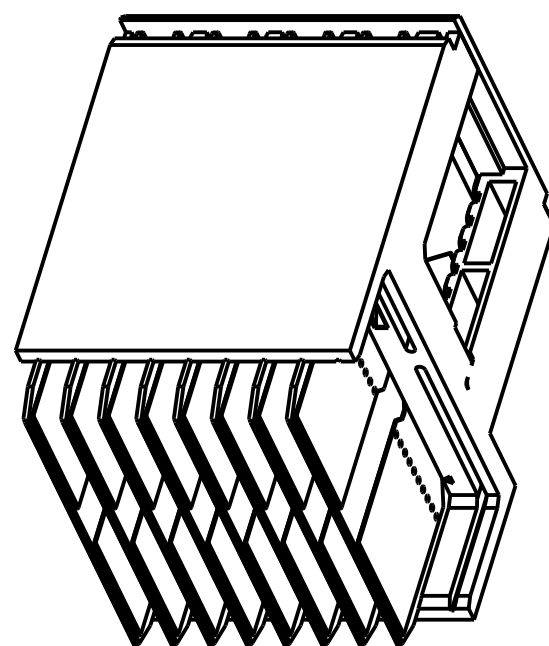

TABLE 1
INTERCONNECTIONS WITH BACKPLANE
CONNECTOR RVPX-J08EXX

TYPICAL INTERCONNECTIONS FOR COLUMN (WAFER): 1, 2, 3, 4, 5, 6, 7, 8		
CONTACT USAGE	DAUGHTERCARD CONNECTOR PIN	BACKPLANE CONNECTOR PIN
POWER	ax, bx, cx	ax, bx, cx, dx
POWER	ex, fx, gx	fx, gx, hx, ix
NOT CONNECTED	dx	ex

NOTE: "x" DESIGNATES THE COLUMN NUMBER

TABLE 2

PLATING THICKNESS AND MATERIAL BY PART NUMBER			
PART NUMBER	GOLD IN CONTACT AREA	COMPLIANT	NICKEL OVERALL
RVPX-P08PM1	50 μ-INCH MIN	50 μ-INCH MIN TIN	50 μ-INCH MIN
RVPX-P08PM2	50 μ-INCH MIN	50 μ-INCH MIN TIN-LEAD	50 μ-INCH MIN
RVPX-P08PC1	30 μ-INCH MIN	50 μ-INCH MIN TIN	50 μ-INCH MIN
RVPX-P08PC2	30 μ-INCH MIN	50 μ-INCH MIN TIN-LEAD	50 μ-INCH MIN

- 4 SEE TABLE 2 FOR PART NUMBER AND FINISHES
- 3 SEE TABLE 1 FOR INTERCONNECTIONS TO BACKPLANE CONNECTOR
- 2 PTH CALLOUT TYPICAL HOLE
Ø0.53-.57 DRILL
Ø0.46 ±.05 FINISH HOLE
Ø0.92 PAD
- 1 HOUSING: GLASS FILLED LCP, UL94 - V0
CONTACT: Cu ALLOY
POST: STAINLESS STEEL, PASSIVATED

THE USE OF THIS DOCUMENT IS UNLIMITED. HOWEVER, DOCUMENTS REFERENCED HEREON MAY CONTAIN LIMITED RIGHTS DATA.

RELEASED / Apr. 30 2019, 12:39:10 PM

DOCUMENT NO. RVPX-P08PXX

SHEET 1 OF 2

REV. A

N/A

NEXT ASSEMBLY

PRO/ENGINEER INFORMATION

Pro/e Model Used:
P1233-426-0008-001.ATCS-1.PART
Drawing Name:
RVPX-P08PXX

UNLESS OTHERWISE SPECIFIED	SPECIFICATIONS	POS	QTY	PART NUMBER	DESCRIPTION	NOTE
LINEAR DIMENSIONS ARE IN MILLIMETERS TOLERANCES: .XXXX = ±. - ANGLES= ±1° .XXX = ±. - .XX = ±.13 .X = ±.5 DIM. & TOL. PER ASME Y14.5M; DRM PER MIL-DTL-31000; OTHER Amphenol Stds. PER 9-3800 LEGENDS: =FLAG NOTE CALL OUT REFERENCE ONLY	MATERIAL SPEC. N/A	APPROVALS		DATE	PARTS LIST	
	PROCESS SPEC. 9-3895 9-3856-5	PREPARED BY S. LANGELIER	ENGINEER IN CHARGE S. LANGELIER	DESIGN MANAGER E. HICKEY	25-MAY-18	AMPHENOL CORPORATION 40-60 DELAWARE AVENUE SIDNEY, N.Y. 13856 RIGHT-ANGLE PLUG ASSEMBLY HALF LEFT END, RVPX DAUGHTERCARD CONNECTOR, VITA 46
		THIRD ANGLE PROJECTION			SIZE C CAGE CODE 77820 SCALE: 5.0	DOCUMENT NO. RVPX-P08PXX REF. RVPX-P08VXX SHEET 1 OF 2

DOCUMENT NO. RVPX-P08PXX

SHEET 1 OF 2

REV. A

C

B

A

FORMAT: C-0-L-E-1

Eng. PDM Information For Reference Only

REVISION A

DOCUMENT NO. RVPX-P08PXX

REV. A

RVPX-P08PXX

SHEET 2 OF 2

REV. A

C

B

A

4 PAD CONTACT AREA: TYP

DAUGHTERCARD EDGE

HOUSING

WAFER #1

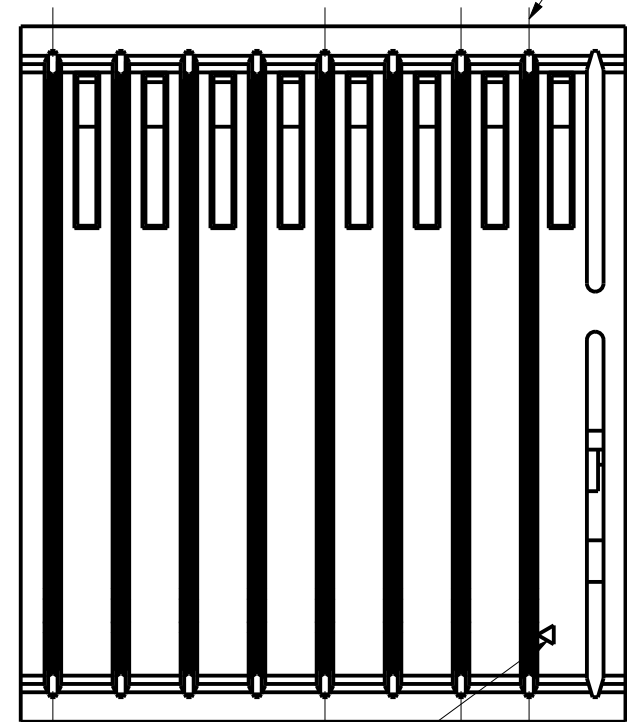

POSITION a1 1.80 REF 7 PLC 5.40 REF 12.60 REF

18.40 ± 0.1

11.81 ± 0.2

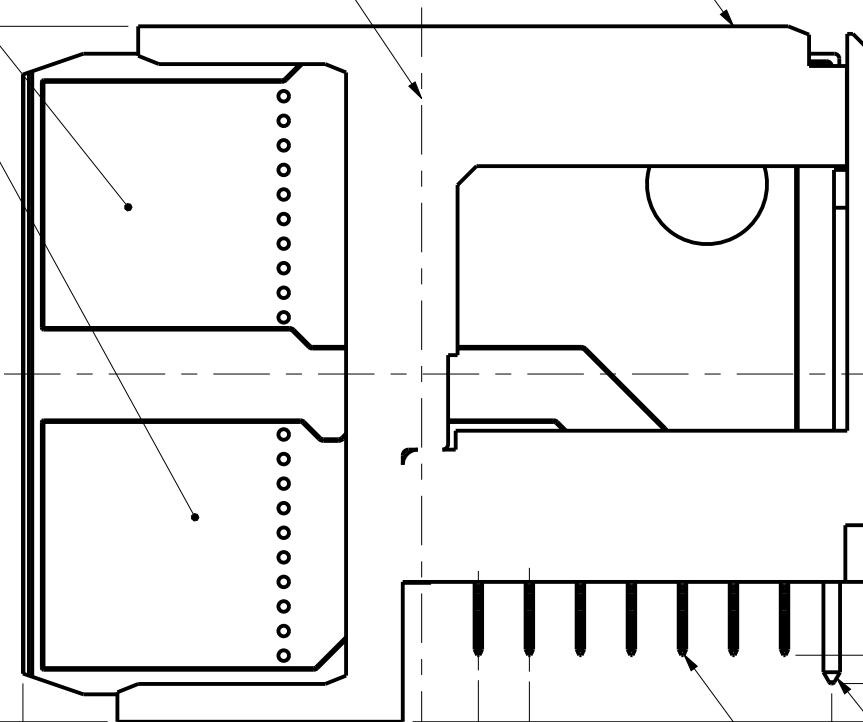

5.50 REF

1.94 TYP 2.69 ± 0.1 2 PLC 3.70 ± 0.1

1.35 REF 6 PLC

1.50 REF

10.00 ± .13

10.85 REF

10.50 ± .13

SEE NOTE 1 POST

SEE NOTE 4 P.C.B TAIL CONTACT

PART MARKING AS FOLLOWS AMPHENOL 77820 'AAO PART NUMBER' (SEE TABLE 1) 'DATE CODE' 'WORK ORDER NUMBER AS LOT NUMBER'

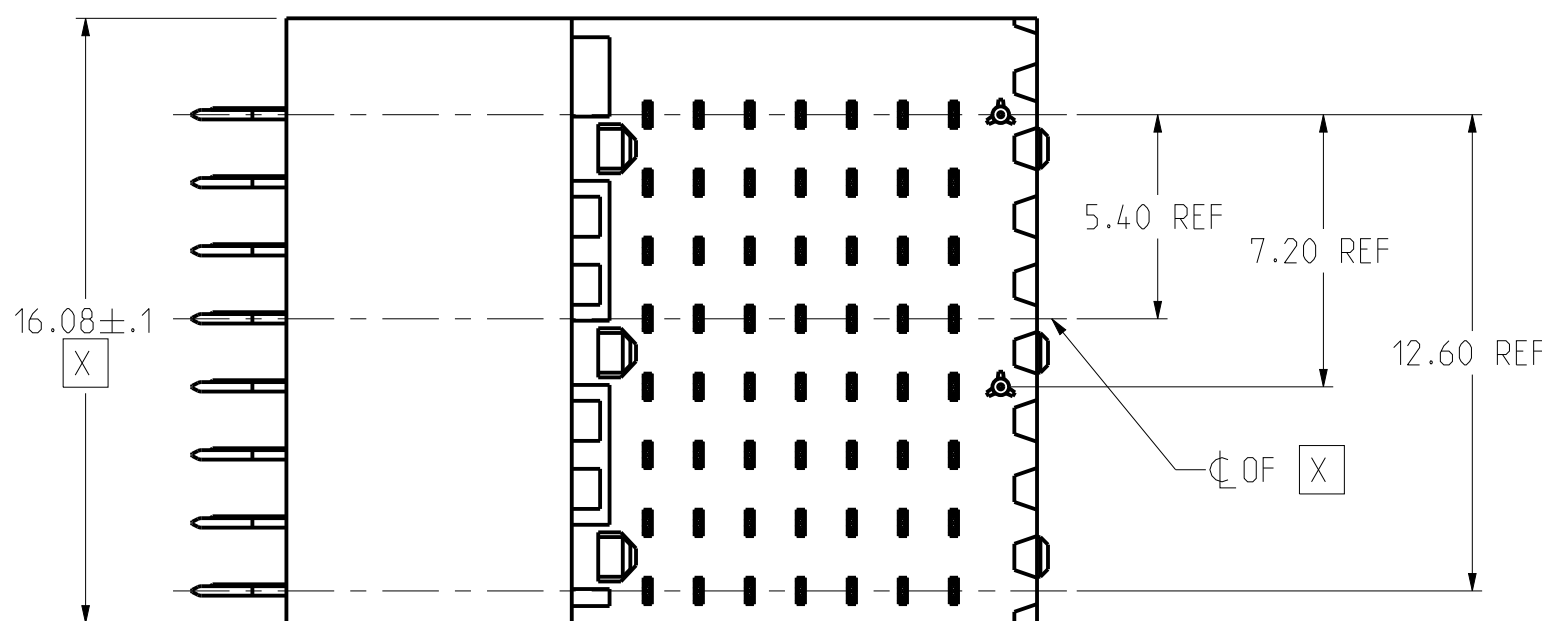
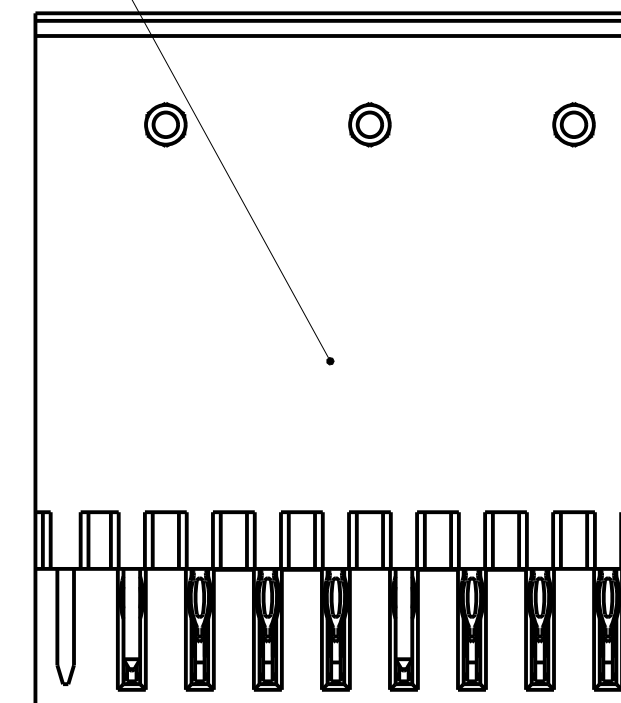

16.08 ± .1

5.40 REF

7.20 REF

12.60 REF

Ø OF X

NOTES: SEE SHEET 1

THE USE OF THIS DOCUMENT IS UNLIMITED. HOWEVER, DOCUMENTS REFERENCED HEREON MAY CONTAIN LIMITED RIGHTS DATA.

RELEASED / Apr. 30 2019, 12:39:10 PM

RVPX-P08PXX

SHEET 2 OF 2

REV. A

SIZE C	CAGE CODE 77820	DOCUMENT NO. RVPX-P08PXX	REV. A
SCALE: 5.0		REF: RVPX-P08VXX	SHEET 2 OF 2

VERSION 0

REVISION A

Eng PDM Information For Reference Only

REV. A

SHEET 2 OF 2

RVPX-P08PXX

X-ON Electronics

Largest Supplier of Electrical and Electronic Components

Click to view similar products for [High Speed/Modular Connectors](#) category:

Click to view products by [Amphenol](#) manufacturer:

Other Similar products are found below :

[650827-1](#) [74040-1346](#) [1410191-1](#) [1410337-1](#) [1410368-3](#) [1410367-3](#) [1410971-4](#) [1467833-1](#) [2000877-1](#) [2000878-1](#) [2041314-1](#) [2065387-1](#)
[2187307-1](#) [163P](#) [1934290-1](#) [2000875-1](#) [2065799-1](#) [2065917-1](#) [2102736-2](#) [FSR-40](#) [2169868-2](#) [22354-8](#) [437-5040-000](#) [039-0246-000](#)
[0740618502](#) [0761601016](#) [73774-1000](#) [030-2415-003/100 PK](#) [030-7380-004](#) [030-2494-001](#) [532939-1](#) [5532901-3](#) [3-1469268-7](#) [UMK-SE](#)
[11,25-1](#) [74748-102LF](#) [10041743-101LF](#) [10066670-100002LF](#) [1-533915-1](#) [249-4515-000](#) [7-1469373-3](#) [DL2-2J/S](#) [2000713-8](#) [2000713-7](#)
[10124313-101LF](#) [1410189-2](#) [3011-21](#) [EBTF-4-10-2.0-S-RA-1](#) [430305-001](#) [4395800100](#) [8140115](#)