

| REVISIONS | | | | | |
|-----------|-----|------------------------|----------|-----|-------|
| REV | ECO | DESCRIPTION | DATE | BY | APPR |
| B1 | - | RELEASE NEW DWG FORMAT | 06/16/14 | TOD | TOMMY |
| B2 | - | UPDTAED SPECIFICATION | 09/14/15 | TOD | TOMMY |

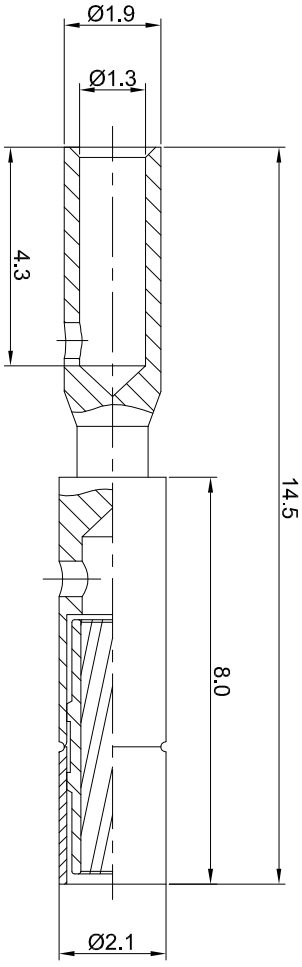

- NOTES: UNLESS OTHERWISE SPECIFIED
- MATERIAL: COPPER ALLOY; GOLD PLATED
 - SPECIFICATIONS:
 - 2.1 RATED CURRENT: 10 AMPS
 - 2.2 CONTACT RESISTANCE: <5 milliohm
 - 2.3 AVAILABLE WIRE RANGE: 18AWG~22AWG
 - 2.4 ROHS COMPLIANT
 - ALL DIMENSIONS ARE FOR REFERENCE USE ONLY.

| | | | | |
|--|-----------------------|--|------------------------------------|-----------|
| QUANTITY | SEE PART NUMBER CHART | PART NUMBER | DESCRIPTION | ITEM |
| MATERIALS LIST | | | | |
| UNLESS OTHERWISE SPECIFIED 1) All dimensions are in millimeters. 2) Tolerances are as follows: 1 Pl. DEC 20.00 2 Pl. DEC 20.00 3 Pl. DEC 20.08 3) Note reference = | | DRAWN: tod | DATE: 09/14/15 | |
| MATERIAL SPECIFICATIONS: | | CHECKED: | ENGINEER: | APPROVAL: |
| PROCESS SPECIFICATIONS: | | CUSTOMER: | Socket Contact, 20#, Chmp 18-22AWG | |
| NEXT ASSY: | | THE DRAWING IS SUPPLIED FOR INFORMATION ONLY. DESIGN FEATURES, SPECIFICATIONS AND PERFORMANCE DATA ARE SUBJECT TO CHANGE WITHOUT NOTICE. THE APPLICABLE SPECIFICATION NO RIGHTS OF REPRODUCTION ARE IMPLIED. ALL MANUFACTURING VARIATIONS. | | |
| SCALE: NONE | | SIZE: B TYPE: C- DWG NO: SC000013 SHEET 1 OF 1 | | |

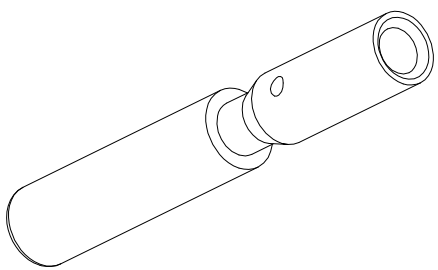

Socket Contact, 20#, Chmp 18-22AWG

DWG NO: SC000013

REV: B2

SH: 1

OF: 1

TITLE: Socket Contact, 20#, Chmp 18-22AWG

Amphenol

Sine Systems - www.amphenol-sine.com
44724 Moley Drive
Clifton Township, MI 48036

X-ON Electronics

Largest Supplier of Electrical and Electronic Components

Click to view similar products for [Circular Metric Connectors](#) category:

Click to view products by [Amphenol](#) manufacturer:

Other Similar products are found below :

[600X518037X](#) [6STD15PCR99B70A](#) [8R4000A16M020](#) [8R5000A16M005](#) [1200910002](#) [1203580030](#) [1200910008](#) [1200910011](#) [1300140094](#)
[130203-0054](#) [1300140026](#) [1300150099](#) [1-3637-600-5205](#) [1612618](#) [21036836414](#) [8R4006A16M010](#) [1R3006A20M005](#) [41-40011](#) [42-00006](#)
[42-01015](#) [4-22279-4](#) [4-22281-1](#) [4-22284-9](#) [43-00113](#) [43-01203](#) [41-40013](#) [42-00008](#) [43-00343](#) [43-01026](#) [43-01162](#) [43-01173](#) [43-10000](#)
[XS3P-M421-2](#) [600X518050X](#) [8R5006A16M020](#) [8R5006A16M005](#) [8R4000A16M010](#) [6-22279-3](#) [1605332](#) [N03FA03144](#) [1300140077](#) [43-](#)
[16213](#) [43-01338](#) [XS2RD4265](#) [XS2R-D426-1](#) [XS8A-0441](#) [859RD04-103R004](#) [860RD04-113R004](#) [860RD04-213R004](#) [1-213245-2](#)