

# PRODUCT DATA DRAWING

| REVISION HISTORY |                |       |          |
|------------------|----------------|-------|----------|
| REV              | DESCRIPTION    | DATE  | APPROVED |
| A                | REV. DCN 32955 | 04/05 | STW      |
| B                | DCN 36749      | 05/09 | PJS      |

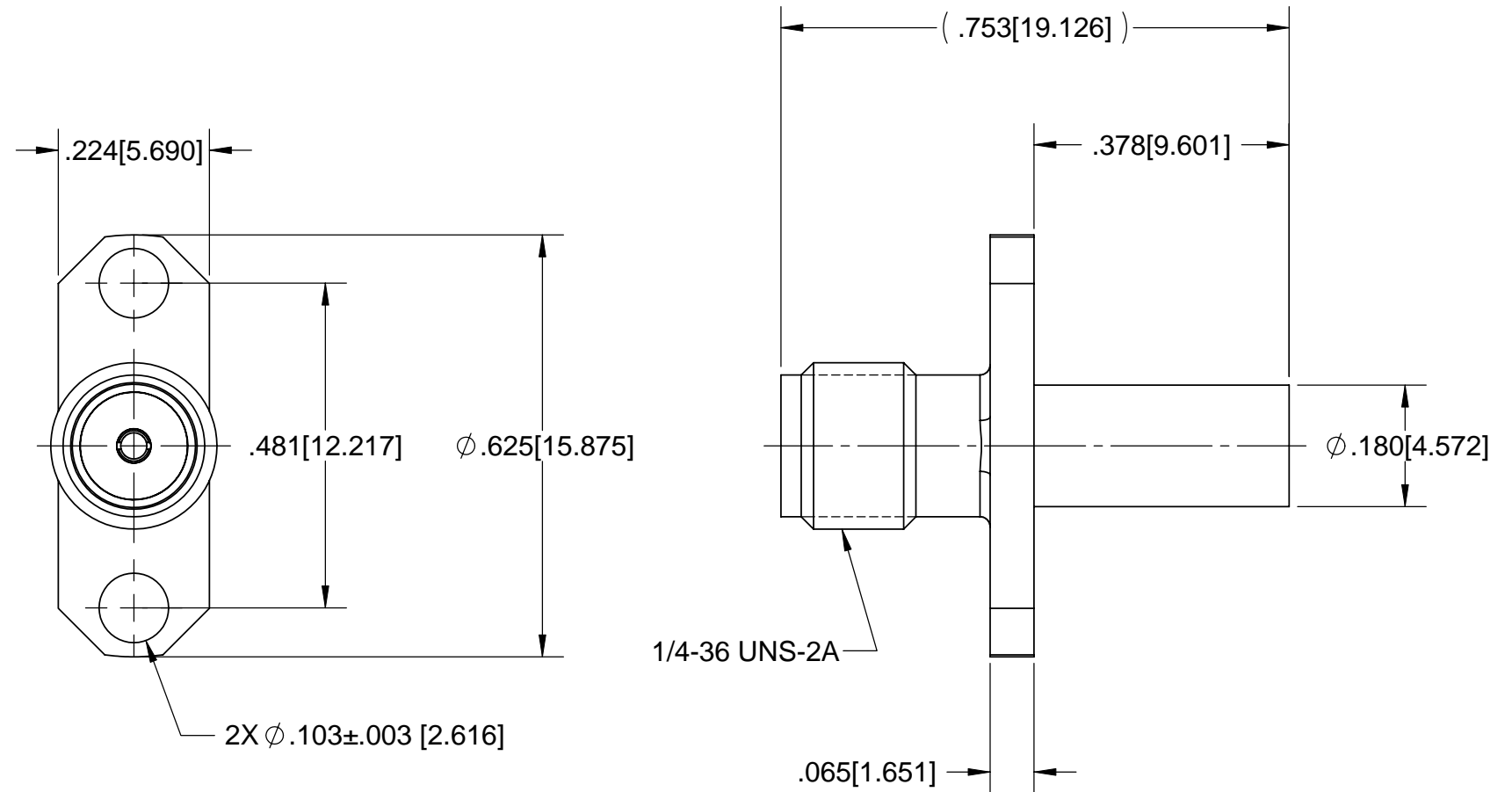

## MATERIAL:

**BODY:** STAINLESS STEEL PER AMS-5640, ALLOY UNS S30300, TYPE I

**CONTACT:** BERYLLIUM COPPER PER ASTM B196, ALLOY UNS C17300, TD04

**INSULATOR:** PTFE PER ASTM D1710, TYPE I, GRADE 1, CLASS B

## FINISH

**BODY:** PASSIVATED PER AMS 2700

**CONTACT:** GOLD PER ASTM B488, TYPE II, CODE C, CLASS 1.27; OVER NICKEL PER AMS-QQ-N-290, CLASS 1, .000050" MIN.

## PERFORMANCE

**IMPEDANCE:** 50 OHMS

**FREQ. RANGE:** DC TO 18.0 GHz

**VSWR:** 1.35:1 MAX. DC TO 18.0GHz

**INSERTION LOSS:** .10 X SQRT(F IN GHz)

**D.W.V.:** 1000 VRMS

**INSUL. RES.:** 10,000 MEGOHMS MIN.

|  |  |  |   |
|--|--|--|---|
| MATERIAL: SEE NOTES  | DIMENSIONS ARE IN INCHES TOLERANCES:<br>FRACTIONAL: ±1/64 ANGULAR: X° ±1'0"<br>X*X' ±15' | UNLESS OTHERWISE SPECIFIED<br>1) ALL DIMENSIONS ARE IN INCHES (MILLIMETERS)<br>2) ALL DIMENSIONS ARE AFTER PLATING.<br>3) BREAK CORNERS & EDGES .005 R. MAX.<br>4) CHAM. 1ST & LAST THREADS.<br>5) SURFACE ROUGHNESS 63√ MIL-STD-10.<br>6) DIA.'S ON COMMON CENTERS TO BE CONCENTRIC WITHIN .005 T.I.R.<br>7) REMOVE ALL BURRS | <b>SV Microwave, Inc.</b><br>2400 Centrepark West Drive, Suite 100<br>West Palm Beach, FL 33409<br>TITLE: <b>SMA JACK TO BMZ JACK ADAPTER</b> |
| FINISH: SEE NOTES  | DECIMAL: .X ±.030<br>.XX ±.010<br>.XXX ±.005   | INTERPRET DIMENSIONS AND TOLERANCES PER ASME Y14.5M - 1994   |   |
| SURFACE AREA: N/A  | THIRD ANGLE PROJECTION   | DRAWN: MGT 04/13/05  | SIZE: <b>B</b> CAGE CODE: <b>95077</b> DWG. NO.: <b>SF1189-6001</b>   |
| <b>PROPRIETARY</b><br>THE INFORMATION CONTAINED IN THIS DRAWING IS THE SOLE PROPERTY OF SV MICROWAVE, INC. ANY REPRODUCTION IN PART OR AS A WHOLE WITHOUT THE WRITTEN PERMISSION OF SV MICROWAVE, INC IS PROHIBITED. |  | CHECKED: STW 05/22/96  | SCALE: 4:1  |
|  |  | APPROVED: STW 05/22/96   | SHEET 1 OF 1  |
|  |  | E.M. SIMULATION:   |   |

## X-ON Electronics

Largest Supplier of Electrical and Electronic Components

*Click to view similar products for [RF Adapters - Between Series category](#):*

*Click to view products by [Amphenol manufacturer](#):*

Other Similar products are found below :

[5945-9503-000](#) [MCX/F-SMA/M](#) [R192417010](#) [ADBJ20-E1-BJ379](#) [ADM2](#) [ADPL75-A1-PL75](#) [242191](#) [9317505](#) [AD130](#) [ADBJ20-E1-PL74](#)  
[ADBJ77-E1-UPL20](#) [ADRMF370](#) [242190](#) [242215](#) [242228](#) [R125680000W](#) [R192430000](#) [UAD95](#) [1057367-1](#) [8311505](#) [R114704000](#)  
[R451034500](#) [R451030500](#) [R451543000](#) [HDVDPN](#) [ADBJ20-K1-PL20](#) [R451570000](#) [R192419000](#) [R451034000](#) [J9](#) [J3WE-5](#) [R451032500](#)  
[242201RP](#) [17K132-K00S5](#) [03K719-S22S3](#) [AD-RSMAF-RTNC](#) [53K156-K00N5](#) [53K160-KIMN1](#) [02K119-K00E3](#) [29S132-K01N5](#) [53S156-](#)  
[K00N5](#) [02S119-S00E3](#) [28K132-K00N5](#) [02S109-K00S3](#) [27-8200TP](#) [242235](#) [ADBJ20-E1-BJ89](#) [ADP-SMAF-MMCXM](#) [000-2900](#) [321-102-](#)  
[003 \(SMA-50/2-H155/W1.03 AU\)](#)