

# PRODUCT DATA DRAWING

REVISION HISTORY			
REV	DESCRIPTION	DATE	APPROVED
G	DCN 32901	03/05	BRT

**MATERIAL**

BODY  
FERRULE,  
COUPLING NUT: STAINLESS STEEL PER AMS-5640,  
ALLOY UNS S30300, TYPE 303. COND. A

PRESS CAP: STAINLESS STEEL PER ASTM A240,  
ALLOY UNS S30400, TYPE 304

LOCK RING: BERYLLIUM COPPER PER ASTM B196,  
COND. TD04, ALLOY UNS C17300

CONTACT: BRASS PER ASTM B16, ALLOY UNS C36000

INSULATOR: PTFE PER ASTM D1710, TYPE I, GRADE 1,  
CLASS B

GASKET: SILICONE RUBBER PER A-A-59588,  
CLASS 2B, GRADE 50/60

**FINISH**

BODY  
FERRULE,  
CONTACT,  
PRESS CAP: GOLD PER ASTM B488, TYPE II,  
CODE C, CLASS 0.76; OVER NICKEL  
PER AMS-QQ-N-290, CLASS 1, .00010 MIN.

COUPLING NUT: PASSIVATED PER AMS-QQ-P-35, TYPE II

**PERFORMANCE**

IMPEDANCE: 50 OHMS  
FREQ. RANGE: DC TO 12.4 GHz  
D.W.V.: 1000 VRMS  
INSUL. RES.: 5000 MEGOHMS

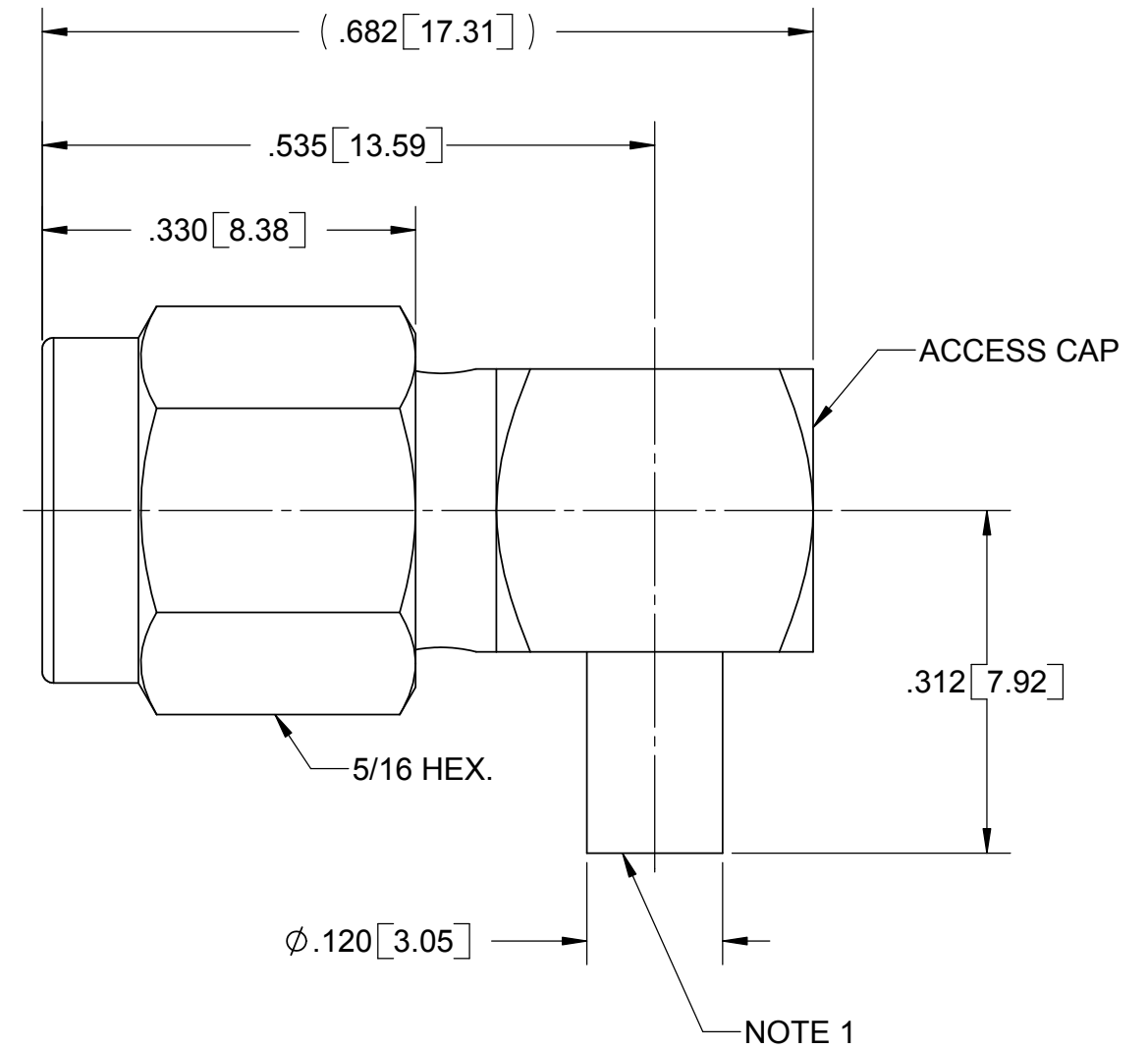

**NOTES:**  
1. ACCEPTS .085 SEMI-RIGID CABLE AND T-FLEX 405 CABLE

MATERIAL: SEE ABOVE	DIMENSIONS ARE IN INCHES TOLERANCES: FRACTIONAL: ±1/64 ANGULAR: X° ±1'0" X°X' ±15'	UNLESS OTHERWISE SPECIFIED 1) ALL DIMENSIONS ARE IN INCHES[MILLIMETERS] 2) ALL DIMENSIONS ARE AFTER PLATING. 3) BREAK CORNERS & EDGES .005 R. MAX. 4) CHAM. 1ST & LAST THREADS. 5) SURFACE ROUGHNESS 63 √ MIL-STD-10. 6) DIA.'S ON COMMON CENTERS TO BE CONCENTRIC WITHIN .005 T.I.R. 7) REMOVE ALL BURRS	<b>SV Microwave, Inc.</b> 2400 Centrepark West Drive, Suite 100 West Palm Beach, FL 33409
FINISH: SEE ABOVE	DECIMAL: X ±.030 .XX ±.010 .XXX ±.005	INTERPRET DIMENSIONS AND TOLERANCES PER ASME Y14.5M - 1994	TITLE: SMA PLUG RIGHT ANGLE SOLDER-ON
SURFACE AREA: N/A	<b>THIRD ANGLE PROJECTION</b>	DRAWN: BRT 04/04/97	SIZE: B CAGE CODE: 95077 DWG. NO.: SF2915-6001
<b>PROPRIETARY</b> THE INFORMATION CONTAINED IN THIS DRAWING IS THE SOLE PROPERTY OF SV MICROWAVE, INC. ANY REPRODUCTION IN PART OR AS A WHOLE WITHOUT THE WRITTEN PERMISSION OF SV MICROWAVE, INC IS PROHIBITED.		CHECKED: CT 10/15/85 APPROVED: ND 10/16/85	SCALE: 6:1 SHEET 1 OF 1

## X-ON Electronics

Largest Supplier of Electrical and Electronic Components

*Click to view similar products for [RF Connectors / Coaxial Connectors](#) category:*

*Click to view products by [Amphenol](#) manufacturer:*

Other Similar products are found below :

[8915-1511-000](#) [89674-0827](#) [6001-7071-019](#) [6002-7051-003](#) [6002-7551-202](#) [6059674-1](#) [619550-1](#) [630059-000](#) [M39030/3-01N](#) [M3933/25-36N](#) [6500-7071-046](#) [6769](#) [CX050L2AQ](#) [7002-1542-011](#) [7004-1512-000](#) [7009-1511-004](#) [7010-1511-000](#) [7029-1511-060](#) [7101-1541-010](#) [7101-1571-002](#) [7105-1521-002](#) [7145-1521-002](#) [7203-1571-003](#) [7209-1511-011](#) [7210-1511-015](#) [7210-1511-019](#) [73137-5015](#) [73216-2241](#) [7325-1512-000](#) [73404-2300](#) [7405-1521-005](#) [7405-1521-802](#) [7406-1521-005](#) [8527](#) [8547](#) [FS11V](#) [8808-1511-001](#) [9049-9513-000](#) [9074-9513-000](#) [9101-9573-002](#) [910A205F](#) [9130-9573-002](#) [PL11SC-026](#) [PL375-33](#) [PL40-5](#) [PL71-9](#) [PL74C-221](#) [PL75MC-217](#) [PL803-7](#) [980-8666-005](#)