

REV.	ECN NO.	DATE	SIGN	DESCRIPTION
B	LEN1350134	2013/05/08	Lu Di	Change Logo
C	LE31730076	2017/03/02	Ruru	Change Outer Mold Design

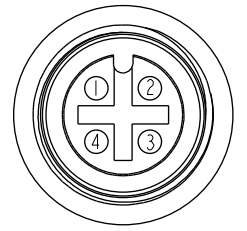

Conn. 2
Pin Assignments
Front View

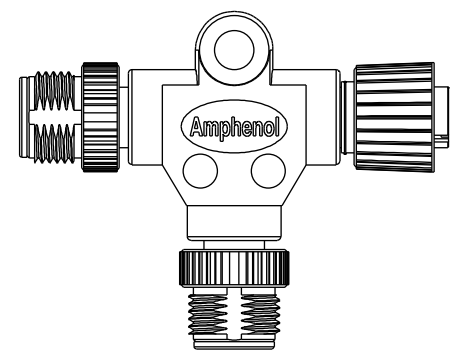
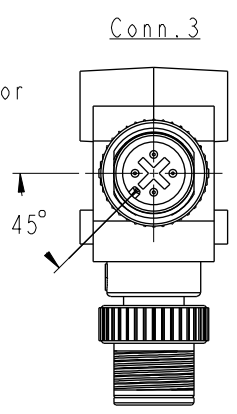
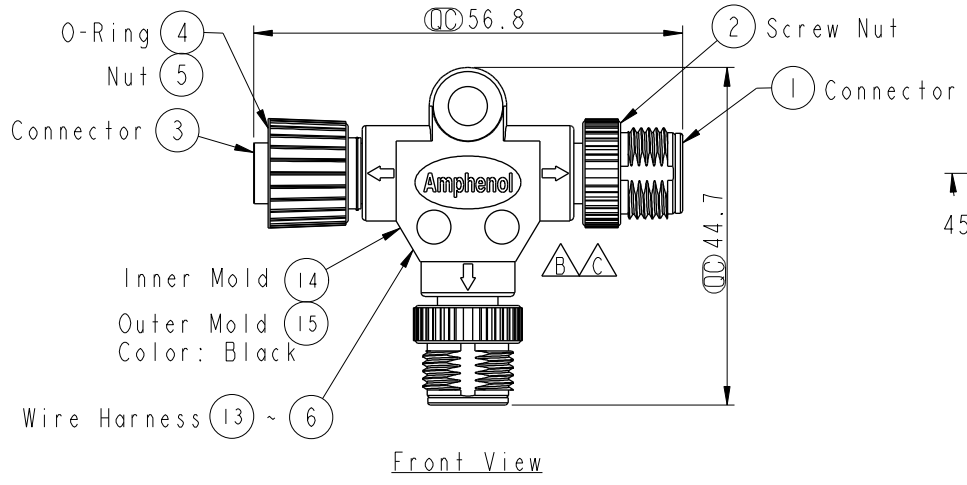
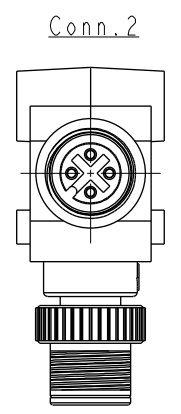
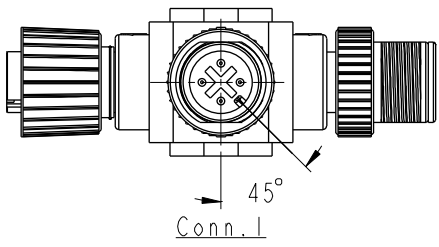

45°
Conn. 1

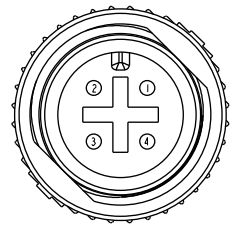

Conn. 1&3
Pin Assignments
Front View

Green 綠	4	4	4
Blue 藍	3	3	3
White 白	2	2	2
Black 黑	1	1	1
Wire Color	Conn. 1	Conn. 2	Conn. 3

Pin Out



- Note:
- * \varnothing Important Dimension
 - * Waterproof Rate: IP68
IM Depth Of Water In 24 Hours
 - * Connector: PU, Black
 - * O- Ring: Viton, Green
 - * Nut: Zinc Alloy, Nickel Plated
 - * Pin: Copper Alloy, Gold Plated
 - * Wire Harness: UL1007 24AWG 8PCS

UNIT:mm	
TOLERANCE	± 0.5mm

TITLE M12 Conn T Adaptor Screw MFM Conn MFM Pin			
SCALE 1:1	SIZE A4	SHEET 1 OF 1	
REV. C	WC-REV. A.1	\varnothing : Inspection item	

Amphenol LTW
安費諾亮泰企業股份有限公司

ITEM NO. SS-040404-MFM-TS001	DRAWN BY Ruru	DATE 2017-03-02
DWG NO. SS-040404-MFM-TS001	CHECKED BY Rita	DATE 2017-03-02
CUSTOMER ALTW	APPROVED BY Max	DATE 2017-03-02

THIS DOCUMENT IS SUBJECT TO CHANGE WITHOUT NOTICE. IT IS CONFIDENTIAL AND A PROPERTY OF Amphenol LTW. DISCLOSURE TO THIRD PARTY HAS TO BE AUTHORIZED BY Amphenol LTW.

X-ON Electronics

Largest Supplier of Electrical and Electronic Components

Click to view similar products for [Circular Metric Connectors](#) category:

Click to view products by [Amphenol](#) manufacturer:

Other Similar products are found below :

[600X518037X](#) [6STD15PCR99B70A](#) [8R4000A16M020](#) [8R5000A16M005](#) [1200910002](#) [1203580030](#) [1200910008](#) [1200910011](#) [1300140094](#)
[130203-0054](#) [1300140026](#) [1300150099](#) [1-3637-600-5205](#) [1612618](#) [21036836414](#) [8R4006A16M010](#) [1R3006A20M005](#) [41-40011](#) [42-00006](#)
[42-01015](#) [4-22279-4](#) [4-22281-1](#) [4-22284-9](#) [43-00113](#) [43-01203](#) [41-40013](#) [42-00008](#) [43-00343](#) [43-01026](#) [43-01162](#) [43-01173](#) [43-10000](#)
[XS3P-M421-2](#) [600X518050X](#) [8R5006A16M020](#) [8R5006A16M005](#) [8R4000A16M010](#) [6-22279-3](#) [1605332](#) [N03FA03144](#) [1300140077](#) [43-](#)
[16213](#) [43-01338](#) [XS2RD4265](#) [XS2R-D426-1](#) [XS8A-0441](#) [859RD04-103R004](#) [860RD04-113R004](#) [860RD04-213R004](#) [1-213245-2](#)