

T812

X

XX

XX

XX

CEU

IDC Socket
2.54mm pitch



Housing Color

0: Grey
1: Black

No of Positions

06= 6 Positions
:
:
64=64 Positions

Plating Options

A1: Flash Gold
A2: 15u" selective gold
A3: 30u" selective Gold
SN: Tin

Variation Code

00: w/o Strain Relief
01: With Strain Relief

Fixed index

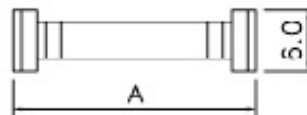
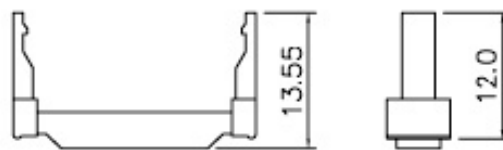
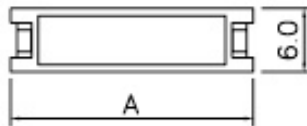
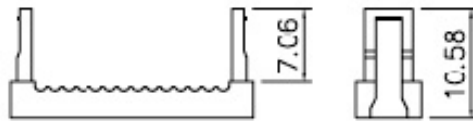
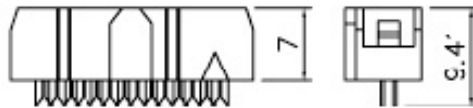
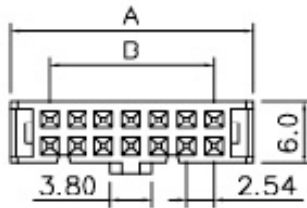

Strain Relief

position	A	B
6	12.16	5.08
8	14.78	7.62
10	17.27	10.16
12	19.85	12.70
14	22.40	15.24
16	24.94	17.78
20	30.00	22.86
24	35.10	27.94
26	37.59	30.48
30	42.66	35.56
34	47.80	40.64
36	50.29	43.18
40	55.37	48.26
44	60.56	53.34
50	68.18	60.96
56	75.74	68.58
60	80.80	73.66
62	83.35	76.20
64	85.90	78.74

General Specification

Materials and Finish :

Insulator: Glass-reinforce thermoplastic, UL 94V-0, PBT.
Contact : Phosphor Bronze, plated with full flash gold or selected gold in mating area; 100u" min. full tin on the termination area, with entire contact under-plated 50u" min. nickel.

Electrical :

Contact Resistance: 20 mΩ max. at 1A DC.
Insulation Resistance: 1000 MΩ min, at 500 VDC.
Dielectric Withstanding Voltage : 500 VAC/RMS 60Hz for one minute.
Current Rating : 3A per contact
Voltage Rating : 250VAC/RMS 60Hz

Envirement :

Operating Temperature:
-40degree C to +105 degree C

X-ON Electronics

Largest Supplier of Electrical and Electronic Components

Click to view similar products for [amphenol manufacturer](#):

Other Similar products are found below :

[JTPQ00RT-16-35P\(453\)](#) [CF-509621-29P](#) [BF8-1218-31SV-Y70](#) [TVP00RGW-23-6SA\(LC\)](#) [RNJ27CI1535P014](#) [10-553998-139](#) [10-507142-843](#) [GTS02R20-15P-025-116](#) [ACC02E28-51S-003-B30-LC](#) [TV06RL-13-35SD-LC](#) [TV06RL-13-35SD](#) [TV06RL-13-98SD-LC](#) [TV06RL-13-98SD](#) [TVP00RW-23-53AD](#) [100-007-213-002-001](#) [JT07RT-22-14PB-453](#) [10-037090-161](#) [10-541504-001](#) [10-580902-409](#) [TV97RW-9-9S\(S15\)](#) [TVPS00RGF-9-5P-LC](#) [TVPS00RGF-9-5PA-LC](#) [TV06RW-25-90AE](#) [97-3108B16S-5PW-417](#) [PT06J20-24SW](#) [97-3108B16S-4PY-417](#) [97-3108B16S-4PX-417](#) [97-3108B16S-5PY-417](#) [97-3108B16S-4PW-417](#) [CS-DSDMDB37MF-025](#) [97-3108B16S-5PZ-417](#) [TV06RW-25-46AE](#) [TVS07RF-21-16AA](#) [TVS07RF-21-39BA](#) [GTC02R32-17S-025-RDS](#) [GTC06-22-13SW](#) [BA-4116-50LD-Y103](#) [BACC63DB15-5PCH](#) [TVPS00RGF-23-6SC-LC](#) [GTC06-22-13SX-025-B30](#) [GTC06-22-13SW-025-B30](#) [GTC06-22-13SW-025-B30-LC](#) [GTC06-22-13SX-025-LC](#) [GTC06-22-13SY-025-B30-LC](#) [GTC06-22-13SY-025-LC](#) [97-3101A20-21P-958](#) [97-3106A18-3PX-958](#) [97-3106A18-3PY-958](#) [GTC06-36-7S-LC](#) [GTS08-36-22PZ-025-B30](#)