

DATA SHEET (Preliminary)

**RB521D3-30**

- ◇ Low current rectification
- ◇ Low forward voltage
- ◇ ROHS Compliant
- ◇ UL-94 V-0 / Green EMC

Device Marking Code	
<b>RB521D3-30</b>	<b>F</b>

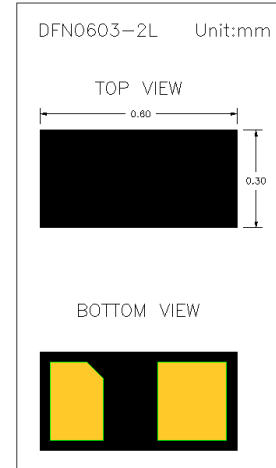
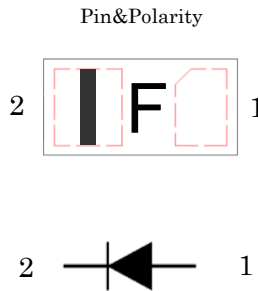

**Maximum Ratings (Ta = 25 °C)**

Symbol	Parameter	Value	Units
$P_D$	Power Dissipation	100	mW
$V_R$	Reverse Voltage	30	V
$I_{F(AV)}$	Average Forward Current	100	mA
$I_{FSM}$	Non-Repetitive Peak Forward Current *1	500	mA
$T_J$	Junction Temperature	125	°C
$T_{STG}$	Storage Temperature	-55 to +125	°C

\*1: 8.3ms Single Half Sine-Wave

**Electrical Characteristics (Ta = 25 °C unless otherwise noted)**

Symbol	Parameter	Conditions	Min	Typ	Max	Units
$I_R$	Reverse Leakage Current	$V_R=10V$	-	-	10	uA
		$V_R=30V$	-	-	50	
$V_F$	Forward Voltage	$I_F=10mA$	-	-	0.38	V
		$I_F=100mA$	-	0.46	0.53	
$V_R$	Reverse Voltage	$I_R=50uA$	30	-	-	V

### Typical Characteristics

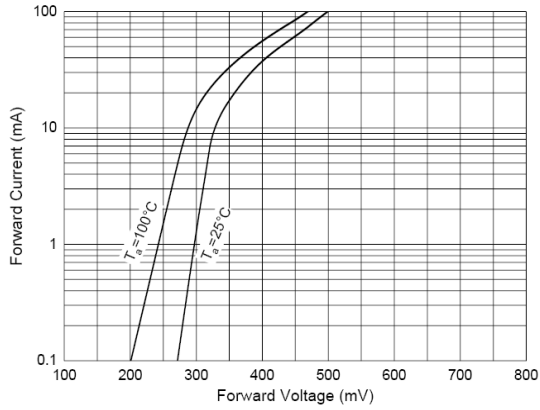

Forward Characteristics

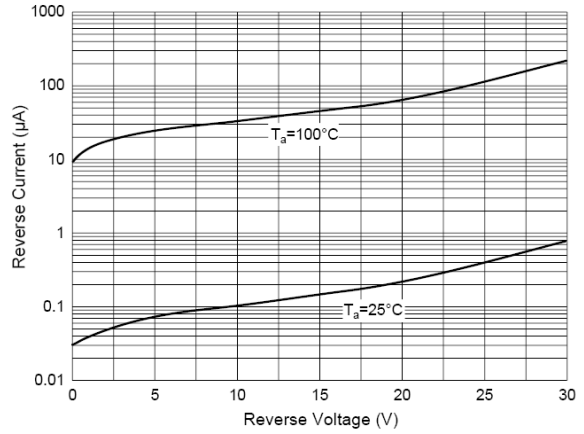

Reverse Characteristics

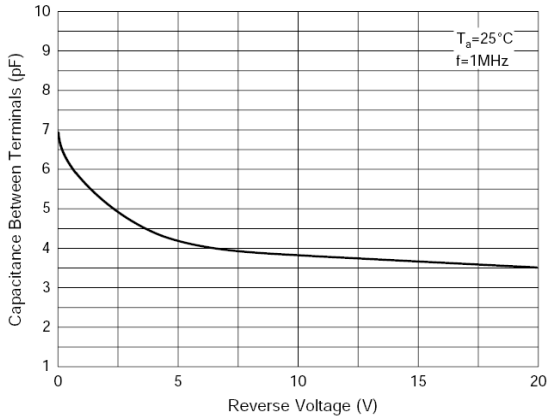

Capacitance Characteristics

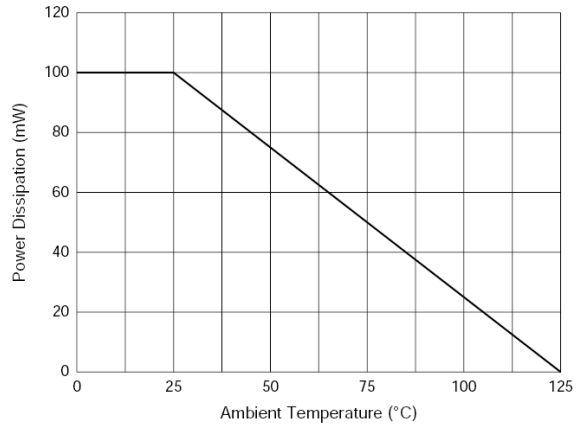

Power Derating Curve

### Ordering Information

Device	Package	Shipping	Tape wide	Emboss pitch	Tape specification	Notes
RB521D3-30	DFN0603-2L	Tape & Reel 15000pcs /7" Reel	8mm	4mm	Conductive	

#### Package outline : DFN0603-2L

Top view

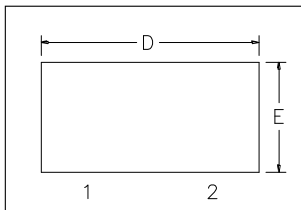

Bottom view

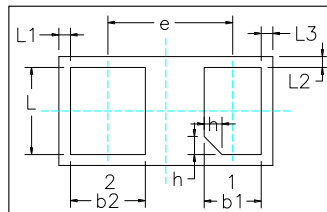

Side view

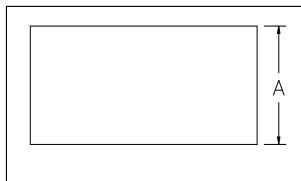

Soldering Pattern

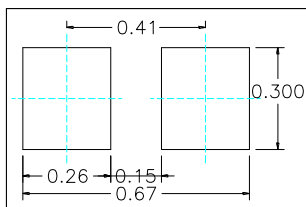

SYMBOL	MILLIMETER		
	MIN	NOM	MAX
A	0.28	0.30	0.32
b1	0.13	0.18	0.23
b2	0.14	0.19	0.24
D	0.55	0.60	0.65
e	0.350BSC		
L1	0.030BSC		
L2	0.025BSC		
L3	0.035BSC		
E	0.25	0.30	0.35
L	0.20	0.25	0.30
h	0.00	0.05	0.10

#### Notice:

1. Lead no need to do plating
2. Other Tolerance:  $\pm 0.05$
3. Dimensions are exclusive of Burrs, Mold Flash and Tie Bar extrusions
4. Unit: mm

## X-ON Electronics

Largest Supplier of Electrical and Electronic Components

*Click to view similar products for [Schottky Diodes & Rectifiers](#) category:*

*Click to view products by [amsem](#) manufacturer:*

Other Similar products are found below :

[MA4E2039](#) [MMBD301M3T5G](#) [RB160M-50TR](#) [D83C](#) [BAS16E6433HTMA1](#) [BAS 3010S-02LRH E6327](#) [BAT 54-02LRH E6327](#)  
[NRVBAF360T3G](#) [NSR05F40QNXT5G](#) [NTE555](#) [JANS1N6640](#) [SS3003CH-TL-E](#) [GA01SHT18](#) [CRS10I30A\(TE85L,QM](#) [MBRA140TRPBF](#)  
[MBRB30H30CT-1G](#) [BAT 15-04R E6152](#) [JANTX1N5712-1](#) [DMJ3940-000](#) [SB007-03C-TB-E](#) [NRVBB20100CTT4G](#) [NRVBM120LT1G](#)  
[NTSB30U100CT-1G](#) [CRG04\(T5L,TEMQ\)](#) [ACDBA1100LR-HF](#) [ACDBA1200-HF](#) [ACDBA240-HF](#) [ACDBA3100-HF](#) [CDBQC0530L-HF](#)  
[ACDBA260LR-HF](#) [ACDBA1100-HF](#) [10BQ015-M3/5BT](#) [NRVBM120ET1G](#) [VSSB410S-M3/5BT](#) [1N5819T-G](#) [PDS1040Q-13](#) [B160BQ-13-F](#)  
[SDM05U20CSP-7](#) [BAS 70-07 E6433](#) [B140S1F-7](#) [HSM560Je3/TR13](#) [DDB2265-000](#) [ZHCS506QTA](#) [HSM190Je3/TR13](#) [B330AF-13](#)  
[ACDBUC0230-HF](#) [SDM1U100S1F-7](#) [MBR10200CTF-G1](#) [CDLL5712](#) [DMF2822-000](#)