

### Features

- Zero Reverse Recovery Current
- Zero Forward Recovery Voltage
- Positive Temperature Coefficient on  $V_F$
- Temperature-independent Switching
- 175°C Operating Junction Temperature

$V_{RRM}$	=	1200	V
$I_F (T_C \leq 135^\circ\text{C})$	=	26	A**
$Q_C$	=	58	nC**

\*Per Leg, \*\*Per Device

### Benefits

- Replace Bipolar with Unipolar Device
- Reduction of Heat Sink Size
- Parallel Devices Without Thermal Runaway
- Essentially No Switching Losses

### Package

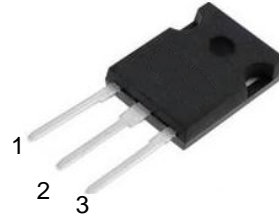

TO-247-3

### Applications

- Switch Mode Power Supplies
- Power Factor Correction
- Motor drive, PV Inverter, Wind Power Station

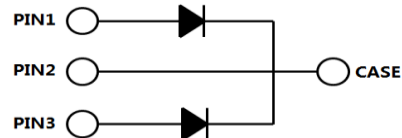

Part Number	Package	Marking
AS3D020120P2	TO-247-3	ASD20120P2

### Maximum Ratings

Symbol	Parameter	Value	Unit	Test Conditions	Note
V <sub>RRM</sub>	Repetitive Peak Reverse Voltage	1200	V	T <sub>C</sub> = 25°C	
V <sub>RSM</sub>	Surge Peak Reverse Voltage	1200	V	T <sub>C</sub> = 25°C	
V <sub>R</sub>	DC Blocking Voltage	1200	V	T <sub>C</sub> = 25°C	
I <sub>F</sub>	Forward Current (Per leg/Device)	30/60 13/26 10/20	A	T <sub>C</sub> ≤ 25°C T <sub>C</sub> ≤ 135°C T <sub>C</sub> ≤ 149°C	
I <sub>FSM</sub>	Non-Repetitive Forward Surge Current	95*	A	T <sub>C</sub> = 25°C, t <sub>p</sub> = 8.3ms, Half Sine Wave	
P <sub>tot</sub>	Power Dissipation (Per leg/Device)	150/ 300	W	T <sub>C</sub> = 25°C	Fig.3
T <sub>C</sub>	Maximum Case Temperature	149	°C		
T <sub>J</sub> , T <sub>STG</sub>	Operating Junction and Storage Temperature	-55 to 175	°C		
	TO-247 Mounting Torque	1	Nm	M3 Screw	

### Electrical Characteristics

Symbol	Parameter	Typ.	Max.	Unit	Test Conditions	Note
V <sub>F</sub>	Forward Voltage	1.55 2.2	1.8 2.5	V	I <sub>F</sub> = 10A, T <sub>J</sub> = 25°C I <sub>F</sub> = 10A, T <sub>J</sub> = 175°C	Fig.1
I <sub>R</sub>	Reverse Current	2 10	20 200	μA	V <sub>R</sub> = 1200V, T <sub>J</sub> = 25°C V <sub>R</sub> = 1200V, T <sub>J</sub> = 175°C	Fig.2
C	Total Capacitance	650 49 40	/	pF	V <sub>R</sub> = 0V, T <sub>J</sub> = 25°C, f = 1MHz V <sub>R</sub> = 400V, T <sub>J</sub> = 25°C, f = 1MHz V <sub>R</sub> = 800V, T <sub>J</sub> = 25°C, f = 1MHz	Fig.5
Q <sub>C</sub>	Total Capacitive Charge	29	/	nC	V <sub>R</sub> = 800V, I <sub>F</sub> = 10A di/dt = 200A/μs, T <sub>J</sub> = 25°C	Fig.4

### Thermal Characteristics

Symbol	Parameter	Typ.	Unit	Note
R <sub>θJC</sub>	Thermal Resistance from Junction to Case	1* 0.5**	°C/W	Fig.6
R <sub>θJA</sub>	Thermal Resistance from Junction to Ambient	80	°C/W	
T <sub>sold</sub>	Soldering Temperature	260	°C	

\*Per Leg, \*\*Per Device

## Typical Performance (Per Leg)

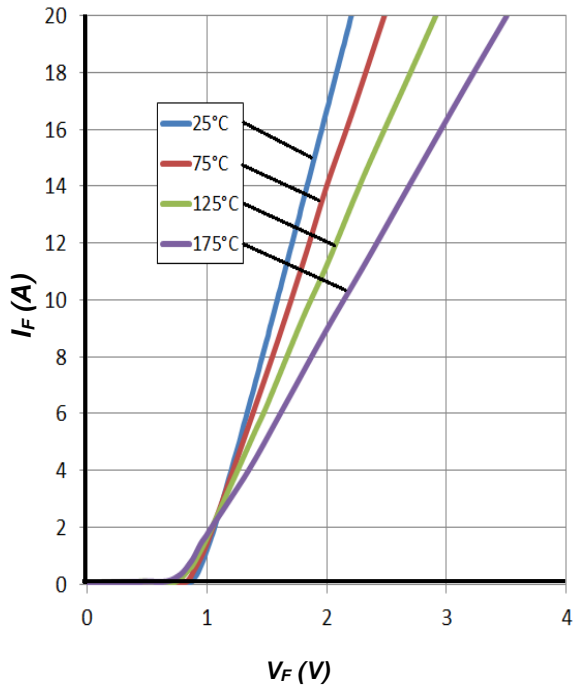

Figure 1. Forward Characteristics

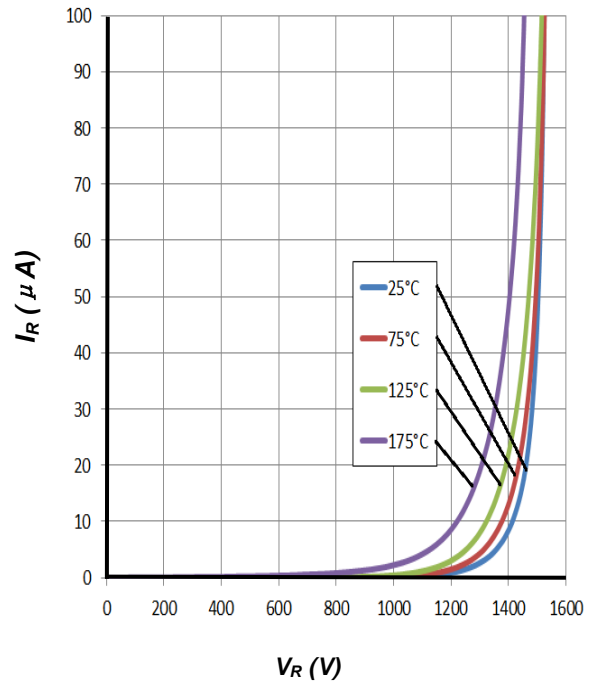

Figure 2. Reverse Characteristics

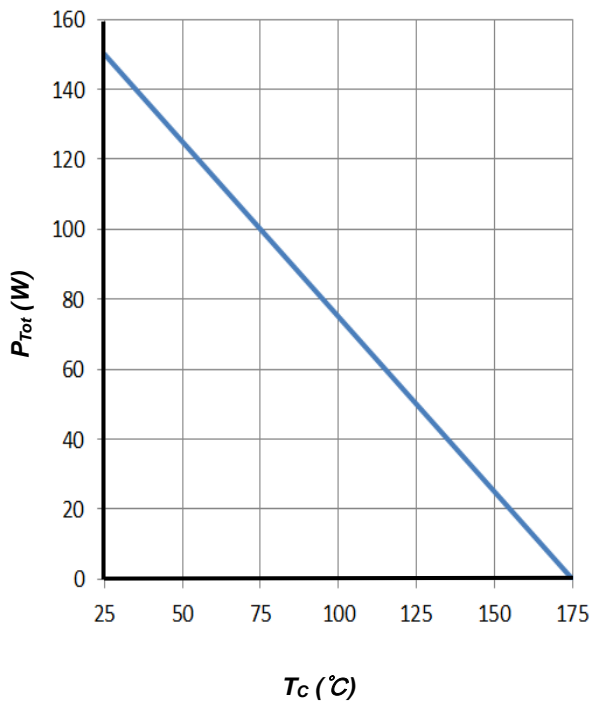

Figure 3. Power Derating

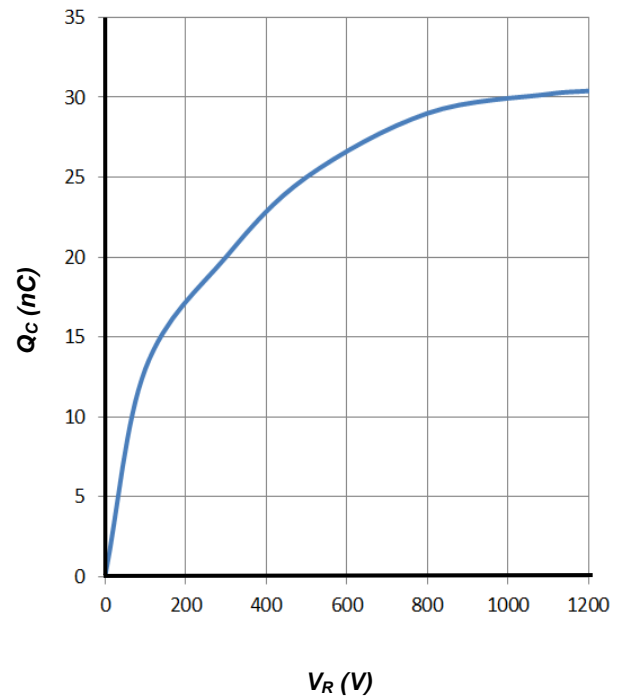

Figure 4. Total Capacitive Charge vs. Reverse Voltage

## Typical Performance (Per Leg)

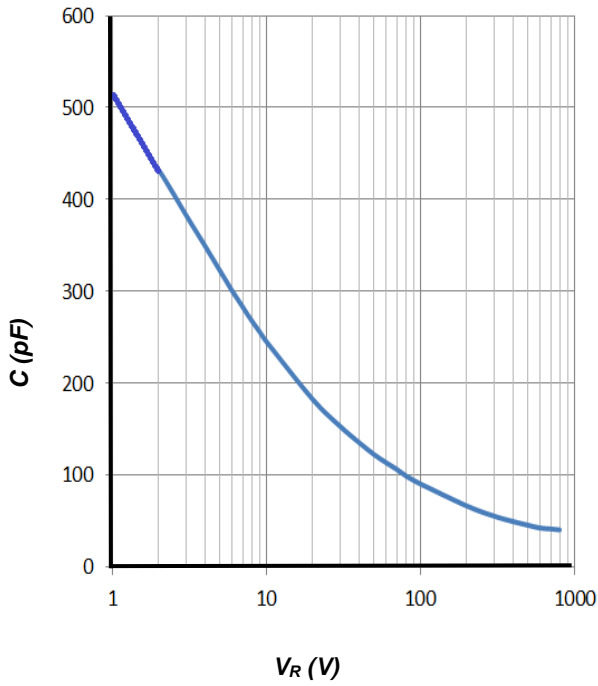

Figure 5. Total Capacitance vs. Reverse Voltage

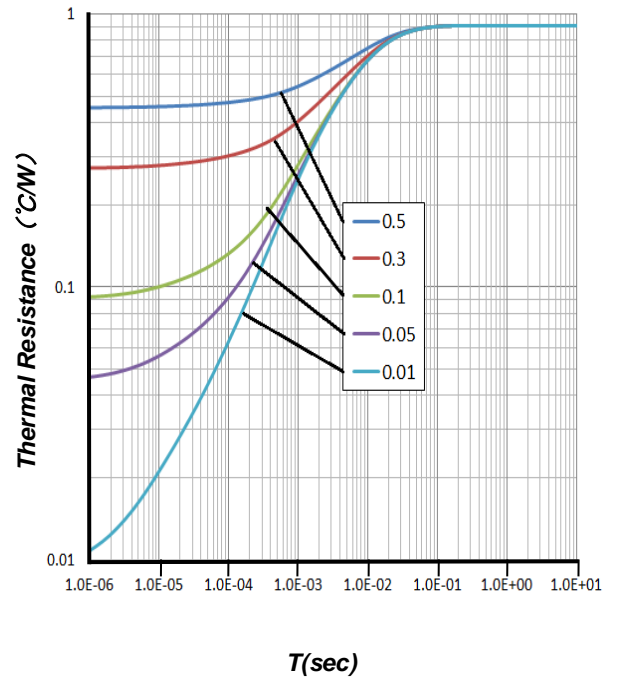
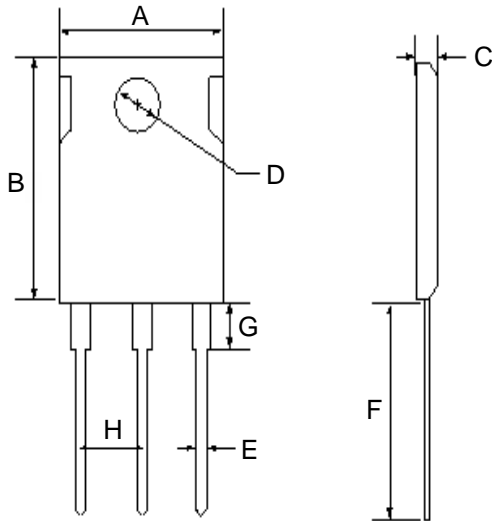

Figure 6. Transient Thermal Impedance

### Package Dimensions

Package TO-247-3



Symbol	Min. (mm)	Typ. (mm)	Max. (mm)
A	14.18	15.75	17.33
B	18.45	20.5	22.55
C	4.50	5.00	5.50
D	3.15	3.50	3.85
E	1.08	1.20	1.32
F	18.27	20.30	22.33
G	4.21	4.68	5.15
H	4.91	5.46	6.01

## X-ON Electronics

Largest Supplier of Electrical and Electronic Components

*Click to view similar products for [Schottky Diodes & Rectifiers](#) category:*

*Click to view products by [AnBon](#) manufacturer:*

Other Similar products are found below :

[MA4E2039](#) [MMBD301M3T5G](#) [HFA35HB60C](#) [RB160M-50TR](#) [D83C](#) [BAS16E6433HTMA1](#) [BAS 3010S-02LRH](#) [E6327](#) [BAT 54-02LRH](#)  
[E6327](#) [NRVBAF360T3G](#) [NSR05F40QNXT5G](#) [NTE555](#) [JANS1N6640](#) [SS3003CH-TL-E](#) [GA01SHT18](#) [CRS10I30A\(TE85L,QM](#)  
[MBRA140TRPBF](#) [MBRB30H30CT-1G](#) [BAT 15-04R](#) [E6152](#) [JANTX1N5712-1](#) [DMJ3940-000](#) [SB007-03C-TB-E](#) [NRVBB20100CTT4G](#)  
[NRVBM120LT1G](#) [NTSB30U100CT-1G](#) [CRG04\(T5L,TEMQ\)](#) [ACDBA1100LR-HF](#) [ACDBA1200-HF](#) [ACDBA240-HF](#) [ACDBA3100-HF](#)  
[CDBQC0530L-HF](#) [ACDBA260LR-HF](#) [ACDBA1100-HF](#) [10BQ015-M3/5BT](#) [NRVBM120ET1G](#) [VSSB410S-M3/5BT](#) [1N5819T-G](#)  
[PDS1040Q-13](#) [B160BQ-13-F](#) [SDM05U20CSP-7](#) [BAS 70-07](#) [E6433](#) [B140S1F-7](#) [HSM560Je3/TR13](#) [DDB2265-000](#) [ZHCS506QTA](#)  
[HSM190Je3/TR13](#) [B330AF-13](#) [ACDBUC0230-HF](#) [SDM1U100S1F-7](#) [MBR10200CTF-G1](#) [CDLL5712](#)