

HIGH POWER SPEC Pak™

Sealed Power For Environmental Connections



Marine | Wind Power | Lighting | Transportation | Pumps | Ground Support
Machine Tool | Industrial Automation | Motor | Solar Power | Harsh Environments



APP
Anderson Power Products

Rugged and Sealed (IP68) Plugs and Receptacles

For Use with APP® Powerpole® Signal, Power & Ground Contacts & Housings

The SPEC Pak™ High Power uses rugged and environmentally sealed (IP68) shells to protect APP® Powerpole® contacts and housings. Customer configured SPEC Pak™ High Power Connectors are capable of up to 260 amps and may be used anywhere a rugged and/or waterproof high power, signal and ground interconnect solution is required.

The SPEC Pak™ High Power shell accepts 75 to 180 amp Powerpole® contacts and up to 8 auxiliary contacts. The wide range of Powerpole® housing colors and contact sizes, coupled with the available Powerpole® insert holders, offers the user a wide array of design options. Wire sizes which can accommodate a range from 24 to 3/0 AWG (0.25 to 85.0 mm²). SPEC Pak™ High Power is highly configurable with thousands of design options in a single interconnect.

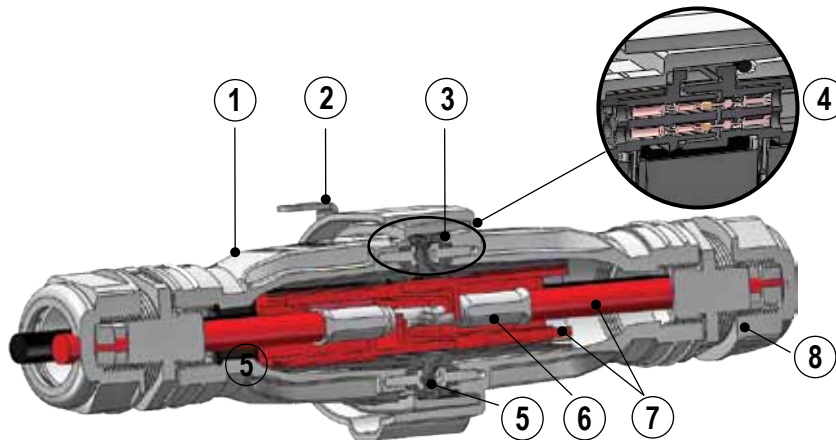

5 Powerpole® Insert Arrangement



1 - Chemical & UV Resistant Ruggedized Shells

- Wire to wire configurations
- Wire to Panel configurations

2 - Stainless Steel Latches (securing plug to receptacle)

3 - IP68 Interfacial Sealing O-Ring

4 - Auxiliary Contacts (up to 8)

5 - Powerpole® Insert Holders (user configurable)

- H02 Arrangement - up to two PP180 & 8 auxiliaries
- H03 Arrangement - up to three PP120 & 8 auxiliaries
- H06 Arrangement - up to six PP75 & 8 auxiliaries

6 - Power Contacts (up to 260 amps with 3/0 AWG)

7- Color Coded Powerpole® Housings Match Wire Colors

8 - Industry Standard Sealing (IP68) Components

- PG Gland Compatible - Size 36 and 42
- Multi-hole Glands For Use With Discrete Wires
- Single Hole Glands For Use With Jacketed Cable

Specifications

High Power SPEC Pak™ Shell / Components

Electrical

| | |
|---|--------------|
| UL Voltage Rating (AC/DC) | 600 |
| Dielectric Withstanding Voltage (AC) | 3000 |
| Operating Temperature (°C) | -40 to 105 * |
| (°F) | -40 to 221 |
| Flammability Rating of SPEC Pak™ Shells | UL94 V-0 |
| UV Rating (equivalent) | UL746C F1 |

Mechanical

| | |
|----------------------------------|------------|
| Shell/Latch Mating Cycles | 1,500 Min. |
| Average Connect/Disconnect (lbf) | 28 |
| (N) | 125 |
| IP Rating | IP68 |
| UL50 Sec. 36 Sealing Requirement | Pass |
| Crush Test per EIA-364-40B | Pass |
| Drop Test per UL50E | Pass |

Material

| | |
|--|---------------------|
| SPEC Pak™ - Receptacle, Plug & Holders | PBT |
| Latch | Stainless Steel |
| Latch Retainer | Stainless Steel |
| Holder Mount Hardware | Nickel Plated Steel |



**Mated Pair
High Power Plug To
Inline Receptacle**

| Powerpole® Contacts | PP180 | PP120 | PP75 | PowerMod® |
|---------------------------------------|---------------|---------------|-----------------------------------|---------------------|
| UL Current Rating (Amperes) ** | 260 | 190 | 70 | 5 |
| CSA (30C Rise) (Amperes) ** | 140 | 100 | 40 | 5 |
| Voltage Rating (AC/DC) | 600 | 600 | 600 | 600 |
| Contact Barrel Wire Size (AWG) | 3/0 to 6 | 1/0 to 6 | 6 to 12 | 12 to 24 |
| (mm ²) | 85 to 13.3 | 53.5 to 13.3 | 13.3 to 3.3 | 4.0 |
| Average Contact Resistance (milliohm) | 0.10 | 0.14 | 0.20 | 3.00 |
| Contact Retention Force (lbf) | 170 | 100 | 50 | 8 |
| (N) | 756 | 445 | 222 | 36 |
| Operating Temperature (°C) | -20 to 105 * | -20 to 105 * | -20 to 105 * | -20 to 105 * |
| (°F) | -4 to 221 | -4 to 221 | -4 to 221 | -4 to 221 |
| Flammability Rating | UL94 V-0 | UL94 V-0 | UL94 V-0 | UL94 V-0 |
| Contact Materials | Copper | Copper | Copper | Copper Alloy |
| Contact Plating | Silver | Silver | Silver | Gold over Nickel |
| Mechanical | | | | |
| Mating Cycles - no load | 10,000 | 10,000 | 10,000 | 10,000 |
| Average Connect/Disconnect (lbf) | 20 | 8 | 5 (Low Detent) 7 (High Detent) | 10 oz. (3N) Average |
| Material | | | | |
| Powerpole® Housing Material | Polycarbonate | Polycarbonate | Polycarbonate | PBT |

NOTE:

* -40° to 120° C (-40° to 248° F) can be achieved by using APP Chemical Resistant Powerpole® housing. Contact factory for more information.

** Based on Panel Mount Receptacle to Plug configuration.

1. Agency approvals - TUV Pending / Patents &

Pending   File No. E26226  

Part Number Configurator

PART NUMBER PLAN

| SPEC Pak™ Series (1 Fixed Character) | Shell Color (1 Character) | Shell Style (1 Character) | Dash | Shell Size (mm) (3 Characters) | Insert Arrangement (3 Characters) |
|---|------------------------------|---|----------|--|---|
| S | K | 2 | - | 095 | H02 |
| S = SPEC Pak™ Series | K = Black | 1 = Inline Receptacle 2 = Panel Mount Receptacle 6 = Straight Plug 9 = Environmental Receptacle Cover 9P = Environmental Plug Cover | | 095 = 095mm Panel Mount Receptacle Shell A95 = 095mm Shell, PG 36 B95 = 095mm Shell, PG 42 | Detailed Information Is Available On: H02 = PP180, 2 Pole Page 7 H03 = PP120 Housing, 3 Pole Page 8 H06 = PP75, 6 Pole Page 9 |

PLUG KIT

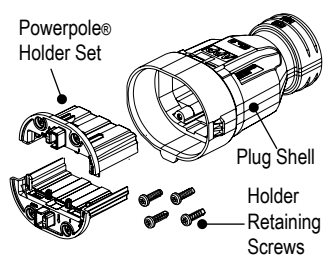

Ordering Information

- Part Number & Description
- SK6-A95H02**
- Plug Kit, PG 36 compatible shell with 2 pole PP180 holder
- SK6-A95H03**
- Plug Kit, PG 36 compatible shell with 3 pole PP120 holder
- SK6-A95H06**
- Plug Kit, PG 36 compatible shell with 6 pole PP75 holder
- SK6-B95H02**
- Plug Kit, PG 42 compatible shell with 2 pole PP180 holder
- SK6-B95H03**
- Plug Kit, PG 42 compatible shell with 3 pole PP120 holder
- SK6-B95H06**
- Plug Kit, PG 42 compatible shell with 6 pole PP75 holder

NOTE:
- Panel Mount Receptacle mounting hardware (8 each #10 or M5 screw) not included
- Recommended torque for mounting hardware is 15 to 20 in-lbf (1.7 to 2.2 N-m)

PANEL MOUNT RECEPTACLE KIT

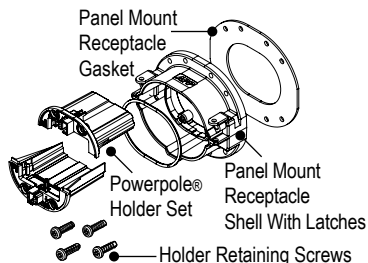

Ordering Information

- Part Number & Description
- SK2-095H02**
- Panel Mount Receptacle Kit with 2 pole PP180 holder
- SK2-095H03**
- Panel Mount Receptacle Kit with 3 pole PP120 holder
- SK2-095H06**
- Panel Mount Receptacle Kit with 6 pole PP75 holder

INLINE RECEPTACLE KIT

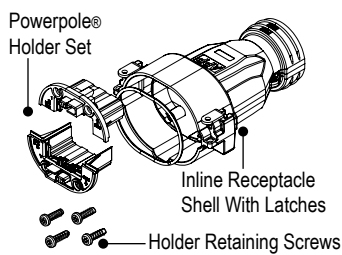

Ordering Information

- Part Number & Description
- SK1-A95H02**
- Inline Receptacle Kit, PG 36 compatible shell with, 2 pole PP180 holder
- SK1-A95H03**
- Inline Receptacle Kit, PG 36 compatible shell with, 3 pole PP120 holder
- SK1-A95H06**
- Inline Receptacle Kit, PG 36 compatible shell with, 6 pole PP75 holder
- SK1-B95H02**
- Inline Receptacle Kit, PG 42 compatible shell with, 2 pole PP180 holder
- SK1-B95H03**
- Inline Receptacle Kit, PG 42 compatible shell with, 3 pole PP120 holder
- SK1-B95H06**
- Inline Receptacle Kit, PG 42 compatible shell with, 6 pole PP75 holder

COVER KIT

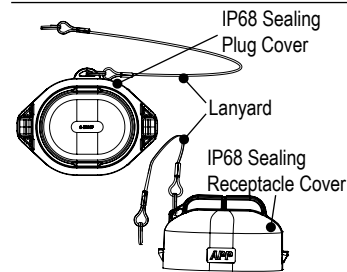

Ordering Information

- Part Number & Description
- SK9-095**
- Receptacle Cover Kit with lanyard
- SK9P-095**
- Plug Cover Kit with lanyard

Component Replacement Parts

- Part Number & Description
- H1120P41**
- #8 x 5/8 screw - Bulk Packaged

PART NUMBER PLAN

| Wire Protection See page 6 (4 Characters) | Housing Arrangement For more information see pages 7 thru 9 Dash (1 Character) | Contact Dash (2 Characters) | APP Content Dash (3 Characters) |
|--|---|--------------------------------|------------------------------------|
| PS | 00 | - | 0 |
| 00 = None PS = Plastic Short PM = Plastic Multi-hole | 00 = None 00 - 99 = Various Gland Type | - | 0 |
| | | 00 | - |
| | | | A01 |
| | | | Custom Configuration |

| Insert Arrangement | Contact Code | Contact | Wire Size AWG (mm ²) | Available in Insert Arrangement |
|--------------------------|--------------|---|-------------------------------------|---------------------------------|
| - | 00 | Custom Configuration - Use Next Section | | |
| A = AC Single Phase | 11 | 5900 | #6 13.3 | H06 |
| B = AC 3 Phase, 3 Wire | 12 | 5952 | #8 8.4 | H06 |
| E = AC 3 Phase, 4 wire | 13 | 5915 | #10 to 12 5.3 to 3.3 | H06 |
| F = AC 3 phase, 5 wire | 14 | 5900 with Auxiliary | #6 13.3 | H06 |
| G = DC 2 Circuit, 6 wire | 15 | 5952 with Auxiliary | #8 8.4 | H06 |
| R = DC 1 Circuit, 2 Wire | 16 | 5915 with Auxiliary | #10 to 12 5.3 to 3.3 | H06 |
| Z = All Black | | | | |
| | | | | |
| | 20 | 1323G2 | 1/0 53.5 | H03 |
| | 21 | 1323G1 | #1 42.4 | H03 |
| | 22 | 1319 | #2 33.6 | H03 |
| | 23 | 1319G4 | #4 21.2 | H03 |
| | 24 | 1319G6 | #6 13.3 | H03 |
| | 25 | 1323G2 with Auxiliary | 1/0 53.5 | H03 |
| | 26 | 1323G1 with Auxiliary | #1 42.4 | H03 |
| | 27 | 1319 with Auxiliary | #2 33.6 | H03 |
| | 28 | 1319G4 with Auxiliary | #4 21.2 | H03 |
| | 29 | 1319G6 with Auxiliary | #6 13.3 | H03 |
| | | | | |
| | 80 | 1328G2 | 3/0 85.0 | H02 |
| | 81 | 1328G1 | 2/0 67.4 | H02 |
| | 82 | 1382 | 1/0 53.5 | H02 |
| | 83 | 1347 | #1 42.4 | H02 |
| | 84 | 1383 | #2 33.6 | H02 |
| | 85 | 1384 | #4 21.2 | H02 |
| | 86 | 1348 | #6 13.3 | H02 |
| | 87 | 1328G2 with Auxiliary | 3/0 85.0 | H02 |
| | 88 | 1328G1 with Auxiliary | 2/0 67.4 | H02 |
| | 89 | 1382 with Auxiliary | 1/0 53.5 | H02 |
| | 90 | 1347 with Auxiliary | #1 42.4 | H02 |
| | 91 | 1383 with Auxiliary | #2 33.6 | H02 |
| | 92 | 1384 with Auxiliary | #4 21.2 | H02 |
| | 93 | 1348 with Auxiliary | #6 13.3 | H02 |

Part Numbering Notes:

- 1) To order SPEC Pak™ Shell Kits only (no internal Powerpole® housings or contacts), use part numbering on page 4 only. **Plug Shell Kit Example: SK6-A95H02 or SK6-B95H02.** Powerpole® housings, contacts and wire protection may be ordered separately, see pages 6 thru 9 for information.
- 2) To order customer configured SPEC Pak™ connectors (including internal Powerpole® housings and contacts) use Part Number Plan across the top of pages 4 and 5. **Customer Configured SPEC Pak™ Plug Connector Example: SK6-A95H03PS04-A22.**
- 3) To order a custom configuration which is not listed on page 7 thru 9, use APP custom part number configurator on the APP® website, www.andersonpower.com or contact factory.

NOTE: 1. Custom configurations may not be UL Recognized.

2. Contact code designation #14 to 16, #25 to 29 and #87 to 93 use 4 each of part number PM1612S30 (Pins) & 4 each of part number PM16S12S32 (Sockets) as signal.

Wire Protection - PG Gland

SPECIFICATIONS

| Material | | Mechanical | | Torque Requirements | |
|----------|------------------------|----------------|---------------------------------|--|--|
| Shell | Nylon PA 66 (UL94 V-2) | Operating Temp | -40°C to 105°C (-40°F to 221°F) | Cable Gland Body to Plug Housing | |
| Gasket | EPDM | IP Rating | IP68 | - Hand tighten until snug, tighten additional 1/8 - 1/4 turn with wrench | |
| Color | Black | UV Rating | Equivalent to UL746C F1 | Sealing Nut to Cable | |
| | | Thread Type | PG | - Hand tighten until snug, tighten additional 1/2 - 3/4 turn with wrench | |



STRAIGHT PLASTIC SHORT THREAD TYPE - STD PACK 10 / UL LISTED

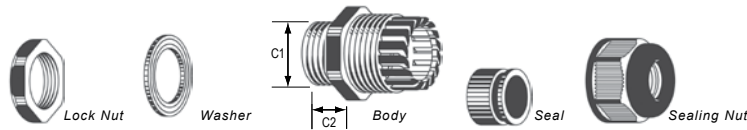

| APP® P/N | Wire Protection Designation (4 Characters) | PG Gland Size | Number Of Holes | Cable Range Wire Outer Dia. mm (in) | Thread O.D. C1 mm (in) | Panel Mounting Hole mm (in) | Thread Length C2 mm (in) | Wrench Size Lock Nut (mm) | Wrench Size Sealing Nut (mm) |
|------------|--|---------------|-----------------|-------------------------------------|------------------------|-----------------------------|--------------------------|---------------------------|------------------------------|
| PS1P36-26X | PS04 | 36 | 1 | 26.5 - 21.0 (1.04 - 0.83) | 47 (1.85) | 47 - 47.4 (1.85 - 1.67) | 15 (0.59) | 57 | 52 |
| PS1P36-32X | PS05 | 36 | 1 | 32.0 - 24.0 (1.26 - 0.94) | 47 (1.85) | 47 - 47.4 (1.85 - 1.67) | 15 (0.59) | 57 | 52 |
| PL1P42-19X | PS01 | 42 | 1 | 19.5 - 16.0 (0.77 - 0.63) | 54 (2.13) | 54 - 54.4 (2.13 - 2.14) | 15.5 (0.61) | 64 | 62 |
| PS1P42-32X | PS02 | 42 | 1 | 32.0 - 26.0 (1.26 - 0.79) | 54 (2.13) | 54 - 54.4 (2.13 - 2.14) | 15.5 (0.61) | 64 | 62 |
| PS1P42-41X | PS03 | 42 | 1 | 41.0 - 31.0 (1.61 - 1.22) | 54 (2.13) | 54 - 54.4 (2.13 - 2.14) | 15.5 (0.61) | 64 | 62 |

STRAIGHT PLASTIC MULTI-HOLE TYPE - STD PACK 10 / NOT UL LISTED

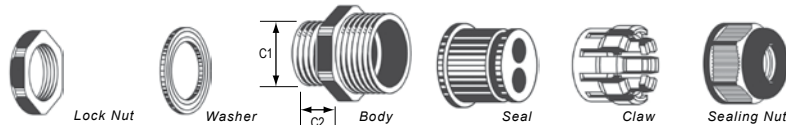

| APP® P/N | Wire Protection Designation (4 Characters) | PG Gland Size | Number Of Holes | Cable Range Wire Outer Dia. mm (in) | Thread O.D. C1 mm (in) | Panel Mounting Hole mm (in) | Thread Length C2 mm (in) | Wrench Size Lock Nut (mm) | Wrench Size Sealing Nut (mm) |
|------------|--|---------------|-----------------|-------------------------------------|------------------------|-----------------------------|--------------------------|---------------------------|------------------------------|
| PS2P36-13X | PM21 | 36 | 2 | 13.0 - 11.0 (0.51 - 0.43) | 47 (1.85) | 47 - 47.4 (1.85 - 1.67) | 15 (0.59) | 57 | 52 |
| PS2P36-9X | PM22 | 36 | 2 | 9.0 - 7.0 (0.35 - 0.28) | 47 (1.85) | 47 - 47.4 (1.85 - 1.67) | 15 (0.59) | 57 | 52 |
| PS3P36-7X | PM31 | 36 | 3 | 7.8 - 6.5 (0.31 - 0.26) | 47 (1.85) | 47 - 47.4 (1.85 - 1.67) | 15 (0.59) | 57 | 52 |
| PS3P36-10X | PM32 | 36 | 3 | 10 - 7.7 (0.39 - 0.30) | 47 (1.85) | 47 - 47.4 (1.85 - 1.67) | 15 (0.59) | 57 | 52 |
| PS4P36-12X | PM41 | 36 | 4 | 12.0 - 10.0 (0.48 - 0.39) | 47 (1.85) | 47 - 47.4 (1.85 - 1.67) | 15 (0.59) | 57 | 52 |
| PS5P36-8X | PM51 | 36 | 5 | 8.3 - 6.5 (0.33 - 0.26) | 47 (1.85) | 47 - 47.4 (1.85 - 1.67) | 15 (0.59) | 57 | 52 |
| PL4P42-10X | PM46 | 42 | 4 | 10.5 - 8.5 (0.41 - 0.33) | 54 (2.13) | 54 - 54.4 (2.13 - 2.14) | 15.5 (0.61) | 64 | 62 |
| PL6P42-7X | PM66 | 42 | 6 | 7.0 - 5.0 (0.28 - 0.20) | 54 (2.13) | 54 - 54.4 (2.13 - 2.14) | 15.5 (0.61) | 64 | 62 |
| PL8P42-7X | PM86 | 42 | 8 | 7.0 - 5.7 (0.28 - 0.22) | 54 (2.13) | 54 - 54.4 (2.13 - 2.14) | 15.5 (0.61) | 64 | 62 |

NOTE:

- Other PG Gland configurations and specifications are available, please contact the factory.
- Only UL listed cable glands are UL recognized components when used with SPEC Pak™ connector(s).
- Shading indicates stock item.

H02 Insert Arrangement

Configured with up to 2 PP180 Contacts (up to 260 amps)

Standard & Custom Configuration Options

HOUSING ARRANGEMENT

0 Custom Configuration

DC 1 Circuit, 2 Wire

R 1381G1 1381G3

All Black

Z 1381G1 1381G1

POWERPOLE® INSERT HOLDER



H02

NOTE:

1. For custom configuration, use APP® custom part number configurator at www.andersonpower.com or contact the factory.
2. Arrangement represents front view of the receptacle.

POWERPOLE® CONTACTS & HOUSINGS FOR H02 INSERT ARRANGEMENT

PP180 Contacts

| Standard Part Number | Minimum & Multiples | Packaged Part Number | Minimum & Multiples | Contact Code Designation | Description | Wire Size (AWG) |
|----------------------|---------------------|----------------------|---------------------|--------------------------|-------------|-----------------|
| 1328G2-BK | 100 | 1328G2 | 20 | 80 | Individual | 3/0 |
| 1328G1-BK | 100 | 1328G1 | 20 | 81 | Individual | 2/0 |
| 1382-BK | 500 | 1382 | 10 | 82 | Individual | 1/0 |
| 1347-BK | 500 | 1347 | 10 | 83 | Individual | #1 |
| 1383-BK | 500 | 1383 | 10 | 84 | Individual | #2 |
| 1384-BK | 500 | 1384 | 10 | 85 | Individual | #4 |
| 1348-BK | 200 | 1348 | 10 | 86 | Individual | #6 |

PP180 Contact Housings

| Standard Part Number | Minimum & Multiples | Packaged Part Number | Minimum & Multiples | Description |
|----------------------|---------------------|----------------------|---------------------|-------------|
| 1381G1-BK | 250 | 1381G1 | 10 | Black |
| 1381-BK | 250 | 1381 | 10 | Blue |
| 1381G4-BK | 250 | 1381G4 | 10 | Green |
| 1381G3-BK | 250 | 1381G3 | 10 | Red |
| 1381G2-BK | 250 | 1381G2 | 10 | White |

Signal Contacts for Standard & Custom Configurations

| Standard Part Number | Minimum & Multiples | Packaged Part Number | Minimum & Multiples | Contact Code Designation | Description | Wire Size (AWG) |
|----------------------|---------------------|----------------------|---------------------|--------------------------|-------------|-----------------|
| PM16P12S30 | 500 | PM16P12S30-50 | 50 | 87 thru 93 | Individual | #12 |
| PM16P1416S30 | 500 | PM16P1416S30-50 | 50 | - | Individual | #14 to 16 |
| PM16P1620S30 | 500 | PM16P1620S30-50 | 50 | - | Individual | #16 to 20 |
| PM16P2024S30 | 500 | PM16P2024S30-50 | 50 | - | Individual | #20 to 24 |
| PM16S12S32 | 500 | PM16S12S32-50 | 50 | 87 thru 93 | Individual | #12 |
| PM16S1416S32 | 500 | PM16S1416S32-50 | 50 | - | Individual | #14 to 16 |
| PM16S1620S32 | 500 | PM16S1620S32-50 | 50 | - | Individual | #16 to 20 |
| PM16S2024S32 | 500 | PM16S2024S32-50 | 50 | - | Individual | #20 to 24 |

NOTE:

1. Contact code designation #87 to 93 is 4 each of PM16P12S30 (pins) & 4 each of part number PM16S12S32 (sockets) as signal.
2. See Powerpole® & Multipole Power Connectors Catalog for additional contacts and/or housings options.
3. Application tooling information is available on page 12.

H03 Insert Arrangement

Configured with up to 3 PP120 Contacts (up to 190 amps)
Standard & Custom Configuration Options

HOUSING ARRANGEMENT

0 Custom Configuration

AC Single Phase

A 1321G1 1321G2 1321G4

DC 1 Circuit, 2 Wire

R 1321G1 1321G3 E

All Black

Z 1321G1 1321G1 1321G1

POWERPOLE® INSERT HOLDER



H03

NOTE:

1. E = Empty
2. For custom configuration, use APP® custom part number configurator at www.andersonpower.com or contact the factory.
3. Arrangement represents front view of the receptacle.

POWERPOLE® CONTACTS & HOUSINGS FOR H03 INSERT ARRANGEMENT

PP120 Contacts

| Standard Part Number | Minimum & Multiples | Packaged Part Number | Minimum & Multiples | Contact Code Designation | Description | Wire Size (AWG) |
|----------------------|---------------------|----------------------|---------------------|--------------------------|-------------|-----------------|
| 1323G2-BK | 100 | 1323G2 | 20 | 20 | Individual | 1/0 |
| 1323G1-BK | 100 | 1323G1 | 20 | 21 | Individual | #1 |
| 1319-BK | 500 | 1319 | 20 | 22 | Individual | #2 |
| 1319G4-BK | 500 | 1319G4 | 20 | 23 | Individual | #4 |
| 1319G6-BK | 500 | 1319G6 | 20 | 24 | Individual | #6 |

PP120 Contact Housings

| Standard Part Number | Minimum & Multiples | Packaged Part Number | Minimum & Multiples | Description |
|----------------------|---------------------|----------------------|---------------------|-------------|
| 1321G1-BK | 500 | 1321G1 | 20 | Black |
| 1321-BK | 500 | 1321 | 20 | Blue |
| 1321G4-BK | 500 | 1321G4 | 20 | Green |
| 1321G3-BK | 500 | 1321G3 | 20 | Red |
| 1321G2-BK | 500 | 1321G2 | 20 | White |

Signal Contacts for Standard & Custom Configurations

| Standard Part Number | Minimum & Multiples | Packaged Part Number | Minimum & Multiples | Contact Code Designation | Description | Wire Size (AWG) |
|----------------------|---------------------|----------------------|---------------------|--------------------------|-------------|-----------------|
| PM16P12S30 | 500 | PM16P12S30-50 | 50 | 25 thru 29 | Individual | #12 |
| PM16P1416S30 | 500 | PM16P1416S30-50 | 50 | - | Individual | #14 to 16 |
| PM16P1620S30 | 500 | PM16P1620S30-50 | 50 | - | Individual | #16 to 20 |
| PM16P2024S30 | 500 | PM16P2024S30-50 | 50 | - | Individual | #20 to 24 |
| PM16S12S32 | 500 | PM16S12S32-50 | 50 | 25 thru 29 | Individual | #12 |
| PM16S1416S32 | 500 | PM16S1416S32-50 | 50 | - | Individual | #14 to 16 |
| PM16S1620S32 | 500 | PM16S1620S32-50 | 50 | - | Individual | #16 to 20 |
| PM16S2024S32 | 500 | PM16S2024S32-50 | 50 | - | Individual | #20 to 24 |

NOTE:

1. Contact code designation #25 to 29 uses 4 each of PM16P12S30 (pins) & 4 each of part number PM16S12S32 (sockets) as signal.
2. See Powerpole® & Multipole Power Connectors Catalog for additional contacts and/or housings options.
3. Application tooling information is available on page 12.

H06 Insert Arrangement

Configured with up to 6 PP75 Contacts (up to 75 amps)
Standard & Custom Configuration Options

HOUSING ARRANGEMENT

POWERPOLE® INSERT HOLDER

0 Custom Configuration

AC 3 Phase, 3 Wire

| | | | |
|----------|--------|--------|--------|
| B | 5916G4 | 5916G5 | 5916G7 |
| | E | 5916G6 | E |

AC 3 Phase, 4 Wire

| | | | |
|----------|--------|--------|--------|
| E | 5916G4 | 5916 | 5916G5 |
| | 5916G6 | 5916G7 | E |

AC3 Phase, 5 Wire

| | | | |
|----------|--------|--------|--------|
| F | 5916G4 | 5916G5 | 5916G7 |
| | 5916 | 5916G6 | 5916 |

DC 2 Circuit, 6 Wire

| | | | |
|----------|--------|--------|--------|
| G | 5916G4 | 5916G4 | 5916G4 |
| | 5916G7 | 5916G7 | 5916G7 |



H06

NOTE:

1. E = Empty
2. For custom configuration, use APP® custom part number configurator at www.andersonpower.com or contact the factory.
3. Arrangement represents front view of the receptacle.

POWERPOLE® CONTACTS & HOUSINGS FOR H06 INSERT ARRANGEMENT

PP75 Contacts

| Standard Part Number | Minimum & Multiples | Packaged Part Number | Minimum & Multiples | Contact Code Designation | Description | Wire Size (AWG) |
|----------------------|---------------------|----------------------|---------------------|--------------------------|-------------|-----------------|
| 5900-BK | 1000 | 5900 | 25 | 11 | Individual | #6 |
| 5952-BK | 1000 | 5952 | 25 | 12 | Individual | #8 |
| 5915-BK | 1000 | 5915 | 100 | 13 | Individual | #10 to 12 |

PP75 Contact Housings

| Standard Part Number | Minimum & Multiples | Packaged Part Number | Minimum & Multiples | Description |
|----------------------|---------------------|----------------------|---------------------|-------------|
| 5916G4-BK | 1000 | 5916G4 | 25 | Black |
| 5916-BK | 1000 | 5916 | 25 | Blue |
| 5916G6-BK | 1000 | 5916G6 | 25 | Green |
| 5916G7-BK | 1000 | 5916G7 | 25 | Red |
| 5916G5-BK | 1000 | 5916G5 | 25 | White |

Signal Contacts for Standard & Custom Configurations

| Standard Part Number | Minimum & Multiples | Packaged Part Number | Minimum & Multiples | Contact Code Designation | Description | Wire Size (AWG) |
|----------------------|---------------------|----------------------|---------------------|--------------------------|-------------|-----------------|
| PM16P12S30 | 500 | PM16P12S30-50 | 50 | 14 thru 16 | Individual | #12 |
| PM16P1416S30 | 500 | PM16P1416S30-50 | 50 | - | Individual | #14 to 16 |
| PM16P1620S30 | 500 | PM16P1620S30-50 | 50 | - | Individual | #16 to 20 |
| PM16P2024S30 | 500 | PM16P2024S30-50 | 50 | - | Individual | #20 to 24 |
| PM16S12S32 | 500 | PM16S12S32-50 | 50 | 14 thru 16 | Individual | #12 |
| PM16S1416S32 | 500 | PM16S1416S32-50 | 50 | - | Individual | #14 to 16 |
| PM16S1620S32 | 500 | PM16S1620S32-50 | 50 | - | Individual | #16 to 20 |
| PM16S2024S32 | 500 | PM16S2024S32-50 | 50 | - | Individual | #20 to 24 |

NOTE:

1. Contact code designation #14 to 16 uses 4 each of PM16P12S30 (pins) & 4 each of part number PM16S12S32 (sockets) as signal.
2. See Powerpole® & Multipole Power Connectors Catalog for additional contacts and/or housings options.
3. Application tooling information is available on page 12.

Dimensions

PLUG

Top View

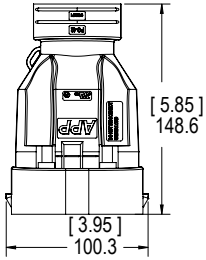

Side View

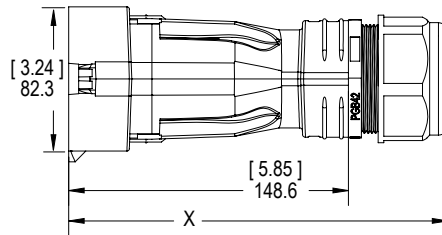

APPROXIMATE OVERALL LENGTH W/ GLAND

| | X | |
|------------------|-----|-----|
| | MM | IN |
| Shell with PG 36 | 193 | 7.6 |
| Shell with PG 42 | 201 | 7.9 |

Insert Arrangements

Front View - H02

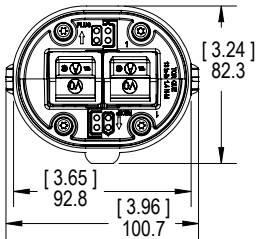

Front View - H03

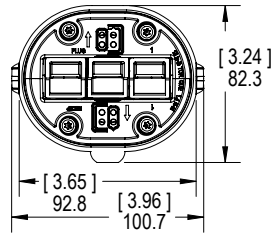

Front View - H06

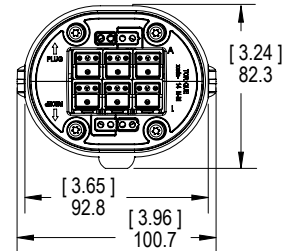

MATED SIDE VIEW

Plug to Panel Mount Receptacle

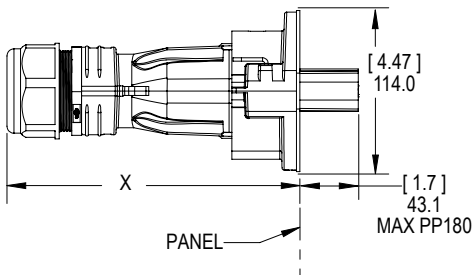

PLUG TO PANEL MOUNT RECEPTACLE

| | X | | | |
|------------------|-------|-----|-------|------|
| | MM | IN | MM | IN |
| Shell with PG 36 | 114.0 | 4.7 | 200.7 | 7.90 |
| Shell with PG 36 | 114.0 | 4.7 | 207.3 | 8.16 |

Plug to Inline Receptacle

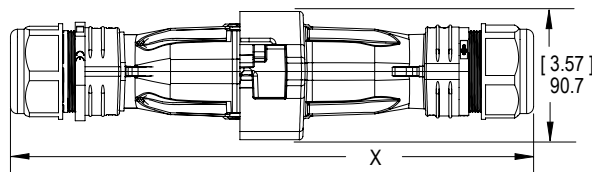

PLUG TO INLINE RECEPTACLE

| | X | | | |
|------------------|------|------|-------|-------|
| | MM | IN | MM | IN |
| Shell with PG 36 | 90.7 | 3.57 | 354.1 | 13.94 |
| Shell with PG 36 | 90.7 | 3.57 | 370.3 | 14.58 |

PLUG COVER

Front View

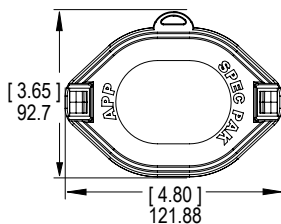

Side View

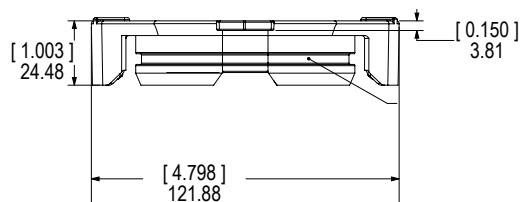

INLINE RECEPTACLE

Top View

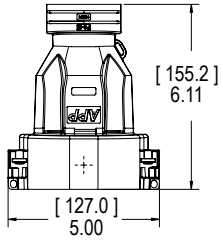

Side View

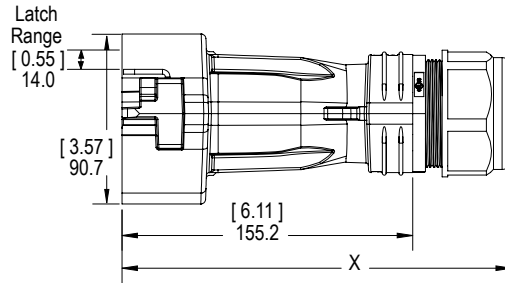

APPROXIMATE OVERALL LENGTH W/ GLAND

| | X | |
|------------------|-----|-----|
| | MM | IN |
| Shell with PG 36 | 200 | 7.9 |
| Shell with PG 42 | 208 | 8.2 |

Insert Arrangements

Front View - H02

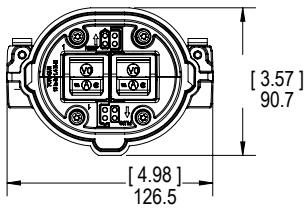

Front View - H03

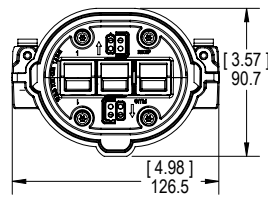

Front View - H06

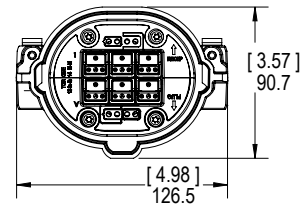

PANEL MOUNT RECEPTACLE

Panel Cutout

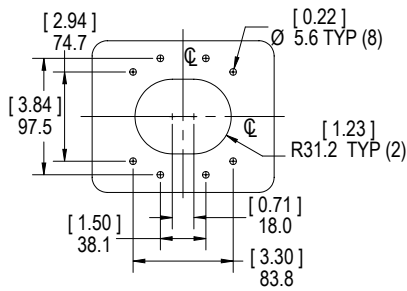

Top View

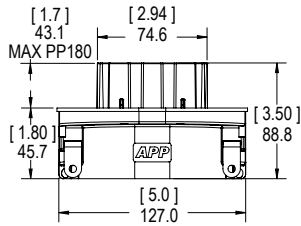

Side View

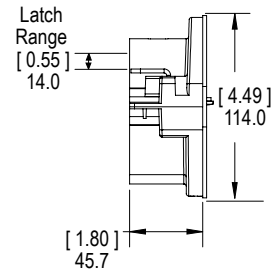

Insert Arrangements

Front View - H02

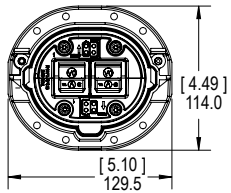

Front View - H03

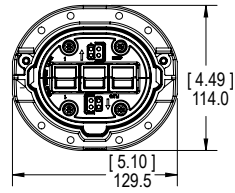

Front View - H06

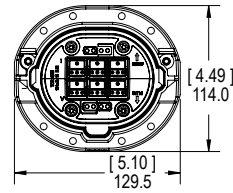

RECEPTACLE COVER

Front View

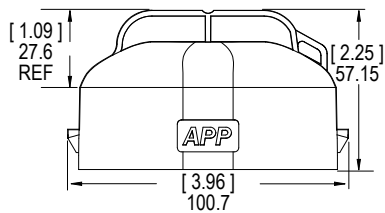

Side View

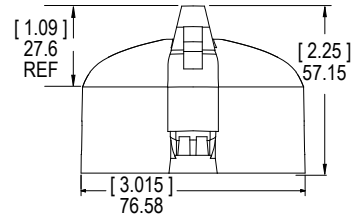

Tooling Charts

APPLICATION TOOLING

PP75 Contact Tools

| Contact Part Number | + Hand Tool | or Pneumatic Bench Tool | + Die | + Locator |
|---------------------|-------------|-------------------------|--------|-----------|
| 5900 | 1309G4 | 1387G1 | 1388G6 | 1389G6 |
| 5952 | | | 1388G7 | 1388G7 |
| 5915 | | | | |

PP120 Contact Tools

| Contact Part Number | Dieless Hydraulic Tool | or Pneumatic Bench Tool | + Die | + Locator |
|---------------------|------------------------|-------------------------|--------|-----------|
| 1319 | 1368 | 1387G1 | | |
| 1319G4 | | | 1388G4 | 1389G4 |
| 1319G6 | | | | |
| 1323G1 | | | 1388G3 | 1389G3 |
| 1323G2 | | | | |

PP180 Contact Tools

| Contact Part Number | Dieless Hydraulic Tool | or Pneumatic Bench Tool | + Die | + Locator | |
|---------------------|------------------------|-------------------------|--------|-----------|---------|
| 1382 | 1368 | 1387G1 | 1387G2 | 1303G4 | 1304G32 |
| 1383 | | | 1388G3 | 1389G3 | |
| 1348 | | | | | |
| 1347 | | | | | |
| 1384 | | | 1388G5 | 1389G5 | |
| 1328G1 | | | 1303G4 | 1304G32 | |
| 1328G2 | 1387G2 | 1303G12 | | | |

PowerMod® Signal Contact Tools

| Contact Part Number | APP Hand Tool | or Mil Std. Hand Tool (APP Part #) | or Locator / Turret | or Pneumatic Tool for Locator / Turret |
|---|---------------|------------------------------------|----------------------|--|
| Crimp Pins PM16P12S30 PM16P1416S30 PM16P1620S30 PM16P2024S30 | PM1000G1 | M22520/1-01 (TM0001) | No Mil Std. (TL0001) | TP0001 |
| Crimp Sockets PM16S12S32 PM16S1416S32 PM16S1620S32 PM16S2024S32 | | | No Mil Std. (TL0002) | |



1309



PM1000G1



TM0001



1368



Die

Locator

1387G2

1387G1

NOTE: Visit www.andersonpower.com for additional tooling options.

All Data Subject To Change Without Notice Patents with Patents Pending

DS-HPSPAK REV00

HEADQUARTERS: Anderson Power Products®, 13 Pratts Junction Road, Sterling, MA 01564-2305 USA T:978-422-3600 F:978-422-3700

EUROPE: Anderson Power Products® Ltd., Unit 3, Europa Court, Europa Boulevard, Westbrook, Warrington, Cheshire, WA5 7TN United Kingdom T: +44 (0) 1925 428390 F: +44 (0) 1925 520203

ASIA / PACIFIC: IDEAL Anderson Asia Pacific Ltd., Unit 922-928 Topsail Plaza, 11 On Sum Street, Shatin N.T., Hong Kong T: +(852) 2636 0836 F: +(852) 2635 9036

CHINA: IDEAL Anderson Technologies (Shenzhen) Ltd., Block A8 Tantou Western Industrial Park, Songgang Baoan District, Shenzhen, P.R. China 518105 T: +(86) 755 2768 2118 F: +(86) 755 2768 2218

TAIWAN: IDEAL Anderson Asia Pacific Ltd., Taiwan Branch, 4F-2, No.116, Dadun 20th St., Situn District, Taichung City 407, Taiwan (R.O.C.) T: +(886) 4 2310 6451 F: +(886) 4 2310 6460

www.andersonpower.com

X-ON Electronics

Largest Supplier of Electrical and Electronic Components

Click to view similar products for [Heavy Duty Power Connectors](#) *category:*

Click to view products by [Anderson Power Products](#) *manufacturer:*

Other Similar products are found below :

[1424439](#) [1424438](#) [09330062652](#) [2-8675P1](#) [580129-2](#) [605601-1](#) [6340G1](#) [6341G1](#) [6360G1](#) [6373G1](#) [6374g2](#) [6396G1](#) [647757-1](#) [66394-4](#)
[6643411-1](#) [6646058-2](#) [6646137-1](#) [6646138-1](#) [6646348-1](#) [6646479-1](#) [6646608-1](#) [6646786-1](#) [6646940-1](#) [6651091-1](#) [6651525-1](#) [6651529-1](#)
[6651778-1](#) [6651788-1](#) [696465-1](#) [696475-1](#) [73000005059](#) [73000005349](#) [73000005642](#) [73080255059](#) [73080965046](#) [765-15-0080A](#)
[765-16-0080B](#) [789.700-44](#) [789.700-54](#) [80-1010](#) [80-9](#) [827381-1](#) [829992-1](#) [902-77-02113](#) [PL00U-301-10D10](#) [PM103MOOLOO](#)
[PM16S1620S32-50](#) [PM212MOOLOO](#) [PM309FOOLOO](#) [PM324FOOLCH](#)