

21000N series

Low profile toggle switches

Distinctive features and specifications

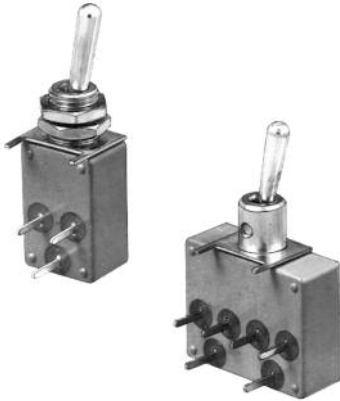

- Available with threaded or plain bushing, both with mounting plate
- Low profile - same height for single and double pole
- Wave solderable only

ELECTRICAL SPECIFICATIONS

- Max. current/voltage rating with resistive load :
 - silver contacts (A) : 4A 30VDC
 - gold plated brass contacts (LD) : 100mA 30VDC
- Minimum load :
 - silver contacts (A) : 100mA 10V
 - gold plated brass contacts (LD) : 10 μ A 5VDC - 10mA 50mV
- Initial contact resistance : 20 m Ω max.
- Insulation resistance : 1.000 M Ω min. at 500VDC
- Dielectric strength :
 - 1.000 Vrms 50 Hz min. between terminals
 - 2.000 Vrms 50 Hz min. between poles
 - 2.000 Vrms 50 Hz min. between terminals and frame
- Electrical life at full load :
 - silver contacts (A) : 20.000 cycles
 - gold plated brass contacts (LD) : 50.000 cycles
- Low level or mechanical life : 100.000 cycles

MATERIALS

- Case and cover : PBT
- Actuator : brass, nickel plated
- Bushing : brass, nickel plated
- Contacts
 - A** : silver
 - LD** : brass, gold plated

GENERAL SPECIFICATIONS

- Operating temperature : -40°C to +85°C

21000N series

Low profile toggle switches

Overview

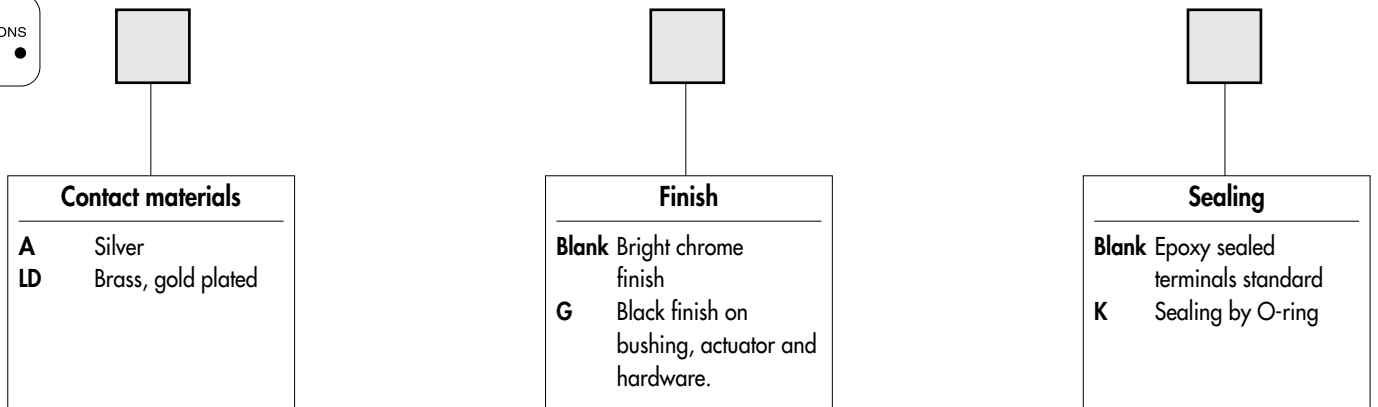
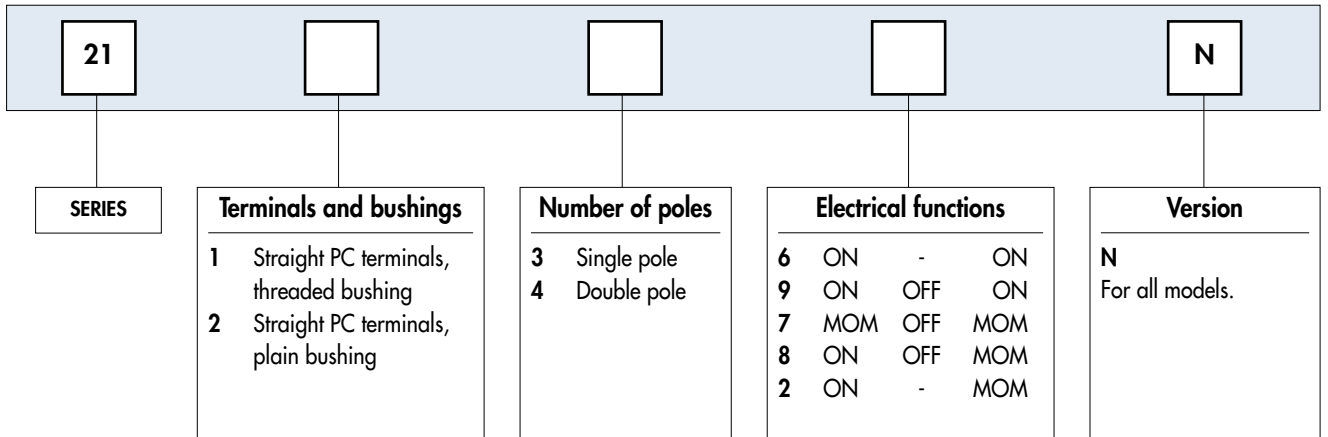

ABOUT THIS SERIES

On the following pages, you will find successively :

- model structure of switches
- options in the same order as in above chart

Dimensions : first dimensions are in mm while inches are shown as bracketed numbers.



Mounting accessories : standard hardware supplied with all models with threaded bushing : 2 hex nuts 8 mm (.314) across flats. Standard and special hardware available are presented in section I.



Packaging unit : 50 pieces for SP models, 25 pieces for DP.

21000N series

Low profile toggle switches

MODEL
STRUCTURE

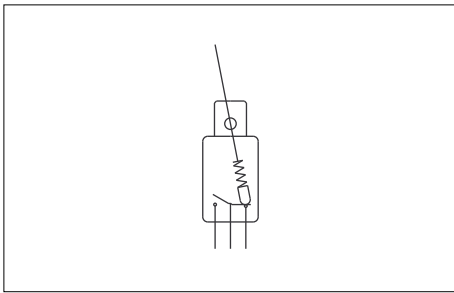

- Epoxy sealed terminals standard
- 1 and 2 pole configurations

MODEL
STRUCTURE

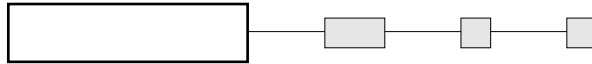

Threaded bushing - single pole



21136N
21139N
21137N
21138N
21132N

III	II	I
2-3		1-2
ON	-	ON
ON	OFF	ON
MOM	OFF	MOM
ON	OFF	MOM
ON	-	MOM

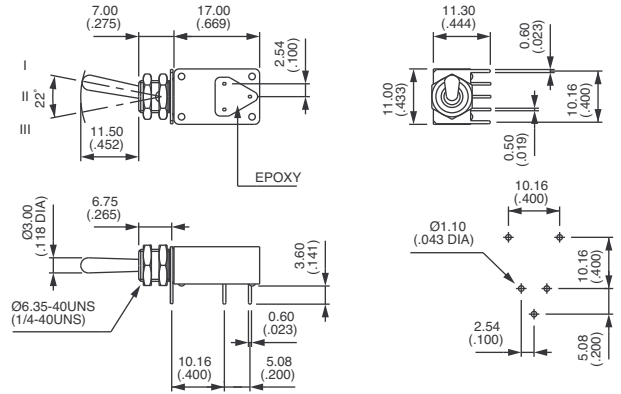

Threaded bushing - double pole



21146N
21149N
21147N
21148N
21142N

III	II	I
2-3		1-2
5-6		4-5
ON	-	ON
ON	OFF	ON
MOM	OFF	MOM
ON	OFF	MOM
ON	-	MOM

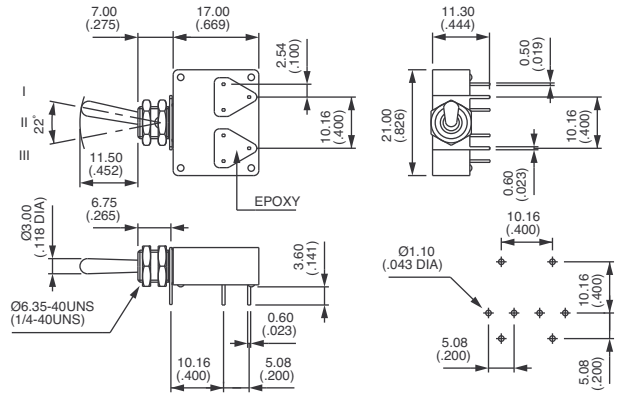

Plain bushing - single pole



21236N
21239N
21237N
21238N
21232N

III	II	I
2-3		1-2
ON	-	ON
ON	OFF	ON
MOM	OFF	MOM
ON	OFF	MOM
ON	-	MOM

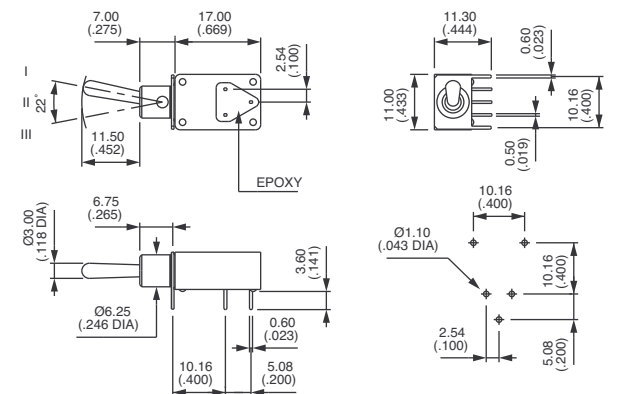

Plain bushing - double pole



21246N
21249N
21247N
21248N
21242N

III	II	I
2-3		1-2
5-6		4-5
ON	-	ON
ON	OFF	ON
MOM	OFF	MOM
ON	OFF	MOM
ON	-	MOM

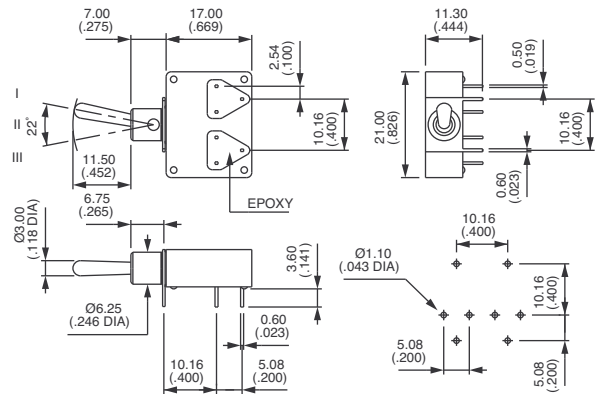

PANEL CUT-OUT

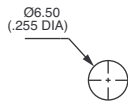

PCB MOUNTING

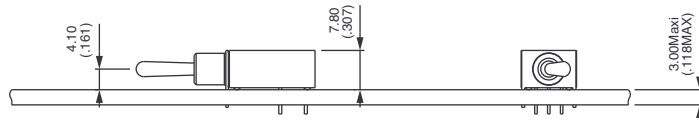

POSITIONS AND CONNECTIONS

Bottom view

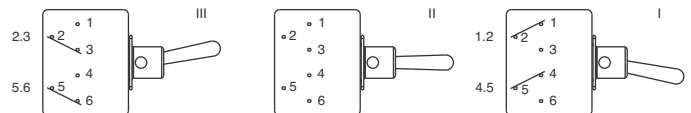

Function 6	ON	-	ON
Function 9	ON	OFF	ON
Function 7	MOM	OFF	MOM
Function 8	ON	OFF	MOM
Function 2	ON	-	MOM

21000N series

Low profile toggle switches

OPTIONS



CONTACT MATERIALS

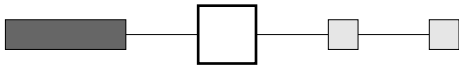

- A Silver
- LD Brass, gold plated

FINISH

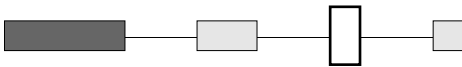

- Blank Bright chrome finish on actuator, nickel plating for bushing and hardware.
- G Black finish on bushing, actuator and hardware

SEALING

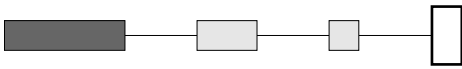

Epoxy sealed terminals are standard.

- Blank No sealing except standard.
- K Bushing internally sealed by one O-ring (version without washer U360). Protects the switch against water and dust.

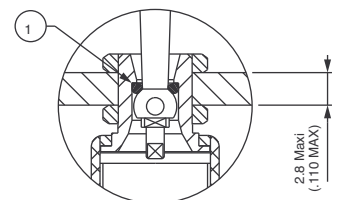

① O-ring

X-ON Electronics

Largest Supplier of Electrical and Electronic Components

Click to view similar products for [Toggle Switches](#) category:

Click to view products by [Apem](#) manufacturer:

Other Similar products are found below :

[A19HV](#) [8A1-C-222](#) [60012L](#) [6006L](#) [6663](#) [7101MD9V30GE](#) [7101SPDV30BE](#) [7103SDV30BE](#) [7105D](#) [7108P3YAV2BE](#) [71YY50282](#)
[7201MD9AVBE](#) [7301K38](#) [7306K36](#) [7310K36](#) [7314K36](#) [7506K4](#) [7592K6](#) [7691K14](#) [7700K1](#) [8396K108](#) [8824K14](#) [8828K13](#) [G3VX](#) [PS83-](#)
[121G](#) [A101MD9AB04](#) [A101SD9AB04](#) [A101SDCQ04](#) [A103SD9AQ04](#) [A107TZB04](#) [A123P32YZQ](#) [A123S1YZG](#) [A127S1YCQ](#) [1-1825192-](#)
[0](#) [A131S1YZQ](#) [A201SCWZB04](#) [A207SYCB04](#) [A208J61ZQ0004](#) [A221K12KAG](#) [A221S1YZQ](#) [A221T1TCQ](#) [A232K12KZQ](#) [A232M1YCQ](#)
[A323S1CWZQ](#) [A423S1YZQ](#) [12149A-3V](#) [12156AX408](#) [12147AGKX679](#) [12149AD2G0383VX408](#) [12246X778](#)