

# SOCKETS FOR PUSHWHEEL SWITCHES

## FEATURES

- Glass fiber reinforced, self extinguishing body.
- Solder lug or p.c. terminals.
- Permanently marked terminals.
- High insertion/withdrawal force.

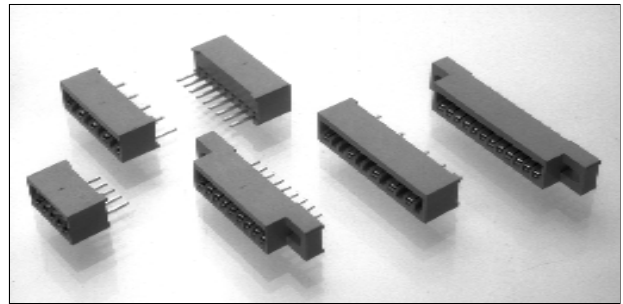

## MATERIALS

Body: Glass fiber reinforced PPO (self-extinguishing, non drip group 1).

Contacts: Gold over nickel over phosphor bronze

## SPECIFICATIONS

Contact spacing: .079" (2mm)

Contact rating: 40 V at 1 Amp

Contact resistance: Less than 15 milliohms

Insulation resistance: Greater than  $10^{12}$  ohms

Test voltage: 500 V

Operating temperature: -40°C to 100°C

Insertion force/contact: Approx. 7.2 oz.

Withdrawal force/contact: Approx. 6.5 oz.

Socket integrity: 100 insertions min. with no change to above values

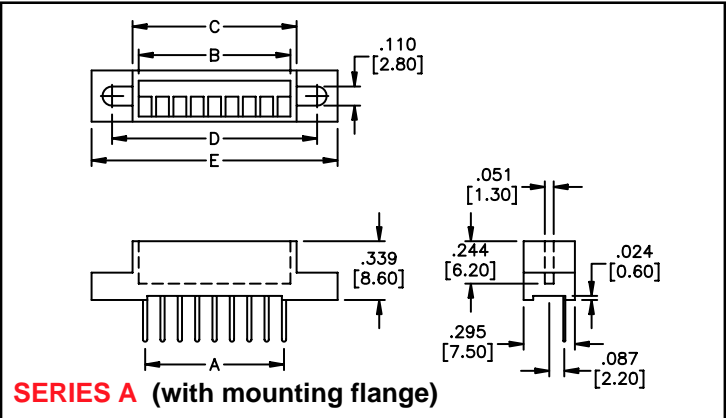

**SERIES A (with mounting flange)**

Poles/models	A	B	C	D	E
<b>9 poles for SMCD &amp; DPS8</b>	8 X .100" (2.54mm)	.874" (22.2mm)	.945" (24mm)	1.180" (30mm)	1.417" (36mm)
<b>12 poles for DPS9 &amp; DPS10</b>	11 x .100" (2.54mm)	1.200" (30.5mm)	1.300" (33mm)	1.535" (39mm)	1.772" (45mm)

## TERMINATIONS

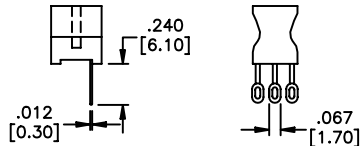

**L** Solder lug (for .100" (2.54mm) spacing only).

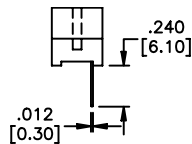

**LS** Printed circuit

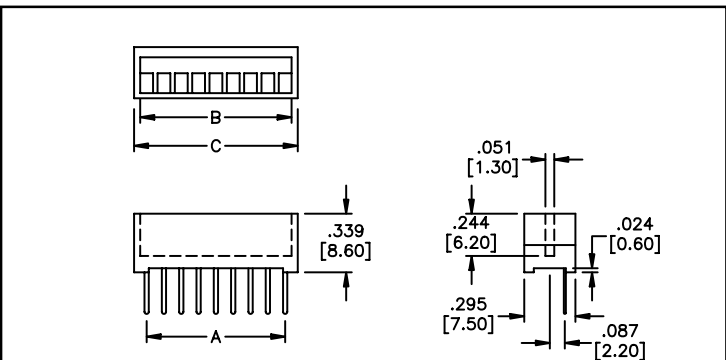

**SERIES B (without mounting flange)**

Poles/models	A	B	C
<b>5 poles for PICOD</b>	4 X .100" (2.54mm)	.559" (14.2mm)	.598" (15.2mm)
<b>9 poles for SMCD &amp; DPS8</b>	8 X .100" (2.54mm)	.874" (22.2mm)	.945" (24mm)
<b>11 poles for SMCD &amp; DPS8</b>	10 X .079" (2.00mm)	.874" (22.2mm)	.945" (24mm)
<b>12 poles for DPS9 &amp; DPS10</b>	11 x .100" (2.54mm)	1.200" (30.5mm)	1.300" (33mm)

## ORDER FORMAT:

Make selections shown below boxes for complete connector model number.

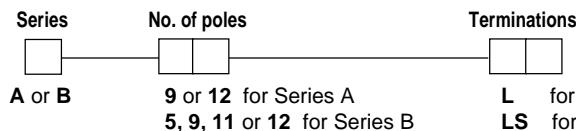

Example of complete model no.: B11LS

## X-ON Electronics

Largest Supplier of Electrical and Electronic Components

*Click to view similar products for [Thumbwheel Switches & Pushwheel Switches](#) category:*

*Click to view products by [Apem](#) manufacturer:*

Other Similar products are found below :

[PICOD131ALULS2](#) [A7SS-107-PM](#) [DGAN-031-B](#) [1437603-2](#) [DPS10131AL2](#) [DPS10301AK](#) [DPS8111AK](#) [DPS8137AK2](#) [1437603-7](#) [A7M-1P](#) [B5LS](#) [B5LS](#) [3-1437603-8](#) [DGBN-036-B](#) [DPS10131AK](#) [DPS910A2](#) [1-1437602-8](#) [SH6G137AKLS2](#) [1-1437603-1](#) [SMCL2](#)  
[SMCD137AK](#) [SP1.5](#) [DPS8111AK2](#) [TW01RED14](#) [TW01BLK14](#) [84212014](#) [84212013](#) [HTWF-1A12A21](#) [301419100](#) [302109002](#)  
[302329N00](#) [311100001](#) [312100100](#) [312300000](#) [332300003](#) [337100000](#) [342300001](#) [311100000](#) [312100000](#) [313100000](#) [313110003](#)  
[321400100](#) [322300000](#) [323100000](#) [332100100](#) [333100110](#) [347100000](#) [301119000](#) [303109101](#) [332710P00](#)