

# CW series

## Proportional miniature control wheel

Distinctive features and specifications



- Miniature design
- Ideal for joystick, armrest and panel mounting
- Proportional output
- Self-centering, single axis actuator
- Snap-in mounting

MECHANICAL	ELECTRICAL
<ul style="list-style-type: none"> <li>• Mechanical Angle of Movement: <math>\pm 45^\circ</math></li> <li>• Expected Life: 3 million cycles</li> <li>• Mass / weight: <math>18.25g \pm 5.0g</math> (<math>0.64oz \pm 0.18oz</math>)</li> <li>• Lever Action (Centering): Spring centering</li> </ul>	<ul style="list-style-type: none"> <li>• Resolution: 1.22mV</li> <li>• Supply Voltage Range: <math>5.00V \pm 0.250VDC</math></li> <li>• Reverse Polarity Max: -10V</li> <li>• Overvoltage Max: 20V</li> <li>• Output Impedance: 2<math>\Omega</math></li> <li>• Return to Center Voltage Tolerance: <math>\pm 200mV</math> initial</li> </ul>
ENVIRONMENTAL	<p>NOTES: Exact specifications are subject to configuration. All values are nominal.</p>
<ul style="list-style-type: none"> <li>• Operating Temperature: <math>-40^\circ C</math> to <math>+85^\circ C</math> (<math>-40^\circ F</math> to <math>+185^\circ F</math>)</li> <li>• Storage Temperature: <math>-40^\circ C</math> to <math>+85^\circ C</math> (<math>-40^\circ F</math> to <math>+185^\circ F</math>)</li> <li>• EMC Immunity Level: EN61000-4-3</li> <li>• EMC Emissions Level: EN61000-6-3:2001</li> <li>• ESD: EN61000-4-2</li> </ul>	

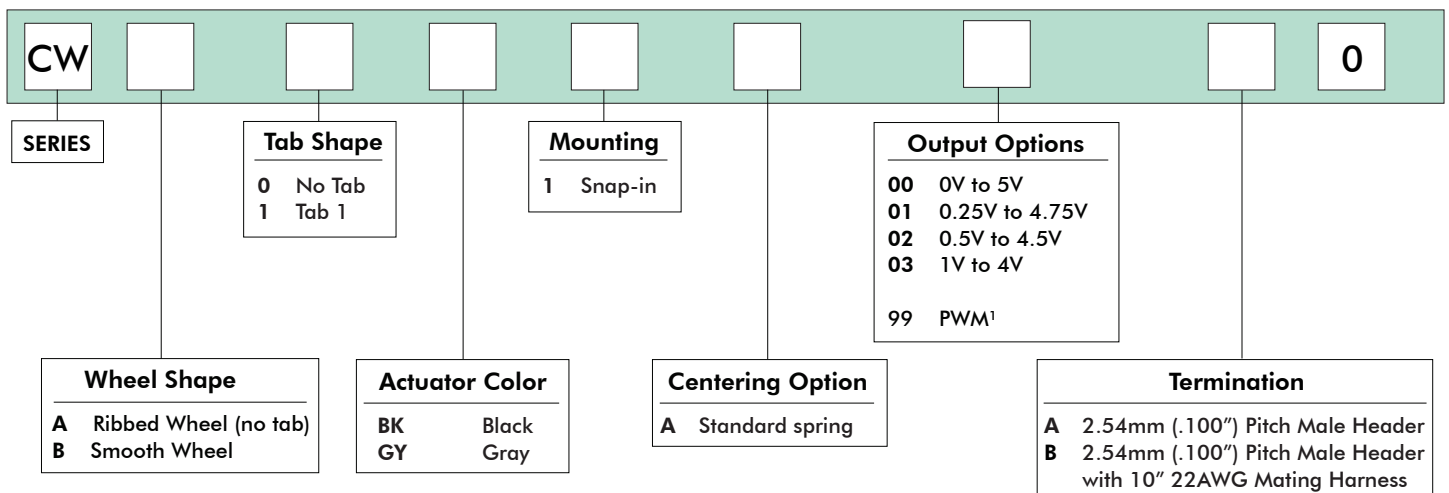

NOTE:

1 - Contact factory for PWM configuration.

# CW series

## Proportional miniature control wheel

### Overview

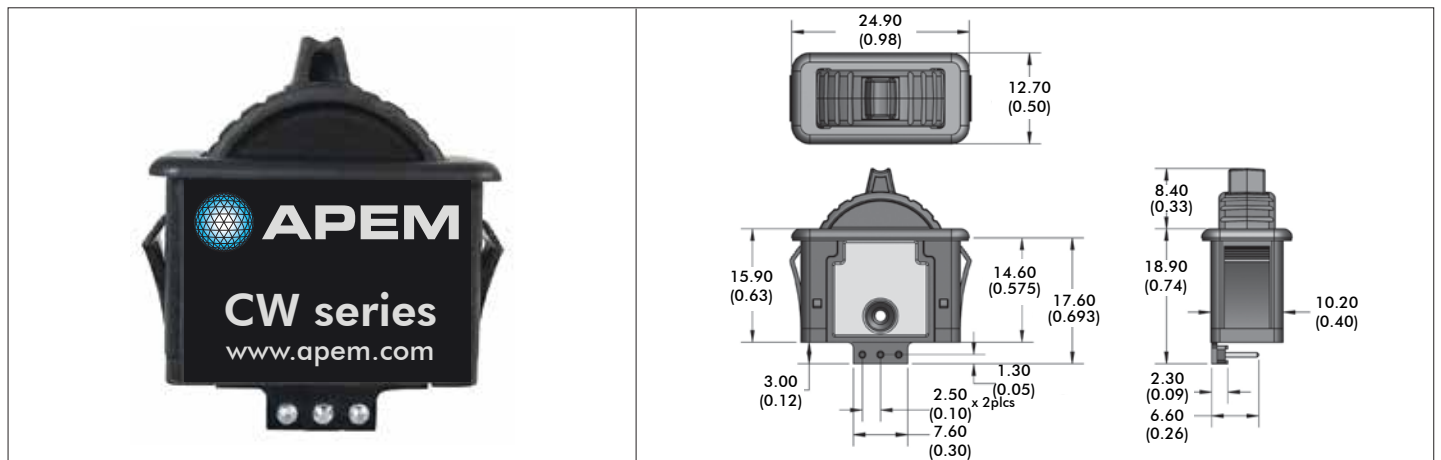

### MOUNTING OPTIONS

#### PANEL CUTOUT

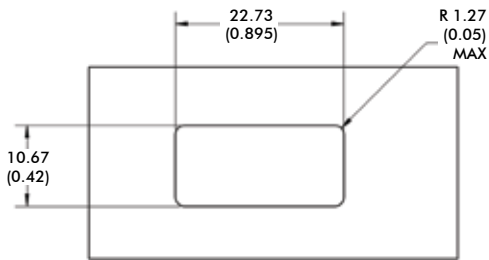

#### PANEL THICKNESS

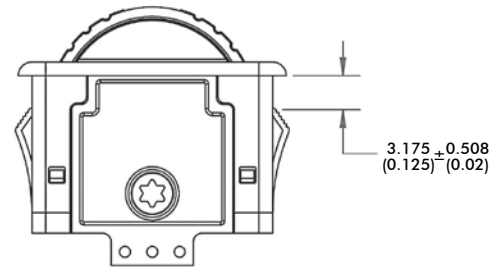

NOTE: Dimensions are in mm/(inch).

### VOLTAGE OUTPUT OPTIONS

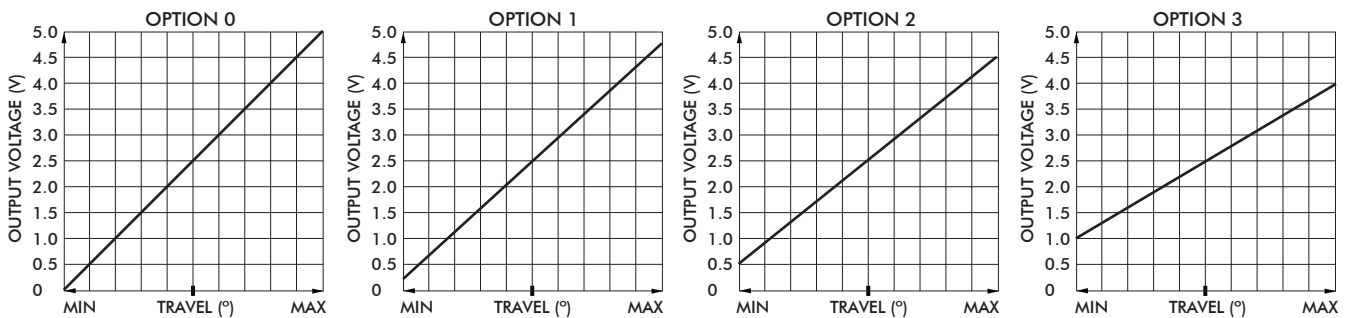

### TERMINALS

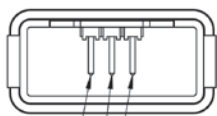

Pin 1 - 5V power (RED)  
Pin 2 - Ground (BLACK)  
Pin 3 - Signal (BLUE)

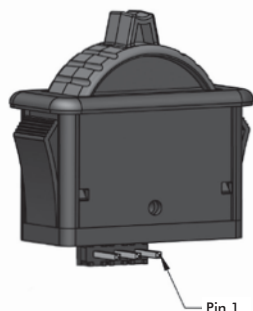

Pin 1

### OPTIONAL MATING HARNESS<sup>1</sup>

- Wire type: 22AWG 25cm PTFE
- Connector: Molex 0050579503

### WIRING SPECIFICATION

- Red: Power (5V)
- Black: Ground
- Blue: Signal

### NOTES:

1. The CW Series is fitted with a three terminal SAMTEC (TLW-103-05-T-S) 2.54mm header. An optional 22AWG Mating Harness may be specified from the "Terminal" category of the Option Selection Guide.
- Images shown are for illustration purposes only.

Note: The company reserves the right to change specifications without notice.

## X-ON Electronics

Largest Supplier of Electrical and Electronic Components

*Click to view similar products for [Joysticks](#) category:*

*Click to view products by [Apem](#) manufacturer:*

Other Similar products are found below :

[M11L0A1](#) [C1000C1P](#) [S10L0A1M](#) [G3-A1AM151NNNN](#) [TH500P00D4](#) [C1000C1PMJ0](#) [S10L061J](#) [60C22-M7-4-020S](#) [67A-DF-3C-060C](#)  
[60A00-8-050C](#) [60A00-4-050C](#) [60C22-M7-4-040S](#) [G3-0425](#) [S30L081F50](#) [3440SAT6476](#) [60A18-4-090C](#) [S30L081J](#) [M11L001C](#) [M11L0X1P](#)  
[USBM31Q081RMJ4S](#) [USBC200051JMJS](#) [TW08BLK12](#) [S30L0M1CSJBLK](#) [HF11R11](#) [HG-44MIS000-2654](#) [HG-44MIS000-U-2655](#)  
[4P182F1E55475](#) [TS4A1S00A](#) [BD140D01GR0000](#) [BD150SD4BL1200](#) [3140SAL6475](#) [TW01BLK11](#) [TW01GRY1](#) [ZD4PA203](#)  
[HF44S10UMJ0](#) [TS3N2S00A](#) [TS1R1U00A](#) [TS1R1S09A](#) [TS1D2S00A](#) [HFX45S02](#) [HFX10S00](#) [HF11P11](#) [4R28-2S1E-55-00](#)  
[BD150A01RE0000](#) [BD150D02BK1200](#) [ZD4PA24](#) [ZD4PA22](#) [ZD4PA12](#) [ZD4PA14](#) [J1-00105-S-G](#)