

# FM series

Snap-in rocker switches •  
panel cut-out 19 x 13 (.750 x .508)



## DISTINCTIVE FEATURES

For class II appliances

UL approved

Protection against moisture by double-shell case

Illuminated or non-illuminated

Optional sealing boot



## ELECTRICAL AND GENERAL SPECIFICATIONS

- Approved ratings (functions 1 and 6) :  
UL : 6 A 250 VAC & 125 VAC T 65°C
- Max. contact rating :
  - functions 1 and 6 : see above.
  - function 3 : 4 A 250 VAC
  - functions 8 and 9 : 6 A 250 VAC
- LED types available :  
3.3 V (4 V max.) 10 mA LED (resistor to be series connected by the user)  
5 V or 12 V LED with integrated resistor
- Initial contact resistance : 20 mΩ max.
- Insulation resistance : 1,000 MΩ min. at 500 VDC
- Dielectric strength :
  - functions 1 and 6 : 2,500 Vrms between terminals
  - functions 3, 8 and 9 : 1,500 Vrms between terminals
- Electrical life at full load : 10,000 cycles
- Operating temperature : -20 °C to +85 °C (-4 °F to +185 °F)



## MATERIALS

- Case, frame, rocker : PA6/6
- Contacts : silver
- Terminals : silver plated
- Lens : PC
- Lamp terminal : no plating
- Fluorescent lamp for blue or green lens, neon lamp for other colors

APEM products may be recycled at end-of-life for the re-claiming of valuable metal components.

The company reserves the right to change specifications without notice.



# FM series

Snap-in rocker switches •  
panel cut-out 19 x 13 (.750 x .508)

## AGENCY APPROVALS



Availability : functions 1 and 6.

Marking : approved models are standard marked.



## PANEL CUT-OUT

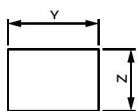

Panel thickness	Dim. Y	Dim. Z
0.75 to 1.25 mm	19.2 +0/-0.1	12.9 +0.15/-0
1.25 to 2 mm	19.4 +0/-0.1	12.9 +0.15/-0
2 to 3 mm	19.8 +0/-0.1	12.9 +0.15/-0



## TERMINALS

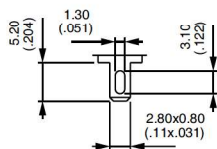

2  
Solder lug

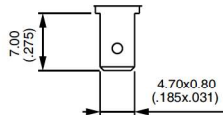

8  
Quick-connect

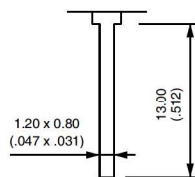

9  
Straight PC  
(functions 1 and 6 only)

# FM series

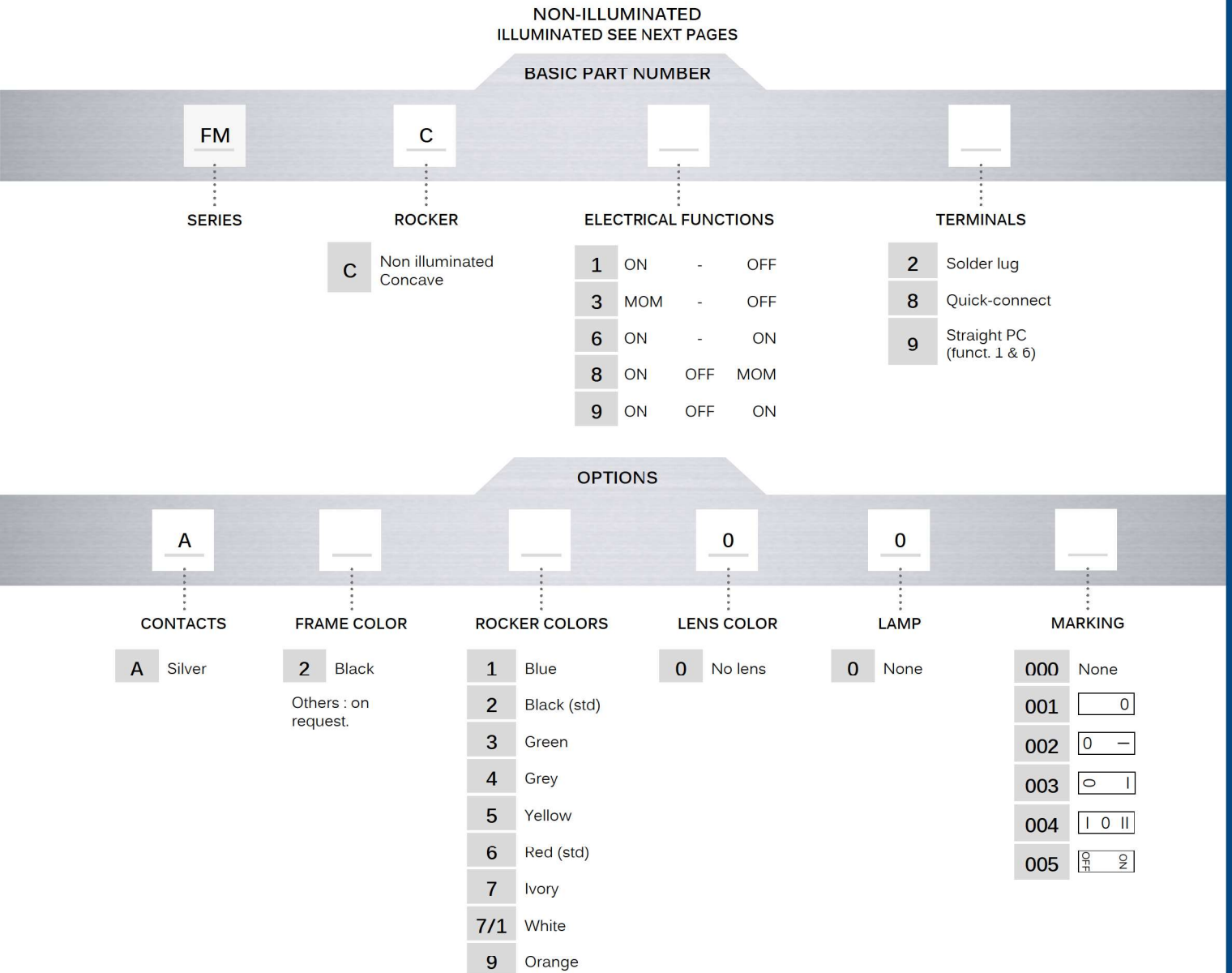

Snap-in rocker switches •  
panel cut-out 19 x 13 (.750 x .508) • non-illuminated

## BUILD YOUR PART NUMBER



## ABOUT THIS SERIES

On the following pages, you will find successively basic part numbers of switches and options in the same order as in above chart.

-  **Notice** : please note that not all combinations of above numbers are available. Refer to the following pages for further information.
-  **A sealing boot** is available to protect the switches against sand or splashing water. Part number U7720. See "Sealing boots" section of website.

# FM series

Snap-in rocker switches • panel cut-out 19 x 13 (.750 x .508) • non-illuminated

## NON-ILLUMINATED QUICK-CONNECT TERMINALS



Single pole	1-2		2-3
<b>FMC18</b>	ON	-	OFF
<b>FMC38</b>	MOM	-	OFF
<b>FMC68</b>	ON	-	ON
<b>FMC88</b>	ON	OFF	MOM
<b>FMC98</b>	ON	OFF	ON

For solder lug terminals, replace 8 with 2 (FMC•2)  
For straight PC terminals, replace 8 with 9 (FMC•9)

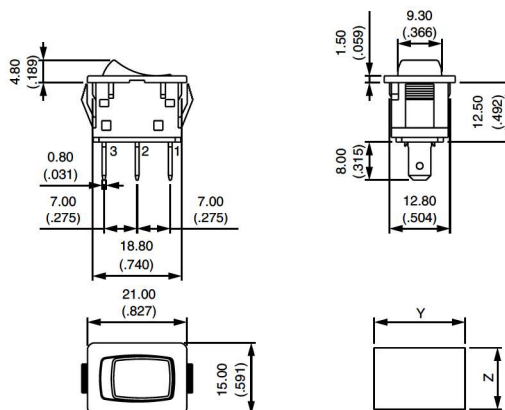

### CONTACT MATERIALS

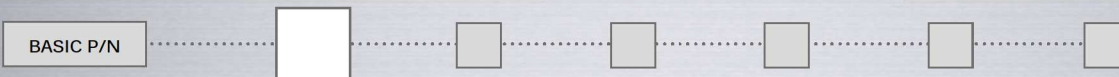

A Silver

### FRAME COLOR

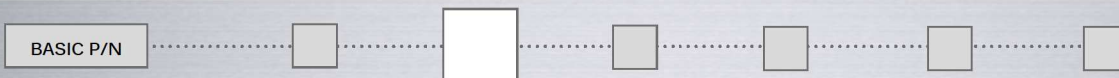

2 Black

Others : on request

### ROCKER COLORS

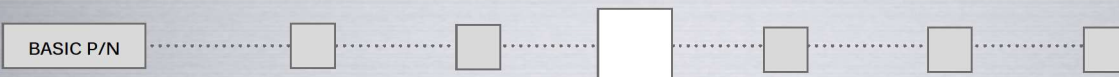

- 1 Blue
- 2 Black (std)
- 3 Green
- 4 Grey
- 5 Yellow
- 6 Red (std)
- 7 Ivory
- 7/1 White
- 9 Orange

### LENS COLOR

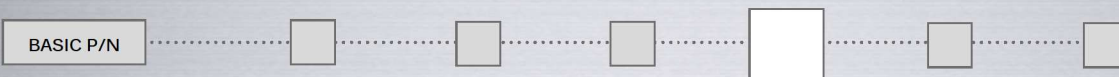

0 No lens

# FM series

Snap-in rocker switches •  
panel cut-out 19 x 13 (.750 x .508) • non-illuminated

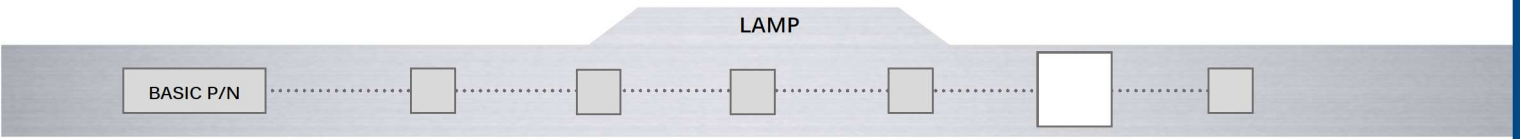

0 None

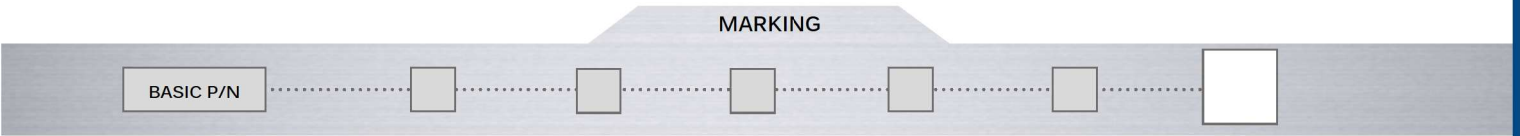

Color of marking : white for black rockers - black for other colors - Other : on request.

000 None

001 

	0
--	---

002 

0	-
---	---

003 

○	
---	--

004 

	0	
--	---	--

005 

0	1	2
---	---	---

# FM series

Snap-in rocker switches • panel cut-out 19 x 13 (.750 x .508) • illuminated

## BUILD YOUR PART NUMBER

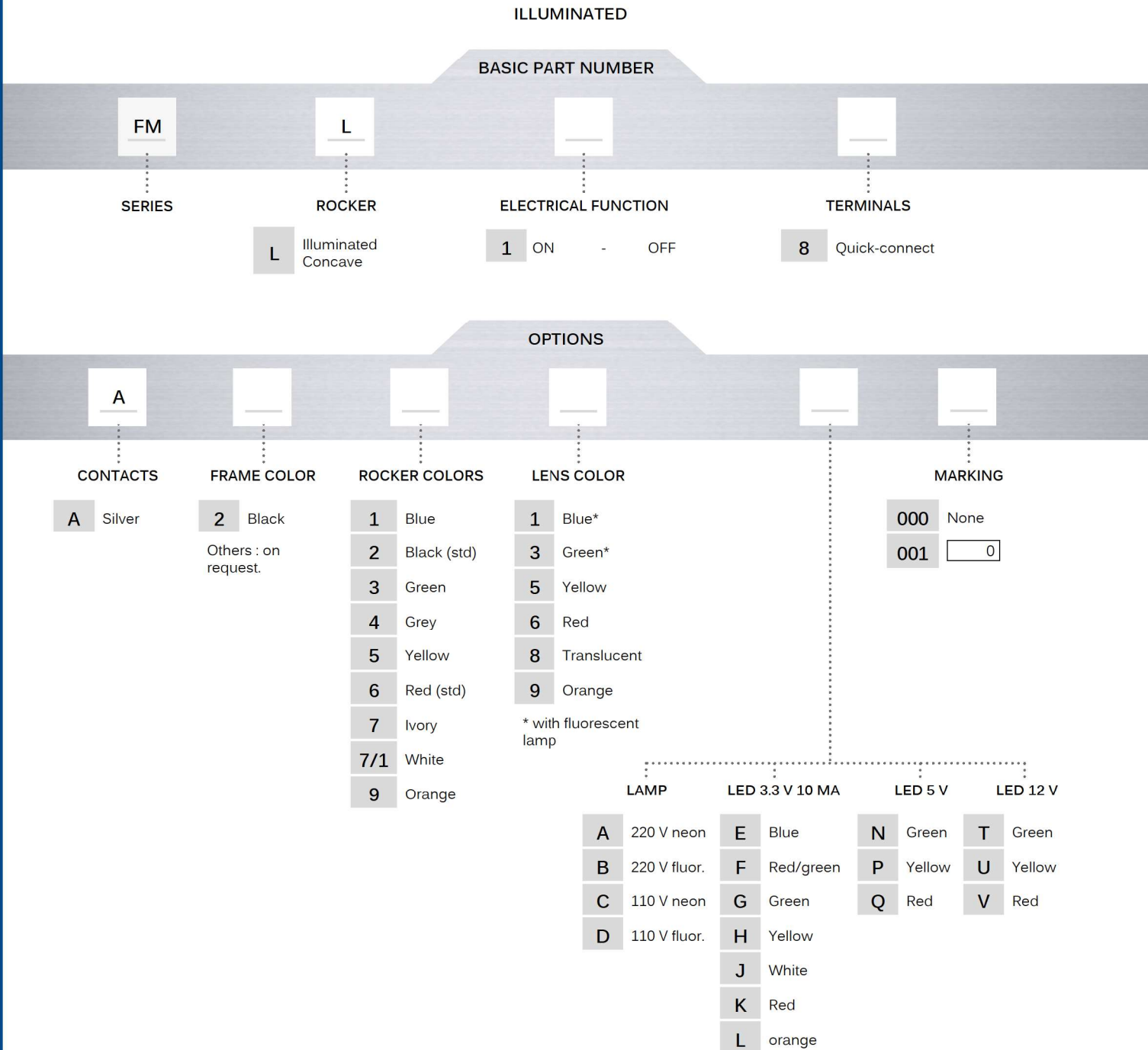

\*\* Resistor value =  $\frac{\text{supply voltage} - \text{LED forward voltage}}{\text{LED forward current}}$

No resistor\*\*

## ABOUT THIS SERIES

On the following pages, you will find successively basic part numbers of switches and options in the same order as in above chart.

- ⚠ **Notice** : please note that not all combinations of above numbers are available. Refer to the following pages for further information.
- 🔒 **A sealing boot** is available to protect the switches against sand or splashing water. Part number U7720. See "Sealing boots" section of website.

# FM series

Snap-in rocker switches • panel cut-out 19 x 13 (.750 x .508) • illuminated

## ILLUMINATED QUICK-CONNECT TERMINALS



Single pole  
**FML18** ON - OFF

For LED models, terminal 2 = cathode (-), terminal 3 = anode (+)

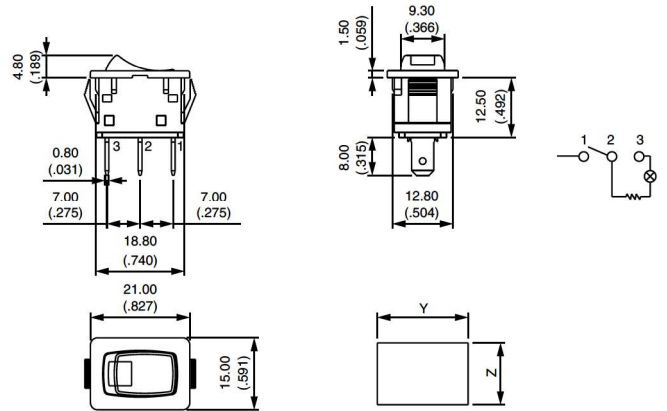

### CONTACT MATERIALS

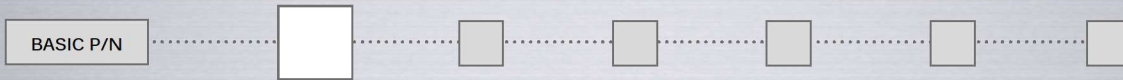

A Silver

### FRAME COLOR



2 Black  
Others : on request

### ROCKER COLORS

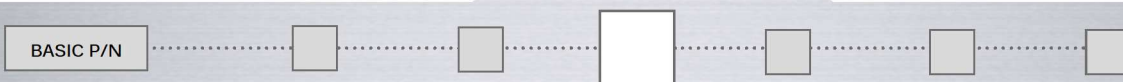

- 1 Blue
- 2 Black (std)
- 3 Green
- 4 Grey
- 5 Yellow
- 6 Red (std)
- 7 Ivory
- 7/1 White
- 9 Orange

### LENS COLORS



- 1 Blue \*
  - 3 Green \*
  - 5 Yellow
  - 6 Red
  - 8 Translucent
  - 9 Orange
- \* with fluorescent lamp

# FM series

Snap-in rocker switches •  
panel cut-out 19 x 13 (.750 x .508) • illuminated

## LAMPS / LEDS

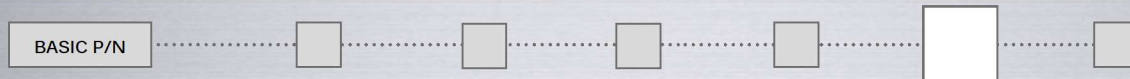

### LAMP

- A 220 V neon
- B 220 V fluorescent
- C 110 V neon
- D 110 V fluorescent

### LED 3.3 V 10 mA

- E Blue
- F Red/green
- G Green
- H Yellow
- J White
- K Red
- L Orange

### LED 5 V

- N Green
- P Yellow
- Q Red

### LED 12 V

- T Green
- U Yellow
- V Red

No resistor \*\*

\*\* Resistor value =  $\frac{\text{supply voltage} - \text{LED forward voltage}}{\text{LED forward current}}$

## MARKING



Color of marking : white for black rockers - black for other colors - Other : on request.

000 None

001



## X-ON Electronics

Largest Supplier of Electrical and Electronic Components

*Click to view similar products for [Rocker Switches](#) category:*

*Click to view products by [Apem](#) manufacturer:*

Other Similar products are found below :

[LTI LA6E-1S-WH-RC-FN12VXCR1](#) [6-1571986-9](#) [8007K26N324V52](#) [8055K32Z7V](#) [8055K52Z7V](#) [8138K20E6M50](#) [84206L](#) [84312LX](#)  
[PREDD5-07F-BB0GW](#) [999-16716-002](#) [999-16716-003](#) [999-16716-004](#) [A101J1V3Q004](#) [A101J2ZQ004](#) [A101J4ZQ004](#) [A101J51CB0004](#)  
[A103J1ZQ004](#) [A201J1AQ004](#) [A201J3ZB004](#) [A201J50ZQ004](#) [A203J51ZQ0004](#) [A435S1YZQ](#) [H8500XBBBBBL-A](#) [H8653VBBG2577W](#)  
[HB130CHNWWNAAC](#) [R13112ABB-602W](#) [1251.0303](#) [AE205J60V3B004](#) [1352.0107](#) [1500G51E](#) [1571099-3](#) [1571987-4](#) [1571987-5](#)  
[1571989-7](#) [1571988-5](#) [B123J77V7B2](#) [B226J50W4Q22P](#) [B433J37ZQ22M](#) [160212E](#) [1634200-7](#) [1801.1164](#) [1839.1502](#) [PANEL-PLUG-VHP-](#)  
[BLACK](#) [PANEL-PLUG-VHP-WT](#) [K1ABBSCADN](#) [K2ABAAAAAA](#) [KG312A2DXD246X](#) [250011E714](#) [2600HM11E](#) [2600R21E](#)