

IM series

Sealed snap-action pushbutton switches - bushing Ø 12 mm - momentary

Distinctive features and specifications

UG1410A



- Snap-action : tactile feedback with audible click
- High current/voltage rating
- Sealed to IP67
- Flat round actuator for optional marking

ENVIRONMENTAL SPECIFICATIONS

- Front panel sealing : IP67 according to IEC 60529
- Shock resistance : 50 g - 11 ms according to IEC 68-2-27
- Salt spray : IEC 512-6, test 11f
- Operating temperature : -40°C to +85°C
- Storage temperature : -40°C to +85°C

ELECTRICAL SPECIFICATIONS

- Max. current/voltage rating with resistive load : 3A 28VDC
- Initial contact resistance : 100 mΩ max.
- Insulation resistance : 1 GΩ min. at 500VDC
- Dielectric strength : 500 Vrms between terminals
- Electrical life at full load : 25.000 cycles

GENERAL SPECIFICATIONS

- Panel thickness : 1,5 mm (.059) to 10 mm (.394)
- Total travel : 1,7 mm (.067) +/- 0,3 mm
- Low level or mechanical life : 1.000.000 cycles
- Torque : 1,5 Nm max. applied to nut

MATERIALS

- Case : polyamide 4/6
- Actuator : polyamide 6/6
- Bushing/bezel : polyamide 6/6
- Contacts : silver, gold plated
- Terminal seal : epoxy

AGENCY APPROVAL



2A 125VAC/250VAC
File E83438

Availability : consult factory for details of approved models.

Marking : to order switches marked UL, complete appropriate box of ordering format.

MOUNTING - STANDARD BEZEL

Panel cut-out

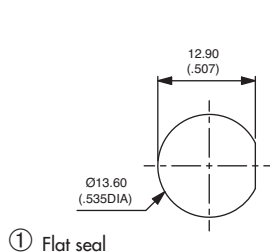

Matrix mounting

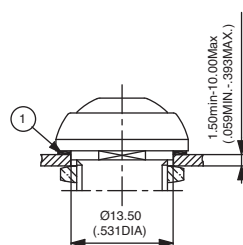

Back of panel space requirement

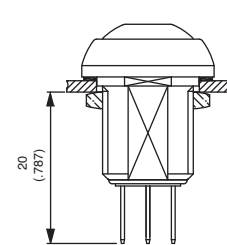
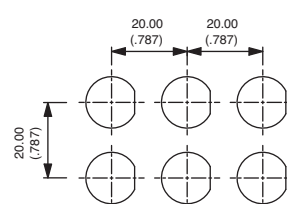

MOUNTING - REDUCED BEZEL

Panel cut-out

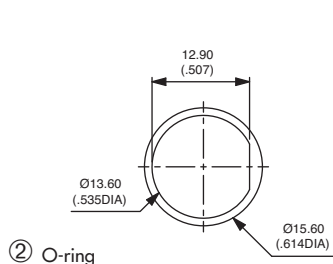

Matrix mounting

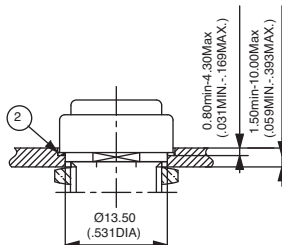

Back of panel space requirement

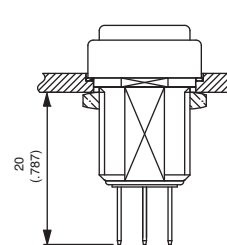
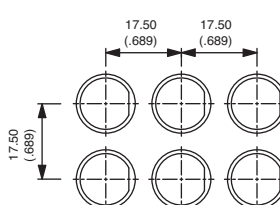

IM series

Sealed snap-action pushbutton switches - bushing Ø 12 mm - momentary

Overview

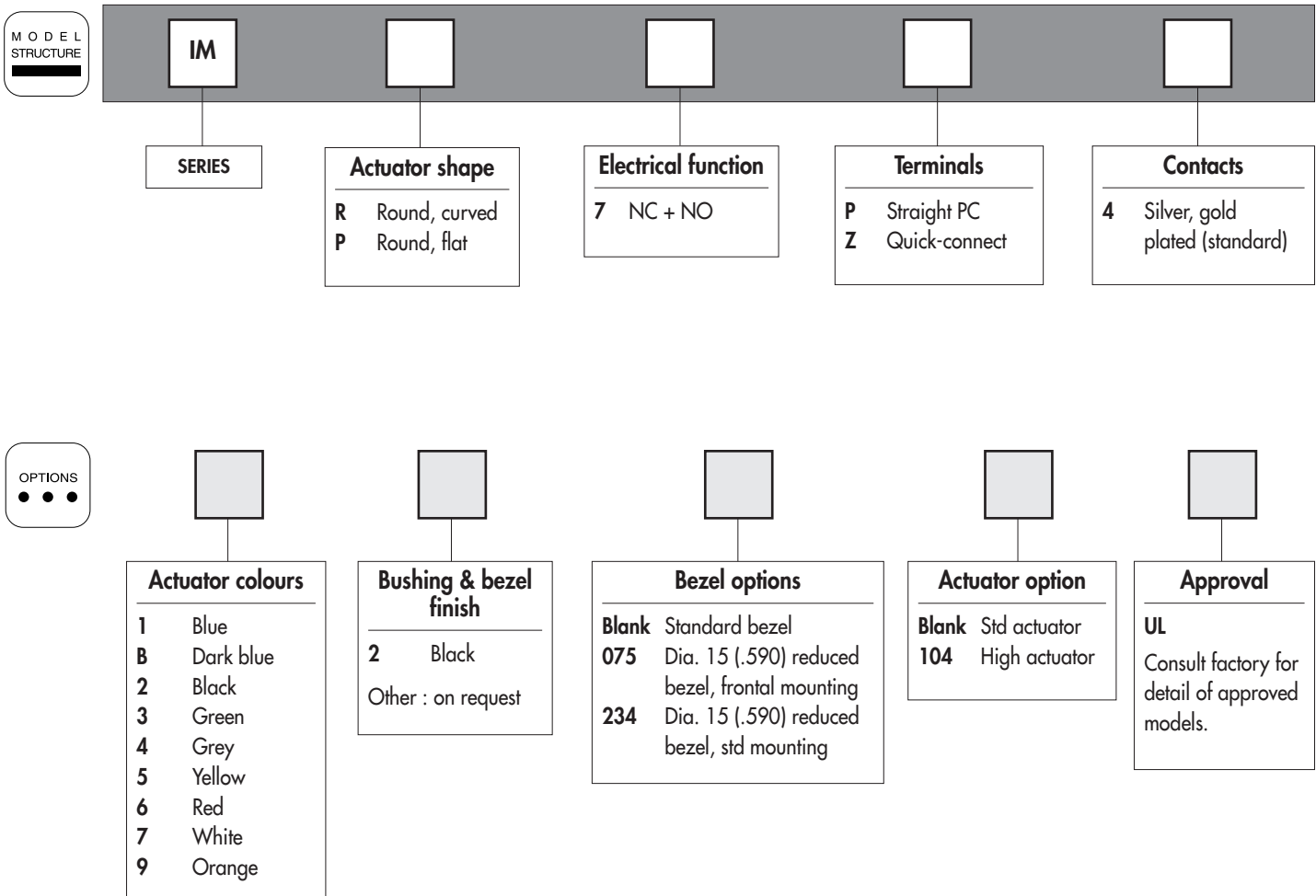

ABOUT THIS SERIES

On the following pages, you will find successively :
model structure of switches and options in the same order as in above chart

Dimensions : first dimensions are in mm while inches are shown as bracketed numbers.



NOTICE : please note that not all combinations of above numbers are available.
Refer to the following pages for further information.



A sealing boot is available to protect the switches against frost and sand (P/N U5125).
It is presented after the IA series and in section H.



Mounting accessories : Standard hardware supplied : 1 flat seal (standard bezel) or 1 O-ring (reduced bezel) and 1 hex nut 14 mm (.551) across flats. Hex nut part number U166.



Packaging unit : 50 pieces

The company reserves the right to change specifications without notice.



IM series

Sealed snap-action pushbutton switches - bushing Ø 12 mm - momentary

Round - non-illuminated

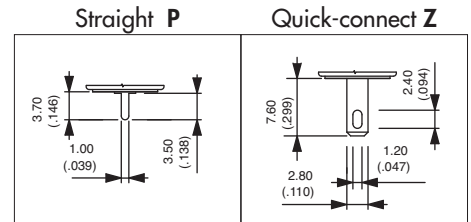
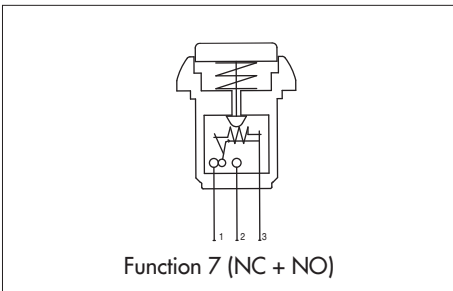

MODEL STRUCTURE

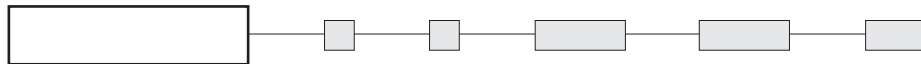

Common terminal identified by a horizontal dash

B1

Standard bezel - straight PC terminals



Curved actuator
IMR7P4



NC+NO

Flat actuator
IMP7P4



NC+NO

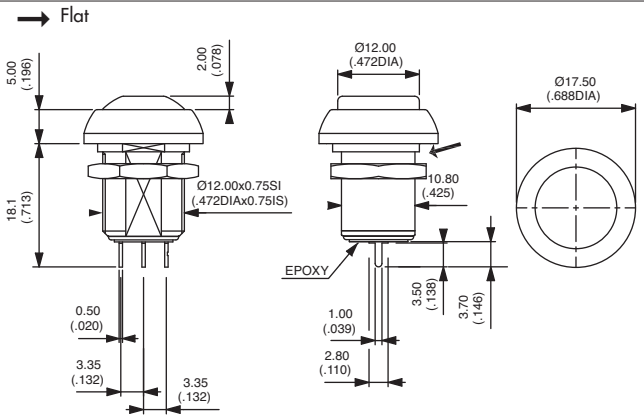

Standard bezel - quick-connect terminals



Curved actuator
IMR7Z4



NC+NO

Flat actuator
IMP7Z4



NC+NO

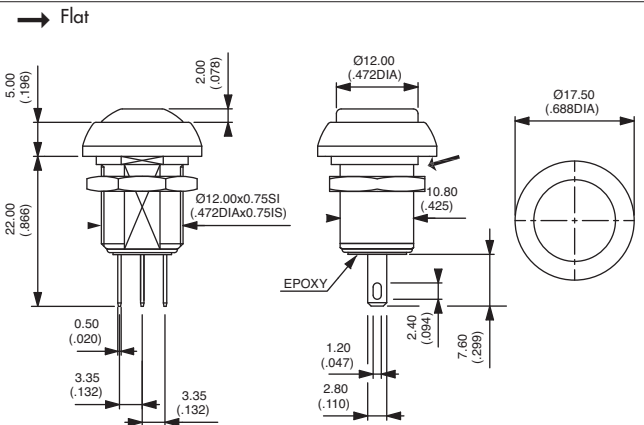

ACTUATOR COLOURS

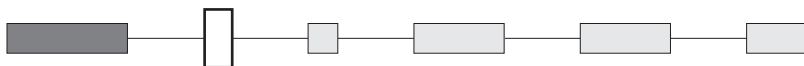

1 : blue - B : dark blue - 2 : black - 3 : green - 4 : grey - 5 : yellow - 6 : red - 7 : white - 9 : orange

BUSHING AND BEZEL COLOURS

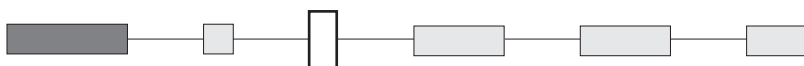

2 : black (standard)
Other : on request



IM series

Sealed snap-action pushbutton switches - bushing Ø 12 mm - momentary

Options

BEZEL OPTIONS

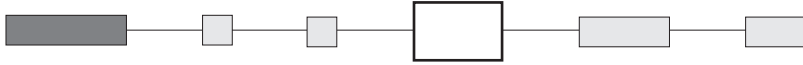

Blank Standard bezel

075 Dia. 15 (.590) reduced bezel, mounting of the switch from the front into a threaded panel cut-out

234 Dia. 15 (.590) reduced bezel, standard mounting

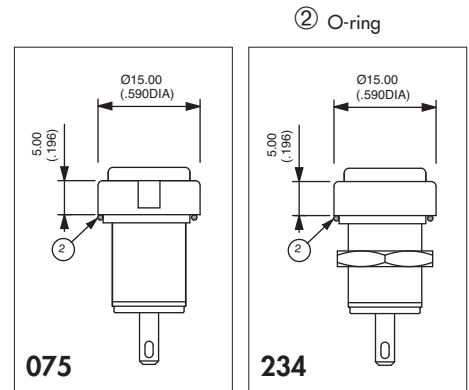

B1

ACTUATOR OPTION

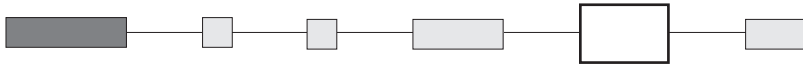

Blank Standard actuator

104 High actuator

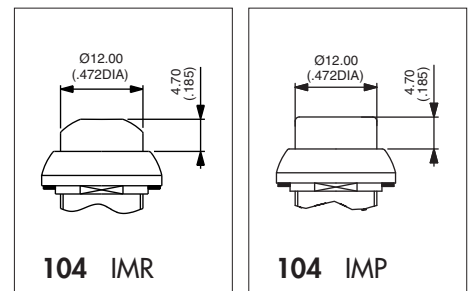

AGENCY APPROVAL

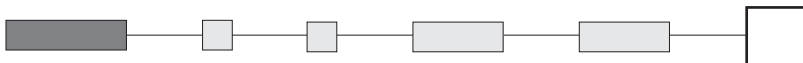

UL

Availability : consult factory for details of approved models.

Marking : to order switches marked UL, complete above box with "UL".

X-ON Electronics

Largest Supplier of Electrical and Electronic Components

Click to view similar products for [apem](#) manufacturer:

Other Similar products are found below :

[48](#) [SLB13814](#) [SLC120025](#) [DA04T](#) [Q6F1CXXB24](#) [SLG12004](#) [SLB1281R5](#) [DPL-02](#) [DA08](#) [5D15F1534](#) [M11L0A1M](#) [M11L0B1M](#)
[M31L0M1M](#) [CW-A0BK1A00A0](#) [MAB6B](#) [A019101](#) [A019305](#) [A019409](#) [A029301](#) [A1PCA0X106J103](#) [Q16F1BXXR12E](#) [Q22F1BXXY12E](#)
[Q22F1CXXB24E](#) [Q22F1CXXG12E](#) [Q8P1BXXY110E](#) [Q8P3BXXG12E](#) [Q8P7BZZRYG12E](#) [Q8R3BXXG02E](#) [121442RA](#) [HF-33S10](#)
[HF44R11](#) [HF45R10](#) [HFX44S00](#) [DMR10](#) [DSR04T](#) [AV0830C900](#) [AV19810KMZB](#) [MSS22](#) [BD150A01RE0000](#) [HS1T24GA](#) [1D09034](#) [1Z03](#)
[1ZZ](#) [NZAA0477](#) [NZAA1475](#) [NZAB1475](#) [NZAB1477](#) [9433CDB](#) [LP1503N20V00SHIM](#) [LPI3124G1K247XX](#)