

# Hardware

## For miniature switches

- Standard hardware is automatically supplied with the switches
- Non standard hardware is to be ordered separately

UG1410A



**Hardware supplied with sealing options :**

- K version : 2 hex nuts + sealing washer
- X408 option : 1 hex nut + 1 O-ring

**STANDARD HARDWARE FOR SWITCHES Ø 6 (.236) - 5000 SERIES**

HEX NUT	LOCKING RING	LOCKWASHER
<p>9.00 (.354) 2.00 (.078) Ø6.00 x 0.75 SI (.236 DIA x 0.75SI)</p>	<p>Ø11.80 (.464 DIA) 6.50 (.216) Ø6.10 (.240 DIA) 2.00 (.078) 0.80 (.031)</p>	<p>Ø9.50 (.374 DIA) Ø6.50 (.255 DIA) 0.80 (.031)</p>
Nickel plated Black	Nickel plated Black	Stainless steel
<b>U208</b> <b>U726</b>	<b>U198</b> <b>U728</b>	<b>U215</b>

**NON STANDARD HARDWARE FOR SWITCHES Ø 6 (.236) - 5000 SERIES**

KNURLED NUT	SPECIAL NUT 12 (.472) ACROSS FLATS	KNURLED CAP NUTS
<p>Ø9.00 (.354 DIA) 2.20 (.086) Ø6.00 x 0.75 SI (.236 DIA x 0.75SI)</p>	<p>12.00 (.472) 2.00 (.086) Ø6.00 x 0.75 SI (.236 DIA x 0.75SI)</p>	<p>Ø9.00 (.354 DIA) 2.70 (.106) Ø6.00 x 0.75 SI (.236 DIA x 0.75SI)</p> <p>Ø12.00 (.472 DIA) 2.60 (.102) Ø6.00 x 0.75 SI (.236 DIA x 0.75SI)</p>
Chrome plated	Chrome plated	Chrome plated
<b>U826</b>	<b>U1916</b>	Black <b>U461</b> <b>U502</b>
		<b>U232</b>

**STANDARD HARDWARE FOR SWITCHES Ø 6,35 (1/4) - ALL SERIES**

HEX NUT	LOCKING RING	LOCKWASHER
<p>8.00 (.314) 1.60 (.062) Ø6.35-40UNS (1/4-40UNS)</p>	<p>Ø9.60 (.377 DIA) 5.20 (.204) Ø6.50 (.255 DIA) 2.00 (.078) 0.80 (.031)</p>	<p>Ø9.50 (.374 DIA) Ø6.50 (.255 DIA) 0.80 (.031)</p>
Nickel plated Black	Nickel plated Black	Stainless steel
<b>U76</b> <b>U94</b>	<b>U78</b> <b>U93</b>	<b>U215</b>

SERIES	HARDWARE SUPPLIED (unsealed types)		
	HEX NUT	LOCKING RING	LOCKWASHER
SF	2	1	1
11000	2	1	1
13000	2	1	1
18000-8000-SP	2	1	1
21000N	2	-	-
5000	2	1	1
9400-9600	2	-	1

The company reserves the right to change specifications without notice.

# Hardware

For miniature switches

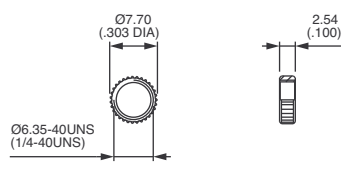
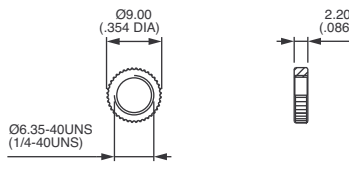
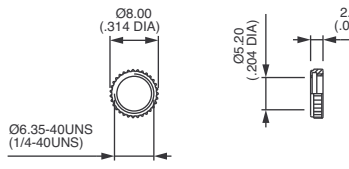
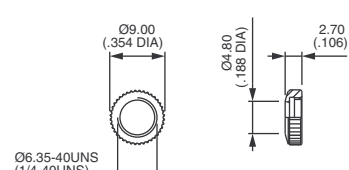
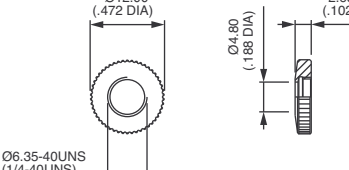
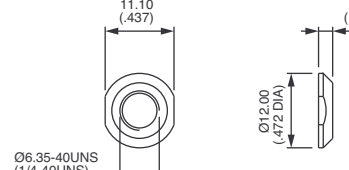
NON STANDARD HARDWARE FOR SWITCHES Ø 6,35 (1/4) - ALL SERIES		
<p><b>KNURLED NUT</b></p>  <p>Nickel plated <b>U369</b></p>	<p><b>KNURLED NUT</b></p>  <p>Nickel plated <b>U229</b> Black <b>U230</b></p>	<p><b>KNURLED NUT</b></p>  <p>Chrome plated <b>U501</b></p>
<p><b>KNURLED CAP NUT</b></p>  <p>Chrome plated <b>U216 *</b> Black <b>U218</b></p>	<p><b>KNURLED CAP NUT</b></p>  <p>Chrome plated <b>U268 *</b> Black <b>U725</b></p>	<p><b>DRESS NUT</b></p>  <p>Nickel plated <b>U443</b> Black <b>U848</b></p>

\* U216 and U268 : consult factory for mounting on 11000 three and four pole, and 5000 locking lever models.

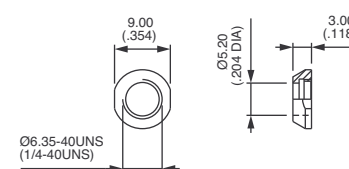
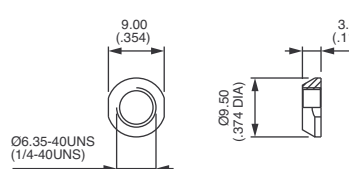
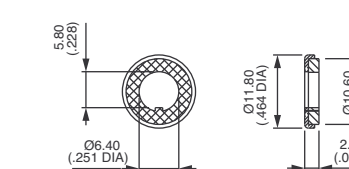
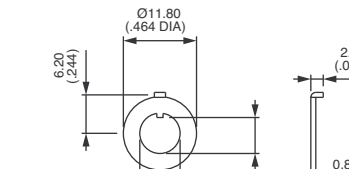
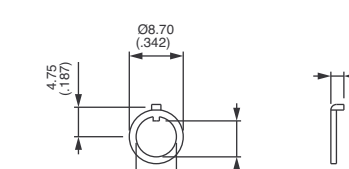
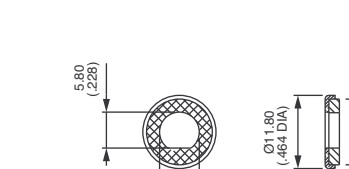
OTHER HARDWARE FOR SWITCHES Ø 6,35 (1/4) - ALL SERIES		
<p><b>CONIC CAP NUT</b></p>  <p>Nickel plated <b>U500</b></p>	<p><b>CONIC NUT</b></p>  <p>Chrome plated <b>U542</b> Nickel plated <b>U561</b></p>	<p><b>SEALING WASHER</b> for keyway bushing</p>  <p><b>U360</b></p>
<p><b>SPECIAL LOCKING RING</b> Spacing 6,2 mm (.244)</p>  <p>Nickel plated <b>U368</b></p>	<p><b>SPECIAL LOCKING RING</b> Spacing 4,75 mm (.187)</p>  <p>Nickel plated <b>U409</b></p>	<p><b>SEALING WASHER</b> for flatted bushing</p>  <p><b>U5141</b></p>

# Hardware

## For miniature switches

### STANDARD HARDWARE FOR SWITCHES Ø 10 (.393) - 10400 AND 10600 SERIES

**KNURLED CAP NUT (std for 10600)**

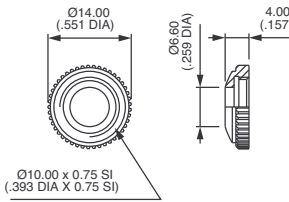

Ø10.00 x 0.75 SI  
(.393 DIA X 0.75 SI)

Chrome plated  
**U220**

**KNURLED NUT (std for 10400)**

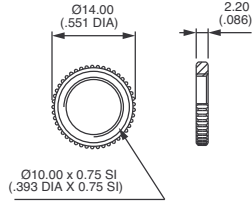

Ø10.00 x 0.75 SI  
(.393 DIA X 0.75 SI)

Nickel plated  
**U2311**

**HEX NUT**

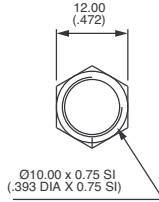

Ø10.00 x 0.75 SI  
(.393 DIA X 0.75 SI)

Nickel plated  
**U842**

**LOCKING RING**

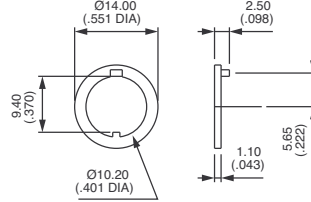

Ø10.20  
(.401 DIA)

Nickel plated  
**U844**

**LOCKWASHER**

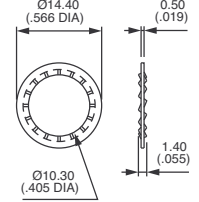

Ø10.30  
(.405 DIA)

Zinc plated steel  
**U843**

### STANDARD HARDWARE FOR SWITCHES Ø 11,9 (15/32) - 12000, 13000X768 AND 5600M SERIES

**HEX NUT**

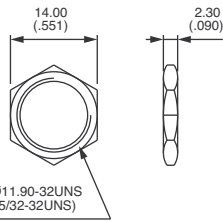

Ø11.90-32UNS  
(15/32-32UNS)

Nickel plated  
Black  
**U162**  
**U41**

**LOCKING RING**

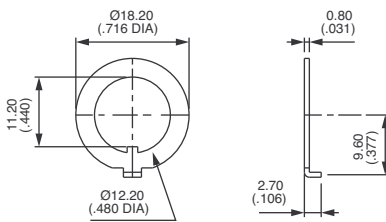

Nickel plated  
Black  
**U121**  
**U12**

SERIES	HARDWARE SUPPLIED	
	HEX NUT	LOCKING RING
12000	2	1
13000X768	1	-
5600M	2	1
8000X718	2	1

### NON STANDARD HARDWARE FOR SWITCHES Ø 11,9 (15/32) - 12000, 13000X768 AND 5600M SERIES

**KNURLED NUT**

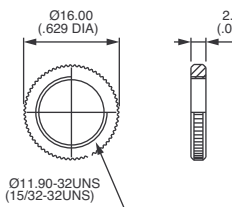

Ø11.90-32UNS  
(15/32-32UNS)

Nickel plated  
Black  
**U53**  
**U1634**

**KNURLED CAP NUTS**

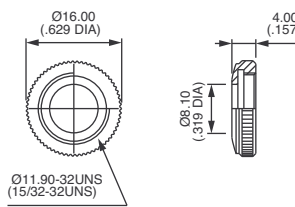

Ø11.90-32UNS  
(15/32-32UNS)

Chrome plated  
**U124**

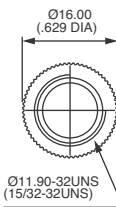

Ø11.90-32UNS  
(15/32-32UNS)

Chrome plated  
**U123**

**LOCKWASHER**

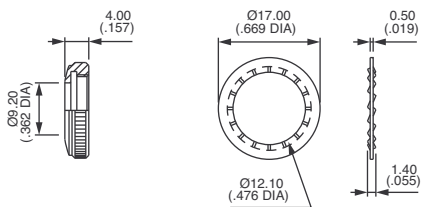

Zinc plated steel  
**U13**

### HARDWARE FOR SWITCHES Ø 16

**KNURLED NUT**

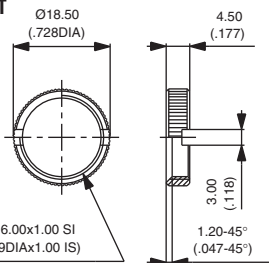

Ø16.00x1.00 SI  
(.629 DIA X 1.00 SI)

**U3327**

### OTHER HARDWARE

**SEALING WASHER**

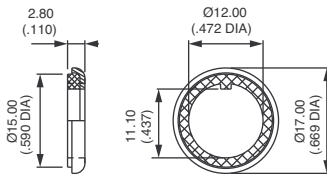

**U60**

### WRENCHES

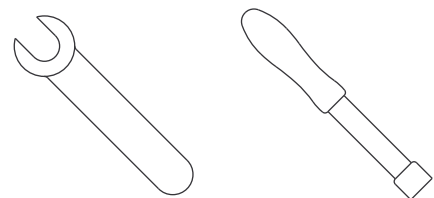

Available for some accessories.  
Consult factory.

# Hardware

## For industrial switches

- Standard hardware is indicated by darkened boxes.
- For details of hardware supplied, please refer to beginning of each series.
- Special hardware is to be ordered separately.

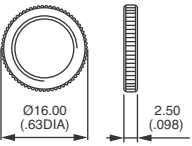
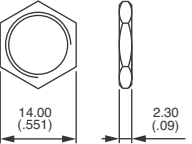
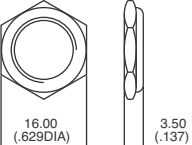
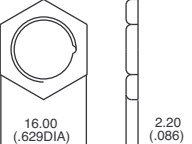
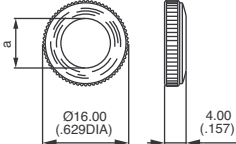
NUTS	Bushing $\varnothing$ 11,9 (15/32) thread 0,794-32UNS Series 3500 - 6000			Bushing $\varnothing$ 12 (.472) thread 0,75 Series IB/IS - IP - 660 - 600H - 600NH 1000 - 1200 - 1500 - 1600 - 1700 - 3600 - 4000		
	Chrome plated brass	Nickel plated brass	Black brass	Chrome plated brass	Nickel plated brass	Black brass
		<b>U53</b>	<b>U1634</b>	<b>U412</b>	<b>U411</b>	<b>U413</b>
	<b>U92</b>	<b>U162</b>	<b>U41</b>	<b>U212</b>	<b>U166</b>	<b>U183</b>
 Hex cap nut				<b>U35</b>		
 PAL nut					<b>U42</b> (passive zinc plated steel)	
 Knurled cap nut	<b>U123</b>			<b>U117</b> $\alpha = 8,5 (.334)$ <b>U118</b> $\alpha = 10,3 (.405)$		<b>U129</b> $\alpha = 8,5 (.334)$ <b>U130</b> $\alpha = 10,3 (.405)$

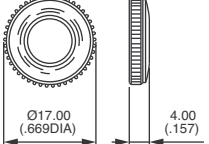
INSULATED NUT U520									
 ABS or polyamide with glass fibre	For threaded bushing $\varnothing$ 12 (.472) x 0,75 IS Series 1500 - 4000 - 600NH - 6-600NH								
	Blue	Black	Green	Grey	Yellow	Red	White	Chrome plated	Orange
	<b>U521</b>	<b>U522</b>	<b>U523</b>	<b>U524</b>	<b>U525</b>	<b>U526</b>	<b>U527/1</b>	<b>U528</b>	<b>U529</b>

The locking ring U121 (nickel plated) or U12 (black) is only provided with tropicalized switches version T or G and with series 3500 - 6000.

The lockwasher U13 must be ordered separately, except for series 660, 3500 and 6000.

# Hardware

## For industrial switches

### HARDWARE FOR SWITCHES Ø 12 (.472) AND 11,9 (15/32)

#### LOCKING RING

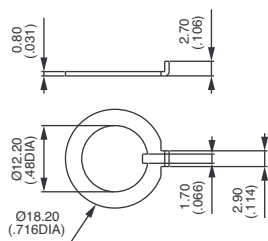

Nickel plated **U121**  
Black **U12**

#### LOCKWASHER

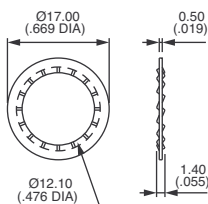

Zinc plated steel **U13**

#### SEALING WASHER

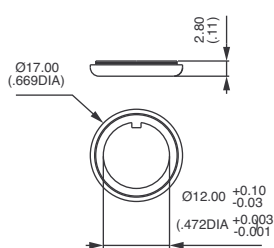

Stainless steel and neoprene **U60**

#### SEALING WASHER FOR BOOTS

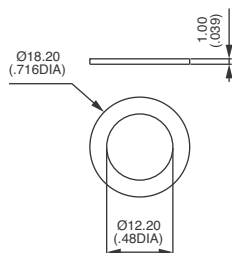

Nylon **U21**

#### GROUND CONNECTOR

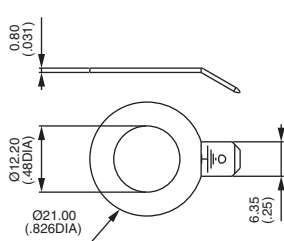

Nickel plated **U187**

#### LOCKWASHER

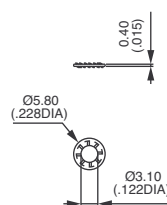

Zinc plated steel **U14**

### PLATES FOR SWITCHES Ø 12 (.472) AND 11,9 (15/32)

#### Marche - arrêt

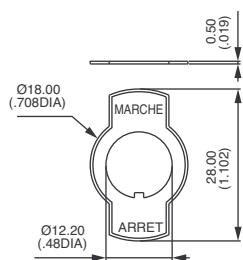

**U17**

#### ON - OFF

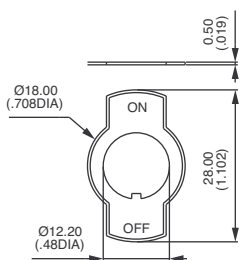

**U19**

#### EIN - AUS

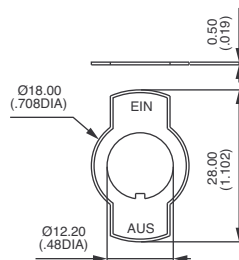

**U99**

#### I - 0

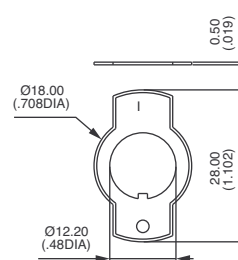

**U1050**

#### CONNECTING SCREW

Supplied with the switches

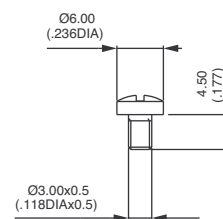

**U03**

# Hardware

For industrial switches

## HARDWARE FOR AV SERIES (ANTI-VANDAL AND SECURITY PUSHBUTTON SWITCHES)

### HEX NUT FOR MODELS Ø 16 (.629)

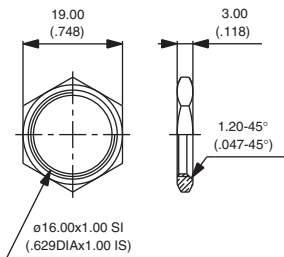

10-621

### KNURLED NUT FOR MODELS Ø 16 (.629)

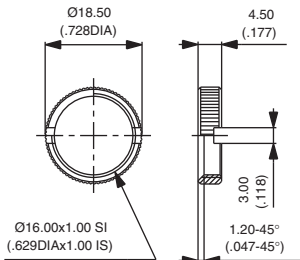

10-960-5

### KNURLED NUT FOR MODELS Ø 19 (.748)

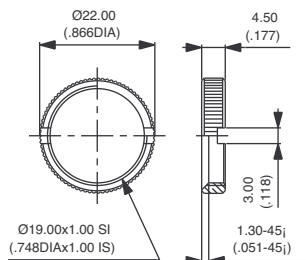

U1977-5

### HEX NUTS FOR MODELS Ø 19 (.748)

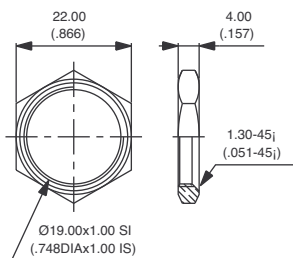

10-855-5

Wrench for nut U1977-5 available under part number **U1929**.

### HEX NUTS FOR MODELS Ø 22 (.866)

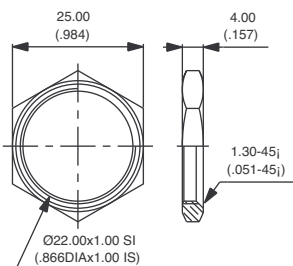

10-856-5

### HEX NUT FOR MODELS Ø 24 (.944)

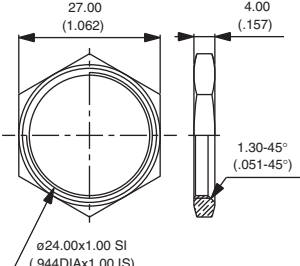

U2059-5

All above nuts are made of nickel plated brass.  
For switches with front panel sealing (option K), a neoprene O-ring is supplied with each nut.

## X-ON Electronics

Largest Supplier of Electrical and Electronic Components

*Click to view similar products for [Switch Fixings](#) category:*

*Click to view products by [Apem](#) manufacturer:*

Other Similar products are found below :

[893102000](#) [00-5150](#) [LZZ1A](#) [0098.9234](#) [M2PA-5011](#) [630155](#) [635401](#) [6PA113](#) [6PA147-E6](#) [6PA148-E6](#) [6PA32](#) [6PA9](#) [700106](#) [700109](#)  
[700303A56](#) [700C1GRY](#) [700C2GRN](#) [704-6001](#) [704.960.9](#) [704.965.2](#) [704.965.6](#) [704.966.0](#) [7089-3](#) [710082-B11](#) [71M1048](#) [757200264](#)  
[764300000](#) [MHU35](#) [MHU37](#) [807039-1](#) [825.003.011](#) [825.005.011](#) [825.053.011](#) [825.055.011](#) [826.000.071](#) [827.020.011](#) [827.400.021](#)  
[835.900.023](#) [MML52C10C](#) [MML52E10C](#) [MML92HGH](#) [MML93K](#) [84211M02CNNS](#) [84212M02CNNS](#) [842.500.011](#) [843.000.011](#) [843187-](#)  
[000](#) [843487-000](#) [84-901](#) [84-902](#)