

ZL series

Tiny toggle switches - metal bushing

Distinctive features - Specifications - Overview

UG1410A



□ Ø 4,83 mm threaded bushing

□ Solder lug and straight PC terminals

A

ELECTRICAL SPECIFICATIONS

- Max. current/voltage rating with resistive load :
 - gold plated contacts : 0,4VA 20V max. AC or DC
 - silver plated contacts : 0,5A 48V max. AC or DC
- Minimum load : 10mA 50mV - 10µA 5VDC
- Contact resistance : 20 mΩ max.
- Insulation resistance : 1.000 MΩ min. at 500VDC
- Dielectric strength: 1.000 Vrms 50 Hz min. between terminals and frame
500 Vrms 50 Hz min. between terminals
- Electrical life at full load :

| Contacts | Number of cycles | |
|---------------|------------------|-------------|
| | 2 positions | 3 positions |
| Gold plated | 60.000 | 30.000 |
| Silver plated | 20.000 | 10.000 |

MATERIALS

- Case : thermoplastic UL94-V0
- Actuator : brass, nickel plated
- Bushing : zamac, tin plated
- Contacts and terminals :
 - 0 : brass, gold plated (standard)
 - 1 : brass, silver plated
 - 3 : brass, gold plated (1,27 micron gold)
- Terminal seal : epoxy

SOLDERING

- Hand soldering : 280°C max. for 5 seconds max.
- Wave soldering : 260°C max. for 5 seconds max.

GENERAL SPECIFICATIONS

- Strength of terminals : pull-out force 10N max.
- Torque : 1 Nm max. applied between the 2 nuts
- Max. panel thickness : 1,5 mm (.059) with 2 nuts
- Operating temperature : -30°C to +85°C
- Moisture : 21 days 95 % (NFC 20-603 - IEC 8-2-3)

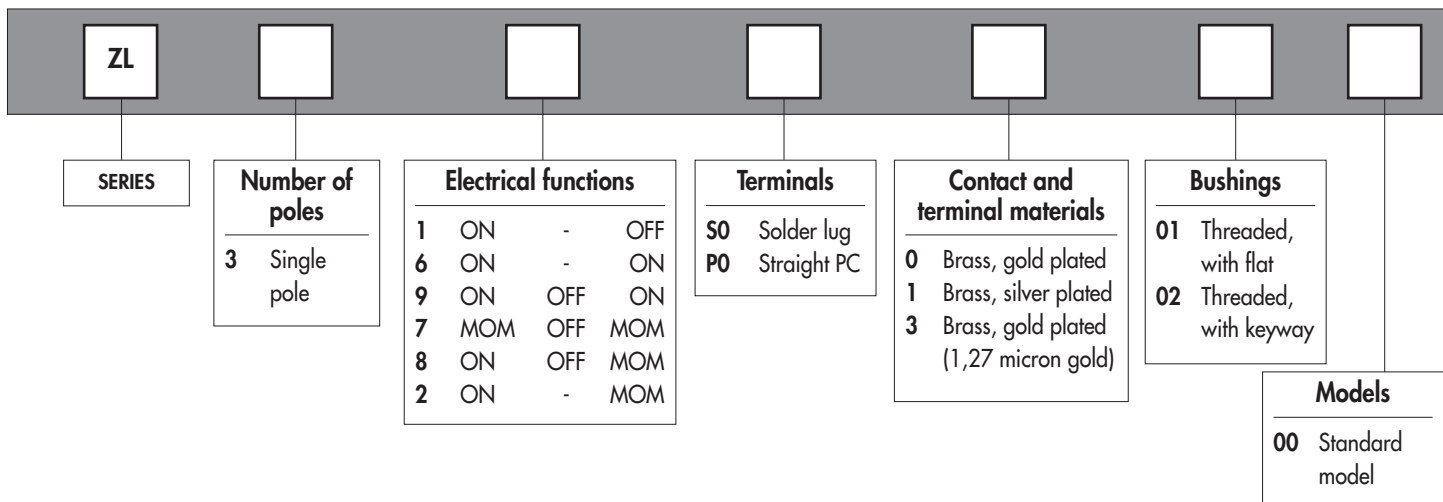

Dimensions : First dimensions are in mm while inches are shown as bracketed numbers.

Packaging unit : 100 pieces

Mounting accessories : Standard hardware supplied with all models : 2 hex nuts 7 mm (.275) across flats P/N U5731, 1 locking ring P/N U5821 (with keyway) or U5831 (with flat) and 1 lockwasher P/N U5841.

The company reserves the right to change specifications without notice.

ZL series

Tiny toggle switches - metal bushing

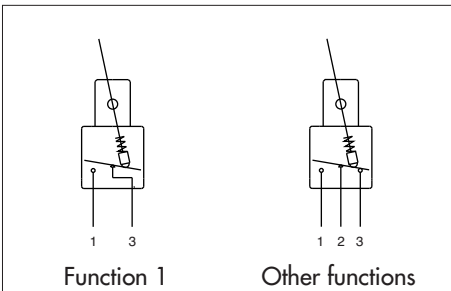

- Single pole
- Gold plated or silver plated contacts
- Epoxy sealed terminals

Other actuator lengths available on request.

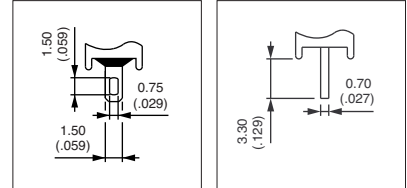

A

MODEL STRUCTURE

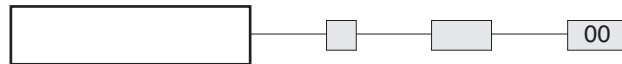

Shown with threaded bushing code 01

Solder lug terminals : ZL..S0



- ZL31S0
- ZL36S0
- ZL39S0
- ZL37S0
- ZL38S0
- ZL32S0

| | III | II | I |
|--------|-----|-----|-----|
| ZL31S0 | ON | - | OFF |
| ZL36S0 | ON | - | ON |
| ZL39S0 | ON | OFF | ON |
| ZL37S0 | MOM | OFF | MOM |
| ZL38S0 | MOM | OFF | ON |
| ZL32S0 | MOM | - | ON |

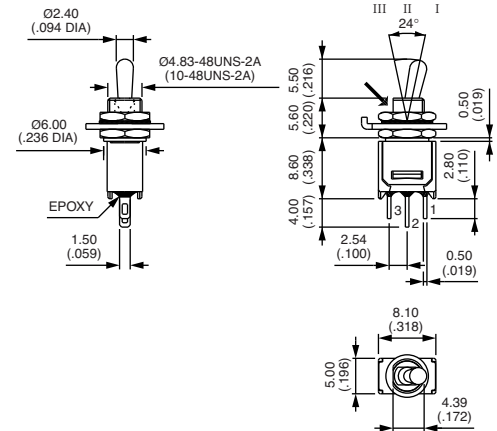

→ Flat

Straight PC terminals : ZL..PO



- ZL31PO
- ZL36PO
- ZL39PO
- ZL37PO
- ZL38PO
- ZL32PO

| | III | II | I |
|--------|-----|-----|-----|
| ZL31PO | ON | - | OFF |
| ZL36PO | ON | - | ON |
| ZL39PO | ON | OFF | ON |
| ZL37PO | MOM | OFF | MOM |
| ZL38PO | MOM | OFF | ON |
| ZL32PO | MOM | - | ON |

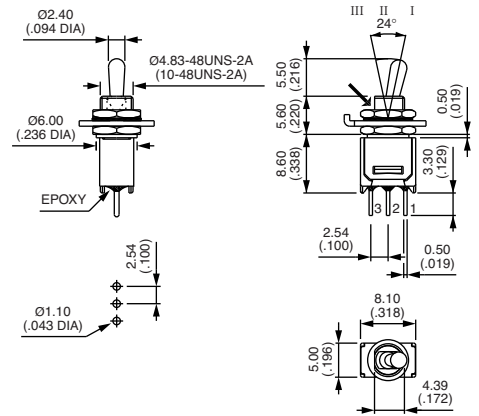

→ Flat

CONTACT & TERMINAL MATERIALS



0 : Brass, gold plated (standard) - 1 : Brass, silver plated
3 : Brass, gold plated (1,27µ gold)

BUSHINGS

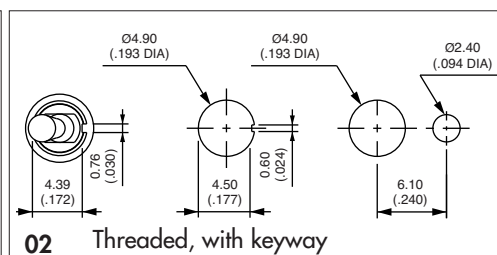
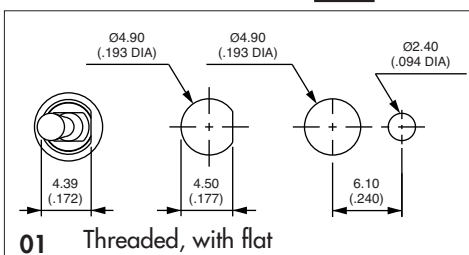
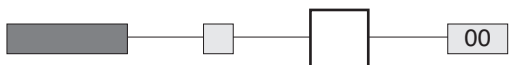

X-ON Electronics

Largest Supplier of Electrical and Electronic Components

Click to view similar products for [Toggle Switches](#) category:

Click to view products by [Apem](#) manufacturer:

Other Similar products are found below :

[8A1-C-222](#) [60012L](#) [6006L](#) [6663](#) [7101MD9V30GE](#) [7101SPDV30BE](#) [7103SDV30BE](#) [7105D](#) [7108P3YAV2BE](#) [71YY50282](#)
[7201MD9AVBE](#) [7301K38](#) [7306K36](#) [7310K36](#) [7314K36](#) [7506K4](#) [7592K6](#) [7691K14](#) [7700K1](#) [8396K108](#) [8824K14](#) [8828K13](#) [G2VX](#) [G3VX](#)
[PS83-121G](#) [A101MD9AB04](#) [A101SD9AB04](#) [A101SDCQ04](#) [A103SD9AQ04](#) [A107TZB04](#) [A123P32YZQ](#) [A123S1YZG](#) [A127S1YCQ](#) [1-](#)
[1825192-0](#) [A131S1YZQ](#) [A201SCWZB04](#) [A207SYCB04](#) [A208J61ZQ0004](#) [A221K12KAG](#) [A221S1YZQ](#) [A221T1TCQ](#) [A232K12KZQ](#)
[A232M1YCQ](#) [A323S1CWZQ](#) [A423S1CWZG-M8](#) [A423S1YZQ](#) [12149A-3V](#) [12156AX408](#) [12147AGKX679](#) [12149AD2G0383VX408](#)