

**SERIES**

**CM7560R  
CM7560**

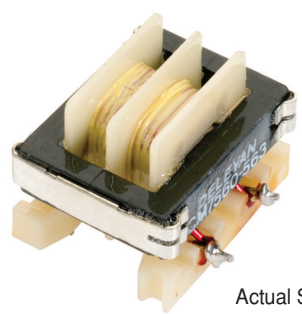

**PC Mount Common Mode Choke**



Actual Size

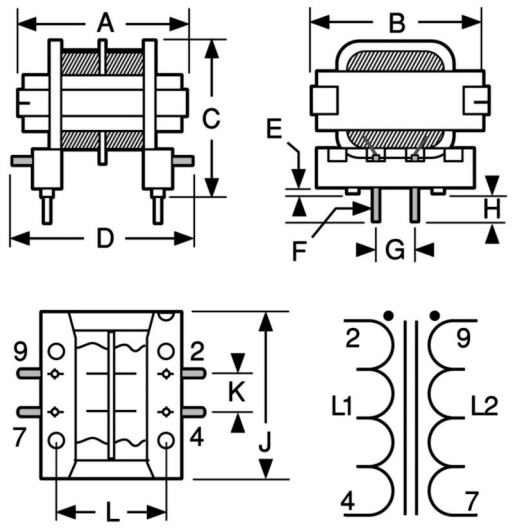

**Physical Parameters**

|   | Inches            | Millimeters      |
|---|-------------------|------------------|
| A | 0.860 ± 0.025     | 21.8 ± 0.64      |
| B | 1.070 ± 0.050     | 27.2 ± 1.27      |
| C | 0.830 ± 0.030     | 21.1 ± 0.76      |
| D | 1.060 (Ref. only) | 26.9 (Ref. only) |
| E | 0.040 ± 0.025     | 1.0 ± 0.64       |
| F | 0.025 Sq. (Typ.)  | 0.64 Sq. (Typ.)  |
| G | 0.400 ± 0.010     | 10.2 ± 0.3       |
| H | 0.175 ± 0.015     | 4.4 ± 0.38       |
| J | 1.03 (Ref. only)  | 26.2 (Ref. only) |
| K | 0.400 ± 0.010     | 10.2 ± 0.3       |
| L | 0.630 ± 0.010     | 16.0 ± 0.3       |

**Operating Temperature Range** -55°C to +125°C

**Current Rating at 85°C Ambient** 40°C Rise

**Mechanical Configuration** Tape wrapped winding sections; varnish impregnated assembly

- Notes** 1) Inductance in table is for either L1 or L2.  
 2) Leakage Inductance tested at L1 with L2 shorted or at L2 with L1 shorted. 3) Windings balanced within 1%.

| DASH NUMBER* | L (µH) L1 or L2 @ 1 kHz ±25% | DC RESISTANCE MAXIMUM (OHMS) | CURRENT RATING MAXIMUM (AMPS) | LEAKAGE INDUCTANCE MAXIMUM (µH) |
|--------------|------------------------------|------------------------------|-------------------------------|---------------------------------|
|--------------|------------------------------|------------------------------|-------------------------------|---------------------------------|

| SERIES CM7560 FERRITE CORE |        |       |      |      |
|----------------------------|--------|-------|------|------|
| -563                       | 56     | 0.013 | 5.5  | 3.5  |
| -683                       | 68     | 0.013 | 5.5  | 3.5  |
| -823                       | 82     | 0.013 | 5.5  | 3.5  |
| -104                       | 100    | 0.013 | 5.5  | 3.5  |
| -124                       | 120    | 0.015 | 5.5  | 4.5  |
| -154                       | 150    | 0.015 | 5.5  | 6.0  |
| -184                       | 180    | 0.019 | 4.5  | 7.0  |
| -224                       | 220    | 0.020 | 4.5  | 7.5  |
| -274                       | 270    | 0.025 | 4.5  | 9.0  |
| -334                       | 330    | 0.025 | 3.5  | 12   |
| -474                       | 470    | 0.030 | 3.5  | 14   |
| -564                       | 560    | 0.035 | 3.5  | 18   |
| -684                       | 680    | 0.040 | 3.5  | 20   |
| -824                       | 820    | 0.060 | 2.8  | 24   |
| -105                       | 1000   | 0.065 | 2.8  | 30   |
| -125                       | 1200   | 0.095 | 2.2  | 35   |
| -155                       | 1500   | 0.115 | 1.7  | 40   |
| -185                       | 1800   | 0.125 | 1.7  | 45   |
| -225                       | 2200   | 0.170 | 1.4  | 55   |
| -275                       | 2700   | 0.180 | 1.4  | 75   |
| -335                       | 3300   | 0.320 | 1.1  | 90   |
| -395                       | 3900   | 0.400 | 1.1  | 100  |
| -475                       | 4700   | 0.450 | 0.88 | 130  |
| -565                       | 5600   | 0.500 | 0.88 | 175  |
| -685                       | 6800   | 0.600 | 0.88 | 220  |
| -825                       | 8200   | 0.750 | 0.88 | 230  |
| -106                       | 10000  | 0.800 | 0.70 | 250  |
| -126                       | 12000  | 0.900 | 0.70 | 300  |
| -156                       | 15000  | 1.00  | 0.70 | 350  |
| -186                       | 18000  | 1.30  | 0.55 | 425  |
| -226                       | 22000  | 1.50  | 0.55 | 475  |
| -276                       | 27000  | 1.80  | 0.44 | 550  |
| -336                       | 33000  | 2.20  | 0.44 | 650  |
| -396                       | 39000  | 2.60  | 0.44 | 800  |
| -476                       | 47000  | 3.00  | 0.44 | 900  |
| -566                       | 56000  | 4.00  | 0.35 | 1100 |
| -686                       | 68000  | 5.00  | 0.27 | 1300 |
| -826                       | 82000  | 5.50  | 0.27 | 1800 |
| -107                       | 100000 | 6.40  | 0.27 | 2100 |
| -127                       | 120000 | 7.80  | 0.22 | 2600 |
| -157                       | 150000 | 9.00  | 0.22 | 3000 |

\*Complete part # must include series # PLUS the dash #

**Marking** DELEVAN; part number.

Example: CM7560-563  
 DELEVAN  
 CM7560-563

**Packaging** Bulk only

## X-ON Electronics

Largest Supplier of Electrical and Electronic Components

*Click to view similar products for [Common Mode Chokes / Filters](#) category:*

*Click to view products by [API Delevan](#) manufacturer:*

Other Similar products are found below :

[74279408](#) [PE-62911NL](#) [PE-64683](#) [ST6118T-R](#) [T8114NLT](#) [RD5122-10-6M0](#) [TCM0806G-350-2P-T](#) [TCM0806G-650-2P-T](#) [IND-0110](#)  
[UAL21V07012500](#) [UAL21VR0802000](#) [UAL24VR06500CH](#) [UALSC023000000](#) [UALSC1020JH000](#) [UALSC1520JH000](#)  
[UALSU10VR20010](#) [UALSU16VD30030](#) [UALSU16VD40010](#) [UALSU9H0305000](#) [UALSU9HF060300](#) [UALSU9VD070100](#) [36-00037](#)  
[5701610000](#) [UALW21HS072450](#) [UALSU9VD070400](#) [UALSU9HF050500](#) [UALSU9H0208000](#) [UALSCF25081300](#) [UAL24VK06450CH](#)  
[PLT10HH501100PNB](#) [PLT10HH401100PNB](#) [PLT10HH1026R0PNB](#) [PE-67531](#) [EXC-X4CH120X](#) [TLH10UB 113 0R5](#) [2752041447](#)  
[2752045447](#) [CMS3-11-R](#) [7351V](#) [CMF16-153131](#) [744252510](#) [T8116NLT](#) [FE2X10-4-2NL](#) [744253200](#) [744253101](#) [744252220](#) [TX8111NLT](#)  
[UAL30VR3500470](#) [CTX01-19077-R](#) [T8003NLT](#)