

SERIES

SDS680R



Surface Mount Shielded Power Choke

DASH NUMBER*
 INDUCTANCE (μH)
 C-100 KHZ
 TOLERANCE
 SRF (MHz) REF. ONLY
 DC RESISTANCE
 MAXIMUM (OHMS)
 CURRENT RATING
 MAXIMUM (mA)

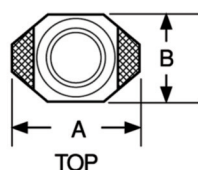
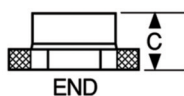
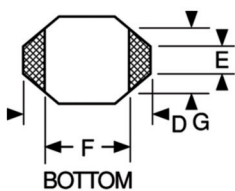

Actual Size

Physical Parameters

	Inches	Millimeters
A	0.260 Max.	6.60 Max.
B	0.175 Max.	4.45 Max.
C	0.115 Max.	2.92 Max.
D	0.040 ±0.010	1.02 ±0.25
E	0.050 Max.	1.27 Max.
F	0.170 ±0.015	4.32 ±0.38
G	0.120 Ref.	3.05 Ref.
H	0.055 Ref.	1.40 Ref.
I	0.140 Ref.	3.56 Ref.
J	0.160 Ref.	4.06 Ref.

Current rating at 25°C Ambient

40°C Max. Rise

Operating Temperature Range

-40°C to +85°C

Weight Maximum

0.20 grams

Marking For values lower than 10 μH the R indicates a decimal point and the remaining digits indicate the inductance in μH. For values 10 μH and above, the first two digits indicate the inductance in μH and the third digit indicates the number of trailing zeros where a zero indicates that there are no trailing zeros.

Example: SDS680R-102M (1.0 μH)

1R0

Example: SDS680R-106M (10,000 μH)

103

Packaging

Tape & Reel (16mm): 13" reel
 2000 pieces max.

SERIES SDS680 FERRITE CORE & SLEEVE

-102M	1.0	±20%	250	0.040	3000
-152M	1.5	±20%	125	0.045	2800
-222M	2.2	±20%	120	0.050	1800
-332M	3.3	±20%	120	0.055	1600
-472M	4.7	±20%	105	0.060	1400
-682M	6.8	±20%	50	0.065	1200
-822M	8.2	±20%	42	0.070	1100
-103M	10	±20%	38	0.075	1000
-153M	15	±20%	33	0.090	800
-223M	22	±20%	25	0.110	700
-333M	33	±20%	20	0.190	600
-473M	47	±20%	20	0.230	500
-683M	68	±20%	15	0.290	400
-104M	100	±20%	10	0.480	300
-154M	150	±20%	9	0.590	260
-224M	220	±20%	6	0.770	220
-334M	330	±20%	5	1.40	200
-474M	470	±20%	4	1.80	190
-684M	680	±20%	3	2.20	180
-105M	1000	±20%	2	3.40	150
-155M	1500	±20%	2	4.20	120
-225M	2200	±20%	2	8.50	100
-335M	3300	±20%	1	11.0	80
-475M	4700	±20%	1	25.0	60
-685M	6800	±20%	1	25.0	40
-106M	10000	±20%	0.8	32.8	20

*Complete part # must include series # PLUS the dash #

LAND PATTERN DIMENSIONS

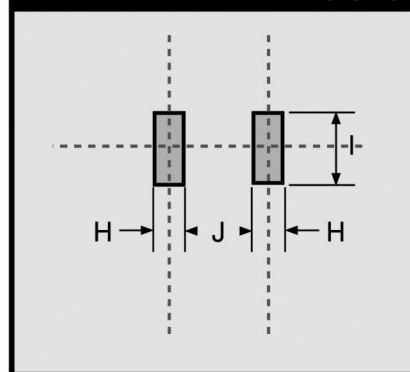

X-ON Electronics

Largest Supplier of Electrical and Electronic Components

Click to view similar products for [Fixed Inductors](#) category:

Click to view products by [API Delevan](#) manufacturer:

Other Similar products are found below :

[API Delevan](#)