

NOTES:

- 1) VOLTAGE: 100 VDC.
- 2) CURRENT: 20 AMPS.
- 3) OPERATING TEMPERATURE: -55°C TO +105°C.
- 4) MATERIAL: BLACK THERMOPLASTIC OR EQUIV.
- 5) SCREW TYPE: #6-32 PHILSLOT HD.
- 6) MARKING: 4 PT. CHARACTERS, WHITE INK.
- 7) CAPACITANCE: 2500pF MIN./ 5200pF MAX.
- 8) GROUND PLANE IS TO BE FLAT WITHIN .012".
- 9) SHIPPING TRAY LABEL MARKING:
 SCI 52F160-004-A DATE CODE
 100V, 20A, 12-22AWG
 UL & CSA LOGOS

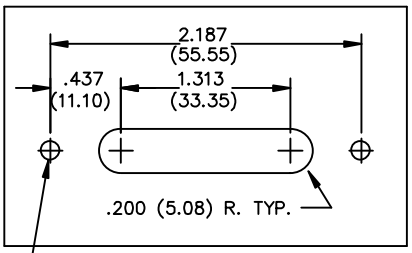

RECOMMENDED CUTOUT

MOUNTING HOLES AS REQUIRED

MARKING:
 SCI
 52F160-004-A
 XXXX - DATE CODE

#6-32UNC-2A THD
 PHILSLOT HD. SCREW

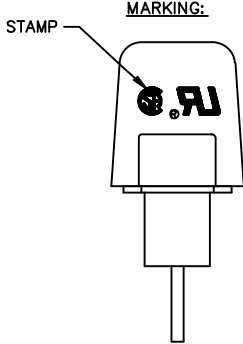
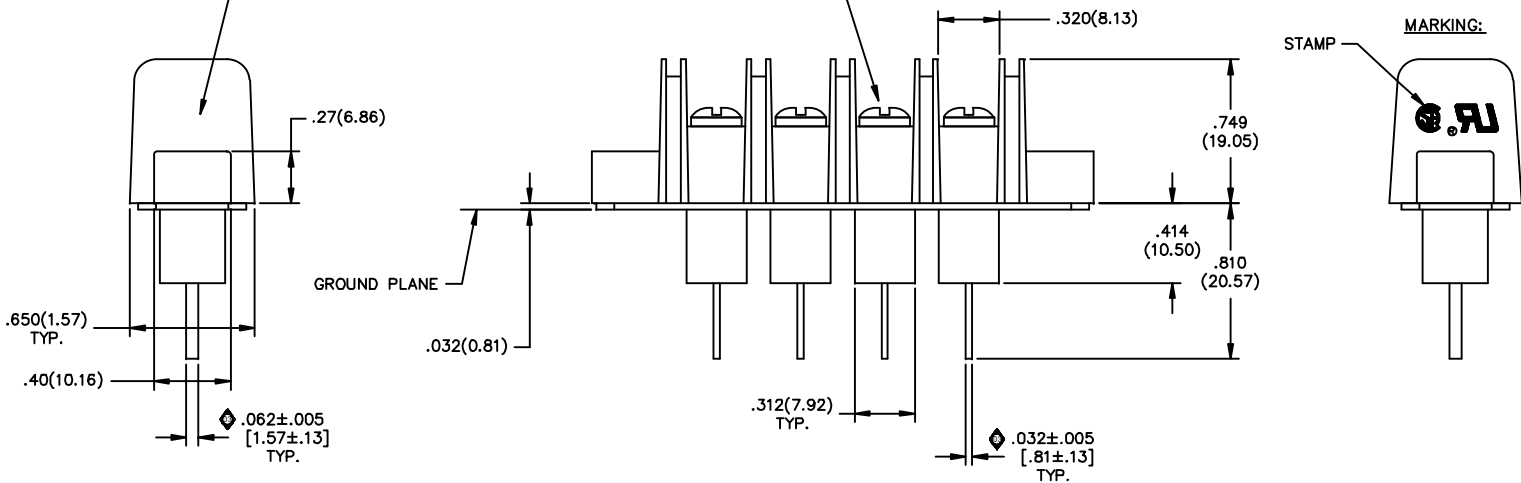

TEST SEQUENCE				
STEP	DESCRIPTION	TESTING METHOD	PASS	FAIL
STEP 0400	INSPECTION	VISUAL/MECH	PASS	FAIL
PER IT 38-0468 INSPECT DIMENSIONS AND WORKMANSHIP. PER MIL-STD-105, LEVEL II, 1%AQL COMMENTS: 100%		OPER:		
STEP 0100	TESTING	CAP./D.F.	PASS	FAIL
PER IT 38-0245 CAP: 2500pF TO 5200pF DF: <4% MAX COMMENTS: 100%		OPER:		
STEP 0200	TESTING	DWV	PASS	FAIL
PER IT 38-0245 DWV: 2000 VDC 25°C 1 MINUTE MINIMUM COMMENTS: 100%		OPER:		
STEP 0300	TESTING	I.R.	PASS	FAIL
PER IT 38-0245 IR: 100VDC, 1000 Mohms MIN. 2 MINUTES MAX. COMMENTS: 100%		OPER:		

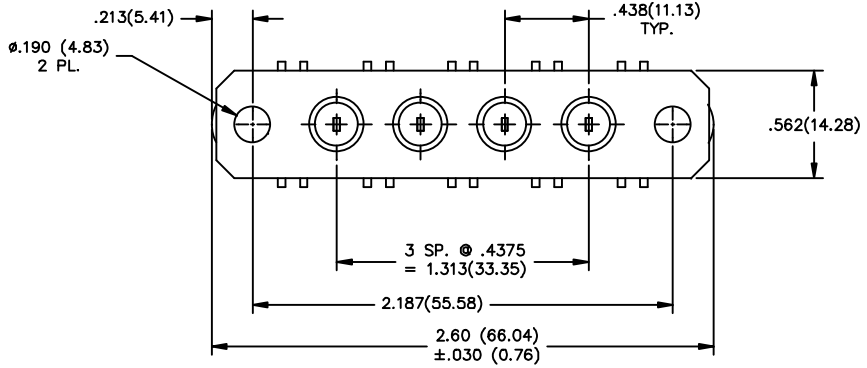

03	02	01	00	REV. NO.	UNLESS OTHERWISE SPECIFIED DIMENSIONS ARE IN INCHES. (MILLIMETERS) DO NOT SCALE.	TOLERANCES UNLESS OTHERWISE SPECIFIED Fractions ± 1/64 Dec. .xxx ± .03(.76) Dec. .xxx ± .020(.51) Angles ± 0° 30'	 SPECTRUM CONTROL INC. Dwn. KAUFFMAN Date 3-18-09 Apr'd Grunauer Sheet 1 of 1	FAIRVIEW PENNSYLVANIA Description FILTER TERMINAL BLOCK 52F160-004-A
CN 67206-ENG	CN 46317-ENG	CN 44322-ENG	CN 25891-CPD	CHANGE NOTICE				
© THIRD ANGLE PROJECTION								
Quality Products From The Specialists In Electro-Magnetic Compatibility								

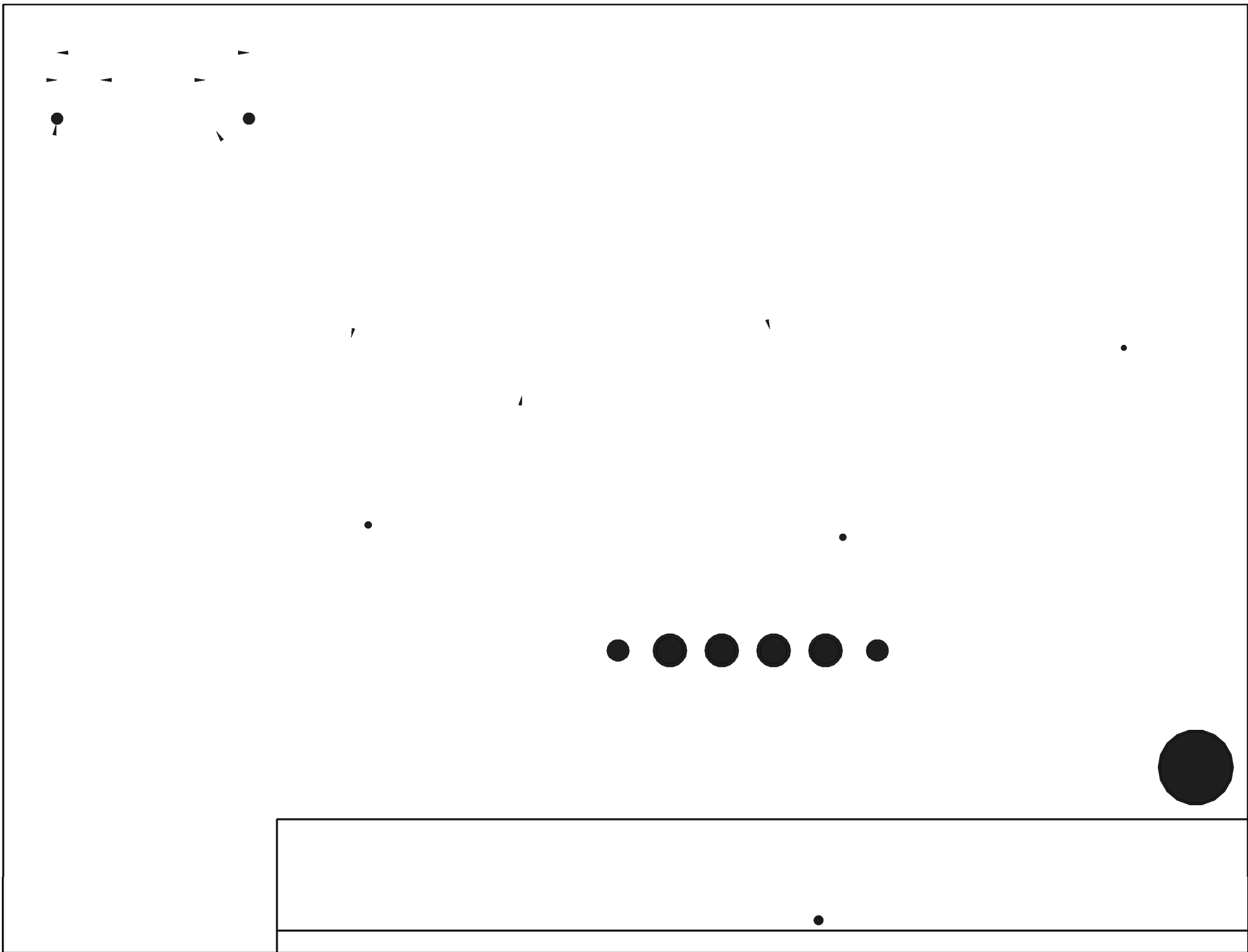

X-ON Electronics

Largest Supplier of Electrical and Electronic Components

Click to view similar products for [Barrier Terminal Blocks](#) category:

Click to view products by [Api Technologies](#) manufacturer:

Other Similar products are found below :

[CR151D20104](#) [670A-RZ-15-KT20](#) [6C1N03](#) [6PCR-02](#) [6PCR-02-008](#) [6PCR-05-008](#) [6PCR-08-008](#) [6PCR-09-008](#) [6PCR-13-006](#) [6PCR-15-006](#) [6PCR-21-006](#) [6PCV-06-008](#) [6PCV-06-716](#) [6PCV-09-001](#) [6PCV-10-009](#) [6PCV-15-008](#) [6PCV-17-1206](#) [6PCV-20-323](#) [6PCV-30-006](#) [6STR-06-006](#) [6STR-08-006](#) [6STR-12-008](#) [6STR-13-006](#) [6STR-14-008](#) [6STR-16-008](#) [6STR-17-008](#) [6STR-21-008](#) [6STR-25-008](#) [6STR-27-008](#) [6STV-03-006](#) [6STV-03-008](#) [6STV-04-006](#) [6STV-09-006](#) [6STV-10-006](#) [6WWR-03-693](#) [6WWV-12-008](#) [6WWV-16-008](#) [72212603](#) [72504-C-50](#) [72506-C](#) [72507-C-50](#) [73203](#) [75505-C](#) [75505-C-50](#) [75510-C](#) [77010-50](#) [7C1N08](#) [812-GP-3/4ST-09](#) [8-1437402-5](#) [8-1437402-7](#)